

8			7		
THIS DRAWING IS UNPUBLISHED.			RELEASED FOR PUBLICATION		
(C) COPYRIGHT 20			BY TYCO ELECTRONICS CORPORATION. ALL RIGHTS RESERVED.		
PART NUMBER	REV	FIRST USED	POWER UNIT	FEED TYPE	DESCRIPTION
1855259-1	A	122500-1	LEADMAKER	AIR FEED	CUTS CARRIER
1855259-2	A	565435-5	BENCH MODEL K	AIR FEED	CUTS CARRIER
1855259-3	A	354500-1	BENCH MODEL G	AIR FEED	CUTS CARRIER
7-1855259-7	A	-	-	-	SPARE PARTS

- 1 RECOMMENDED SPARE PARTS
2 GREASE LIGHTLY
3 GUARD MUST BE IN PLACE WHEN OPERATING APPLICATOR IN A BENCH MACHINE
4 INSTALL ITEMS 101, 102, AND 119 ON SIDE OF STRIPPER ON APPL HOUSING USING ITEM 21.

*** WARNING**
ON INSTALLATION, SET WIRE DISC TO LARGEST WIRE SIZE SETTING. USE OF SETTINGS BELOW MIN. REQUIRED CRIMP HEIGHT SETTING WILL CAUSE DAMAGE TO CRIMP TOOLING.

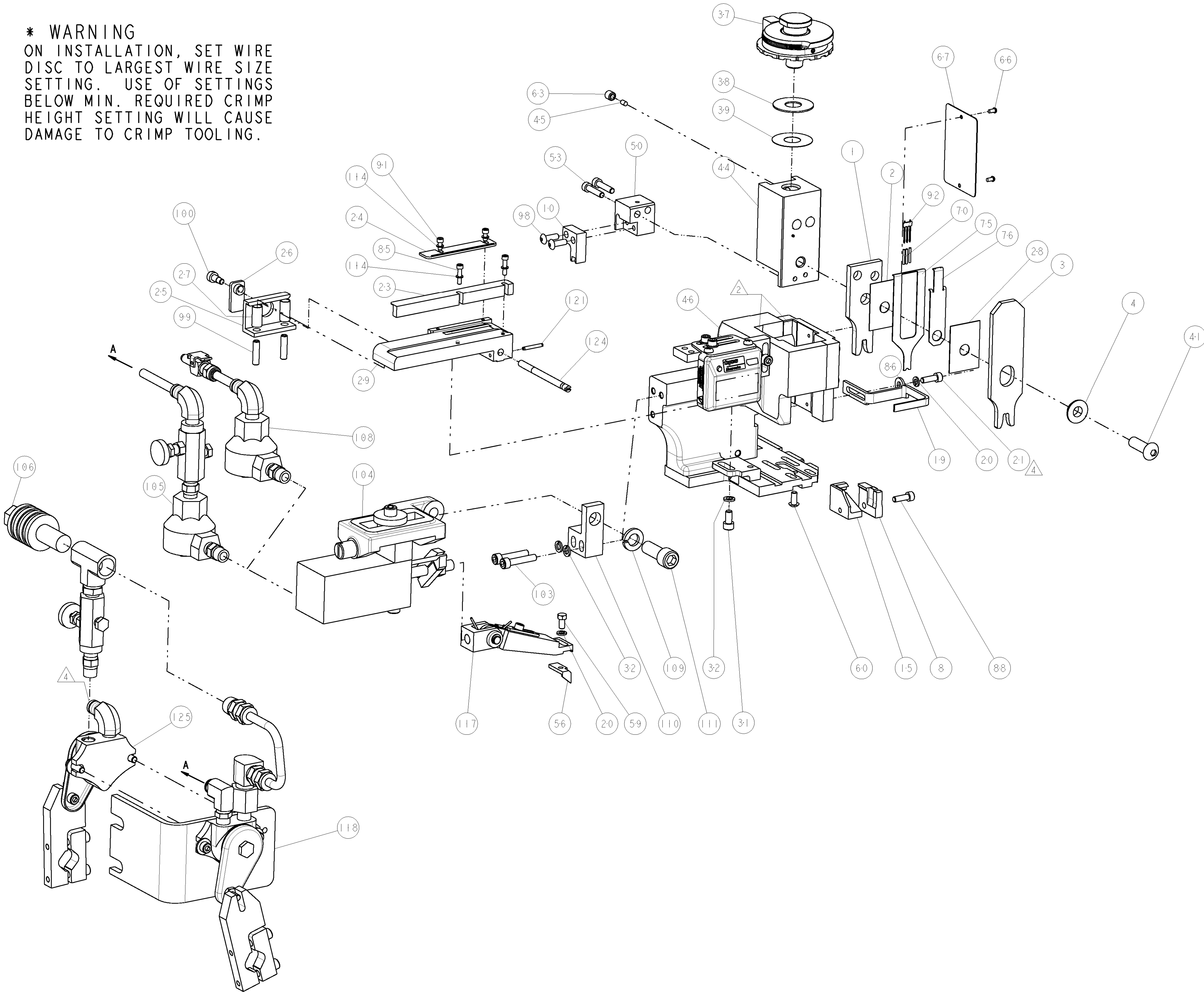

TERMINAL NAME: TERMINAL, RING		DELPHI TERM - DELPHI CRIMP SPECS		REF SETTING
TYCO PN	MFR PN			
1949338	2977618			
-	-	CRIMP HEIGHT	WIRE SIZE	
-	-	2.75±0.05mm [.108±.002]	2.0mm2	B3
-	-	2.64±0.05mm [.104±.002]	1.50mm2	B9
-	-	2.60±0.05mm [.102±.002]	1.0mm2	C2
-	-	-	-	-
-	-	CRIMP	SIZE	TYPE
-	-	WIRE	3.71mm [.146]	F
-	-	INSUL	5.08mm [.200]	F
-	-	FEED	17.52mm	Ø 3.36-3.97mm MAX
WIRE STRIP LENGTH 5.8-6.4mm		TERM APPL SPEC NONE		SET UP GAGE 458637-1
		APPLICATOR INSTRUCTIONS 408-8040		

LOC		DIST		REV		DATE		DWN		APVD	
A	66	P	LTR	DESCRIPTION		DATE		DWN		APVD	
		A		PRODUCT RELEASE		17MAY2007		CMR		TE	

-	-	1	-	-	455350-4	AIR BLAST ASS'Y	125
-	1	1	1	-	690432-3	ADJUSTMENT SCREW	124
-	1	1	1	-	3-21028-9	PIN, SLOTTED SPRING .094 X .688	121
-	18	24	18	IN	27319-4	TUBING, POLY-FLO, NATURAL	119
-	-	1	-	-	692655-6	AIR FEED VALVE ASSEMBLY	118
-	1	1	1	-	461062-1	FEED FINGER ASSEMBLY	117
-	REF	-	-	..	455749-1	GUARD WINDOW	116
-	REF	-	-	..	679532-1	INSERT, GUARD	115
-	4	4	4	-	21024-2	WASHER, SPRG LOCK, REG NO 4	114
-	1	1	1	-	3-21001-5	SCR, SKT HD CAP 3/8-16 X 1.000	111
-	1	1	1	-	459610-1	MOUNT, FEED BRACKET	110
-	1	1	1	-	21024-8	WASHER, SPRG LOCK, REG 3/8	109
-	1	1	1	-	692655-7	AIR FEED VALVE ASSEMBLY	108
-	-	1	-	-	24042-2	VALVE, SLEEVE, 3-WAY	106
-	-	1	-	-	692655-5	AIR FEED VALVE ASSEMBLY	105
-	1	1	1	-	461065-1	ASSEMBLY, AIR FEED	104
-	2	2	2	-	3-21000-9	SCR, SKT HD CAP 10-32 X 1.000	103
-	1	1	1	-	986220-3	CLAMP, CABLE, BLACK	102
-	1	-	1	-	23238-1	INSERT, COUPLING	101
-	1	1	1	-	22353-8	SCR, SHLD, SLOT HD, 3/16 DIA	100
-	2	2	2	-	5-21006-6	SCR, SET, CUP POINT 10-32 X .750	99
-	2	2	2	-	2-21002-2	SCR, BTN SKT HD CAP 8-32 X .500	98
-	1	1	1	-	1424350-1	HOLDER, PIN, WIRED	92
-	2	2	2	-	1-21000-3	SCR, SKT HD CAP 4-40 X .250	91
-	1	1	1	-	2-21000-7	SCR, SKT HD CAP 8-32 X .500	88
-	1	1	1	-	21055-7	WASHER, FLAT, REG NO 10	86
-	2	2	2	-	1-21000-5	SCR, SKT HD CAP 4-40 X .500	85
-	1	1	1	-	1490524-1	DEPRESSOR, SPACER	76
-	1	1	1	-	1490525-3	DEPRESSOR, WIRE	75
-	1	1	1	-	4088040	SF APPL INST 408-8040	72
-	1	1	1	-	217238-1	GENERAL INSTRUCTION PKG	71
-	3	3	3	-	2-23147-2	SPRING, COMPRESSION	70
-	1	1	1	-	461264-5	PLATE, IDENTIFICATION	67
-	2	2	2	-	21017-2	SCREW, DRIVE	66
-	1	1	1	-	21009-2	SCR, SET, SELF LOCKING 1/4-20 X .250	63
-	1	1	1	-	22733-8	SCR, BHSC, SELF-LOCKING, 8-32 X .375	60
-	1	1	1	-	2-22603-0	SCR, HEX HD CAP 8-32 X .312	59
-	1	1	1	-	3-694433-9	FEED PAWL	56
-	2	2	2	-	2-21000-9	SCR, SKT HD CAP 8-32 X .750	53
-	1	1	1	-	1583893-6	HOLDER, SLUG BLADE	50
-	1	1	1	-	1633399-1	APPL., BASIC AIR FEED SUB ASSY	46
-	1	1	1	-	690191-1	PLUG, NYLON	45
-	1	1	1	-	1-455673-4	RAM, SIDE FEED	44
-	1	1	1	-	7-21002-9	SCR, BTN SKT HD CAP 5/16-24 X 1.00	41
-	1	1	1	-	690125-1	SHIM SUB-ASSY	39
-	1	1	1	-	469367-7	SHIM	38
-	1	1	1	-	879103-2	FINE ADJUST HEAD ASSEMBLY	37
-	3	3	3	-	21024-5	WASHER, SPRG LOCK, REG NO 10	32
-	1	1	1	-	3-21000-4	SCR, SKT HD CAP 10-32 X .375	31
-	1	1	1	-	3-844048-4	PLATE, REAR STRIP GUIDE	29
-	1	1	1	-	455888-4	SPACER, CRIMPER	28
-	2	2	2	-	22281-9	SPRING, COMPRESSION	27
-	1	1	1	-	356835-1	LEVER, DRAG RELEASE	26
-	1	1	1	-	240792-1	DRAG, TERMINAL	25
-	1	1	1	-	1-690438-5	FRONT STRIP GUIDE	24
-	1	1	1	-	1-189124-1	GUIDE, FRONT STRIP	23
-	1	1	1	-	2-21000-7	SCR, SKT HD CAP 8-32 X .500	21
-	2	2	2	-	21024-4	WASHER, SPRG LOCK, REG NO 8	20
-	1	1	1	-	1-456468-1	STRIPPER, SPECIAL	19
-	1	1	1	-	1-1633124-2	PLATE, REAR SHEAR	15
-	1	1	1	-	1583859-8	BLADE, SLUG	10
-	1	1	1	-	1-1633507-0	ANVIL, SPECIAL, COMBINATION	8
-	1	1	1	-	3-238009-3	BLOCK, FL CRIMPER SPACER	4
-	1	1	1	-	6-1213077-0	CRIMPER, INSULATION PREMIUM	3
-	1	1	1	-	455888-3	SPACER, CRIMPER	2
-	1	1	1	-	8-1633305-7	CRIMPER, WIRE PREMIUM	1

DIMENSIONS:		TOLERANCES UNLESS OTHERWISE SPECIFIED:		DWN		APVD		NAME		SCALE		SHEET		REV	
INCHES		9 PLC ±.01		10 PLC ±.01		11 PLC ±.01		12 PLC ±.01		13 PLC ±.01		14 PLC ±.01		15 PLC ±.01	
MATERIAL		FINISH		WEIGHT		CUSTOMER DRAWING		SCALE		SHEET		REV		A	
1		2		3		4		5		6		7		8	

CUSTOMER VIEWABLE ASSEMBLY

Mouser Electronics

Authorized Distributor

Click to View Pricing, Inventory, Delivery & Lifecycle Information:

[TE Connectivity:](#)

[1855259-1](#)