

E-Series Surface Mount Power Divider 1-2700 MHz

Rev. V2

Features

- 2 Way 50Ohm
- Surface Mount
- 0 Degree
- Broad Band performance

Description

MAPD-008957-CT0012 is a RoHS compliant 2 Way 0° Power Divider in a low cost, surface mount package.

Schematic

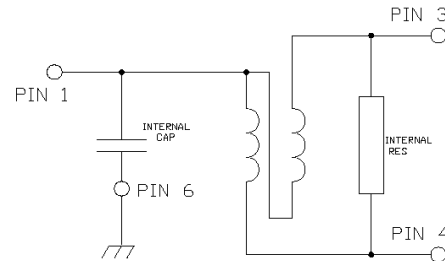

Product Image

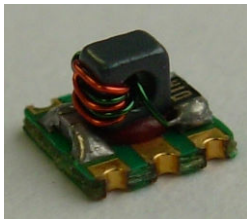

Component Dimensions

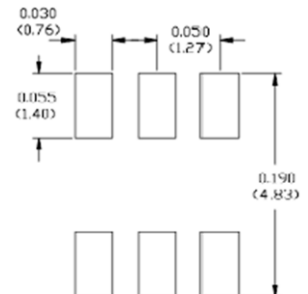
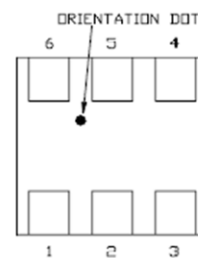
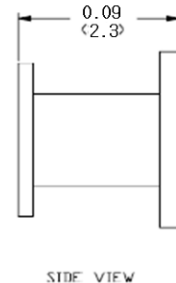
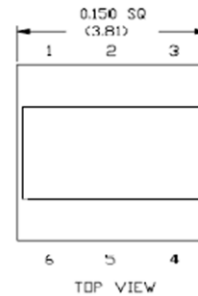

Pin Configuration

Pin No.	Function
1	Input
2	Not Used (GND)
3	Output Port1
4	Output Port2
5	Not Used (GND)
6	Ground

* Dimensions are inches (millimeters) ± 0.015 (0.38) unless otherwise specified.

E-Series Surface Mount Power Divider
1-2700 MHz

Rev. V2

Electrical Specifications: $T_A = 25^{\circ}\text{C}$, $Z_0 = 50\Omega$

Parameter	Frequency (MHz)	Units	Min	Typ	Max
Insertion Loss (Above 3dB)	1 - 1800	dB	—	0.8	1.3
	1800-2700	dB	—	1.3	2.0
Isolation	1 - 2000	dB	9	10	20
	2000-2400	dB	13	20	30
	2400-2700	dB	10	11	—
Amplitude Balance	1 - 2500	dB	—	0.5	1.0
	2500-2700	dB	—	1.0	1.5
Phase Balance	1 - 2700	deg	—	2	8
Input Return Loss	1 - 1200	dB	9	10	—
	1200-2400	dB	12	15	25
	2400-2700	dB	6	10	12
Output Return Loss	1 - 1800	dB	20	25	32
	1800-2700	dB	16	23	32

Absolute Maximum Ratings ^{1,2}

Parameter	Absolute Maximum
RF Power	250 mW
Internal Load Dissipation	50 mA
Operating Temperature	-40°C to +80°C
Storage Temperature	-55°C to +125°C

- Exceeding any one or combination of these limits may cause permanent damage to this device.
- M/A-COM does not recommend sustained operation near these survivability limits.

Typical Performance Curves

Insertion Loss

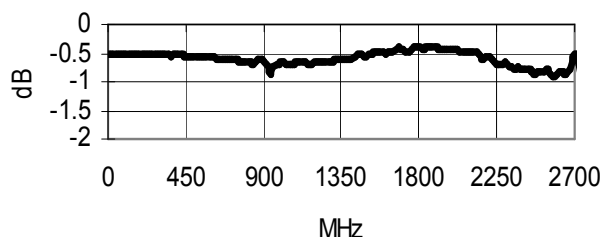

Amplitude Unbalance

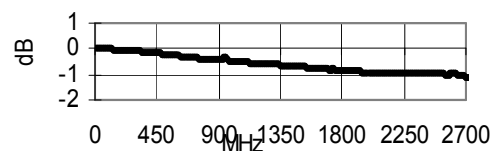

Phase Unbalance

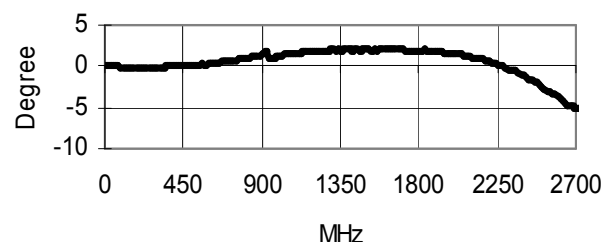

Input Return Loss

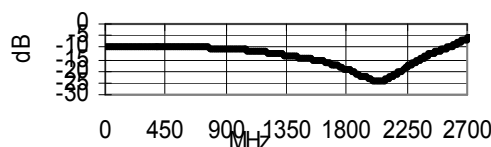

Output Return Loss

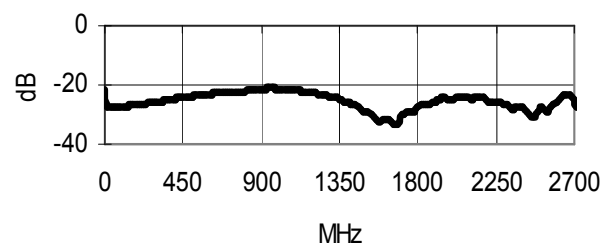

Isolation

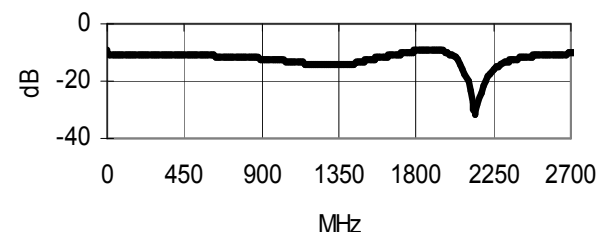

E-Series Surface Mount Power Divider 1-2700 MHz

Rev. V2

Tape & Reel Information

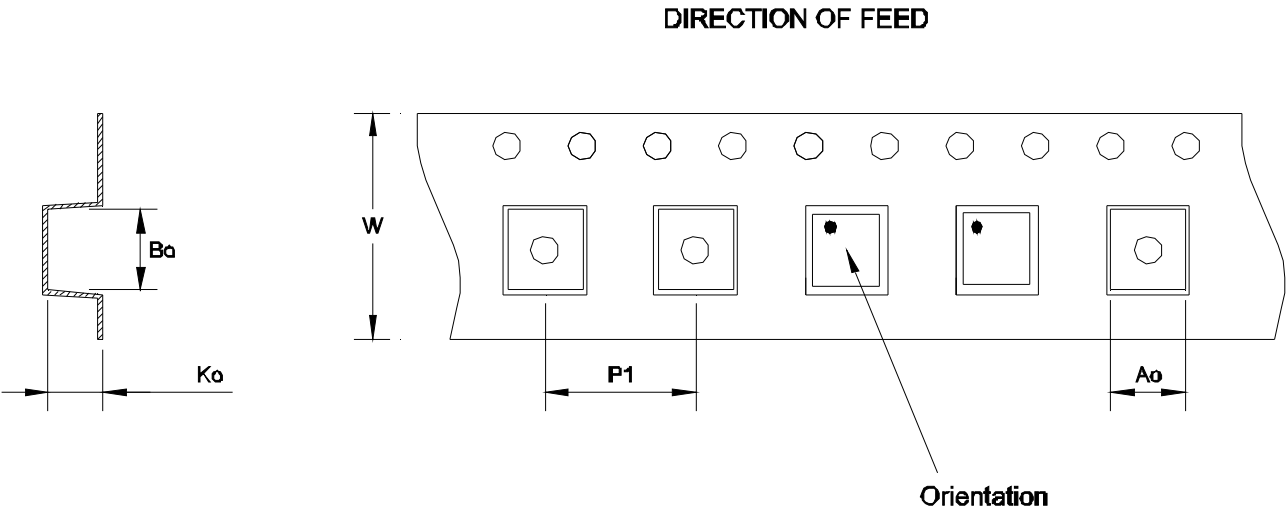

Item	Dimension
Ao	4.0mm +/-0.1mm
Bo	4.1mm +/-0.1mm
Ko	2.7mm +/-0.1mm
W	12.00mm +/-0.3mm
P1	8.00mm +/-0.1mm

Ordering Information

Part Number	Package
MAPD-008957-CT0012	Tape and Reel (2000 piece Reel)

Mouser Electronics

Authorized Distributor

Click to View Pricing, Inventory, Delivery & Lifecycle Information:

MACOM:

[MAPD-008957-CT0012](#)