

DESCRIPTION: POWER / SIGNAL - VERTICAL BOARD - MALE - MACHINED

## SPECIFICATIONS:

### ELECTRICAL:

INSULATOR RESISTANCE:	5 G OHMS Min.
DIELECTRIC WITHSTANDING:	1,000VAC r.m.s.
OPERATING TEMPERATURE:	-55° C ~ +125° C
POWER CONTACT RESISTANCE:	1.0 mOHMS Max.
SIGNAL CONTACT RESISTANCE:	10 mOHMS Max.
POWER PINS:	40 AMPS
SIGNAL PINS:	5 AMPS

### MECHANICAL:

CONTACT INSERTION FORCE:	4.5 Kg Max.
CONTACT SEPARATOR FORCE:	0.3Kg Min.

### MATERIALS:

CONTACTS:	COPPER ALLOY
INSULATOR:	PBT UL94V-0 RATED, BLK
SHELL:	230°C PROCESS TEMP. STEEL

### FINISH:

SHELL:	NICKEL
CONTACTS:	FULL GOLD FLASH

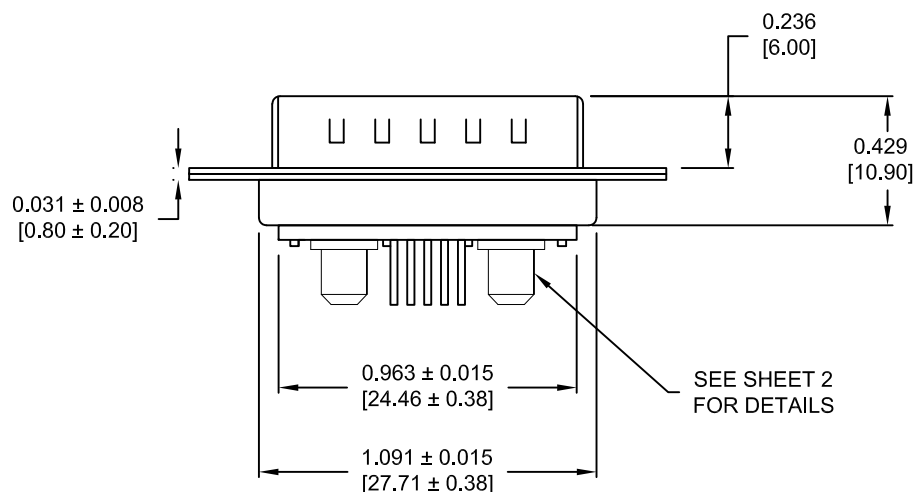
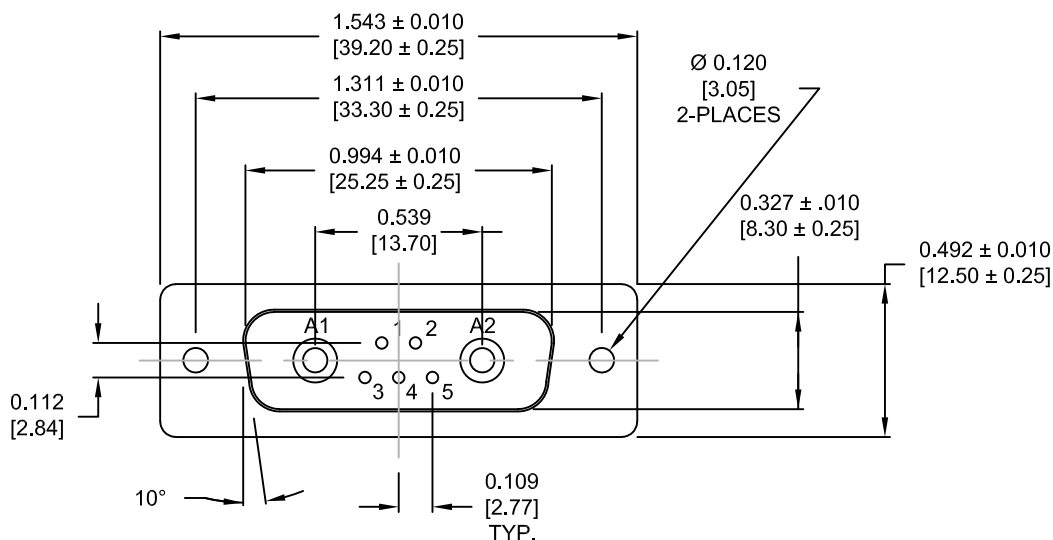

## 681M7W2103LYYY

0 = 40 AMP

0 = NO HARDWARE

1 = 0.098" CN PCB SIDE

2 = 0.236" CN PCB SIDE

3 = 0.236" CN MATING SIDE

4 = 0.237" BOARDLOCK PCB SIDE

5 = 0.224" BOARDLOCK PCB SIDE

1 = GOLD FLASH

RoHS COMPLIANT

UNITS = INCHES [MM] DO NOT SCALE FROM DRAWING



THESE DRAWINGS AND SPECIFICATIONS ARE THE PROPERTY OF NorComp AND SHALL NOT BE REPRODUCED, COPIED OR USED AS THE BASIS FOR THE MANUFACTURE OR SALE OF APPARATUS WITHOUT WRITTEN PERMISSION.

DRAWN:

P. JENKINS

DATE:

08/22/2011

NorComp

SCALE:

NTS

SHEET

1

OF

3

REV

1

DWG NO.

681M7W2103LYYY

DESCRIPTION: 681 SERIES CONTACTS

NOTE:  
SIGNAL AND POWER CONTACTS  
COME PRE-LOADED INTO INSULATORS

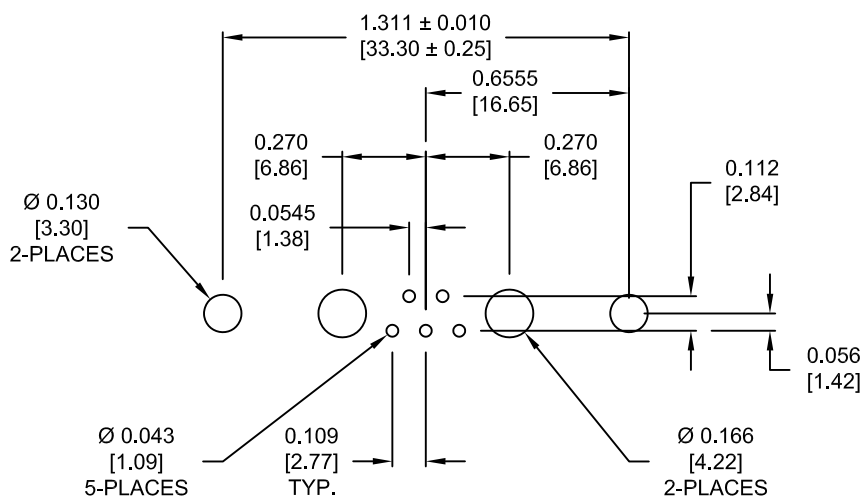

RECOMMENDED PCB LAYOUT  
TOLERANCE  $\pm 0.002$  [0.05]

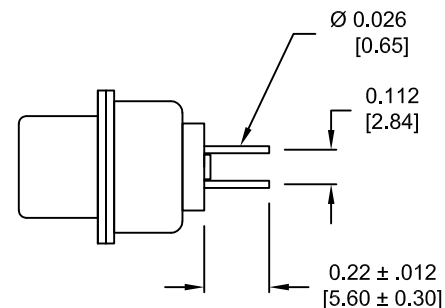

SIGNAL CONTACTS

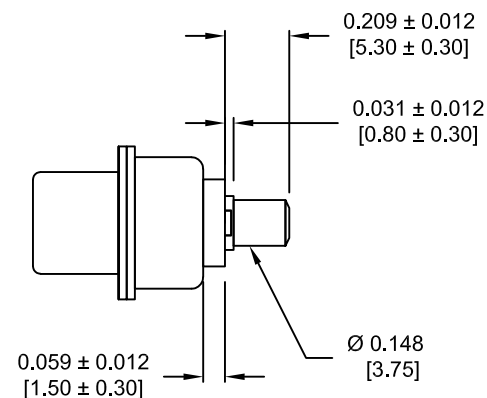

POWER CONTACTS

RoHS COMPLIANT

UNITS = INCHES [MM] DO NOT SCALE FROM DRAWING



THESE DRAWINGS AND SPECIFICATIONS ARE THE PROPERTY OF NorComp AND SHALL NOT BE REPRODUCED, COPIED OR USED AS THE BASIS FOR THE MANUFACTURE OR SALE OF APPARATUS WITHOUT WRITTEN PERMISSION.

DRAWN:  
P. JENKINS  
DATE:  
08/22/2011

NorComp

SCALE: NTS  
SHEET 2 OF 3  
REV 1  
DWG NO. 681M7W2103LYYY

DESCRIPTION: CLINCH NUT HARDWARE

ALL CLINCH-NUTS ARE 4-40 INTERNAL THREADS

TOLERANCE:  
ALL DIMENSIONS ARE  $\pm 0.010$

0 ..... NO HARDWARE

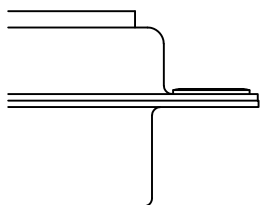

2 ..... 0.236" PCB SIDE

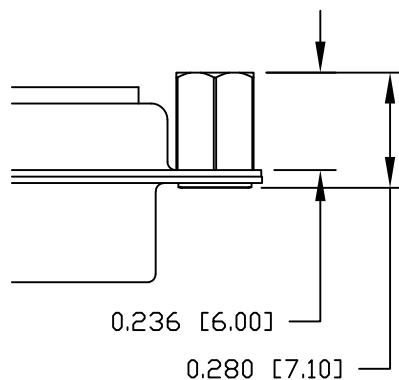

4 ..... 0.237" PCB SIDE

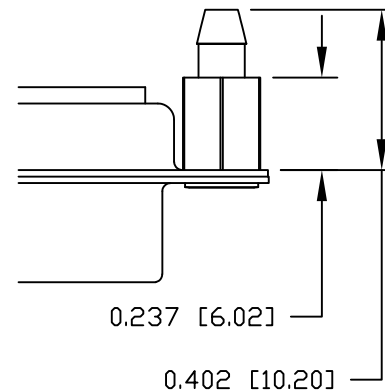

1 ..... 0.098" PCB SIDE

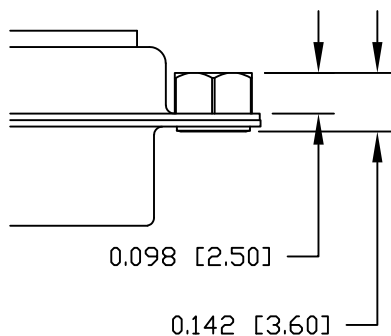

3 ..... 0.236" MATING SIDE

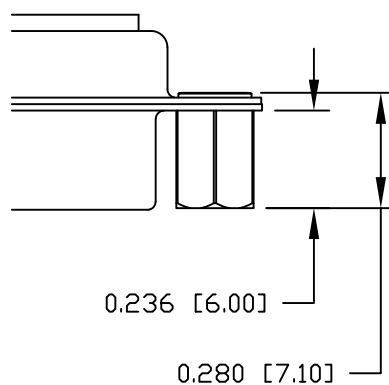

5 ..... 0.224" PCB SIDE

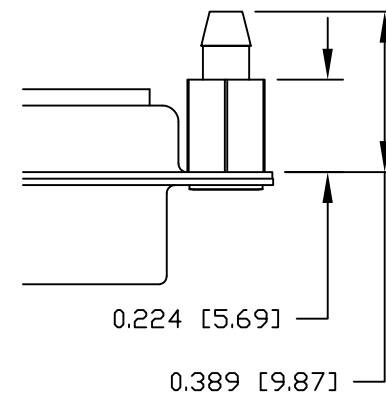

RoHS COMPLIANT



THESE DRAWINGS AND SPECIFICATIONS ARE THE PROPERTY OF NorComp AND SHALL NOT BE REPRODUCED, COPIED OR USED AS THE BASIS FOR THE MANUFACTURE OR SALE OF APPARATUS WITHOUT WRITTEN PERMISSION.

DRAWN:

P. JENKINS

DATE:

08/22/2011

UNITS = INCHES [MM]

DO NOT SCALE FROM DRAWING

NorComp

SCALE:

NTS

SHEET

3

OF

3

REV

1

DWG NO.

681M7W2103LYYY