

- NOTES:
1. TOLERANCES UNLESS OTHERWISE SPECIFIED: ±0.15
 2. FOR APPLICATION INFORMATION SEE AMP SPEC. 114-19019.
 3. FOR PERFORMANCE REQUIREMENTS SEE AMP SPEC. 108-19064

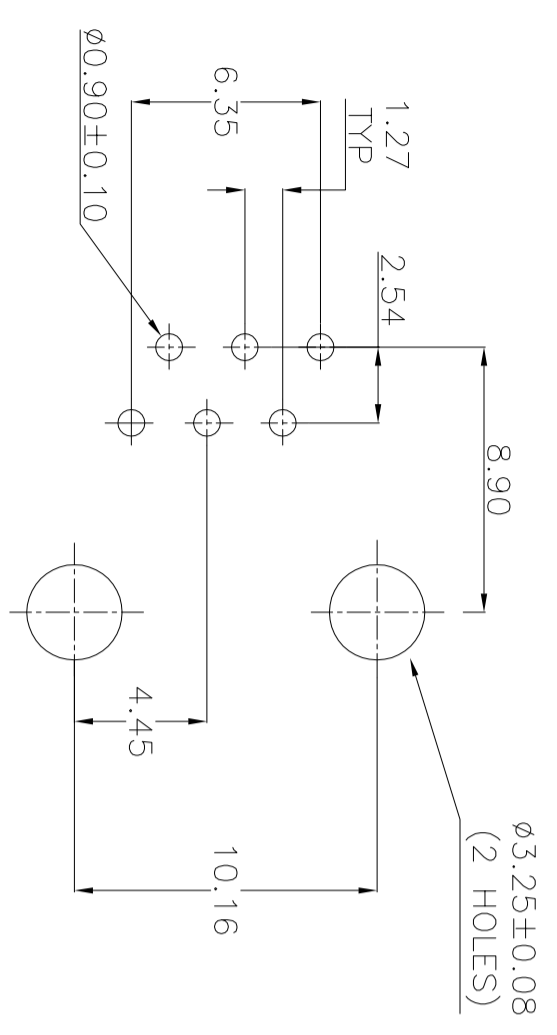
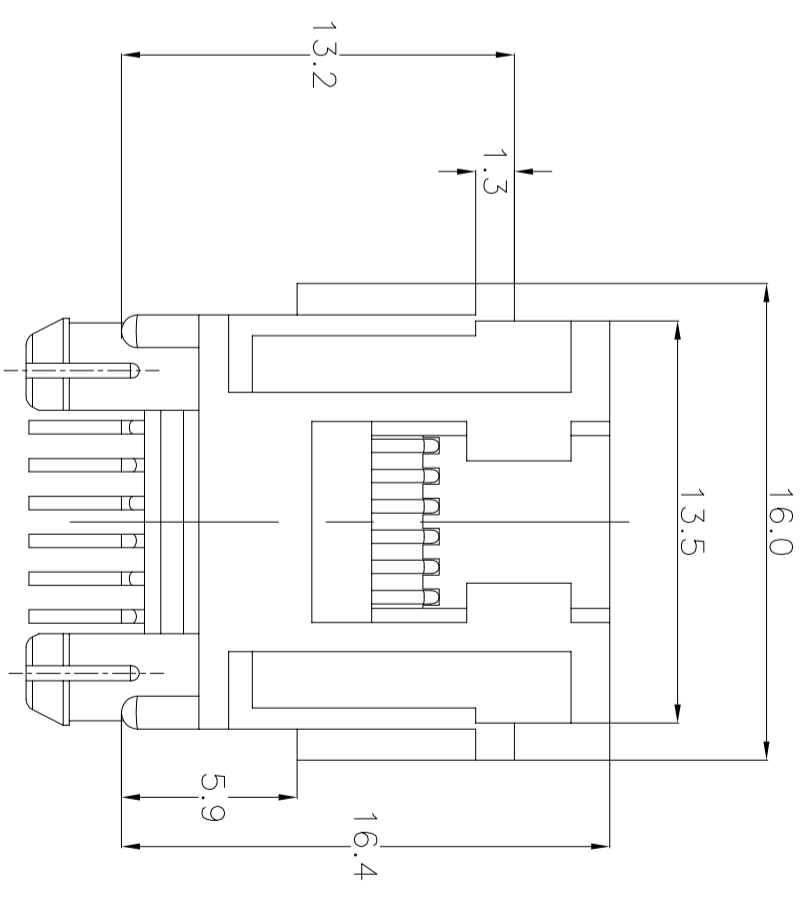
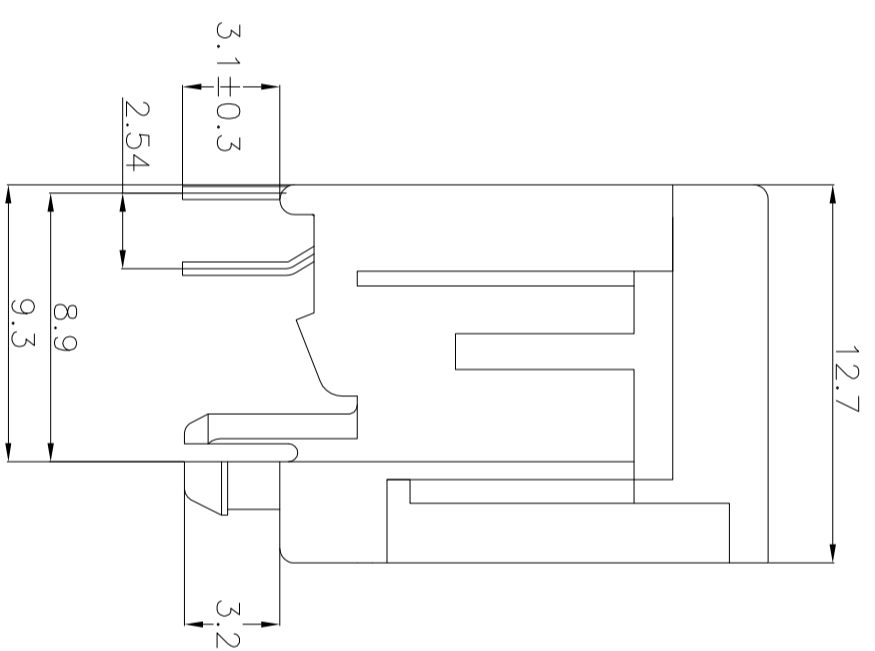
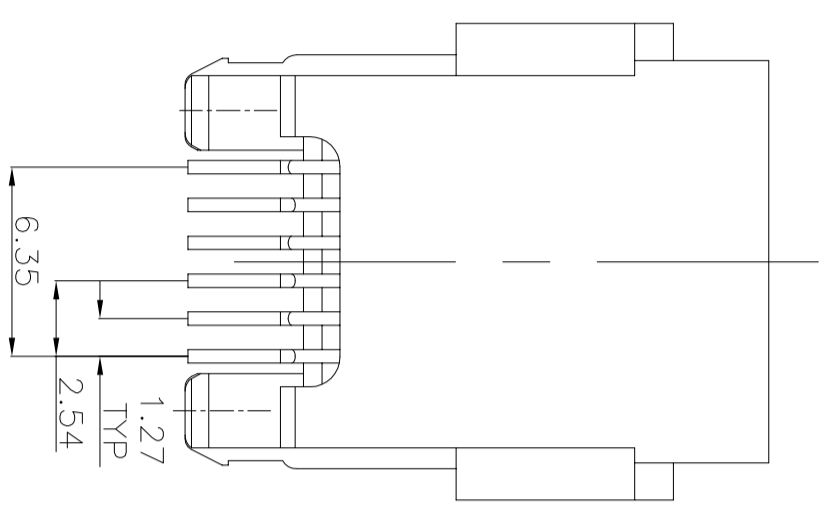
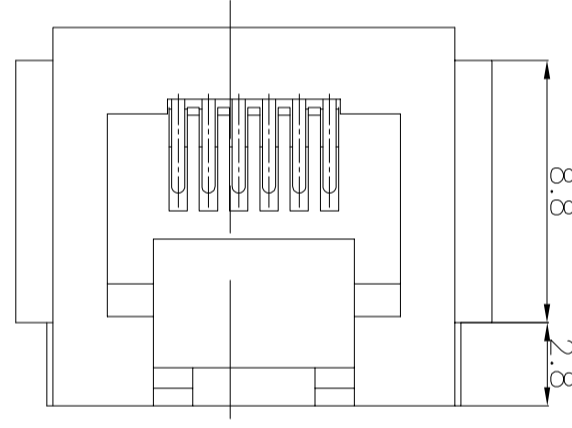

PRINTED CIRCUIT BOARD LAYOUT

[VIEW SHOWN IS CIRCUIT (NONCOMPONENT) SIDE OF BOARD.]
TOLERANCES UNLESS OTHERWISE SPECIFIED: ±0.05
PRINTED CIRCUIT BOARD THICKNESS: 1.6 mm NOMINAL.

LOC		DIST		REVISIONS			
	H			DESCRIPTION	DATE	BY	APP'D
P		LTR		J4 ECR-14-008810	12JUN14	CW	SH
				J5 ECO-15-014053	24SEP2015	AD	SH
				J6 ECO-16-004330	24MAR2016	AD	SH

THIS DRAWING IS A CONTROLLED DOCUMENT.	DMN	22JAN92	NAME	TE Connectivity	PART NUMBER	216548-1
800 PCS. ON A 60cm. DIA. REEL	IN CONTACT AREA: 1.2µm MIN. SEL. GOLD OVER 1.2µm MIN. NICKEL	HOUSING: PBT, UL 94V-HB COLOR: BLACK	FINISH	SOLDER TINNES: 2.0µm MIN. TIN OVER 1.2µm MIN. NICKEL	CONTACTS: PHOSPHOR BRONZE	
PACKAGING	REMARKS	6 POSITIONS/ 6 CONTACTS.	MATERIAL			

DIMENSIONS: mm		TOLERANCES UNLESS OTHERWISE SPECIFIED:		APPROVALS		DRAWING NO.	
0 PLC	±	1 PLC	±	DMN	22JAN92	NAME	TE Connectivity
2 PLC	±	2 PLC	±	CHK	C STERKEN	PRODUCT SPEC	MODULAR JACK, 6 POS. TOP ENTRY, SMALL SIZE WITH PANEL STOPS, FOR PRINTED CIRCUIT BOARDS
3 PLC	±	3 PLC	±	APP	L V SOEST	APPLICATION SPEC	
4 PLC	±	4 PLC	±	SCALE		WEIGHT	
FINISH	±	FINISH	±	CUSTOMER DRAWING		SIZE	A2
SEE TABLE		SEE TABLE		SCALE		CODE	00779
						DRAWING NO.	216548
						RESTRICTED TO	

216548

LOC	DIST	REV	DESCRIPTION	DATE	DWN	APP'D
H	-	P	SEE SHEET 1/3			

- NOTES:
1. TOLERANCES UNLESS OTHERWISE SPECIFIED: ±0.15
 2. FOR APPLICATION INFORMATION SEE AMP SPEC. 114-19019.
 3. FOR PERFORMANCE REQUIREMENTS SEE AMP SPEC. 108-19064

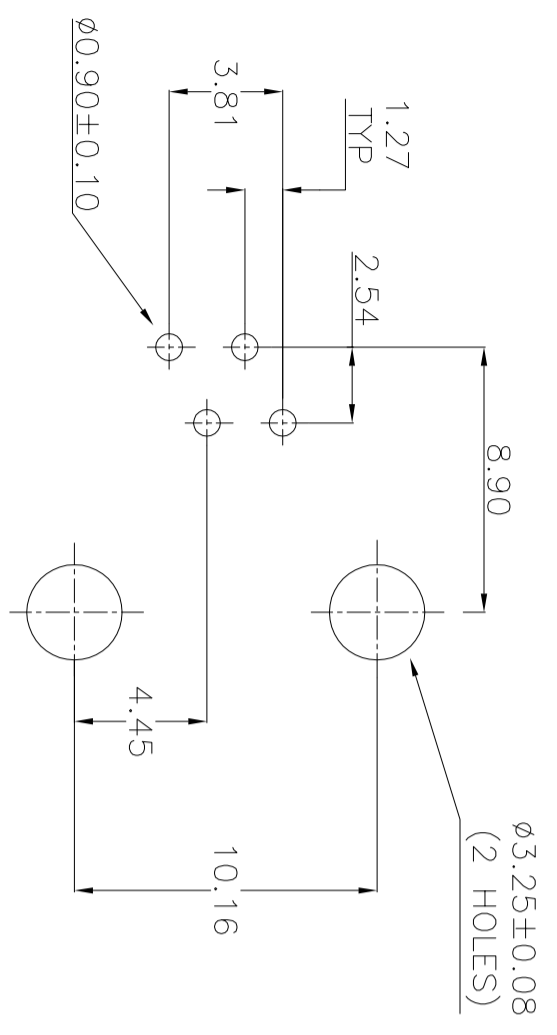
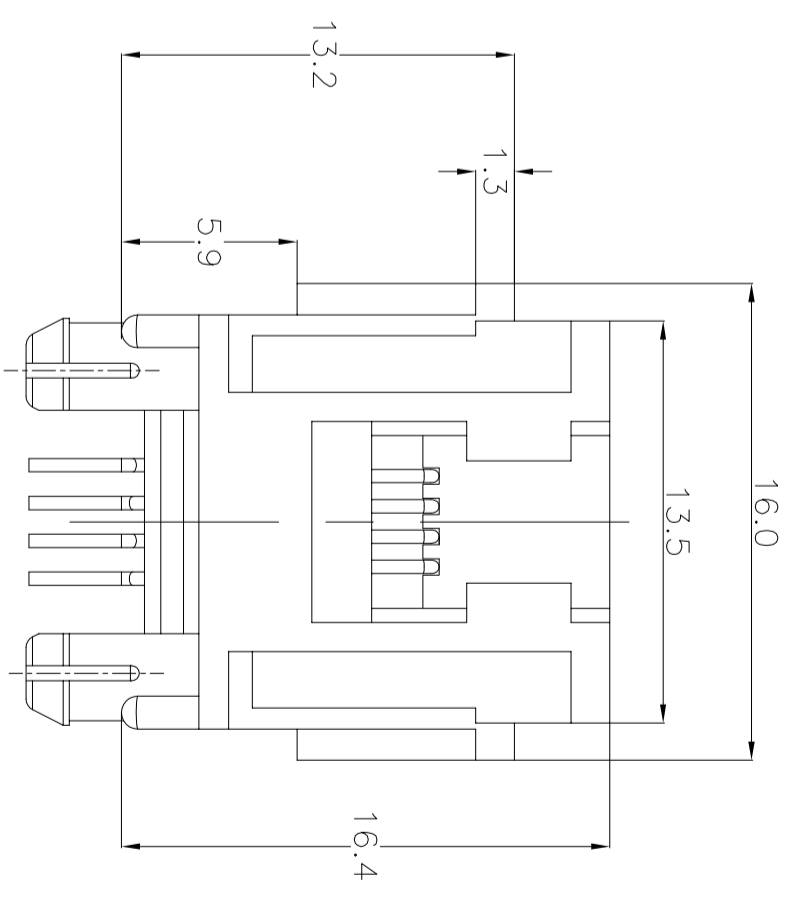
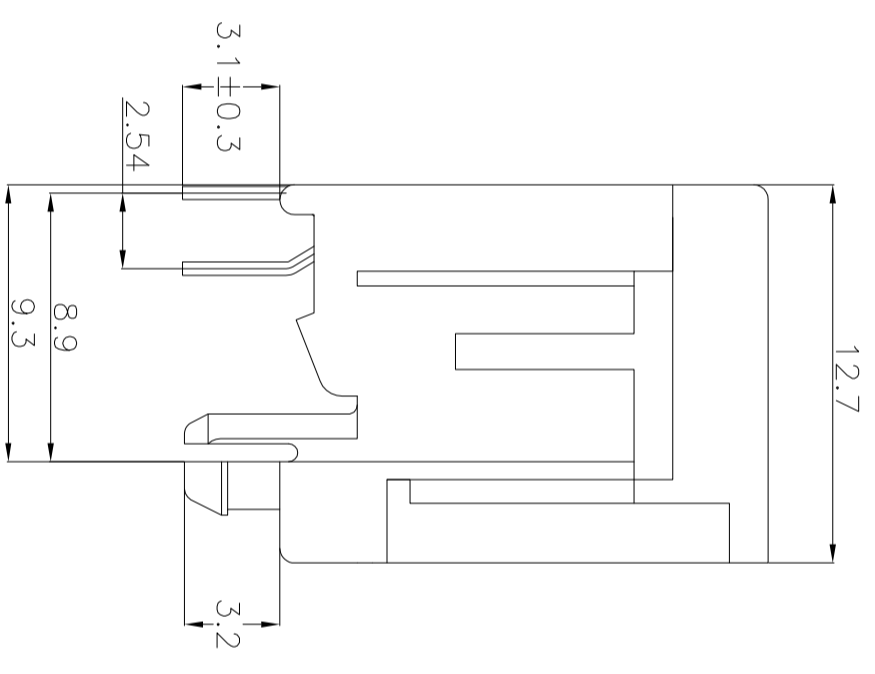
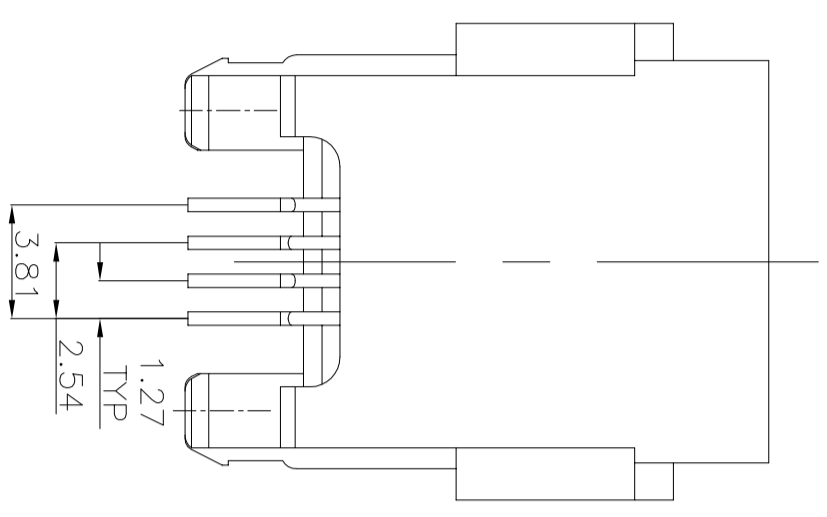
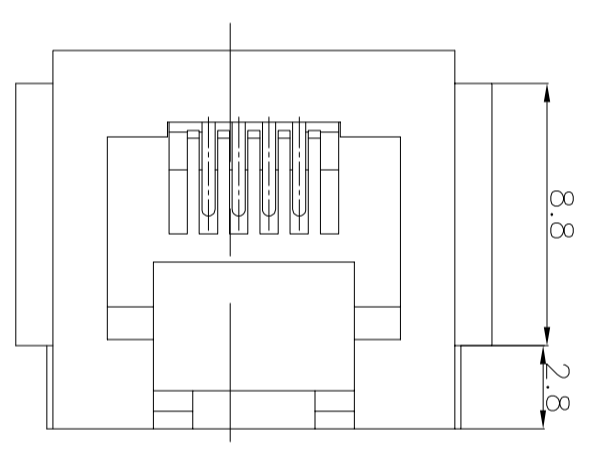

PRINTED CIRCUIT BOARD LAYOUT

[VIEW SHOWN IS CIRCUIT (NONCOMPONENT) SIDE OF BOARD.]
 TOLERANCES UNLESS OTHERWISE SPECIFIED: ±0.05
 PRINTED CIRCUIT BOARD THICKNESS: 1.6 mm NOMINAL.

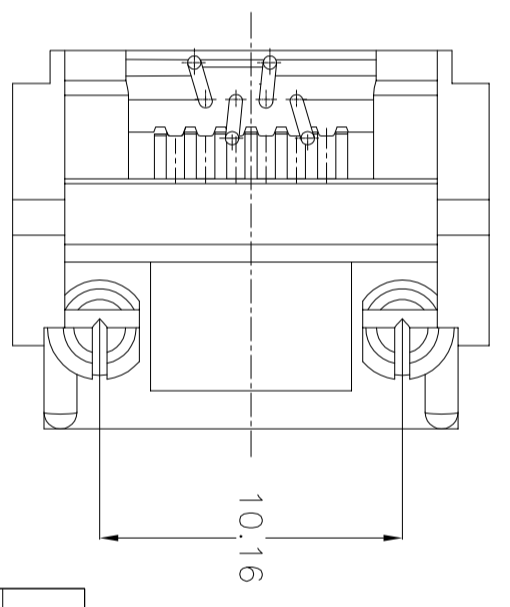

800 PCS. ON A 60cm. DIA. REEL	6 POSITIONS/ 4 CONTACTS.	IN CONTACT AREA: 1.2µm MIN. SEL. GOLD OVER 1.2µm MIN. NICKEL	HOUSING: PBT, UL 94V-HB COLOR: BLACK	PART NUMBER 216548-2
PACKAGING	REMARKS	FINISH	MATERIAL	
		SOLDER TINNES: 2.0µm MIN. TIN OVER 1.2µm MIN. NICKEL	CONTACTS: PHOSPHOR BRONZE	

THIS DRAWING IS A CONTROLLED DOCUMENT.

DIMENSIONS:	TOLERANCES UNLESS OTHERWISE SPECIFIED:
0 PLC	±
1 PLC	±
2 PLC	±
3 PLC	±
4 PLC	±
ANGLES	±
FINISH	±

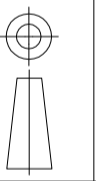

APPROVED	DATE	BY	SCALE	SHEET	REV
DMN	22JAN92	216548	1:1	2 of 3	J6
CHK					
C					
APPROVED	DATE	BY	SCALE	SHEET	REV
DMN	22JAN92	216548	1:1	2 of 3	J6
CHK					
C					

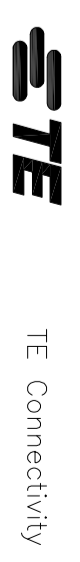

TE Connectivity

MODULAR JACK, 6 POS. TOP ENTRY,
 SMALL SIZE WITH PANEL STOPS,
 FOR PRINTED CIRCUIT BOARDS

SIZE: A2
 CODE: 00779
 DRAWING NO: 216548

LOC	DIST	REV	DESCRIPTION	DATE	DWN	APP'D
H	-	P	SEE SHEET 1/3			

- NOTES:
1. TOLERANCES UNLESS OTHERWISE SPECIFIED: ±0.15
 2. FOR APPLICATION INFORMATION SEE AMP SPEC. 114-19019.
 3. FOR PERFORMANCE REQUIREMENTS SEE AMP SPEC. 108-19064

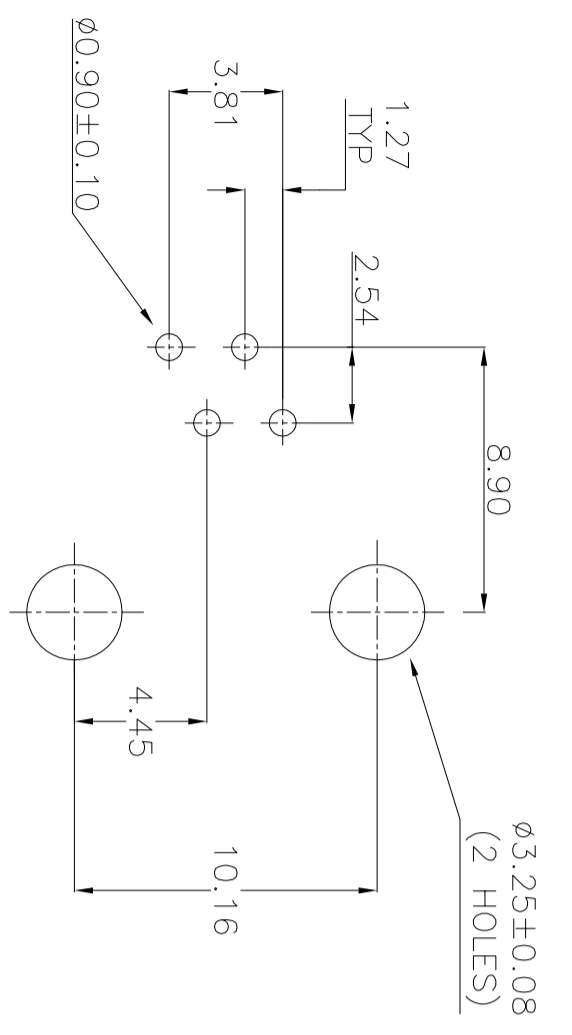
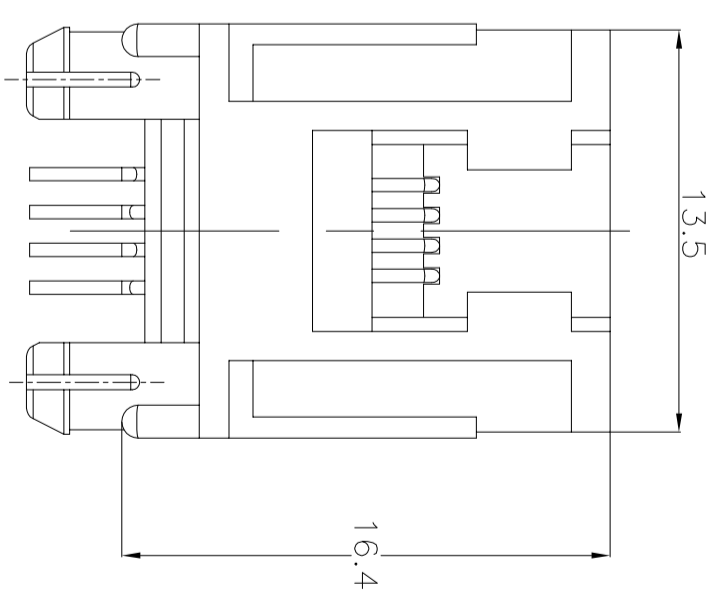
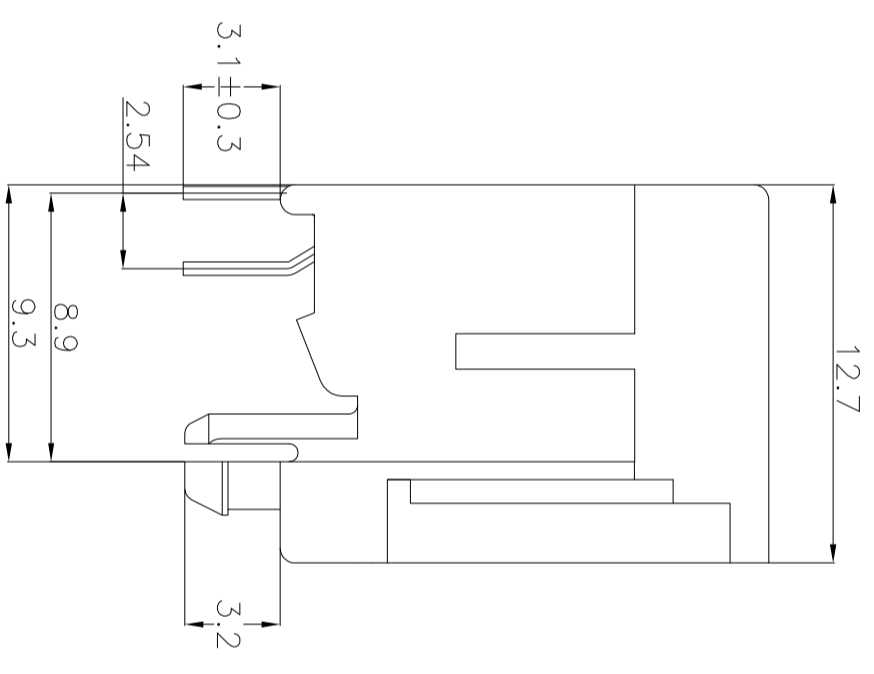
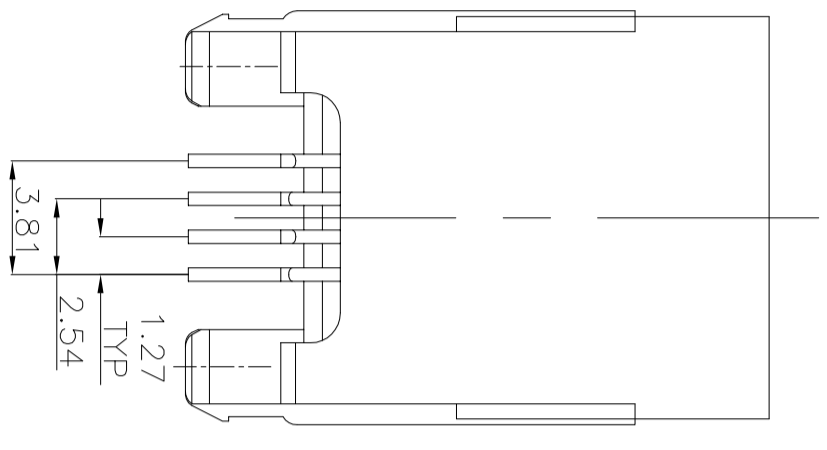
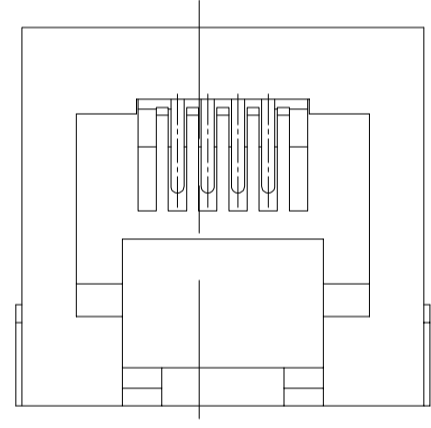

PRINTED CIRCUIT BOARD LAYOUT

[VIEW SHOWN IS CIRCUIT (NONCOMPONENT) SIDE OF BOARD.]
TOLERANCES UNLESS OTHERWISE SPECIFIED: ±0.05
PRINTED CIRCUIT BOARD THICKNESS: 1.6 mm NOMINAL.

DESCRIPTION	REMARKS	FINISH	MATERIAL	PART NUMBER
240 PCS. IN ONE TRAY	6 POSITIONS/ 4 CONTACTS.	IN CONTACT AREA: 1.2µm MIN. SEL. GOLD OVER 1.2µm MIN. NICKEL SOLDER TINES: 2.0µm MIN. TIN OVER 1.2µm MIN. NICKEL	HOUSING: PBT, UL 94V-HB COLOR: BLACK CONTACTS: PHOSPHOR BRONZE	1-216548-5
800 PCS. ON A 60cm. DIA. REEL	6 POSITIONS/ 4 CONTACTS.	IN CONTACT AREA: 1.2µm MIN. SEL. GOLD OVER 1.2µm MIN. NICKEL SOLDER TINES: 2.0µm MIN. TIN OVER 1.2µm MIN. NICKEL	HOUSING: PBT, UL 94V-HB COLOR: BLACK CONTACTS: PHOSPHOR BRONZE	216548-5

THIS DRAWING IS A CONTROLLED DOCUMENT.		DWN: 22JAN92	
DIMENSIONS: mm		CHK: C STERKEN	
TOLERANCES UNLESS OTHERWISE SPECIFIED:		NAME: -	
0 PLC	±	MODULAR JACK, 6 POS. TOP ENTRY, SMALL SIZE WITHOUT PANEL STOPS, FOR PRINTED CIRCUIT BOARDS	
1 PLC	±	APPLICATION SPEC	
2 PLC	±	DRAWING NO	
3 PLC	±	CAGE CODE	
4 PLC	±	A2 00779	
ANGLES	±	SCALE	
FINISH	±	216548	
MATERIAL	SEE TABLE	SHEET 3 of 3	
SEE TABLE	SEE TABLE	REV J6	

216548

Mouser Electronics

Authorized Distributor

Click to View Pricing, Inventory, Delivery & Lifecycle Information:

[TE Connectivity:](#)

[216548-1](#)