





















Tous droits strictement reserves. Reproduction ou communication a des tiers interdite sous quelque forme que ce soit sans autorisation écrite du propriétaire. Propriete de c FCI. Droits de reproduction FCI.



All rights strictly reserved. Reproduction or issue to third parties in any form whatever is not permitted without written authority from the proprietor. Property of FCI. Copyright FCI.

CODE	DIM "M" MATING LENGTH	CONTACT TYPE
PA	[N/A]	POWER
E	[6.86]	SIGNAL
HA	[N/A]	HOLD-DOWN

PRODUCT NO.	ROWS	POWER						SIGNAL					POWER						E2		
		E1	P1	P2	P3	P4	P5	P6	1	2	3	4	5	P7	P8	P9	P10	P11		P12	
51952-077 -- NOTE: 3	D C B A																				

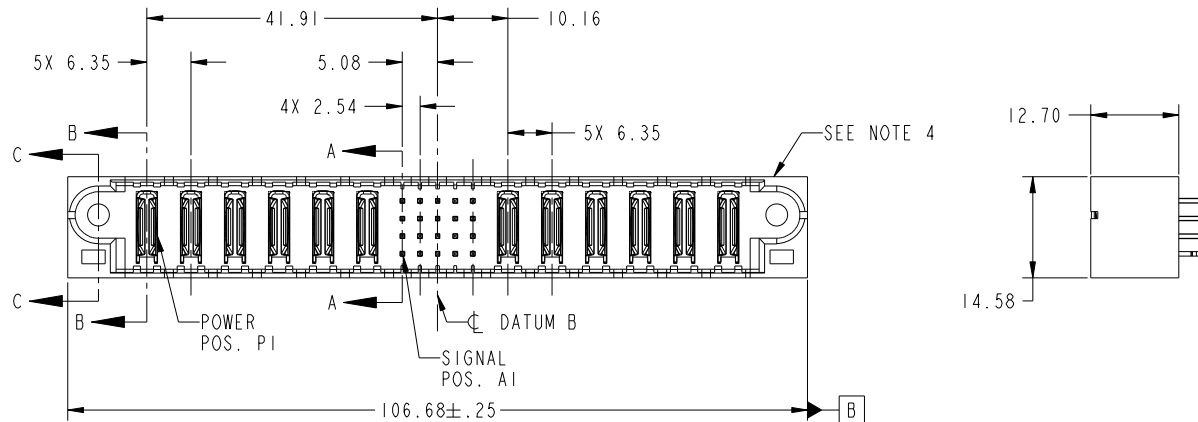

mat'l code				SEE NOTE		tolerances unless otherwise specified		CUSTOMER		FCI	
ltr	ecn no.	dr	date					COPY		www.fciconnect.com	
A	DG05-0331	GuoJM	09/14/05	linear		0.X ±0.5		projection		title	
B	DG05-0563	RYAN	12/26/05			0.XX ±0.25				6P + 20S + 6P VERTICAL STB HEADER	
C	DG07-0498	JW	09/12/08	angles		0.XXX ±0.10				product family	
						0° ±2°		scale		PwrBlade	
				dr	JM Guo	09/14/05				code	
				enrg	SLUO	09/14/05				213	
				chr	VICTOR LIN	09/14/05				sheet	
				appd	JOSEPH HSIA	09/14/05				1 of 4	
sheet index	revision	C	C	C	C						
	sheet	1	2	3	4						

cage code 22526

Tous droits strictement reserves. Reproduction ou communication a des tiers interdite sous quelque forme que ce soit sans autorisation écrite du propriétaire. Propriete de c FCI. Droits de reproduction FCI.



All rights strictly reserved. Reproduction or issue to third parties in any form whatever is not permitted without written authority from the proprietor. Property of FCI. Copyright FCI.

PRODUCT NUMBER
51952-077--
NOTE: 3

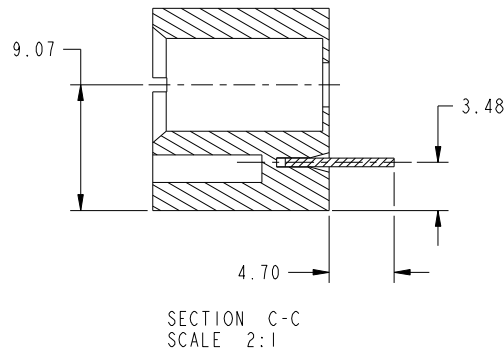
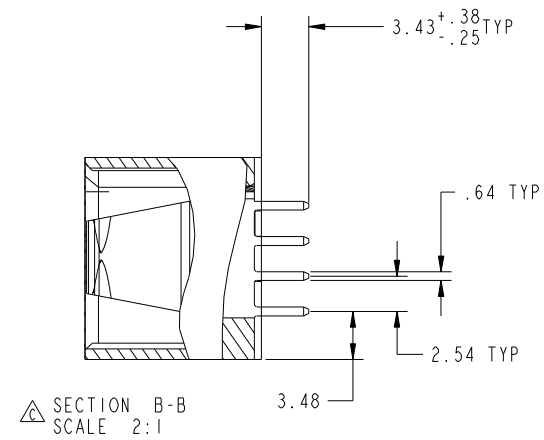
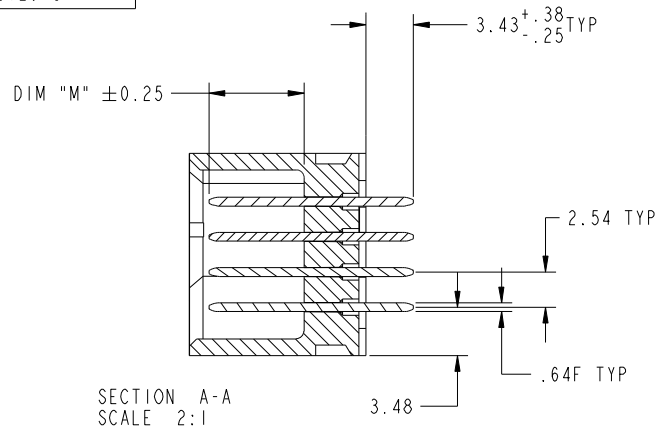

mat'l code				SEE NOTE		tolerances unless otherwise specified		CUSTOMER		www.fciconnect.com	
litr	ecn no.	dr	date	linear		0.X ±0.5		COPY		title 6P + 20S + 6P VERTICAL STB HEADER	
C						0.XX ±0.25		projection			
						0.XXX ±0.10					
				angles		0° ±2°				product family	PwrBlade
				dr	JM Guo	09/14/05				code	213
				enr	SLUO	09/14/05				size	2
				chr	VICTOR LIN	09/14/05		scale	1:1	dwg no	51952-077
				appd	JOSEPH HSIA	09/14/05				sheet	2
sheet index	revision sheet										
										cage code	22526

Pro/E

Tous droits strictement reserves. Reproduction ou communication a des tiers interdite sous quelque forme que ce soit sans autorisation écrite du propriétaire. Propriete de c FCI. Droits de reproduction FCI.



All rights strictly reserved. Reproduction or issue to third parties in any form whatever is not permitted without written authority from the proprietor. Property of FCI. Copyright FCI.

PRODUCT NUMBER
51952-077--
NOTE: 3

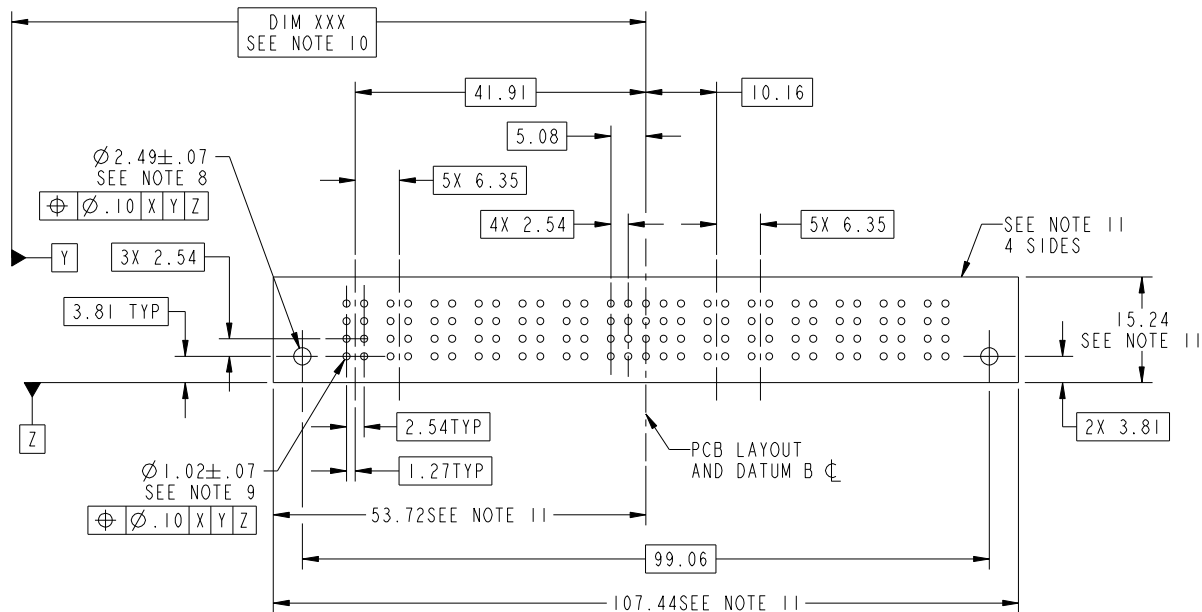

mat'l code				SEE NOTE		tolerances unless otherwise specified		CUSTOMER		FCI	
litr	ecn no.	dr	date	linear		0.X ± 0.5		COPY		www.fciconnect.com	
C						0.XX ± 0.25		projection		title	
						0.XXX ± 0.10				6P + 20S + 6P VERTICAL STB HEADER	
				angles		0° ± 2°				product family	
				dr	JM Guo	09/14/05		PwrBlade		code	
				enrg	SLUO	09/14/05		size		213	
				chr	VICTOR LIN	09/14/05		dwg no		sheet	
				appd	JOSEPH HSIA	09/14/05		scale		3	
sheet index		revision sheet						1:1		A	

Tous droits strictement reserves. Reproduction ou communication a des tiers interdite sous quelque forme que ce soit sans autorisation ecrite du proprietaire. Propriete de c FCI. Droits de reproduction FCI.



All rights strictly reserved. Reproduction or issue to third parties in any form whatever is not permitted without written authority from the proprietor. Property of FCI. Copyright FCI.

1		2		3		4	
PRODUCT NUMBER							
51952-077-- NOTE: 3							
NOTES:							
1. DIMENSIONS AND TOLERANCES ARE IN ACCORDANCE WITH ASME Y14.5M, 1994 UNLESS OTHERWISE SPECIFIED.							
CONNECTOR NOTES:							
2 HOUSING MATERIAL: UL 94 V-0 GLASS FILLED HIGH-TEMP THERMOPLASTIC POWER CONTACT MATERIAL: COPPER ALLOY SIGNAL PIN MATERIAL: COPPER ALLOY							
3. PLATING: SEE ITEM 1 & 2 IN PRINT 10064183 FOR PLATING SPEC OF 51952-077; 51952-077ILF RESPECTIVELY							
4 MANUFACTURER'S NAME, P/N, AND DATE CODE TO APPEAR ON THIS SURFACE.							
5. PRODUCT SPECIFICATION GS-12-149. APPLICATION SPECIFICATION BUS-20-067.							
6. PACKAGED IN TRAYS.							
PCB NOTES:							
7. ALL HOLE DIAMETERS ARE FINISHED HOLE SIZE.							
8. MOUNTING HOLES, WHERE APPLICABLE, ARE UNPLATED.							
9 Ø1.151±0.025 DRILLED HOLES PLATED WITH) 0.008 MIN SnPb OR Sn OVER 0.03 TO 0.08 Cu PLATING TO ACHIEVE Ø1.02±.07 HOLE.							
10 "DIM XXX" TO BE DETERMINED BY THE CUSTOMER.							
11 CONNECTOR KEEP-OUT ZONE.							
12. FOR PRESS FIT APPLICATION USE FCI CAM TOOL 430169-XXX.							
13. A SYMBOL WILL BE NEXT TO ANY DIMENSION, VIEW, OR NOTE WHICH HAS BEEN MODIFIED WITH THE CURRENT DRAWING REVISION.							
sheet index		revision sheet		tolerances unless otherwise specified		CUSTOMER	
ltr		ecn no.		dr		date	
C				linear		0.X ±0.5	
				angles		0.XX ±0.25	
				dr		0.XXX ±0.10	
				enr		0° ±2°	
				chr		JM Guo 09/14/05	
				appd		SLUO 09/14/05	
						VICTOR LIN 09/14/05	
						JOSEPH HSIA 09/14/05	
sheet index		revision sheet		scale		1:1	
				projection			
				MIM			
				size		A	
				product family		PwrBlade	
				dwg no		213	
				sheet		4	
				cage code		22526	

Pro/E

3

cage code 22526

4

Mouser Electronics

Authorized Distributor

Click to View Pricing, Inventory, Delivery & Lifecycle Information:

[FCI / Amphenol:](#)

[51952-077](#) [51952-077LF](#)