

**RATINGS:**

CURRENT: 10 AMPS  
BREAKDOWN VOLTAGE: 5700 V RMS  
CONTACT RESISTANCE: 0.004 OHMS MAX.  
CONTACT-TO-PANEL C: 2 pF NOMINAL

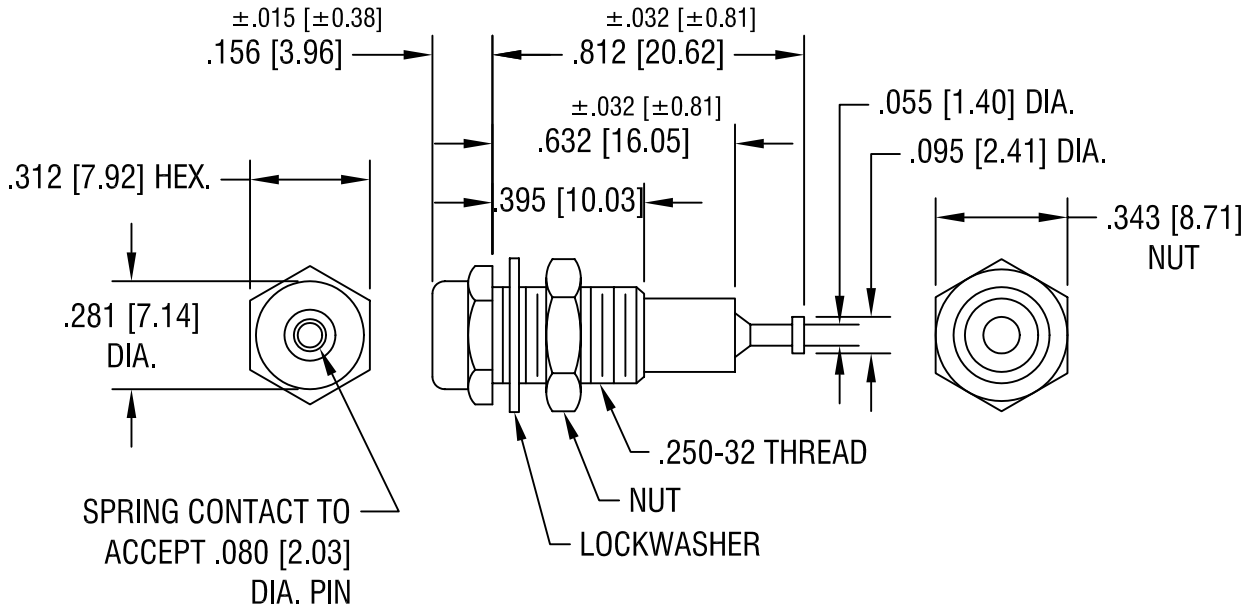

**NOTES:**

**1. CONTACT:**

MAT'L - BRASS BODY WITH WRAP  
AROUND BERYLLIUM COPPER  
GOLD PLATE

**BODY:**

MAT'L - NYLON 6/6 PER ASTM D4066

**2. SHELL, NUT/WASHER:**

BRASS, NICKEL PLATE.  
HARDWARE SUPPLIED  
UNASSEMBLED.

PART NO.	COLOR
6012	WHITE
6013	RED
6014	BLACK
6015	GREEN
6016	YELLOW
6017	BLUE

2.5.03 CHANGE AS PER ECN 03-011 A

DATE DESCRIPTION REV.

<b>KEYSTONE ELECTRONICS CORP.</b>			
ASTORIA, N.Y. 11105-2017			
PART NAME			
INSULATED METAL-CLAD TIP JACK			
MATERIAL			
AS NOTED			
FINISH		DRN BY	DATE
AS NOTED		BOONE	12.7.82
		APPD	SCALE
		LN	2X
TOLERANCES	INCH [MM]	CODE	DWG NO.
DECIMAL	± .005 [± 0.15]	C/M	<b>6012-6017</b>
ANGULAR	± 1°		
UNLESS OTHERWISE SPECIFIED			

# Mouser Electronics

Authorized Distributor

Click to View Pricing, Inventory, Delivery & Lifecycle Information:

[Keystone Electronics:](#)

[6015](#)