

21000N series

Low profile toggle switches



DISTINCTIVE FEATURES

Threaded or plain bushing, with mounting plate

Low profile

Same height for single and double pole

Wave solderable only



ELECTRICAL SPECIFICATIONS

- Max. current/voltage rating with resistive load :
 - silver contacts (A) : 4 A 30 VDC
 - gold plated brass contacts (LD) : 100 mA 30 VDC
- Minimum load :
 - silver contacts (A) : 100 mA 10 V
 - gold plated brass contacts (LD) : 10 μ A 5 VDC - 10 mA 50 mV
- Initial contact resistance : 20 m Ω max.
- Insulation resistance : 1,000 M Ω min. at 500 VDC
- Dielectric strength :
 - 1,000 Vrms 50 Hz min. between terminals
 - 2,000 Vrms 50 Hz min. between poles
 - 2,000 Vrms 50 Hz min. between terminals and frame
- Electrical life at full load :
 - silver contacts (A) : 20,000 cycles
 - gold plated brass contacts (LD) : 50,000 cycles



GENERAL SPECIFICATIONS

- Low level or mechanical life : 100,000 cycles.
- Operating temperature : -40 °C to +85 °C (-40 °F to +185 °F)



MATERIALS

- Case and cover : PBT
- Actuator : brass, nickel plated
- Bushing : brass, nickel plated
- Contacts : **A** : silver, **LD** : brass, gold plated
- Terminal seal : epoxy

APEM products may be recycled at end-of-life for the re-claiming of valuable metal components.

The company reserves the right to change specifications without notice.



21000N series

Low profile toggle switches



PANEL CUT-OUT

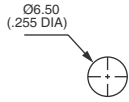

ELECTRICAL FUNCTIONS

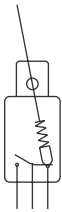

PCB MOUNTING

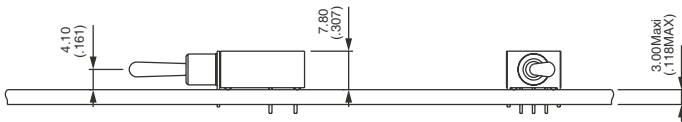

POSITIONS AND CONNECTIONS

Bottom view	III	II	I
Function 6	ON	-	ON
Function 9	ON	OFF	ON
Function 7	MOM	OFF	MOM
Function 8	ON	OFF	MOM
Function 2	ON	-	MOM

21000N series

Low profile toggle switches



BUILD YOUR PART NUMBER

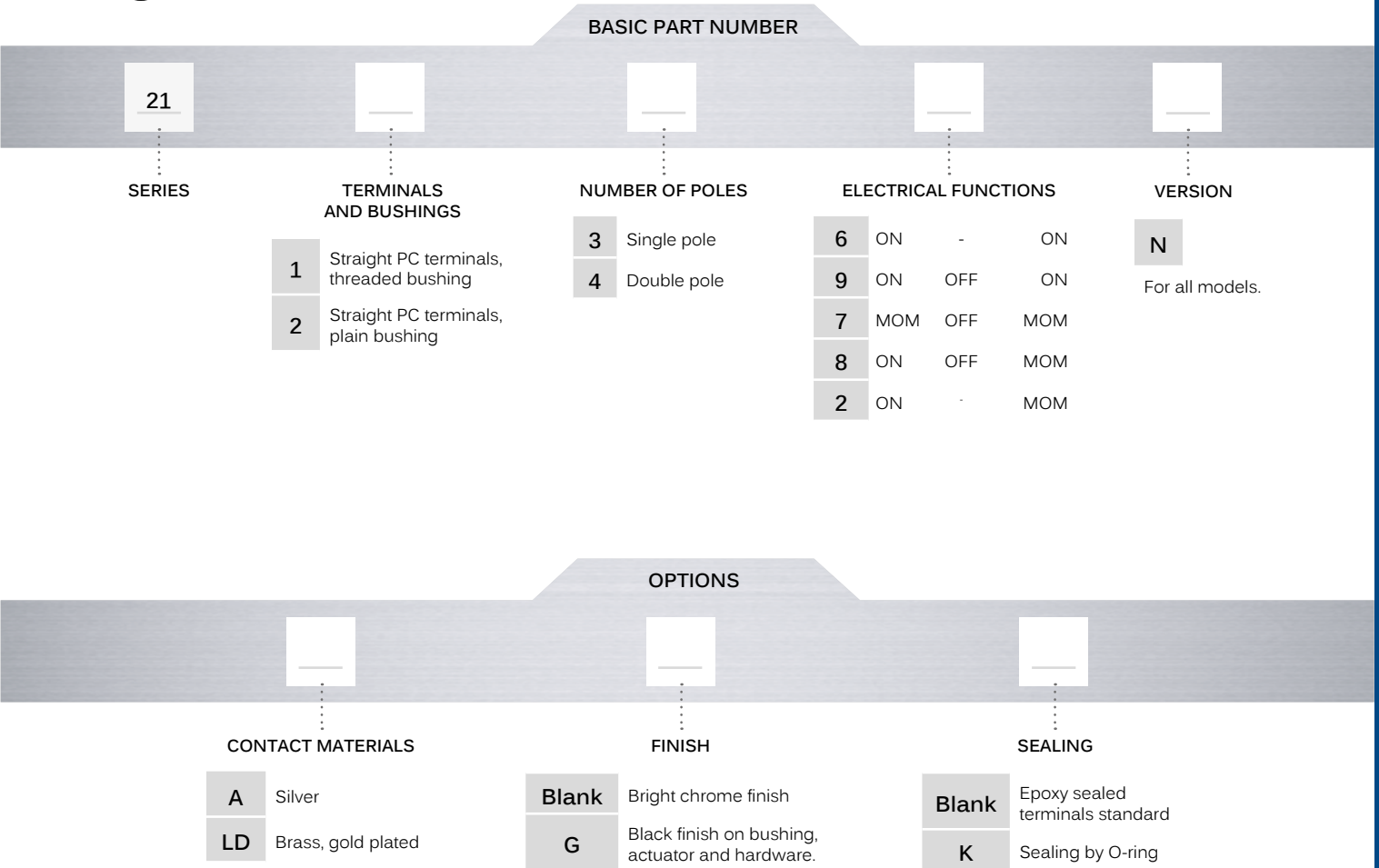

ABOUT THIS SERIES

On the following pages, you will find successively basic part numbers of switches and options in the same order as in above chart.

- ⚠ **Notice** : please note that not all combinations of above numbers are available. Refer to the following pages for further information.
- ⚠ **Mounting accessories** : standard hardware supplied with all models with threaded bushing : 2 hex nuts 8 mm (.314) across flats. Standard and special hardware available is presented in the "Hardware" section of website.

21000N series

Low profile toggle switches

CONTACT MATERIALS



- A Silver
- LD Brass, gold plated

FINISH



- Blank Nickel plating on bushing, actuator and hardware.
- G Black finish on bushing, actuator and hardware.

SEALING

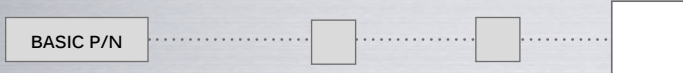

Epoxy sealed terminals are standard.

Blank No sealing except standard.

K Bushing internally sealed by one O-ring (version without washer U360). Protects the switch against water and dust.

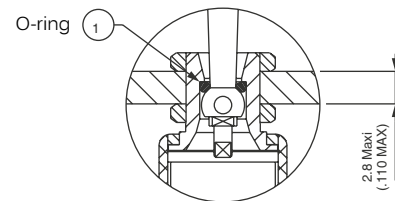

Mouser Electronics

Authorized Distributor

Click to View Pricing, Inventory, Delivery & Lifecycle Information:

[Apem:](#)

[21236NA](#) [21136NA](#) [21137NA](#) [21146NA](#)