

ASO ONLY (APPLICATION SPECIFIC ORDER)

QSH-XXX-01-X-D-EMX

DO NOT SCALE FROM THIS PRINT

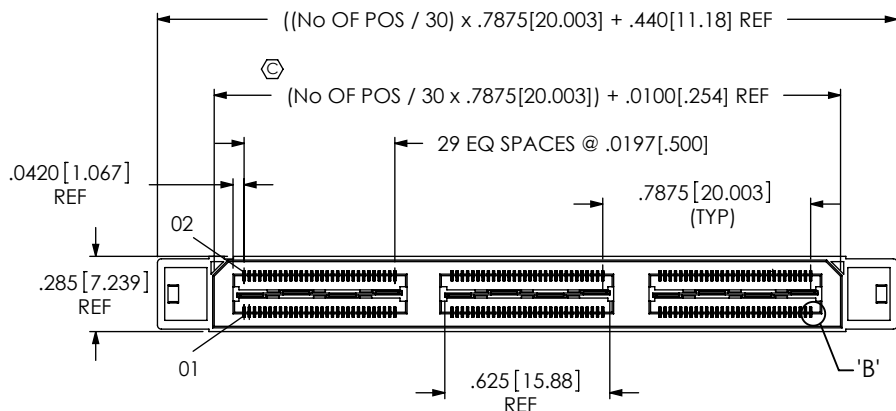

**No OF POSITIONS**  
 -030, -060, -090,  
 \*120, \*-150  
 (PER ROW)

**LEAD STYLE**  
 -01: .1380[3.505]

**PLATING SPECIFICATION**  
 (VALUES GIVEN ARE IN MICRO INCHES)  
 -F: FLASH SELECTIVE, 3 Au / 50 Ni MIN ON CONTACT, MATTE TIN TAIL. (USE C-162-XX-F & T-1G13-01-F) (SEE NOTE 6)  
 -L: LIGHT SELECTIVE, 10 Au / 50 Ni MIN ON CONTACT, MATTE TIN TAIL. (USE C-162-XX-L & T-1G13-01-L)  
 -H: HEAVY GOLD, 30 Au / 50 Ni MIN ON CONTACT, 3 Au / 50 Ni MIN ON TAIL (USE C-162-XX-H & T-1G13-01-G)  
 -S: SELECTIVE, 30 Au / 50 Ni MIN ON CONTACT MATTE TIN TAIL (USE C-162-XX-S & T-1G13-01-L).

**EDGE MOUNT THICKNESS**  
 -EM2: .064[1.63] +/- .004 PCB  
 (USE QSH-30-01-D-EM2-XX & C-162-01-X)  
 -EM3: (USE QSH-30-01-D-EM3-XX & C-162-02-X) SEE NOTE 10

**ROW SPECIFICATION**  
 -D: DOUBLE (USE QSH-30-01-D-EMX-XX)

**No OF BANKS**

\*SEE NOTE 11 BELOW NO OF POSITIONS

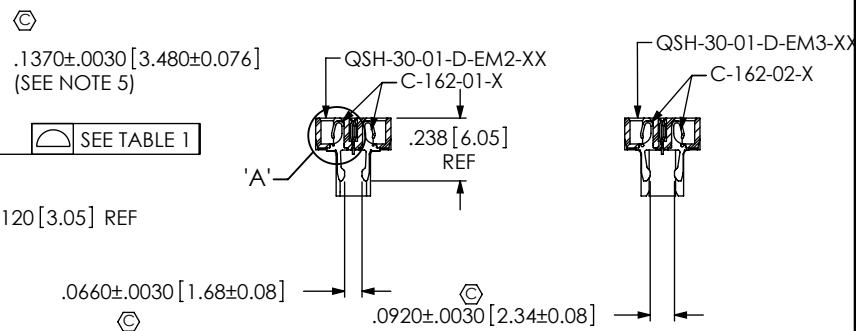
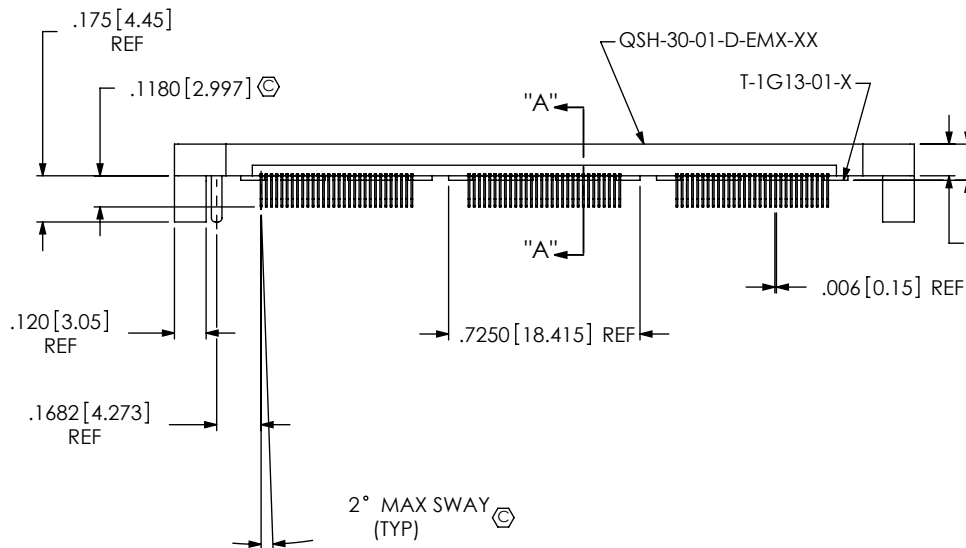

**SECTION "A-A"**  
 EDGE MOUNT THICKNESS  
 -EM2: .064 [1.63] +/- .004 PCB

**SECTION "A-A"**  
 EDGE MOUNT THICKNESS  
 -EM3:  
 SEE NOTE 10  
 (DIFFERENT AS SHOWN, OTHERWISE SAME AS -EM2 PCB THICKNESS)

- NOTES:
1. Ⓢ REPRESENTS A CRITICAL DIMENSION.
  2. CONTACT RETENTION: 6 OZ MIN.
  3. GROUND PLANE RETENTION: 8 OZ MIN.
  4. PARTS ARE "MOLD TO POSITION".
  5. MAX VARIANCE OF .002[.05].
  6. -L PLATING CAN BE SUBSTITUTED FOR -F PLATED SIGNAL PIN.
  7. NOTE DELETED.
  8. NOTE DELETED.
  9. SEE [www.samtec.com/processing/edgemt\\_tectalk/index.htm](http://www.samtec.com/processing/edgemt_tectalk/index.htm) FOR INFORMATION ON PROCESSING EDGE MOUNT PARTS TO BOARDS.
  10. -EM3 IS NOT A STANDARD OFFERING; AVAILABLE AS AN ASP ONLY. PLEASE CONTACT SAMTEC INTERCONNECT PROCESSING GROUP WITH ORDER INQUIRIES
  11. FOR NEW APPLICATIONS REQUIRING THESE POSITIONS, PLEASE CONTACT SAMTEC INTERCONNECT PROCESSING GROUP.

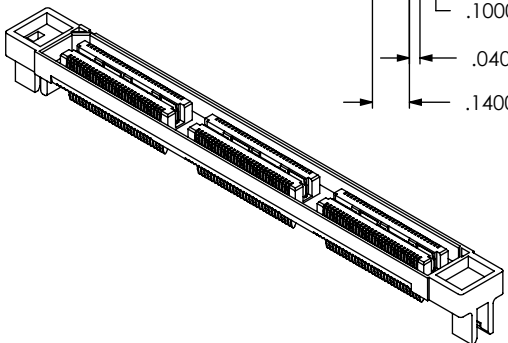
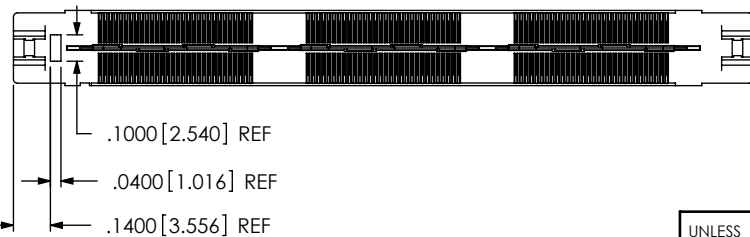

**TABLE 1** Ⓢ

No OF POSITIONS	ASSEMBLY BOW	GND PLANE COPLANARITY
-030 & -060	.004 [.10]	.004 [.10]
-090, -120, & -150	.005[1.27]	.005[1.27]

UNLESS OTHERWISE SPECIFIED, DIMENSIONS ARE IN INCHES.  
 TOLERANCES ARE:  
 DECIMALS ANGLES  
 .XX: ±.01[.3] 2°  
 .XXX: ±.005[.13]  
 .XXXX: ±.0020[.051]

**PROPRIETARY NOTE**  
 THIS DOCUMENT CONTAINS INFORMATION CONFIDENTIAL AND PROPRIETARY TO SAMTEC, INC. AND SHALL NOT BE REPRODUCED OR TRANSFERRED TO OTHER DOCUMENTS OR DISCLOSED TO OTHERS OR USED FOR ANY PURPOSE OTHER THAN THAT WHICH IT WAS OBTAINED WITHOUT THE EXPRESSED WRITTEN CONSENT OF SAMTEC, INC.

**MATERIAL:** DO NOT SCALE DRAWING SHEET SCALE: 1.375:1  
 INSULATOR: LCP, UL 94 VO, COLOR: BLACK  
 CONTACT & GROUND PLANE: PHOS BRONZE

F:\DWG\MISC\MKTG\QSH-XXX-01-X-D-EMX-MKT.SLDDRW

520 PARK EAST BLVD, NEW ALBANY, IN 47150  
 PHONE: 812-944-6733 FAX: 812-948-5047  
 e-Mail: info@SAMTEC.com code: 55322

**DESCRIPTION:**  
 .5MM EDGE MOUNT HIGH SPEED SOCKET ASSEMBLY

**DWG. NO.**  
 QSH-XXX-01-X-D-EMX

**BY:** DEAN P 5/31/2000 **SHEET 1 OF 2**

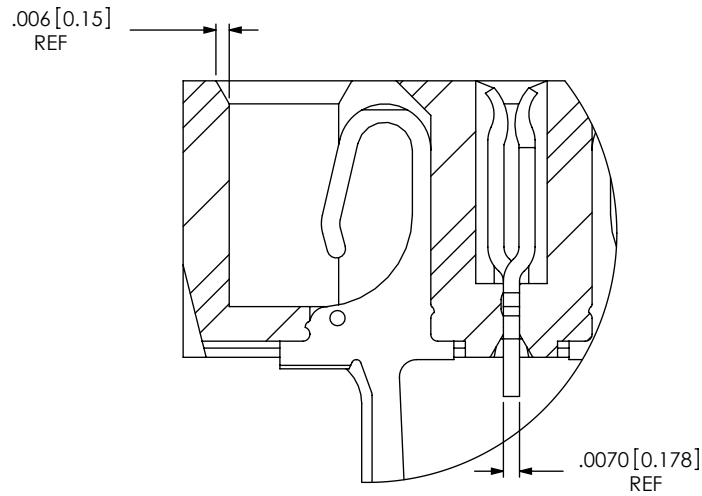

DETAIL 'A'  
SCALE 2:1

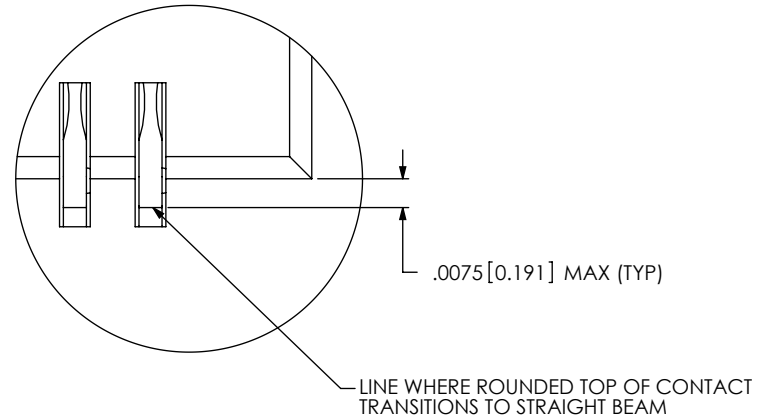

DETAIL 'B'  
SCALE 20:1

**PROPRIETARY NOTE**  
THIS DOCUMENT CONTAINS INFORMATION CONFIDENTIAL AND PROPRIETARY TO SAMTEC, INC. AND SHALL NOT BE REPRODUCED OR TRANSFERRED TO OTHER DOCUMENTS OR DISCLOSED TO OTHERS OR USED FOR ANY PURPOSE OTHER THAN THAT WHICH IT WAS OBTAINED WITHOUT THE EXPRESSED WRITTEN CONSENT OF SAMTEC, INC.

DO NOT SCALE DRAWING

SHEET SCALE: 4:1

**samtec**

520 PARK EAST BLVD, NEW ALBANY, IN 47150  
PHONE: 812-944-6733 FAX: 812-948-5047  
e-Mail: info@SAMTEC.com code: 55322

DESCRIPTION:  
.5MM EDGE MOUNT HIGH SPEED SOCKET ASSEMBLY

DWG. NO.  
QSH-XXX-01-X-D-EMX

BY: DEAN P 5/31/2000 SHEET 2 OF 2