

LOC	DIST	REVISIONS					
		P	LTR	DESCRIPTION	DATE	DWN	APVD
AA	00		A2	REV PER ECO-13-015117	16SEP2013	OL	SZ
			A3	ADD NEW PART 6--2	18NOV2013	OL	SZ
			A4	ECR-15-001425	19JAN2015	SZ	SZ

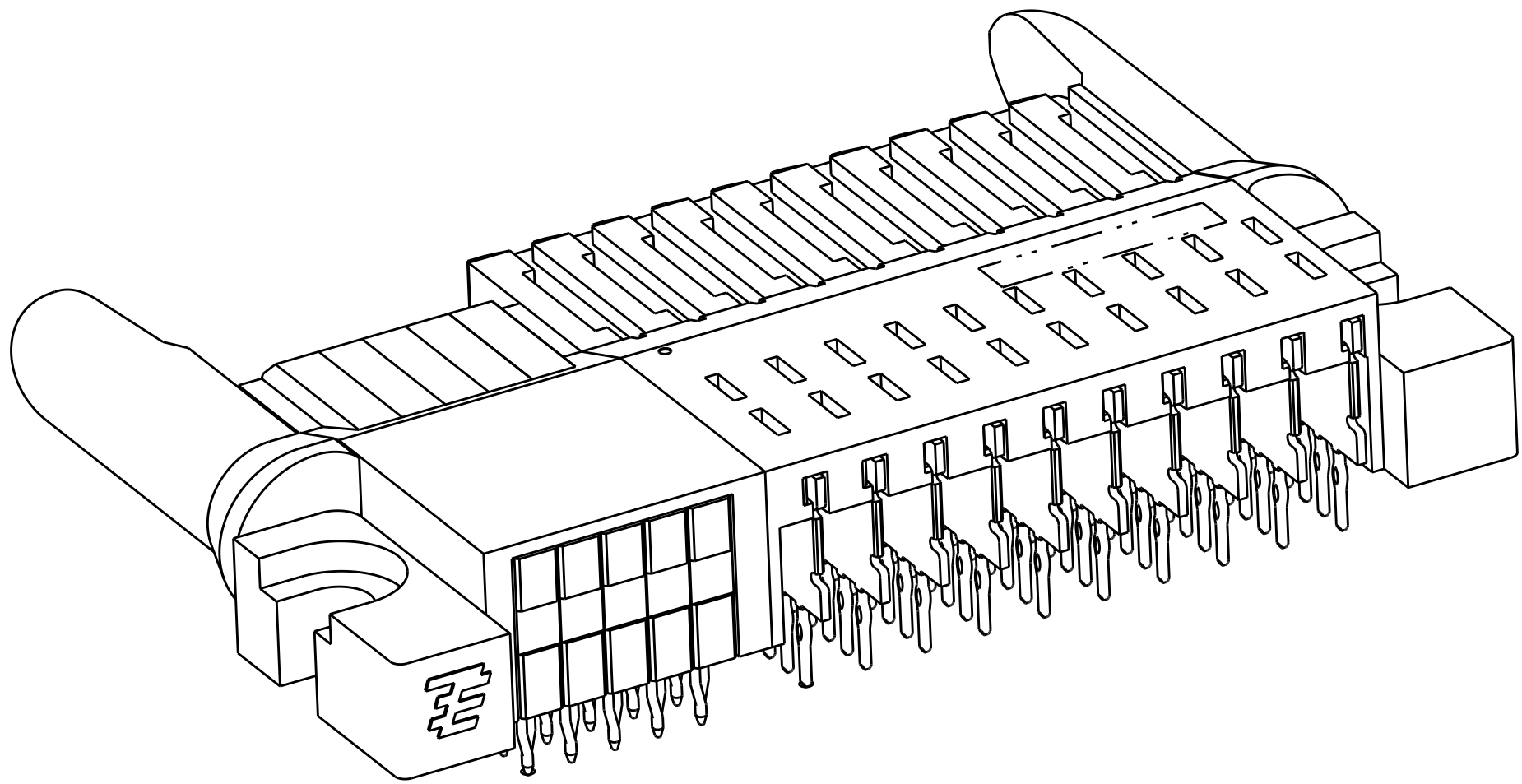
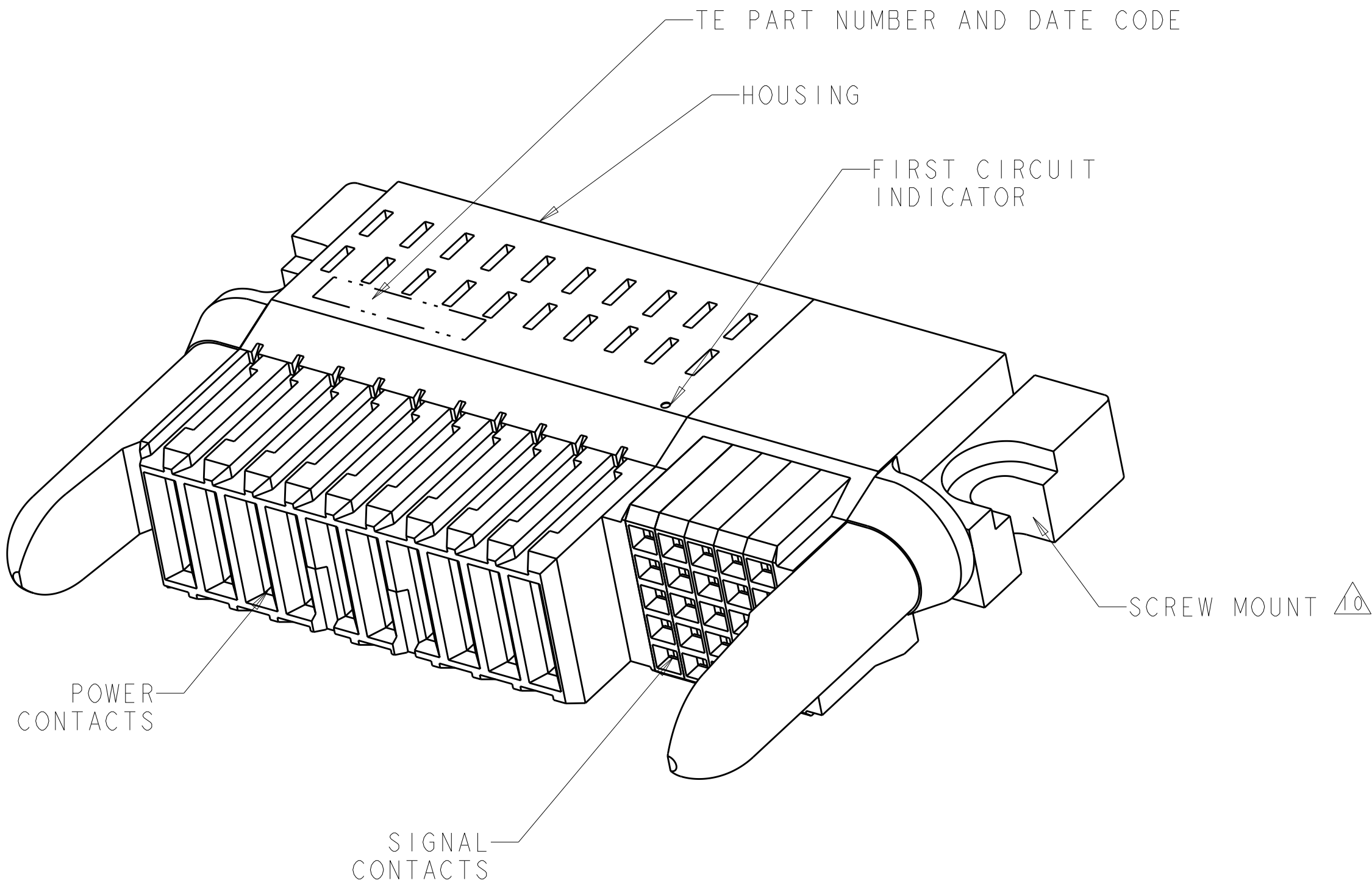

2-1926739-5 SHOWN

- HOUSING: GLASS FILLED LIQUID CRYSTAL POLYMER, COLOR: BLACK, UL 94 V-O RATED  
SIGNAL CONTACT: PHOSPHOR BRONZE  
SIGNAL OVERMOLD: GLASS FILLED POLYESTER  
POWER CONTACT: COPPER ALLOY
- SIGNAL CONTACT: 0.00127mm MIN NICKEL ALL OVER,  
MATING AREA: 0.00008mm MIN GOLD OVER  
0.00076mm MIN PALLADIUM-NICKEL  
TAIL AREA: 0.0005mm MIN MATTE TIN  
  
POWER CONTACT: 0.00127mm MIN NICKEL ALL OVER,  
MATING AREA: 0.00008mm MIN GOLD OVER  
0.00076mm MIN PALLADIUM-NICKEL,  
TAIL AREA: 0.0005mm MIN MATTE TIN
- CONTACT MATING AREA LUBRICATED WITH BELLCORE APPROVED LUBRICANT,  
TECHNICAL REFERENCE: GR-1217-CORE, ISSUE 1, NOVEMBER 1995
- THIS CONNECTOR EMPLOYS UL RECOGNIZED Z-PACK 2mm HM SIGNAL CONTACTS

- 5 DATUMS AND BASIC DIMENSIONS TO BE ESTABLISHED BY CUSTOMER
- 6 PC BOARD THICKNESS 1.4mm MIN, FOR WAVE SOLDER PC BOARD THICKNESS 2.62 MAX
- 7 SEE APPLICATION SPEC 114-13215 FOR PLATED THROUGH HOLE INFORMATION
8. SEE CUSTOMER DRAWING 1926730 OR 1926732 FOR MATING CONNECTOR
- 9 UNPLATED HOLES
- 10 #4-40 UNC PAN HEAD SCREW WITH HEX NUT, NOT SHOWN, SUPPLIED BY CUSTOMER

12	15	1	2	21.94	25.74	15S X 2P	8-1926739-0
144	40	23	7	92.44	96.24	40S X 24P	7-1926739-7
120	35	19	6	79.44	83.24	35S X 20P	6-1926739-2
108	35	17	6	73.94	77.74	35S X 18P	5-1926739-5
96	25	15	4	64.44	68.24	25S X 16P	4-1926739-6
72	15	11	2	49.44	53.24	15S X 12P	3-1926739-0
48	20	7	3	40.44	44.24	20S X 8P	1-1926739-1
72	25	11	4	51.44	57.24	25S X 12P	1926739-9
48	25	7	4	42.44	46.24	25S X 8P	1-1926739-8
36	20	5	3	36.74	40.54	20S X 6P	1-1926739-0
60	25	9	4	47.94	51.74	25S X 10P	2-1926739-5
F PLC	E PLC	D SPACES	C SPACES	DIM B	DIM A	NO OF POSITIONS	PART NUMBER

THIS DRAWING IS UNPUBLISHED. IT IS SUBJECT TO CHANGE AND SHOULD BE USED FOR INFORMATION ONLY. FOR THE LATEST REVISIONS, CONTACT THE ORGANIZATION THAT ISSUED THIS DRAWING.

DIMENSIONS:  
mm

MATERIAL  
SEE NOTE 1

TOLERANCES UNLESS OTHERWISE SPECIFIED:  
0 PLC ±  
1 PLC ±  
2 PLC ±0.13  
3 PLC ±  
4 PLC ±  
ANGLES ±  
FINISH SEE NOTE 2

Customer Drawing

DWN: ORANDO L1 28OCT2011  
CHK: SUNY ZHAO 28OCT2011  
APVD: SUNY ZHAO 28OCT2011

PRODUCT SPEC: 108-2325  
APPLICATION SPEC: 114-13215  
WEIGHT: -

SIZE: A1  
CAGE CODE: 00779  
DRAWING NO: 1926739

Tyco Electronics  
Shanghai, PR 200233

NAME: RECEPTACLE ASSEMBLY, RIGHT ANGLE, PASSIVE GUIDE, SIGNAL/POWER, WITH SCREW MOUNT, MINIPAK HDL

RESTRICTED TO: -

SCALE: 3:1 SHEET: 1 OF 3 REV: A4

AMP 4805 REV 31MAR2000

LOC	DIST	REVISIONS					
		P	LTR	DESCRIPTION	DATE	DWN	APVD
AA	00	-					
		-	SEE SHEET 1		-	-	-

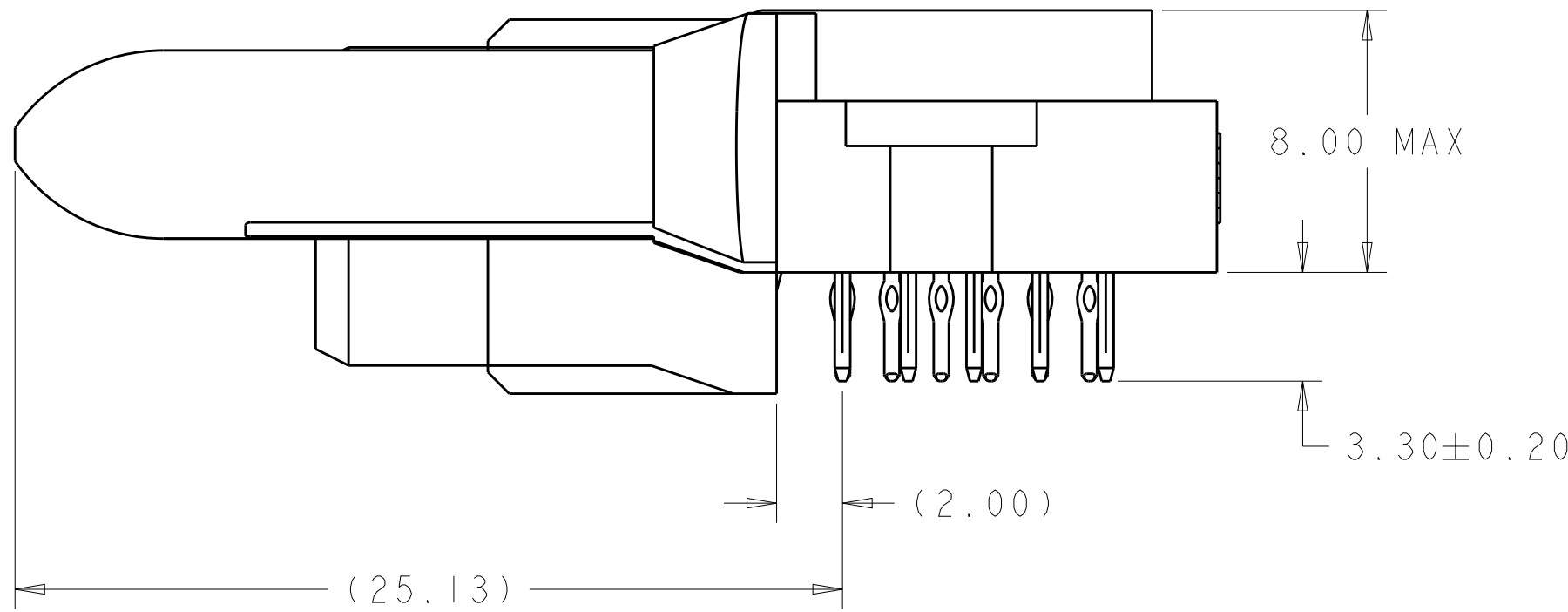
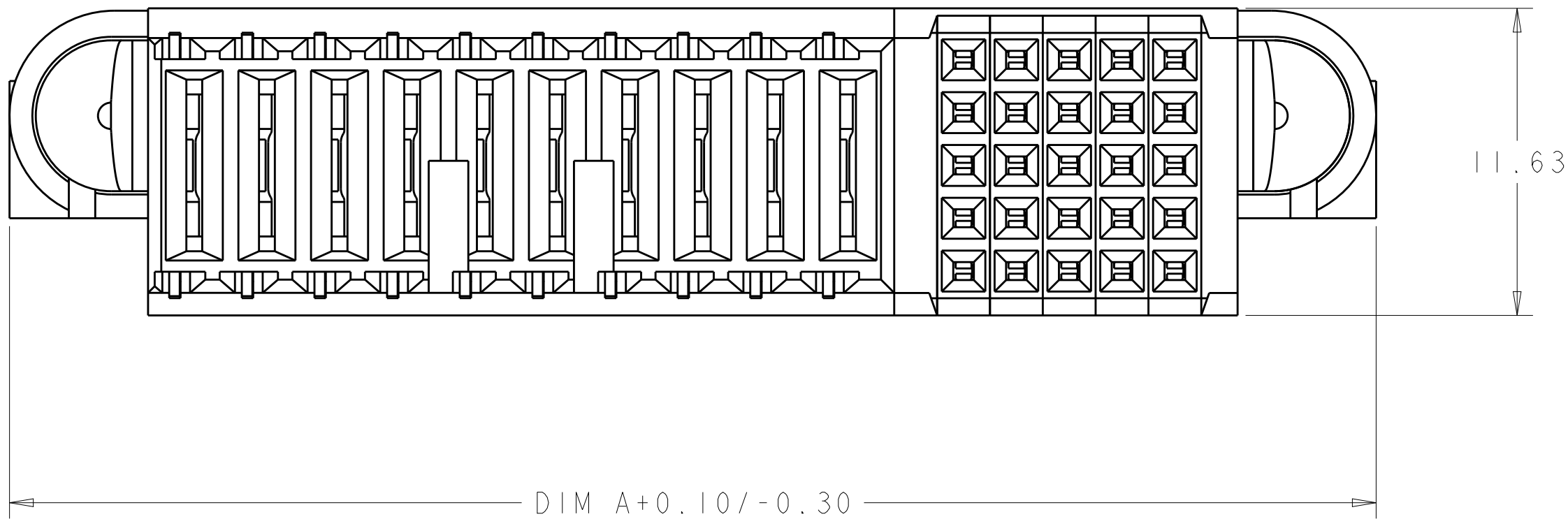
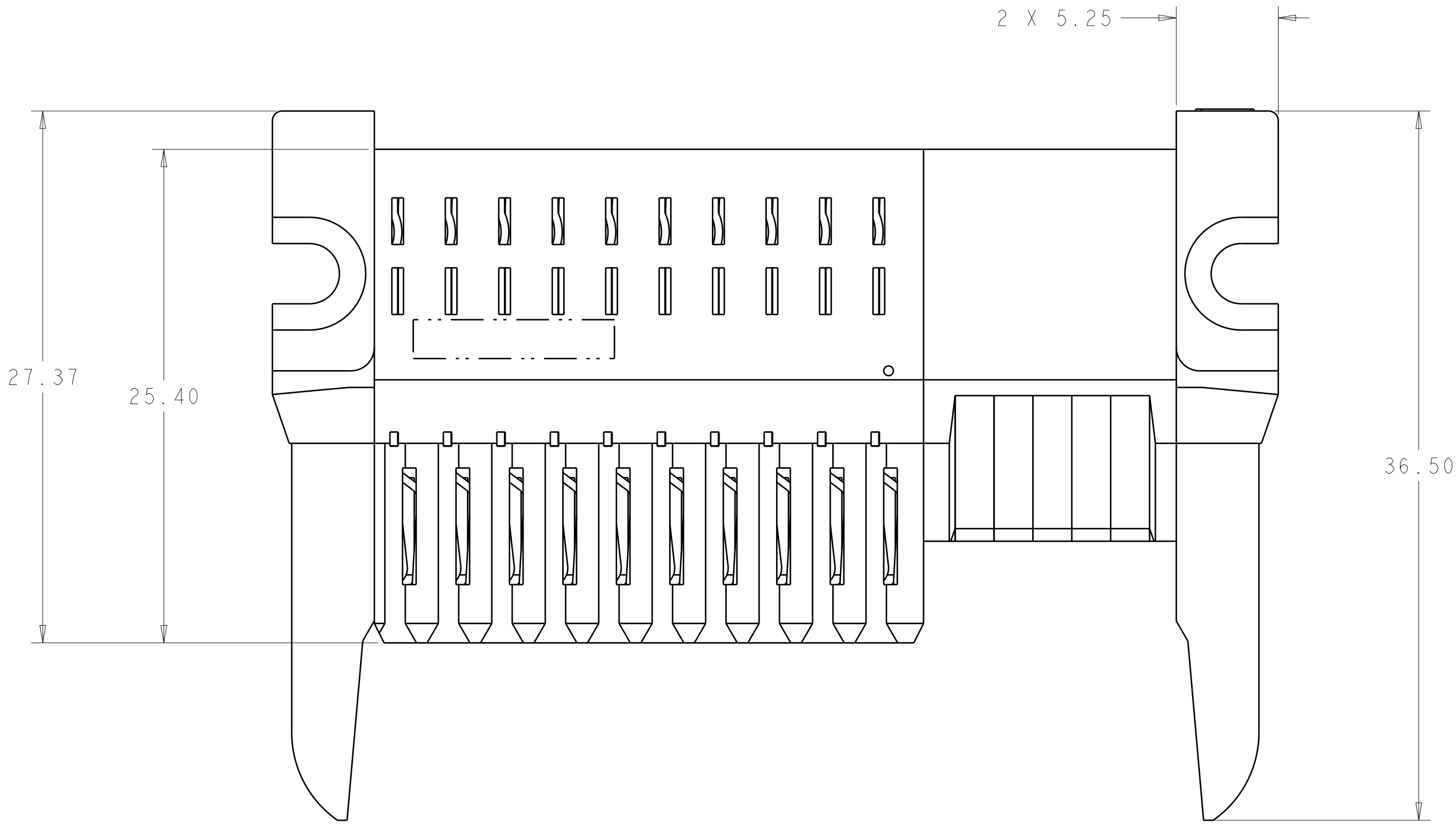

THIS DRAWING IS A CONTROLLED DOCUMENT FOR TYCO ELECTRONICS CORPORATION. IT IS SUBJECT TO CHANGE AND SHOULD BE CONTROLLED BY THE ISSUING ORGANIZATION. SHOULD BE CONTACTED FOR THE LATEST VERSION.		DWN	ORANDO LI	28OCT2011	Tyco Electronics Shanghai, PR 200233	
		CHK	SUNY ZHAO	28OCT2011		
DIMENSIONS:		TOLERANCES UNLESS OTHERWISE SPECIFIED:		APVD	NAME	
mm		0 PLC ±.010		SUNY ZHAO	RECEPTACLE ASSEMBLY, RIGHT ANGLE,	
		1 PLC ±.013		PRODUCT SPEC	PASSIVE GUIDE, SIGNAL/POWER, WITH SCREW MOUNT, MINIPAK HDL	
		2 PLC ±.013		108-2325		
		3 PLC ±.013		APPLICATION SPEC		
		4 PLC ±.013		114-13215		
MATERIAL		FINISH		WEIGHT	RESTRICTED TO	
SEE NOTE 1		SEE NOTE 2		-	A100779C=1926739	
				Customer Drawing	SCALE 3:1 SHEET 2 OF 3 REV A4	



1ST DRAWING: 1.5 CONTINUED DIMENSIONS FOR ALL ELECTRICAL CONNECTIONS DIMENSIONS: 1.5 CONTINUED DIMENSIONS FOR ALL ELECTRICAL CONNECTIONS DIMENSIONS: 1.5 CONTINUED DIMENSIONS FOR ALL ELECTRICAL CONNECTIONS		OWN ORLANDO LI 280C12011 CHW SUNT ZHAO 280C12011 APVU SUNT ZHAO 280C12011		Tyco Electronics Shanghai, PR 200233	
DIMENSIONS: mm 		TOLERANCES, UNLESS OTHERWISE SPECIFIED: 0 P/LC ±, 2 P/LC ±, 2 P/LC ±, 4 P/LC ±, ANGLES ±		NAME RECEPTACLE ASSEMBLY, RIGHT ANGLE, PASSIVE GUIDE, SIGNAL/POWER, WITH SCREW MOUNT, MINIPAK HDL	
MATERIAL SEE NOTE 1		FINISH SEE NOTE 2		SIZE CASE CODE DRAWING NO RESTRICTED TO A 100779 C=1926739 -	
Weight -		Customer Drawing			
SCALE 3:1		SHEET 3 of 3		REV A	

# Mouser Electronics

Authorized Distributor

Click to View Pricing, Inventory, Delivery & Lifecycle Information:

[TE Connectivity:](#)

[1-1926739-8](#)