

LOC		DIST		REVISIONS			
P	LTN	DESCRIPTION	DATE	DWN	APVD		
E		REVISE PER ECR-13-003272	18JUN2013	KH	TM		

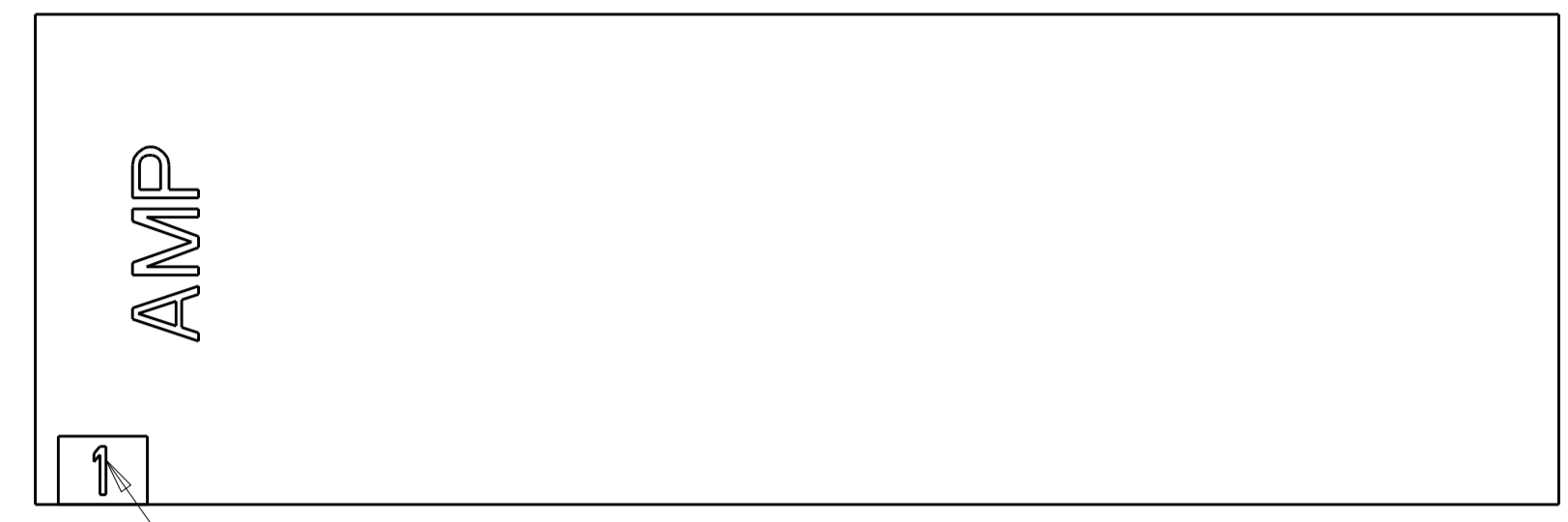

1. UNIT ACCEPTS 1.14 [.045] SQUARE OR ROUND POST.
2. UNIT ACCEPTS STANDARD SL-156 CONTACTS.
3. UNIT ACCEPTS KEYING PLUG 640254-1 AND KEYING PIN 640255-1.
4. CIRCUIT I.D. NUMBER(S) TO BE LOCATED SEQUENTIALLY AS SHOWN OR ONLY NO. 1 CIRCUIT PLACED ON LOCKING RAMP.
5. DIMENSION IN BRACKETS ARE IN INCHES.
6. ACCEPTS UP TO 2.79 [.110] INSULATION WIRE.
7. THIS HOUSING CANNOT BE USED WITH SL-156 HOODED CONTACT PART NUMBERS 770476-X.
8. CORING BETWEEN CIRCUITS ALLOWABLE WHERE SHOWN AS NEEDED TO PREVENT SINK MARKS. MIN WALL THICKNESS BETWEEN CIRCUIT AND CORING TO BE 0.64 [.025].

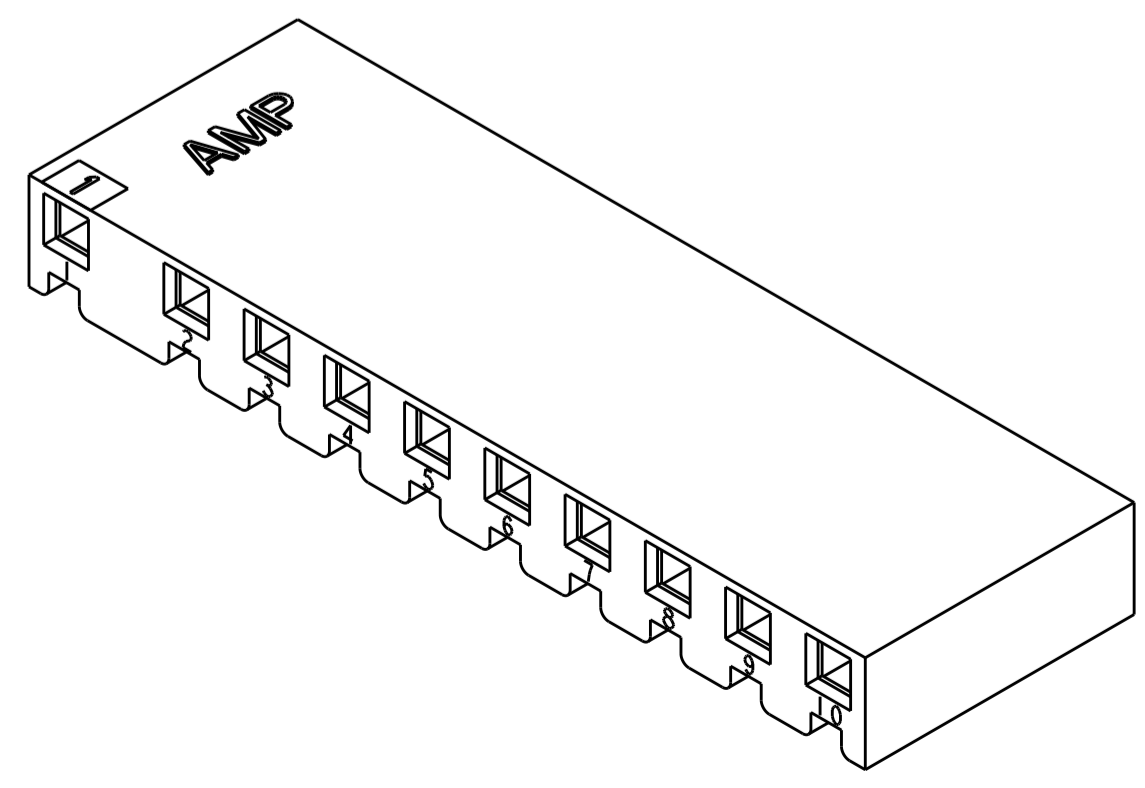
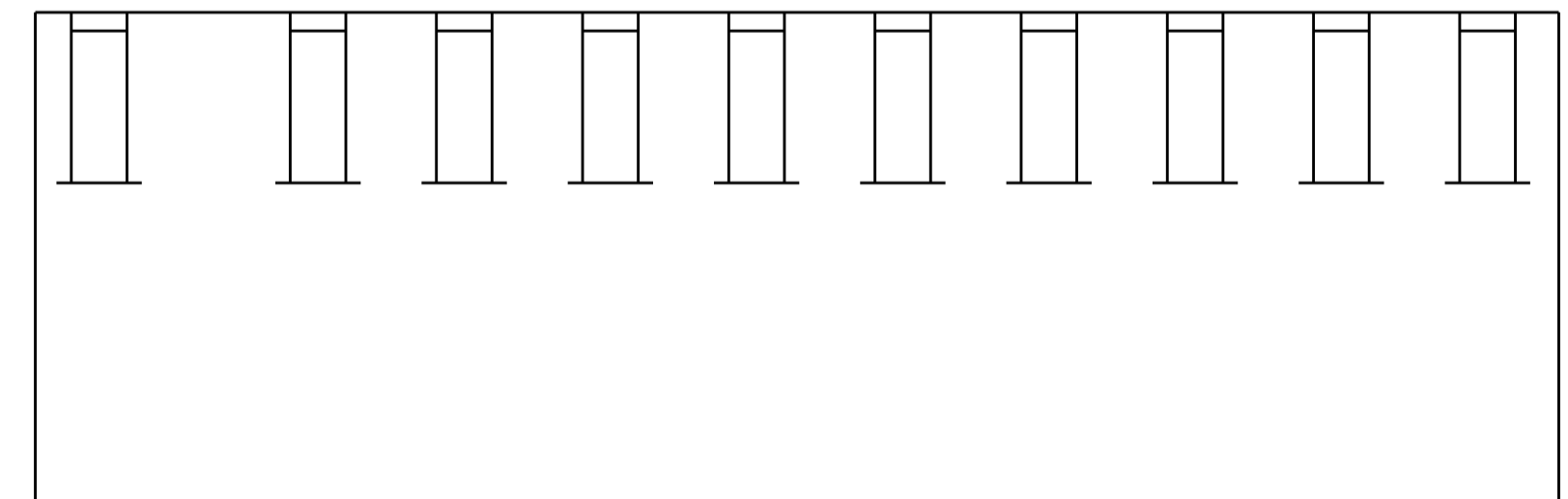
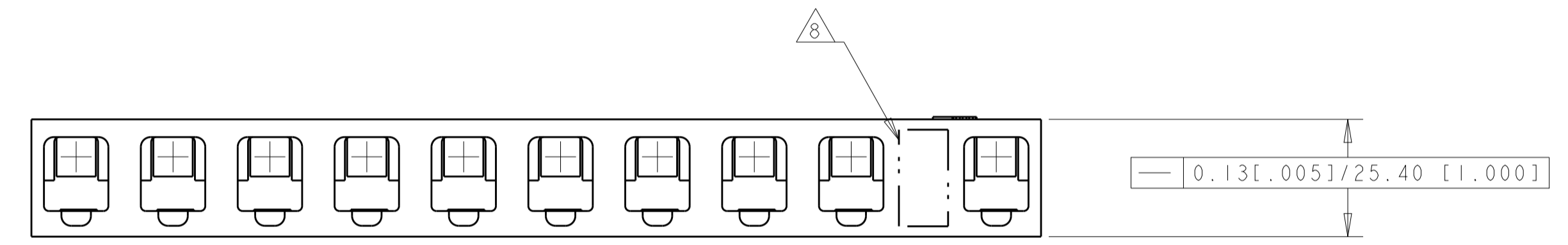
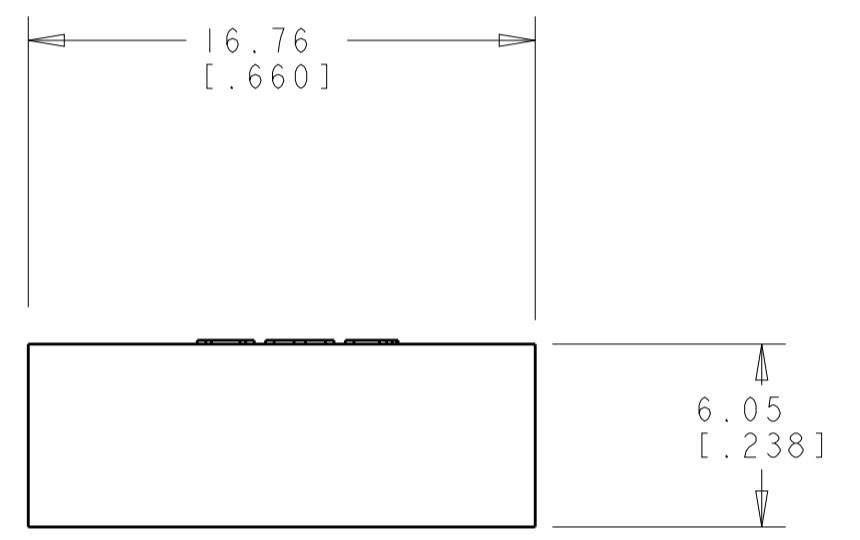
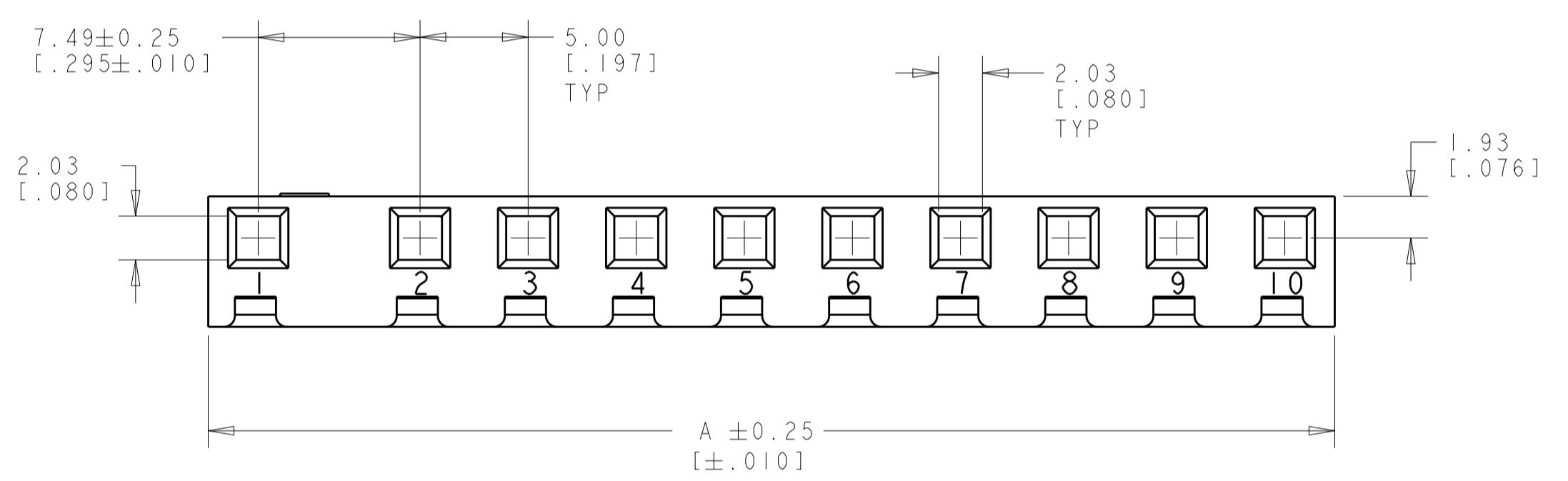

3-DIMENSIONAL MODEL
SCALE 3:1

1-1744074-0 SHOWN

PRELIMINARY - NOT FOR PRODUCTION	0.215	57.15 [2.250]	11	1-1744074-1
	0.196	52.15 [2.053]	10	1-1744074-0
	VOLUME (IN ³)	DIM A	NO OF POSN	PART NUMBER

THIS DRAWING IS A CONTROLLED DOCUMENT.		DWN	R. WHITAKER	14MAR2005		NAME HOUSING, WITH LOCKING RAMP, SL-156, FOR LARGE WIRE INSULATION, SPECIAL				
DIMENSIONS: mm [INCHES]		CHK	J. ELLIS	14MAR2005						
TOLERANCES UNLESS OTHERWISE SPECIFIED:		APVD	J. ELLIS	14MAR2005						
0 PLC ± 1 PLC ± 2 PLC ±0.13 [.005] 3 PLC ± 4 PLC ±		PRODUCT SPEC								
MATERIAL: NYLON, UL 94V-0 NATURAL FINISH: - ANGLES: 40°/30°		APPLICATION SPEC			SIZE	CAGE CODE	DRAWING NO	RESTRICTED TO		
		WEIGHT	SEE TABLE	A100779	SCALE	4:1	SHEET	1 OF 1	REV	E
		CUSTOMER DRAWING								

Mouser Electronics

Authorized Distributor

Click to View Pricing, Inventory, Delivery & Lifecycle Information:

[TE Connectivity:](#)

[1-1744074-1](#)