

NOTES

- ① 極数/2 = 偶数に適用
APPLY FOR CIRCUIT SIZE / 2 =EVEN
- ② 関連製品・書類はSHEET 2参照のこと
REFER TO SHEET 2 ABOUT RELATED PRODUCTS AND DOCUMENTS.
- ③ オーダー番号(製品番号): SHEET 3の製品一覧を参照のこと
ORDER No. (PRODUCT No.) : REFER TO SHEET 3 FOR PRODUCT LIST.

503149 **0*

シリーズ番号 極数 色
SERIES NO CIRCUIT SIZE COLOR

CIRCUIT	ハウジングカラー HOUSING COLOR
08 ~ 34	0:ナチュラル NATURAL
	1:黒 BLACK
	2:赤 RED
	4:青 BLUE
	6:緑 GREEN

24.0	29.8	34
22.5	28.3	32
21.0	26.8	30
19.5	25.3	28
18.0	23.8	26
16.5	22.3	24
15.0	20.8	22
13.5	19.3	20
12.0	17.8	18
10.5	16.3	16
9.0	14.8	14
7.5	13.3	12
6.0	11.8	10
4.5	10.3	8
B	A	CKT SIZE

- ④ トレードマーク : Mプラス 2文字の製造工場を示すアルファベットにて表示。
但し、"J"はJAPANを、"L"はMALAYSIAを示す。(例: MXJ, MXL)
金型番号 : アルファベット2文字にて表示。(例: 1A, 12A, 1B, 12B)

部品 PART	材質 MATERIAL
ハウジング HOUSING	ポリエステル(PBT), UL94V-0, 色 : SEE CHART POLYESTER (PBT), UL94V-0, COLOR : SEE CHART

DOCUMENT STATUS	P1	RELEASE DATE	2019/11/20	09:03:11
-----------------	----	--------------	------------	----------

THIS DRAWING CONTAINS INFORMATION THAT IS PROPRIETARY TO MOLEX ELECTRONIC TECHNOLOGIES, LLC AND SHOULD NOT BE USED WITHOUT WRITTEN PERMISSION		CURRENT REV DESC:		molex		
DIMENSION UNITS	SCALE	EC NO: 627408				
mm	4:1	DRWN: MIKEDA01 2019/06/12		PRODUCT CUSTOMER DRAWING		
GENERAL TOLERANCES (UNLESS SPECIFIED)		CHK'D: SAKIYAMA 2019/11/15		DOCUMENT NUMBER		
ANGULAR TOL	± 3.0 °	APPR: KOMURAKAMI 2019/11/20		5031490000-SD		
4 PLACES	± 0.2	INITIAL REVISION:		DOC TYPE	DOC PART	REVISION
3 PLACES	± 0.2	DRWN: MIKEDA01 2019/06/12		PSD	000	A
2 PLACES	± 0.2	APPR: KOMURAKAMI 2019/11/20		SHEET NUMBER		
1 PLACE	± 0.2	MATERIAL NUMBER		1 OF 3		
0 PLACES	± 0.2	CUSTOMER				
DRAFT WHERE APPLICABLE MUST REMAIN WITHIN DIMENSIONS		THIRD ANGLE PROJECTION	DRAWING	SERIES	MATERIAL NUMBER	CUSTOMER
			A3-SIZE	503149	503149**0*	GENERAL

△ 2 適用製品及び各種仕様書
 APPLICABLE PRODUCTS AND VARIOUS SPECIFICATIONS

梱包仕様書 PACKAGING SPECIFICATION	PART NUMBER 503149 - ****	DOCUMENT NUMBER SPK-503149-001
----------------------------------	------------------------------	-----------------------------------

	PLATING TYPE	PART NUMBER	WIRE SIZE(AWG)
適用端子 APPLICABLE TERMINAL	TIN	502579 0000	#24 - #28
		503429 0000	#26 - #30
	GOLD	213028 **00	#24 - #26
		213029 **00	#26 - #28

適用レセプタクルコネクタ APPLICABLE REC. CONNECTOR	SMT			
	TIN PLATING		GOLD PLATING	
	VERTICAL	RIGHT ANGLE	VERTICAL	RIGHT ANGLE
シリーズ番号 SERIES No.	503154	503148	213227	213228
製品仕様書 PRODUCT SPECIFICATION	5031490000-PS/PS/000	5031490001-PS/PS/000	5031490002-PS/PS/000	
アプリケーション仕様書 APPLICATION SPECIFICATION	AS-503149-001(JAPANESE) / 5031490000 PS 000 (ENGLISH)			



THIS DRAWING CONTAINS INFORMATION THAT IS PROPRIETARY TO MOLEX ELECTRONIC TECHNOLOGIES, LLC AND SHOULD NOT BE USED WITHOUT WRITTEN PERMISSION										
DIMENSION UNITS	SCALE	CURRENT REV DESC:				molex				
mm	1:1					CLIK-MATE 1.5 DUAL PLUG HSG				
GENERAL TOLERANCES (UNLESS SPECIFIED)		EC NO: 627408				PRODUCT CUSTOMER DRAWING				
ANGULAR TOL ± 3.0 °		DRWN: MIKEDA01 2019/06/12				DOCUMENT NUMBER				
4 PLACES ± 0.2		CHK'D: SAKIYAMA 2019/11/15				DOC TYPE DOC PART REVISION				
3 PLACES ± 0.2		APPR: KOMURAKAMI 2019/11/20				5031490000-SD PSD 000 A				
2 PLACES ± 0.2		INITIAL REVISION:				MATERIAL NUMBER CUSTOMER SHEET NUMBER				
1 PLACE ± 0.2		DRWN: MIKEDA01 2019/06/12				SEE CHART GENERAL 2 OF 3				
0 PLACES ± 0.2		APPR: KOMURAKAMI 2019/11/20								
DRAFT WHERE APPLICABLE MUST REMAIN WITHIN DIMENSIONS		THIRD ANGLE PROJECTION	DRAWING	SERIES	MATERIAL NUMBER	CUSTOMER	SHEET NUMBER			
			A3-SIZE	503149	SEE CHART	GENERAL	2 OF 3			

DOCUMENT STATUS	RELEASE DATE
-----------------	--------------

極数別形状
PRODUCT SHAPE AT EACH CKT

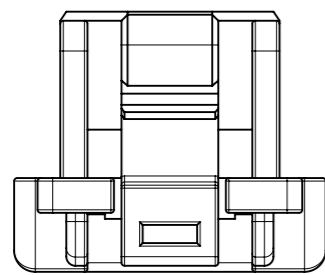

8極形状(1ロック)
FIGURE OF 8 CIRCUITS (1 LOCK)

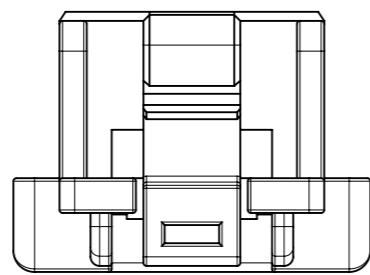

10極形状(1ロック)
FIGURE OF 10 CIRCUITS (1 LOCK)

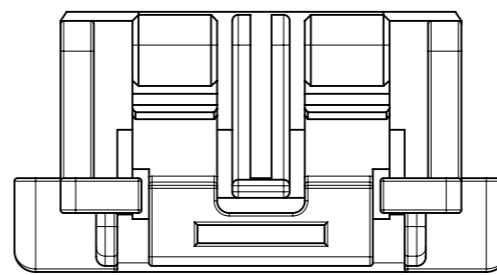

12-18極形状(2ロック)
FIGURE OF 12-18 CIRCUITS (2 LOCKS)

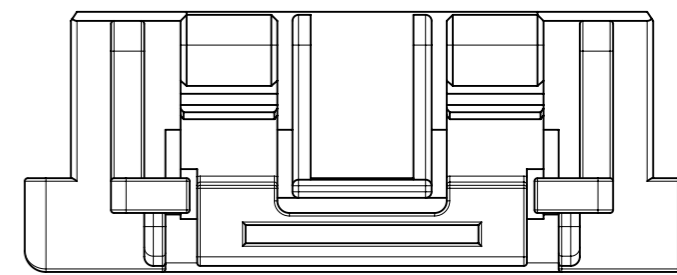

20-34極形状(2ロック)
FIGURE OF 20-34 CIRCUITS (2 LOCKS)

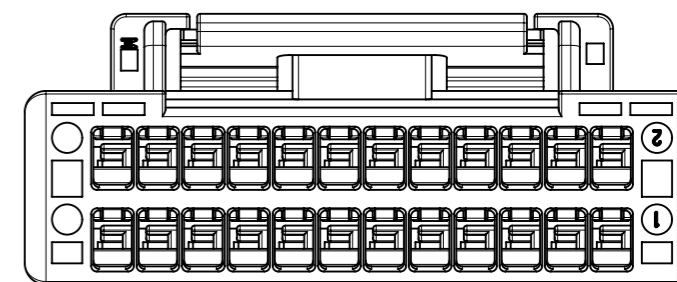
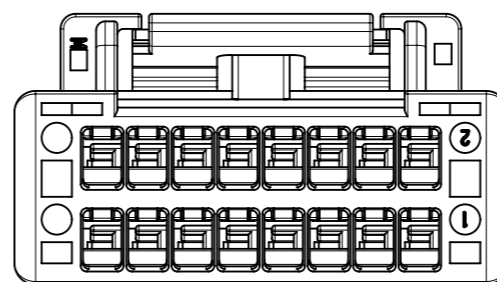
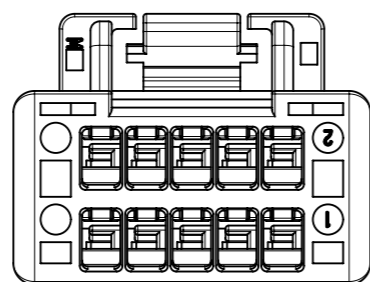
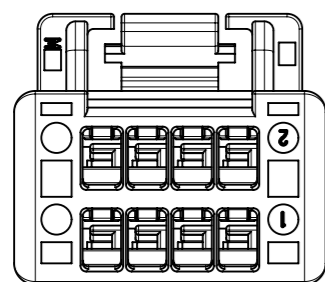

3 製品一覧
PRODUCTS LIST

緑 GREEN	青 BLUE	赤 RED	黒 BLACK	ナチュラル NATURAL	HOUSING COLOR
-	-	-	503149 3401	503149 3400	34
503149 3206	503149 3204	503149 3202	503149 3201	503149 3200	32
503149 3006	503149 3004	503149 3002	503149 3001	503149 3000	30
503149 2806	503149 2804	503149 2802	503149 2801	503149 2800	28
503149 2606	503149 2604	503149 2602	503149 2601	503149 2600	26
503149 2406	503149 2404	503149 2402	503149 2401	503149 2400	24
503149 2206	503149 2204	503149 2202	503149 2201	503149 2200	22
503149 2006	503149 2004	503149 2002	503149 2001	503149 2000	20
503149 1806	503149 1804	503149 1802	503149 1801	503149 1800	18
503149 1606	503149 1604	503149 1602	503149 1601	503149 1600	16
503149 1406	503149 1404	503149 1402	503149 1401	503149 1400	14
503149 1206	503149 1204	503149 1202	503149 1201	503149 1200	12
503149 1006	503149 1004	503149 1002	503149 1001	503149 1000	10
503149 0806	503149 0804	503149 0802	503149 0801	503149 0800	8
オーダー番号 ORDER No					極数 CIRCUIT No

PRE-RELEASE
REFERENCE
USE ONLY

THIS DRAWING CONTAINS INFORMATION THAT IS PROPRIETARY TO MOLEX ELECTRONIC TECHNOLOGIES, LLC AND SHOULD NOT BE USED WITHOUT WRITTEN PERMISSION					
DIMENSION UNITS	SCALE	CURRENT REV DESC:			
mm	1:1	molex			
GENERAL TOLERANCES (UNLESS SPECIFIED)					
ANGULAR TOL	± 3.0°	PRODUCT CUSTOMER DRAWING			
4 PLACES	± 0.2	EC NO: 627408	2019/06/12	DOCUMENT NUMBER	
3 PLACES	± 0.2	DRWN: MIKEDA01	2019/11/15	5031490000-SD	
2 PLACES	± 0.2	CHK'D: SAKIYAMA	2019/11/20	DOC TYPE	DOC PART
1 PLACE	± 0.2	APPR: KOMURAKAMI	2019/11/20	PSD	000
0 PLACES	± 0.2	INITIAL REVISION:		REVISION	A
DRAFT WHERE APPLICABLE MUST REMAIN WITHIN DIMENSIONS		DRWN: MIKEDA01	2019/06/12	SHEET NUMBER	
THIRD ANGLE PROJECTION		APPR: KOMURAKAMI	2019/11/20	3 OF 3	
DRAWING		SERIES	MATERIAL NUMBER	CUSTOMER	
A3-SIZE		503149	SEE CHART	GENERAL	

10 9 8 7 6 5 4 3 2 1

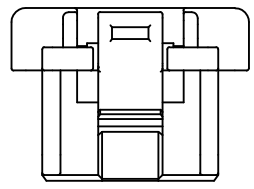
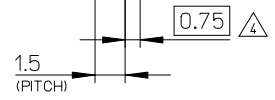
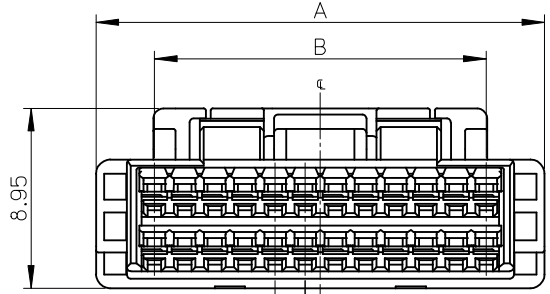
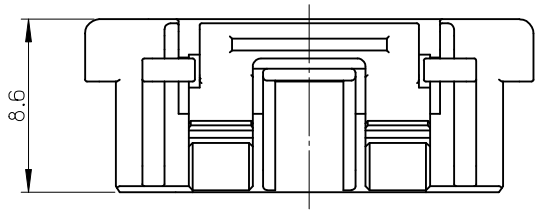

10CKTのロック形状
FIGURE OF 10 CIRCUIT

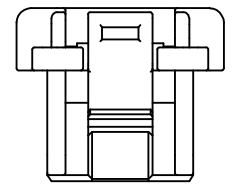

8CKTのロック形状
FIGURE OF 8 CIRCUIT

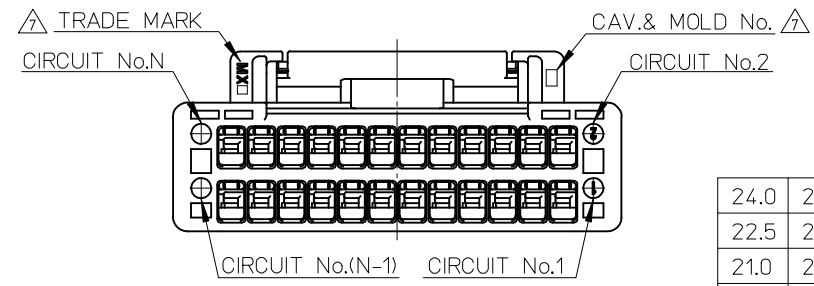
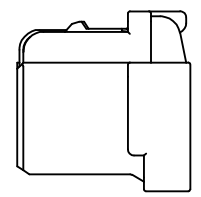

24.0	29.8	△	503149340*	34
22.5	28.3		503149320*	32
21.0	26.8		503149300*	30
19.5	25.3		503149280*	28
18.0	23.8		503149260*	26
16.5	22.3		503149240*	24
15.0	20.8		503149220*	22
13.5	19.3		503149200*	20
12.0	17.8		503149180*	18
10.5	16.3		503149160*	16
9.0	14.8		503149140*	14
7.5	13.3		503149120*	12
6.0	11.8		503149100*	10
4.5	10.3		503149080*	8
B	A		MATERIAL AND ORDER No. △	CIRCUIT No.

REVISED EC NO: J2015-0528 DRWN: TAKAIKE 2014/10/23 CHKD: KASAKAWA 2015/02/16 APPR: NUKITA 2015/02/16	GENERAL TOLERANCES (UNLESS SPECIFIED)		DIMENSION STYLE MM ONLY		SCALE 4:1	DESIGN UNITS METRIC	THIRD ANGLE PROJECTION	
	0.25 UNDER	±0.03	DRAWN BY T. HANYU	DATE 2008/1/8	TITLE 1.5 W/B CONN. DUAL PLUG HOUSING			
	0.25 OVER 0.5 UNDER	±0.05	CHECKED BY K. ASAKAWA	DATE 2008/1/8				
	0.5 OVER 1.0 UNDER	±0.1	APPROVED BY YO. ITO	DATE 2008/1/8				
	1.0 OVER 10 UNDER	±0.2	MATERIAL NO.	DOCUMENT NO.	SEE TABLE		SD-503149-001	SHEET NO. 1 OF 2
10 OVER 30 UNDER	±0.25	DRAFT WHERE APPLICABLE MUST REMAIN WITHIN DIMENSIONS		THIS DRAWING CONTAINS INFORMATION THAT IS PROPRIETARY TO MOLEX INCORPORATED AND SHOULD NOT BE USED WITHOUT WRITTEN PERMISSION				
30 OVER	±0.3							
ANGULAR	±1 °							

9 8 7 6 5 4 3 2 1

NOTES

- 1. 材料 PBT UL94V-0
MATERIAL
- ④ 2. 嵌合相手: 503148, 503154, 505406シリーズ
MATE WITH : 503148, 503154, 505406 SERIES
- 3. 適合ターミナル: 502579, 503429シリーズ
APPLICABLE TERMINAL : 502579, 503429 SERIES
- △ 4. 極数/2=偶数極の場合に適用
APPLY FOR (CIRCUIT/2=EVEN)
- △ 5. 製品番号
MATERIAL No.

503149 - $\times \times 0 \times$
極数 色
 CIRCUIT SIZE COLOR

COLOR	黒 BLACK	赤 RED	青 BLUE	緑 GREEN	ベージュ BEIGE (NATURAL)
COLOR No.	1	2	4	6	0

- 6. 本製品のプラスチック部に黒点・白点等が確認される場合や色合いが異なる場合がありますが、製品性能に問題はありません。
THERE IS NO INFLUENCE IN THE PRODUCT PERFORMANCE THOUGH THE BLACK AND WHITE SPOT ETC. MIGHT BE CONFIRMED TO THE PLASTIC PART OF THIS PRODUCT AND THE SADE MIGHT BE DIFFERENT.
- △ 7. トレードマーク: Mプラス 2文字の製造工場を示すアルファベットにて表示。
'但し、"J"はJAPANを"L"はMALAYSIAを示す。(例 MXJ 又はMXL)'
金型番号: アルファベット1文字にて表示。(例 1A, 12A, 1B, 12B)
FORMED BY M AND FROM 1 TO 2 MORE LETTER OF ALPHABET WHICH MEAN THE MANUFACTORY.
'BUT "J" MEANS JAPAN. "L" MEANS MALAYSIA (TO TRADE MARK)' (e.g. MXJ OR MXL).
AND BY 1 - 2 DIGIT NUMBER (TO CAVITY NO.)
"AND BY 1 LETTER OF ALPHABET (TO MOLD NO.)"(e.g. 1A, 12A, 1B, 12B)."
- 8. アプリケーション仕様書(コネクタ取扱説明書): AS-503149-001
APPLICATION SPECIFICATIONS (CONNECTOR MANUAL) : AS-503149-001
- 9. 製品仕様書: PS-503148-001 / PS-503154-001
PRODUCT SPECIFICATION : PS-503148-001 / PS-503154-001
- 10. ELV及びRoHS適合品
ELV AND RoHS COMPLIANT
- △ 11. 34極品の色対応はベージュと黒色のみとなります。
A COLOR OF 34CKT. IS ONLY BEIGE AND BLACK.

REVISED	EC NO: J2015-0528	2014/10/23	GENERAL TOLERANCES (UNLESS SPECIFIED)		DIMENSION STYLE		SCALE	DESIGN UNITS	THIRD ANGLE PROJECTION
	DRWN: TAKAIKE	2015/02/16	0.25 UNDER	±0.03	MM ONLY		1:1	METRIC	
	CHKD: KASAKAWA	2015/02/16	0.25 OVER 0.5 UNDER	±0.05	DRAWN BY DATE		TITLE		
	APPR: NUKITA	2015/02/16	0.5 OVER 1.0 UNDER	±0.1	T. HANYU 2008/1/8		1.5 W/B CONN. DUAL PLUG HOUSING		
REV	DESCRIPTION		1.0 OVER 10 UNDER	±0.2	CHECKED BY DATE		DOCUMENT NO.		SHEET NO.
	10 OVER 30 UNDER		±0.25	K. ASAKAWA 2008/1/8		SD-503149-001		2 OF 2	
	30 OVER		±0.3	APPROVED BY DATE		SEE SHEET 1			THIS DRAWING CONTAINS INFORMATION THAT IS PROPRIETARY TO MOLEX INCORPORATED AND SHOULD NOT BE USED WITHOUT WRITTEN PERMISSION
	ANGULAR ±1 °			Y0. ITO 2008/1/8					
DRAFT WHERE APPLICABLE MUST REMAIN WITHIN DIMENSIONS			SIZE						
			A3						