

# Non-Insulated Ring Connectors

159-1217, 159-1219, 159-1220, 159-1221



Non-Insulated Ring Connectors

159-1217, 159-1219, 159-1220, 159-1221

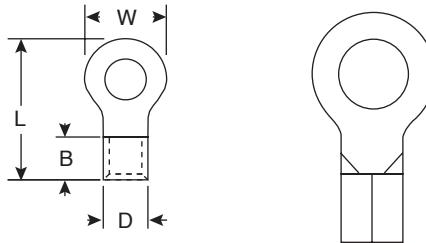

SPECIFICATIONS	
Wire Range:	12-10 AWG
Maximum Electric Current:	48 amps
Terminal Material:	Copper, .039" ( 1.0mm) thick
Seam:	Brazed
Terminals:	Non-insulated

Mouser Stock No.	Stud Size	Dimensions: In.			
		W	L	B	D
159-1217	#8	.374	.780	.268	.220
159-1219	1/4	.472	1.016	.268	.220
159-1220	5/18	.591	1.102	.268	.220
159-1221	5/18	.591	1.102	.268	.220

Date Last Revised: 6-24-05

Available from Mouser Electronics  
1-800-346-6873  
www.mouser.com

KC-300033

# Mouser Electronics

Authorized Distributor

Click to View Pricing, Inventory, Delivery & Lifecycle Information:

[Kobiconn:](#)

[159-1217](#) [159-1219](#) [159-1220](#) [159-1221](#)