



DIN Signal male connector - SMC



General information

Design	IEC 60603-2 types: B, 2B, 3B, C, 2C, 3C, M male		
No. of contacts	max. 96		
Contact spacing	2,54mm		
Test voltage	1000V		
Contact resistance	max. 15mOhm		
Insulation resistance	min. 10 ⁹ Ohm		
Working current	2A at 20°C (only signal contacts, see derating diagram)		
Temperature range	-55°C ... +125°C		
Termination technology	SMC with solder pins		
Clearance & creepage distance	min. 1,2mm each		
Insertion and withdrawal force	16-pole max. 15N	20-pole max. 20N	
	30-pole max. 30N	32-pole max. 30N	
	48-pole max. 45N	64-pole max. 60N	96-pole max. 90N
Mating cycles	PL 1 acc. to IEC 60603-2	500 mating cycles	
	PL 2 acc. to IEC 60603-2	400 mating cycles	
	PL 3 acc. to IEC 60603-2	50 mating cycles	
UL file	E102079		
RoHS - compliant	Yes		
Leadfree	Yes		
Hot plugging	No		

Insulator material

Material	PCT (thermoplastics, glass fiber reinforcement 30%)
Colour	natural coloured, colour deviations and speckles permitted
UL classification	UL 94-V0
Material group acc. IEC 60664-1	II (400 ≤ CTI < 600)
NFF classification	I3, F3

Contact material

Contact material	Copper alloy
Plating termination zone	Sn over Ni
Plating contact zone	Au over PdNi over Ni
	PL S4: 0,06µm Au over 0,7µm PdNi over 2,0µm Ni

Derating diagram acc. to IEC 60512-5 (Current carrying capacity)

The current carrying capacity is limited by maximum temperature of materials for inserts and contacts including terminals.

The current capacity curve is valid for continuous, non interrupted current loaded contacts of connectors when simultaneous power on all contacts is given, without exceeding the maximum temperature.

Control and test procedures according to DIN IEC 60512-5

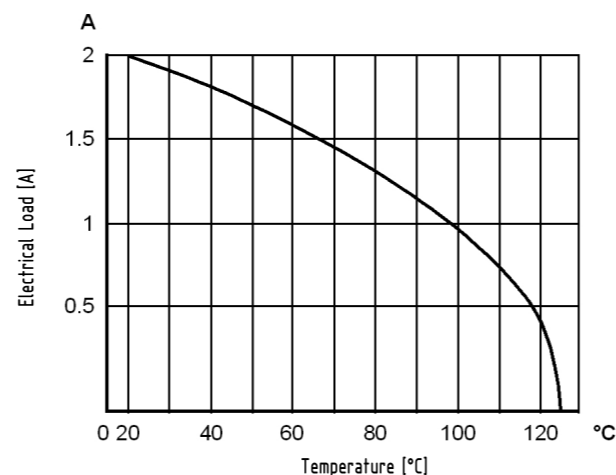

Soldering instructions

SMC (Surface Mount Compatible) connectors are designed to be used in a reflow oven together with other SMD (Surface Mount Device) components. In this process, called as well „Pin in Hole Intrusive Reflow“, the connectors are inserted into plated through holes in a comparable way to conventional component mounting. All other components can be assembled on the pcb surface.

The length of the connector contacts should be such that they protrude by no more than 1.5 millimetres after insertion to the pcb. Each contact collects solder on its tip as it penetrates the solder paste in the hole. So if the contact is too long, this solder would no longer be able to reflow back into the plated through hole by capillary action during the soldering process, therefore the quality of the soldered connection would suffer as a result.

Quantity of solder paste

Before the components are assembled, solder paste must be applied to all the solder pads (for connecting surface-mount components) and the plated through holes. To ensure that the plated through holes are completely filled, significantly more solder paste must be applied than traditional solder pads on the pcb surface. There are numerous calculation methods available which are complicated to apply. The following rule of thumb has proved valuable in practice:

$$VPaste = 2(VH - VP)$$

in which:
 VPaste = Required volume of solder paste
 VH = Volume of the plated through hole
 VP = Volume of the connector termination in the hole

Comment: the multiplier "2" compensates for solder paste shrinkage during soldering. For this purpose, it was assumed that 50 % of the paste consists of the actual solder, the other 50 % being soldering aids.

Cross section of solder pins

$$A = 0,29mm^2 - 0,33mm^2$$

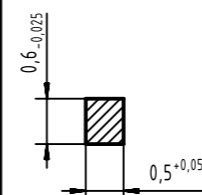

	All rights reserved	Created by	Inspected by	Standardisation	Date	State	
	Department EC PD - DE	HAGEMEYERE	TADJE	HOFFMANN	2016-10-25	Final Release	
HARTING Electronics GmbH		Title				Doc-Key / ECM-Nr.	
D-32339 Espelkamp		DIN Signal male connector - SMC				100561189/UGD/001/D 500000110255	
		Type	Number		Rev.	Page	
		DS	09031230201		D	1/1	