

THIS DRAWING IS UNPUBLISHED. RELEASED FOR PUBLICATION 2009
 © COPYRIGHT 2009 BY - ALL RIGHTS RESERVED.

| REVISIONS | | | | | |
|-----------|-----|---------------------------|-----------|-----|------|
| P | LTR | DESCRIPTION | DATE | DWN | APVD |
| | C2 | REVISED PER ECR-16-011494 | 20JUN2017 | NK | CX |

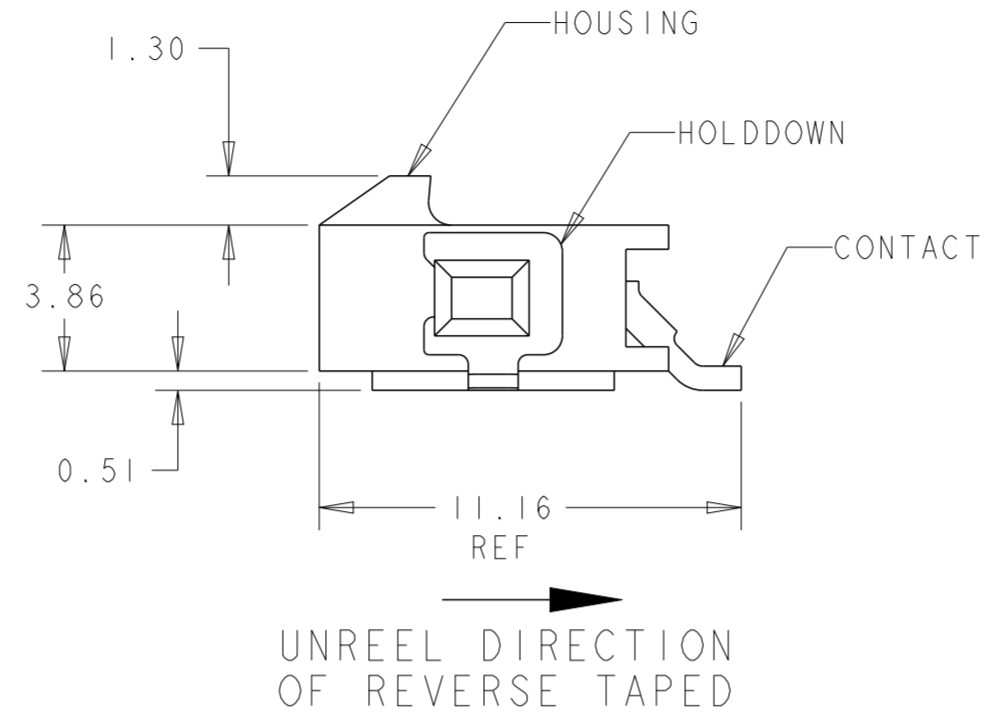

- 1 MATERIAL: CONTACTS - BRASS
HOUSING - UL 94V-0 RATED HIGH TEMP NYLON, COLOR BLACK.
HOLDDOWNS: - PHOSPHOR BRONZE.
- 2 PLATING: CONTACTS - 0.76µm MINIMUM GOLD ON MATING END, 2.54µm MINIMUM TIN LEAD ON SOLDER TAILS, BOTH OVER 1.27µm MINIMUM NICKEL.
HOLDDOWNS: 2.54µm MINIMUM MATTE TIN OVER 1.27µm MINIMUM NICKEL.
- 4 RECOMMENDED PC BOARD THICKNESS OF 1.57.
- 5 PLATING: CONTACTS - 0.76µm MINIMUM GOLD ON MATING END, 2.54µm MINIMUM MATTE TIN ON SOLDER TAILS, BOTH OVER 1.27µm MINIMUM NICKEL.
HOLDDOWNS: 2.54µm MINIMUM MATTE TIN OVER 1.27µm MINIMUM NICKEL.

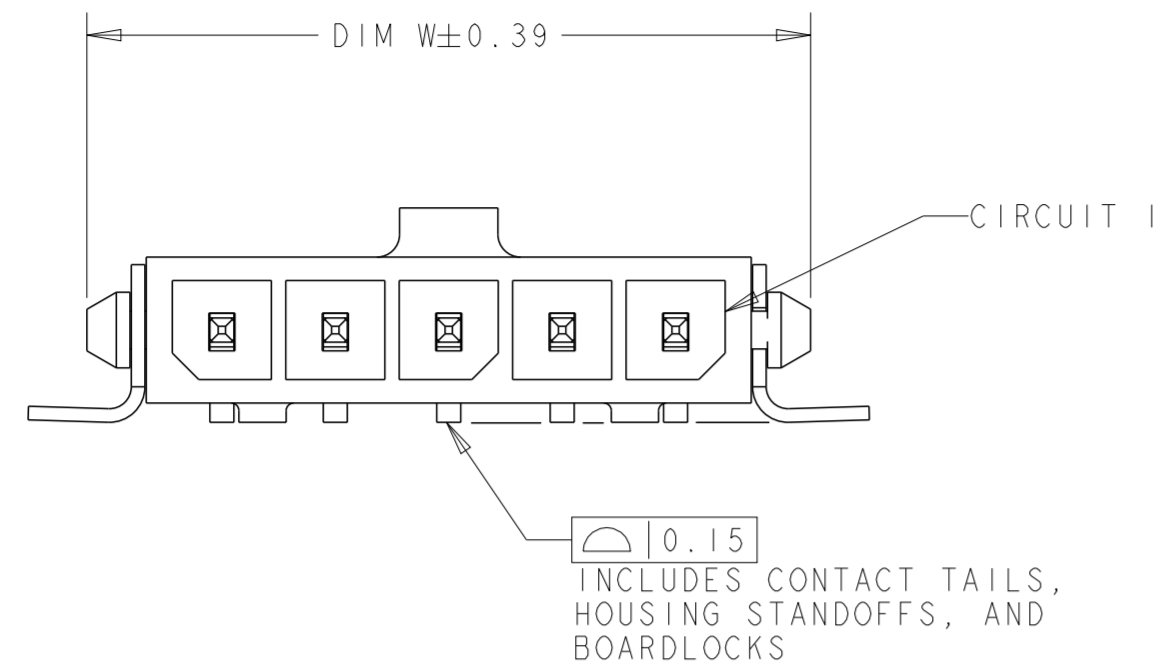
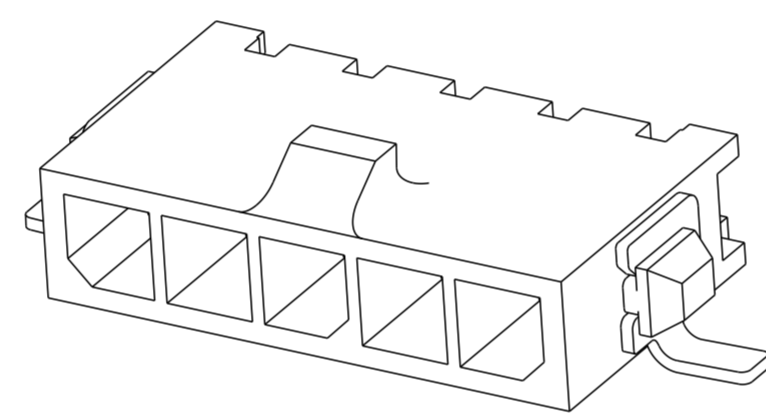
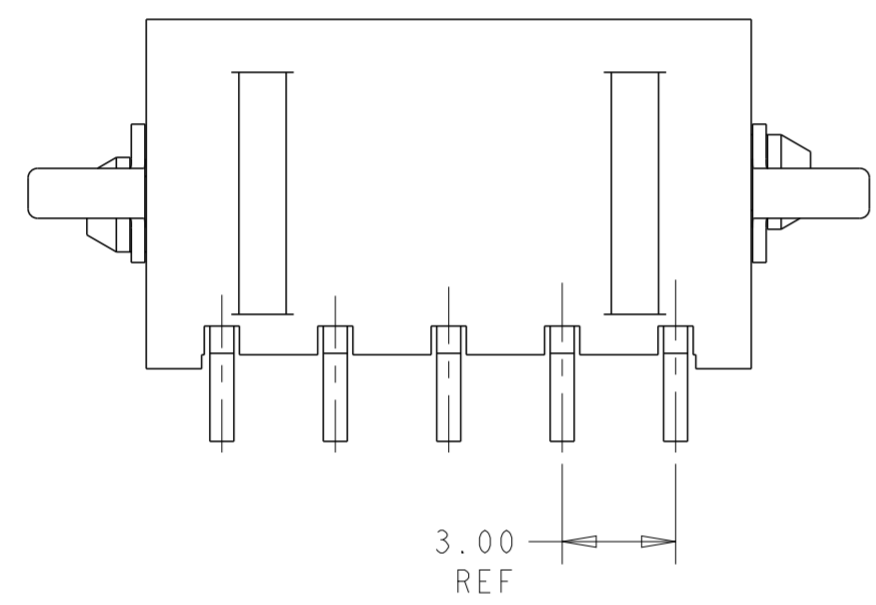

| REVERSE TAPED | 5 | 9.00 | 16.41 | 16.00 | 4 | 6-1445100-4 |
|---------------------------|---|-------|-------|-------|----|-------------|
| TAPED | 5 | 33.00 | 40.41 | 40.00 | 12 | 3-1445100-2 |
| TAPED | 5 | 30.00 | 37.41 | 37.00 | 11 | 3-1445100-1 |
| TAPED | 5 | 27.00 | 34.41 | 34.00 | 10 | 3-1445100-0 |
| TAPED | 5 | 24.00 | 31.41 | 31.00 | 9 | 2-1445100-9 |
| TAPED | 5 | 21.00 | 28.41 | 28.00 | 8 | 2-1445100-8 |
| TAPED | 5 | 18.00 | 25.41 | 25.00 | 7 | 2-1445100-7 |
| TAPED | 5 | 15.00 | 22.41 | 22.00 | 6 | 2-1445100-6 |
| TAPED | 5 | 12.00 | 19.41 | 19.00 | 5 | 2-1445100-5 |
| TAPED | 5 | 9.00 | 16.41 | 16.00 | 4 | 2-1445100-4 |
| TAPED | 5 | 6.00 | 13.41 | 13.00 | 3 | 2-1445100-3 |
| TAPED | 5 | 3.00 | 10.41 | 10.00 | 2 | 2-1445100-2 |
| SUPERSEDED BY 3-1445055-2 | 2 | 33.00 | 40.41 | 40.00 | 12 | +1445100-2 |
| SUPERSEDED BY 3-1445055-1 | 2 | 30.00 | 37.41 | 37.00 | 11 | +1445100-1 |
| SUPERSEDED BY 3-1445055-0 | 2 | 27.00 | 34.41 | 34.00 | 10 | +1445100-0 |
| SUPERSEDED BY 2-1445055-9 | 2 | 24.00 | 31.27 | 31.00 | 9 | +445100-9 |
| SUPERSEDED BY 2-1445055-8 | 2 | 21.00 | 28.41 | 28.00 | 8 | +445100-8 |
| SUPERSEDED BY 2-1445055-7 | 2 | 18.00 | 25.41 | 25.00 | 7 | +445100-7 |
| SUPERSEDED BY 2-1445055-6 | 2 | 15.00 | 22.41 | 22.00 | 6 | +445100-6 |
| SUPERSEDED BY 2-1445055-5 | 2 | 12.00 | 19.41 | 19.00 | 5 | +445100-5 |
| SUPERSEDED BY 2-1445055-4 | 2 | 9.00 | 16.41 | 16.00 | 4 | +445100-4 |
| SUPERSEDED BY 2-1445055-3 | 2 | 6.00 | 13.41 | 13.00 | 3 | +445100-3 |
| SUPERSEDED BY 2-1445055-2 | 2 | 3.00 | 10.41 | 10.00 | 2 | +445100-2 |

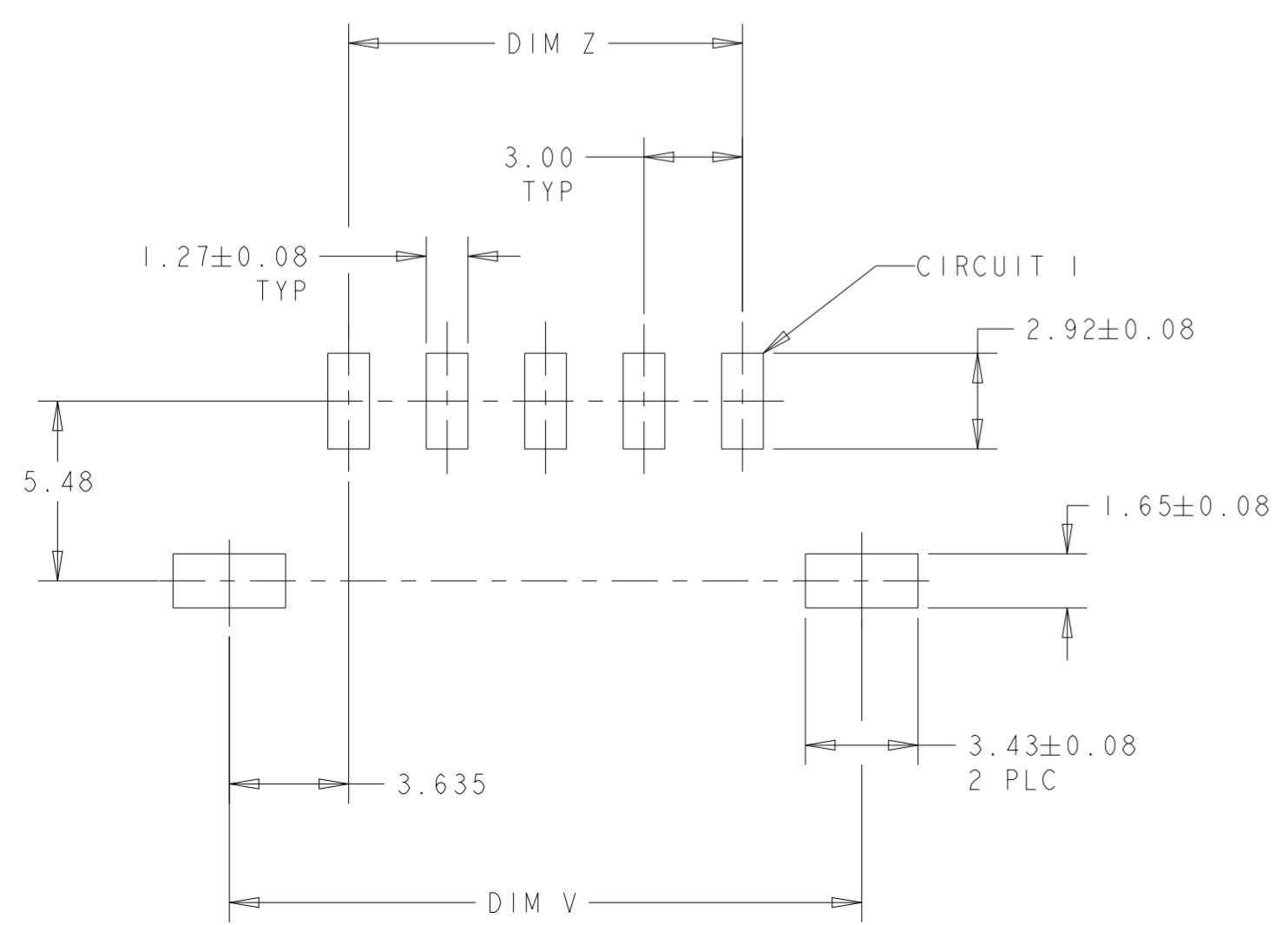

PCB LAYOUT COMPONENT SIDE 4

| | | | | | | | |
|---------------------------|-------|---|-------|-------|-------|----|------------|
| SUPERSEDED BY 3-1445055-2 | TAPED | 2 | 33.00 | 40.41 | 40.00 | 12 | +1445100-2 |
| SUPERSEDED BY 3-1445055-1 | TAPED | 2 | 30.00 | 37.41 | 37.00 | 11 | +1445100-1 |
| SUPERSEDED BY 3-1445055-0 | TAPED | 2 | 27.00 | 34.41 | 34.00 | 10 | +1445100-0 |
| SUPERSEDED BY 2-1445055-9 | TAPED | 2 | 24.00 | 31.27 | 31.00 | 9 | +445100-9 |
| SUPERSEDED BY 2-1445055-8 | TAPED | 2 | 21.00 | 28.41 | 28.00 | 8 | +445100-8 |
| SUPERSEDED BY 2-1445055-7 | TAPED | 2 | 18.00 | 25.41 | 25.00 | 7 | +445100-7 |
| SUPERSEDED BY 2-1445055-6 | TAPED | 2 | 15.00 | 22.41 | 22.00 | 6 | +445100-6 |
| SUPERSEDED BY 2-1445055-5 | TAPED | 2 | 12.00 | 19.41 | 19.00 | 5 | +445100-5 |
| SUPERSEDED BY 2-1445055-4 | TAPED | 2 | 9.00 | 16.41 | 16.00 | 4 | +445100-4 |
| SUPERSEDED BY 2-1445055-3 | TAPED | 2 | 6.00 | 13.41 | 13.00 | 3 | +445100-3 |
| SUPERSEDED BY 2-1445055-2 | TAPED | 2 | 3.00 | 10.41 | 10.00 | 2 | +445100-2 |

| PACKAGING | FINISH | DIM Z | DIM V | DIM W | NO. OF POSN | PART NUMBER |
|--|--------|--|-------|--|-------------|-------------|
| THIS DRAWING IS A CONTROLLED DOCUMENT. | | | | | | |
| DIMENSIONS: mm | | TOLERANCES UNLESS OTHERWISE SPECIFIED: | | DWN J. ROOT 09OCT2000 | | |
| 0 PLC ± | | 1 PLC ± | | CHK K. WHITAKER 17-APR-2001 | | |
| 2 PLC ±0.13 | | 3 PLC ± | | APVD C. JONES 17-APR-2001 | | |
| 4 PLC ± | | ANGLES ± | | NAME | | |
| FINISH | | SEE TABLE | | STE TE Connectivity | | |
| MATERIAL | | SEE TABLE | | RIGHT ANGLE SURFACE MNT HEADER ASSY, 0.76 MIC GOLD CONTACTS, W/SURF MOUNT, HOLDDOWNS, SGL ROW, MICRO MATE-N-LOK™ | | |
| CUSTOMER DRAWING | | SCALE 5:1 | | SHEET 1 OF 1 | | REV C2 |

Mouser Electronics

Authorized Distributor

Click to View Pricing, Inventory, Delivery & Lifecycle Information:

[TE Connectivity:](#)

[1445100-9](#)