

		1					
LOC	DIST	REVISIONS					
GP	00	P	LTR	DESCRIPTION	DATE	DWN	APVD
			A	RELEASED	22SEP2011	RG	DO
			B	REV PER ECO-11-020848	25OCT2011	RG	DO

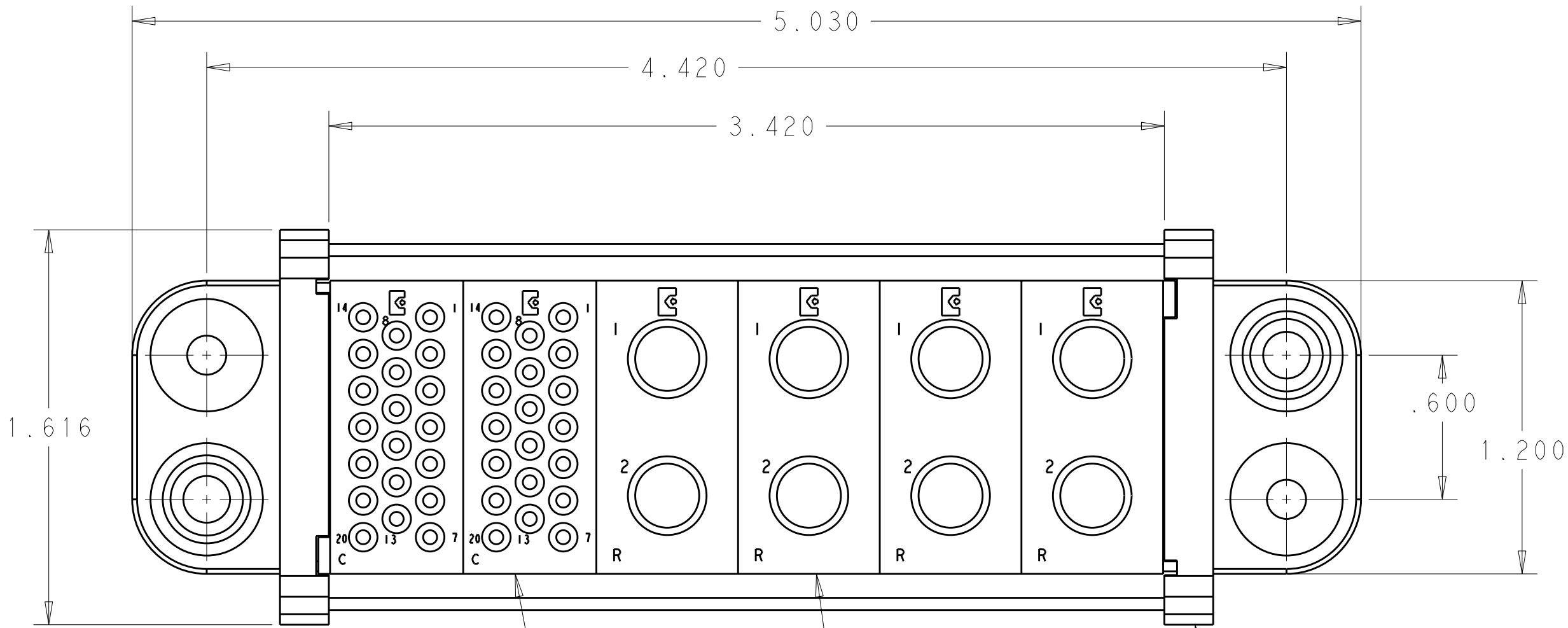

1 ITEMS PROVIDED TO THIS SPECIFICATION TO BE PERMANENTLY IDENTIFIED PER THE FOLLOWING IDENTIFIER:

TE PART NUMBER AND MANUFACTURING DATE CODE

2 MOUNTING FLANGE BUSHING ACCEPTS 6/32 SCREW ($\varnothing .156$ CLEARANCE HOLE, FLOAT MOUNT) OR 8/32 SCREW ($\varnothing .173$ CLEARANCE HOLE, FIXED MOUNT) USER SUPPLIED.

3 SOCKET CONTACTS (ITEM D AND E) WILL BE PACKAGED SEPARATELY AND SHIPPED LOOSE WITH THE CONNECTOR ASSEMBLY.

4. CONNECTOR MATES WITH PN 2085862-1

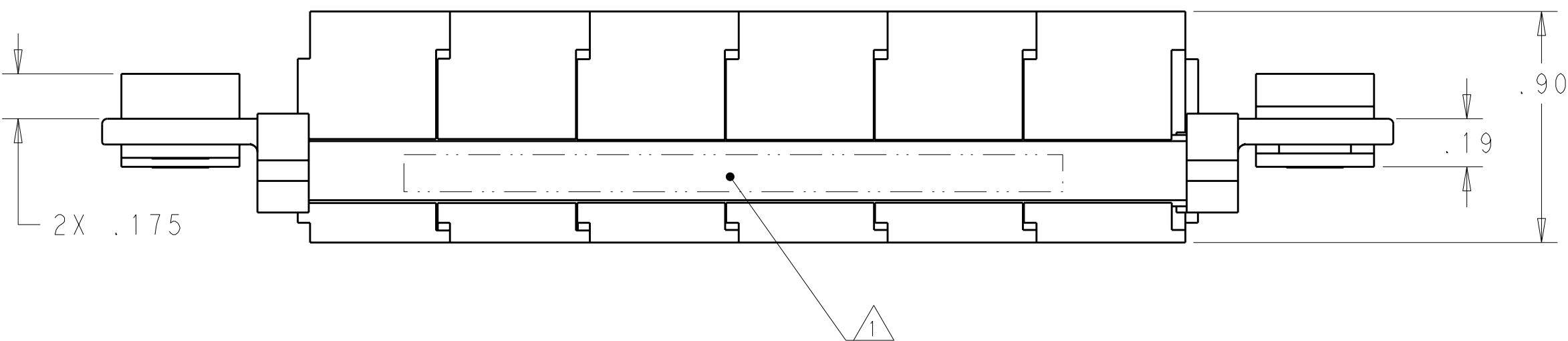

30	1648382-1	SOCKET CONTACT, SIZE No. 20, PCB TAIL	E
7	6648434-1	SOCKET CONTACT, W/ No.4 AWG CRIMP	D
2	1648468-1	MODULE "C"	C
4	6648457-1	MODULE "R"	B
2	6648252-1	END CAP, GUIDE SOCKET, FLOAT	A
-1	PART NO.	DESCRIPTION	ITEM

THIS DRAWING IS A CONTROLLED DOCUMENT.		DWN R.GRZYBOWSKI 20SEP2011	TE Connectivity			
DIMENSIONS: INCHES		CHK D.ORRIS 20SEP2011				
TOLERANCES UNLESS OTHERWISE SPECIFIED:		APVD D.ORRIS 20SEP2011	NAME SOCKET CONNECTOR ASSEMBLY W/ PANEL CUT-OUT DOMINO			
0 PLC ± 1 PLC ± 2 PLC ±.02 3 PLC ±.010 4 PLC ± ANGLES ± FINISH		PRODUCT SPEC - APPLICATION SPEC - WEIGHT -	SIZE A200779	CAGE CODE C-2085863	DRAWING NO -	RESTRICTED TO -
MATERIAL -		CUSTOMER DRAWING	SCALE 2:1	SHEET 1	OF 2	REV B

ELCON DOMINO

LOC	DIST	REVISIONS					
GP	00	P	LTR	DESCRIPTION	DATE	DWN	APVD
			-	SEE SHEET 1	-	-	-

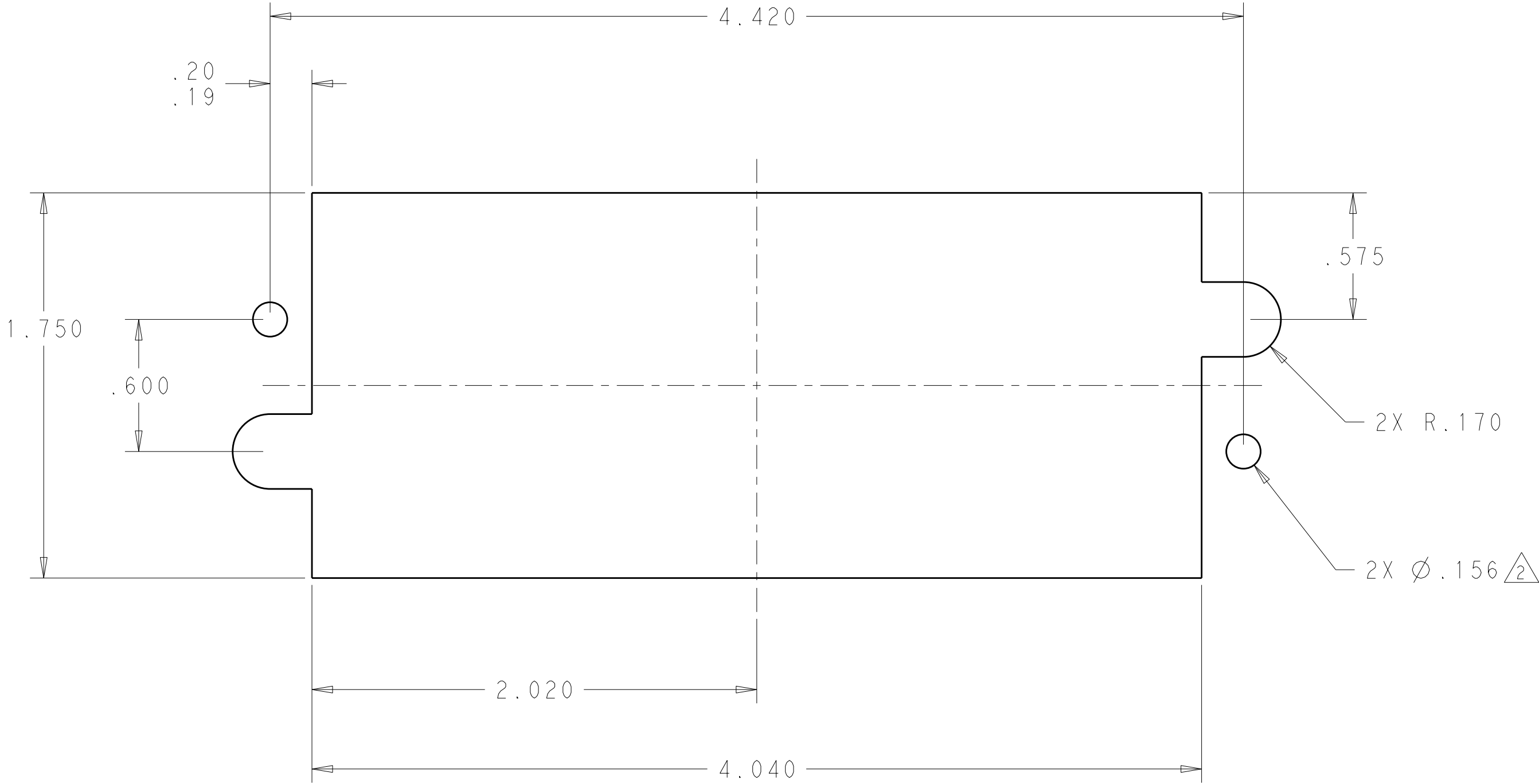

SOCKET PANEL MOUNT CUT-OUT

THIS DRAWING IS A CONTROLLED DOCUMENT.

DWN
R. GRZYBOWSKI
20SEP2011

CHK
D. ORRIS
20SEP2011

APVD
D. ORRIS
20SEP2011

TE Connectivity

NAME
SOCKET CONNECTOR ASSEMBLY
W/ PANEL CUT-OUT
DOMINO

SIZE
A200779

CAGE CODE
C-2085863

DRAWING NO
C-2085863

RESTRICTED TO
-

DIMENSIONS:
INCHES

TOLERANCES UNLESS OTHERWISE SPECIFIED:

0 PLC ±

1 PLC ±

2 PLC ±.02

3 PLC ±.010

4 PLC ±

ANGLES ±

FINISH

MATERIAL
-

PRODUCT SPEC
-

APPLICATION SPEC
-

WEIGHT
-

CUSTOMER DRAWING

SCALE
2:1

SHEET
2

OF
2

REV
B

1471-9 (3/11)

Mouser Electronics

Authorized Distributor

Click to View Pricing, Inventory, Delivery & Lifecycle Information:

[TE Connectivity:](#)

[2085863-1](#)