

2 POS

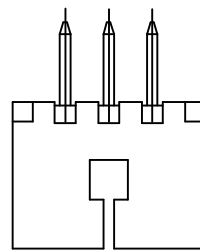

3 POS

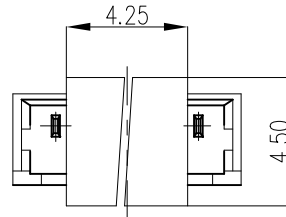
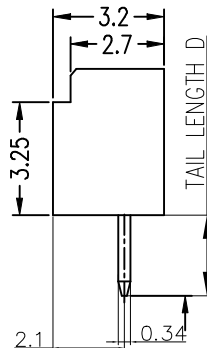
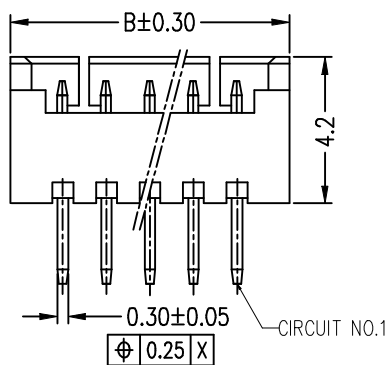

ASSEMBLY CAP
2POS~15POS

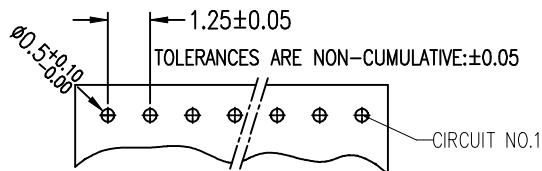

P.C. BOARD LAYOUT
(PCB THK=0.8)

NOTES

- SPECIFICATIONS**
Current Rating: 1A AC,DC
Voltage Rating: 125V AC,DC
Temperature Range: -40°C ~ +105°C
Contact Resistance: 20mΩ Max.
Insulation Resistance: 100MΩ Min.
Withstanding Voltage: 500V AC/minute
- Material & finish:**
Housing: Natural Thermoplastic, UL94V-0
Contact and metal hold-down: Phosphor Bronze
Plating of contact: Matte Tin or gold plating over Nickel
- Product specification:** GS-12-675
- Packaging specification:** GS-14-1593
- Ordering Information & Dimensions:**
Material 10114829- X X X X LF
1LCP NATURAL
2LCP BLACK
Plating 0: Matte Tin
1: Gold Flash
3: Gold 30u" on contact area
4: Gold Flash solder tail and 30u" gold plating on contact area
LF: See note A
pin code from 02-15(D=2.30mm)
pin code from 22-35(D=1.90mm)
Packaging 1:Tape&Reel
2:Tape&Reel+Cap

Part No.		Dimensions			
D=2.30mm	D=1.90mm	POS	A	B	C
10114829-xxx02LF	10114829-xxx22LF	2	1.25±0.10	4.25	3.05
10114829-xxx03LF	10114829-xxx23LF	3	2.50±0.10	5.50	4.30
10114829-xxx04LF	10114829-xxx24LF	4	3.75±0.10	6.75	5.55
10114829-xxx05LF	10114829-xxx25LF	5	5.00±0.10	8.00	6.80
10114829-xxx06LF	10114829-xxx26LF	6	6.25±0.15	9.25	8.05
10114829-xxx07LF	10114829-xxx27LF	7	7.50±0.15	10.50	9.30
10114829-xxx08LF	10114829-xxx28LF	8	8.75±0.15	11.75	10.55
10114829-xxx09LF	10114829-xxx29LF	9	10.00±0.15	13.00	11.80
10114829-xxx10LF	10114829-xxx30LF	10	11.25±0.20	14.25	13.05
10114829-xxx11LF	10114829-xxx31LF	11	12.50±0.20	15.50	14.30
10114829-xxx12LF	10114829-xxx32LF	12	13.75±0.20	16.75	15.55
10114829-xxx13LF	10114829-xxx33LF	13	15.00±0.20	18.00	16.80
10114829-xxx14LF	10114829-xxx34LF	14	16.25±0.20	19.25	18.05
10114829-xxx15LF	10114829-xxx35LF	15	17.50±0.20	20.50	19.30

mat'l. code		surface ISO 1302 ✓		tolerance ISO 406 ISO		projection 11011		product family WTB	
ltr		ecn no		dr		date		title	
A		T10-0145		JH		12/1/10		WTB 1.25MM WAFER 180 DIP	
E		ELX-N-17971		TIM		06/17/14		scale 1:1	
F		ELX-N-23435		TIM		03/03/16		Amphenol FCI	
G		ELX-N-27076		TONY		05/24/17		sheet 1 of 1 size	
				dr		JASON HSU 12/1/10		10114829 A3	
				engr		JASON HSU 12/1/10		type Product Customer Drawing	
				chr		GARY HSIEH 12/1/10			
				appd		JOSEPH HSIA 12/1/10			
sheet index		revision sheet		G 1					

Mouser Electronics

Authorized Distributor

Click to View Pricing, Inventory, Delivery & Lifecycle Information:

[FCI / Amphenol:](#)

[10114829-13104LF](#) [10114829-13202LF](#) [10114829-13105LF](#) [10114829-13203LF](#) [10114829-11203LF](#) [10114829-11202LF](#) [10114829-11222LF](#) [10114829-11208LF](#) [10114829-10404LF](#) [10114829-11206LF](#) [10114829-11205LF](#)