

OBSOLETE
 April 2019
 PCR 23851

SUGGESTED PCB LAYOUT

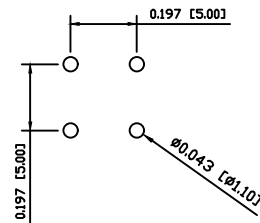

SCHEMATIC

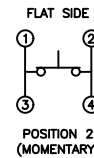
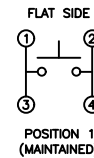

SPECIFICATIONS

FUNCTION:
 1P1T OFF-(ON)

RATINGS:
 10mA 35VDC

OPERATION FORCE:
 130±40gf

CONTACT RESISTANCE:
 Initial: 20mΩ Max.

INSULATION RESISTANCE:
 100MΩ Min. at 500VDC

DIELECTRIC STRENGTH:
 500VAC For 1 Minute

CAPACITANCE:
 1pF

ELECTRICAL LIFE:
 250,000 Cycles

MECHANICAL LIFE:
 500,000 Cycles Min.

TEMPERATURE:
 Operating: -20°C to 85°C

APPROVALS:
RoHS
 COMPLIANT

MATERIALS

UPPER HOUSING:
 Acrylonitrile Butadiene Styrene (ABS)

LOWER HOUSING:
 Polybutylene Terephthalate (PBT)

CONTACTS:
 Silver Plated Copper

TERMINALS:
 Silver Plated Brass

COLORS

UPPER HOUSING COLOR:
 Green

LOWER HOUSING COLOR:
 White

BODY	A	09/08/06	CAB
COLORS	A	09/08/06	CAB
MATERIALS	A	09/08/06	CAB
SPECIFICATIONS	A	09/08/06	CAB
REFERENCE	REV.	DATE	BY

THE INFORMATION CONTAINED IN THIS DOCUMENT IS PROPRIETARY TO E-SWITCH AND IS NOT TO BE COPIED OR TRANSFERRED.

INITIAL RELEASE	PCR00051	09/08/06	CAB
DESCRIPTION	PCR	DATE	DRAWN BY

DIMENSIONS	INCHES [MILLIMETERS]
GENERAL TOLERANCES	±0.008 [±0.2] / ±1°
SCALE	DRAWING NOT TO SCALE
PROJECTION	First Angle

E-SWITCH | **LAMB INDUSTRIES**

KS-00Q-03

DRAWING NUMBER: 29-KS00Q03 | DATE: AUGUST 6, 2009 | REVISION: A

Mouser Electronics

Authorized Distributor

Click to View Pricing, Inventory, Delivery & Lifecycle Information:

[E-Switch:](#)

[KS-00Q-03](#)