

PRODUCT DATA DRAWING

REVISION HISTORY			
REV	DESCRIPTION	DATE	APPROVED
D	DCN 38201	05/11	PJS

MATERIAL:

BODIES, COUPLING NUT:	STAINLESS STEEL PER AMS-5640, ALLOY UNS S30300, TYPE 1
LOCK RINGS, CONTACTS:	BERYLLIUM COPPER PER ASTM B196, ALLOY No. UNS C17300, TD04
SLEEVE:	BRASS PER ASTM B16, ALLOY UNS No. C36000
BELLOWS:	ELECTRO-DEPOSITED GOLD OVER NICKEL
INSULATORS:	PTFE PER ASTM D1710, TYPE I, GRADE 1, CLASS B
GASKETS:	SILICONE RUBBER PER A-A-59588, CLASS 2B, GRADE 50/60
RESISTOR ELEMENTS:	ALUMINA SUBSTRATE WITH TANTALUM NITRIDE RESISTOR

FINISH:

BODIES, COUPLING NUT:	PASSIVATED PER AMS-2700
CONTACTS, SLEEVE:	GOLD PER ASTM B488, TYPE II, CODE C, CLASS 1.27; OVER NICKEL PER AMS-QQ-N-290, CLASS 1, .00005" MIN.

PERFORMANCE:

IMPEDANCE:	50 OHMS
FREQ. RANGE:	DC TO 12.4 GHz
VSWR:	SEE TABLE 1
OPERATING TEMP.:	-55°C TO +125°C
AVG. POWER:	2 WATT (POWER INPUT DERATED LINEARLY FROM 25°C TO 0.5 WATTS AT 125°C)
PEAK POWER:	200 WATTS (PEAK POWER FOR A DUTY CYCLE OF 5X10-4 MAXIMUM PULSE DURATION OF 5 MICROSECONDS)

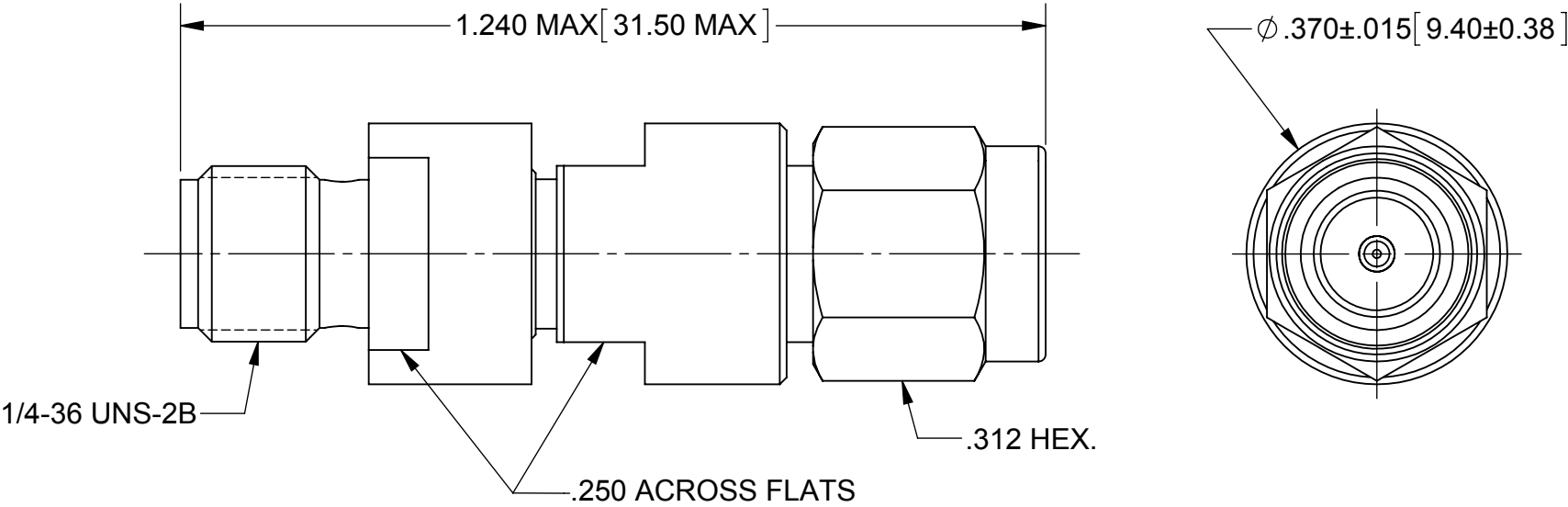

"XX" NUMBER TO dB VALUE CHART

"XX" NUMBER	dB VALUE
01	3
02	6
03	10
04	20
05	15
06	1
07	2
08	4
09	5

"XX" NUMBER	dB VALUE
10	7
11	8
12	9
18	16
19	14
20	13
21	12
22	11
23	1.5

TABLE 1				
dB VALUE	ATTENUATION ACCURACY	VSWR		
		2-4 GHz	4-8 GHz	8-12.4 GHz
1-6 dB	±0.3 dB	1.15:1	1.20:1	1.25:1
7-9 dB	±0.4 dB			
10 dB	±0.3 dB			
11-20 dB	±0.5 dB			

MATERIAL:	SEE NOTES	DIMENSIONS ARE IN INCHES TOLERANCES:	UNLESS OTHERWISE SPECIFIED		SV Microwave, Inc. 2400 Centrepark West Drive, Suite 100 West Palm Beach, FL 33409		
FINISH:	SEE NOTES	FRACTIONAL: ±1/64 ANGULAR: X° ±1°0' 					

Mouser Electronics

Authorized Distributor

Click to View Pricing, Inventory, Delivery & Lifecycle Information:

Amphenol:

M3933/25-27N	M3933/25-46N	M3933/25-60N	M3933/25-61N	M3933/25-61S	M3933/25-62N	M3933/25-62S
M3933/25-27S	M3933/25-28N	M3933/25-28S	M3933/25-29N	M3933/25-30S	M3933/25-31N	M3933/25-32N
M3933/25-33N	M3933/25-34N	M3933/25-35N	M3933/25-36N	M3933/25-64N	M3933/25-32S	M3933/25-83N
M3933/25-78N	M3933/25-78S	M3933/25-79S	M3933/25-80N	M3933/25-81N	M3933/25-88N	M3933/25-88S
M3933/25-70N	M3933/25-66S	M3933/25-67S	M3933/25-68N	M3933/25-68S	M3933/25-69S	M3933/25-71S
M3933/25-72S	M3933/25-73S	M3933/25-74N	M3933/25-74S	M3933/25-59N	M3933/25-03N	M3933/25-02N
M3933/25-01N	M3933/25-20N	M3933/25-17N	M3933/25-13N	M3933/25-30N	M3933/25-10S	M3933/25-76S
M3933/25-41N	M3933/25-64S	M3933/25-39N	M3933/25-58S	M3933/25-06N	M3933/25-05N	M3933/25-20S
M3933/25-70S	M3933/25-65S	M3933/25-86N	M3933/25-75N	M3933/25-02S	M3933/25-77N	M3933/25-72N
M3933/25-31S	M3933/25-84N	M3933/25-87S	M3933/25-66N	M3933/25-38S	M3933/25-79N	M3933/25-80S
M3933/25-19S	M3933/25-13S	M3933/25-84S	M3933/25-09N	M3933/25-12S	M3933/25-07N	M3933/25-08N
M3933/25-16S	M3933/25-43N	M3933/25-45N	M3933/25-69N	M3933/25-04S	M3933/25-77S	M3933/25-85N
M3933/25-85S	M3933/25-35S	M3933/25-63N	M3933/25-81S	M3933/25-82N	M3933/25-10N	M3933/25-87N
M3933/25-60S	M3933/25-34S	M3933/25-29S	M3933/25-76N	M3933/25-58N	M3933/25-33S	M3933/25-59S
M3933/25-82S	M3933/25-15N					