

THIS DOCUMENT IS THE PROPERTY OF
KEYSTONE ELECTRONICS CORP. AND
SHALL NOT BE REPRODUCED, DISTRIBUTED
OR USED AS A BASIS FOR MANUFACTURE
WITHOUT PRIOR WRITTEN PERMISSION
FROM KEYSTONE ELECTRONICS CORP.

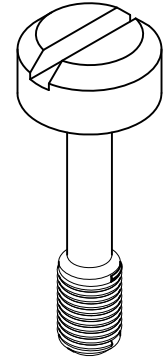
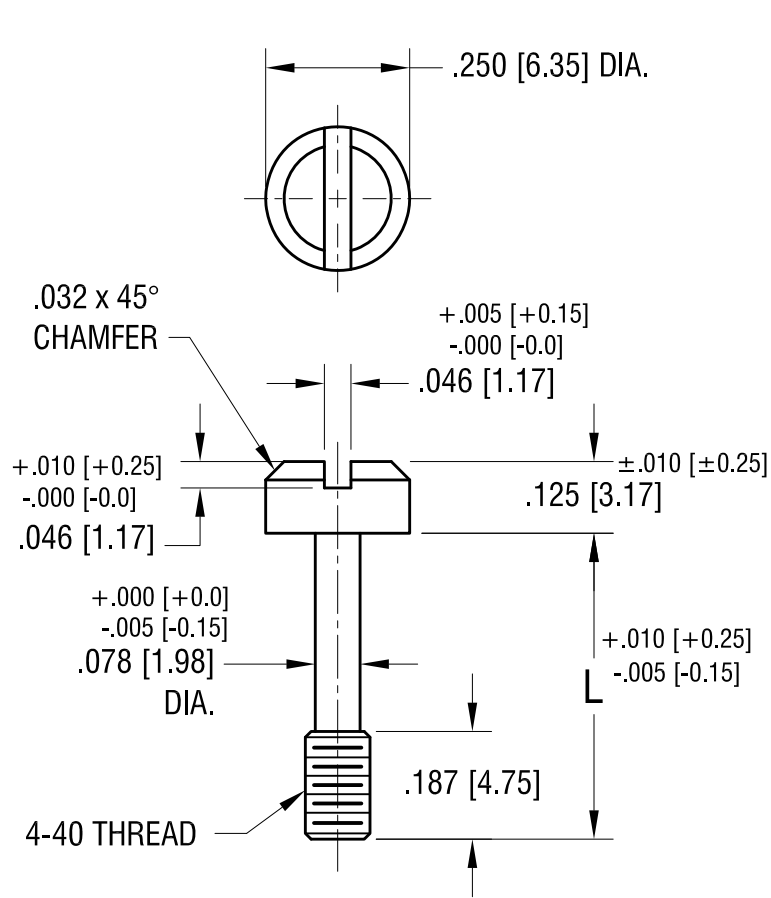

PART NO.	'L' DIM.
2413	.469 [11.91]
2414	.531 [13.49]

DATE	DESCRIPTION	REV.
12.17.10	CHANGE AS PER ECN 10-089	C
7.15.08	CHANGE AS PER ECN 08-123	B
3.27.08	CHANGE AS PER ECN 08-098	A

KEYSTONE ELECTRONICS CORP.			
ASTORIA, N.Y. 11105-2017			
PART NAME CAPTIVE SCREW			
MATERIAL STAINLESS STEEL			
FINISH -		DRN BY BOONE	DATE 12.5.95
		APP'D LN	SCALE 3X
TOLERANCES DECIMAL ANGULAR	INCH [MM] ± .005 [± 0.15] ± 1°	CODE C/M	DWG NO. 2413-2414
UNLESS OTHERWISE SPECIFIED			

Mouser Electronics

Authorized Distributor

Click to View Pricing, Inventory, Delivery & Lifecycle Information:

[Keystone Electronics:](#)

[2413](#)