

| MODEL<br>NUMBER | $\Omega$ |
|-----------------|----------|
| AD228           | 50       |
| UAD228          | 75       |

DATA CONTAINED IN THIS DOCUMENT IS PROPRIETARY  
TO EMERSON CONNECTIVITY SOLUTIONS AND SHALL NOT  
BE DISCLOSED, COPIED OR USED FOR PROCUREMENT OR  
MANUFACTURE WITHOUT EXPRESS WRITTEN PERMISSION

# REVISIONS

| REV | DESCRIPTIONS          | DATE    | APPROVED |
|-----|-----------------------|---------|----------|
| C   | REVISED PER ECO 16820 | 9/16/09 | LM       |

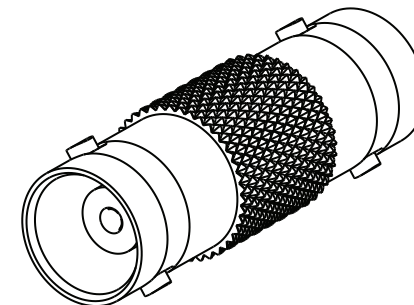

SCALE 2/1

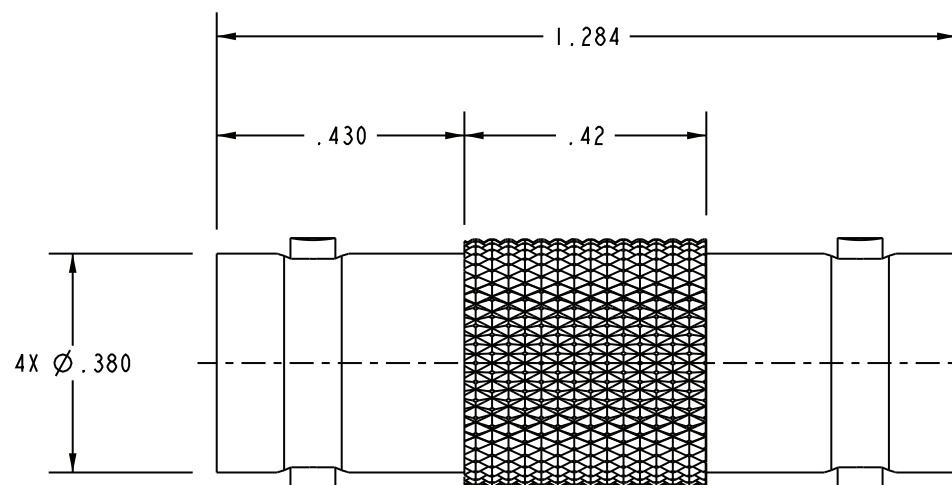
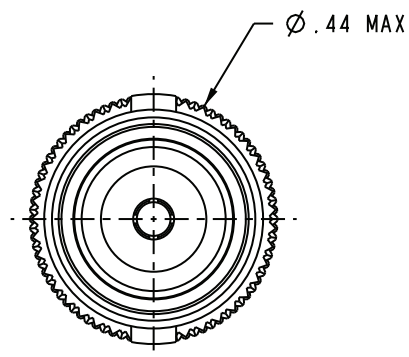

2. WITHIN SERIES FEMALE BNC FEEDTHRU  
ADAPTER, 50 $\Omega$  AND 75 $\Omega$  VERSIONS

1. FINISH: TFS-1A (NICKEL)

NOTES: UNLESS OTHERWISE SPECIFIED.

INTERPRET DRAWING PER  
MIL-STD-100.  
DIMENSIONS ARE IN INCHES  
AND INCLUDE FINISH  
THICKNESS  
UNLESS OTHERWISE SPECIFIED.

TOL: UNLESS SPECIFIED.

.XX  $\pm$  .02  
.XXX  $\pm$  .010  
ANGLE  $\pm$  1°



Cinch Connectivity Solutions  
299 Johnson Ave. Ste. 100  
Waseca, MN 56093  
1-800-247-8256

DRN  
W. JOHNSON

12/8/08

CHK  
LM

9/15/09

QUALITY

MANUF

APPROVED

PROJ TITLE NO.  
1-0623

MATERIAL:

FINISH:

TITLE:

U/AD228

SIZE

CAGE CODE

DRAWING NO.

REV.

A

14949

1-0623

C

SCALE

3/1

DATE 4/11/02

SHEET 1 OF 2

DO NOT SCALE DWG

# Mouser Electronics

Authorized Distributor

Click to View Pricing, Inventory, Delivery & Lifecycle Information:

[Cinch Connectivity Solutions:](#)

[UAD228](#)