

## PCB terminal block - MKDS 1/ 7-3,81 - 1727065

Please be informed that the data shown in this PDF Document is generated from our Online Catalog. Please find the complete data in the user's documentation. Our General Terms of Use for Downloads are valid (<http://phoenixcontact.com/download>)

PCB terminal block, Nominal current: 13.5 A, Nom. voltage: 200 V, Pitch: 3.81 mm, Number of positions: 7, Connection method: Screw connection with tension sleeve, Mounting: Wave soldering, Conductor/PCB connection direction: 0 °, Color: green



The figure shows a 10-position version of the product

### Product Features

- Single-row type with horizontal connection direction



### Key Commercial Data

|                                      |   |
|--------------------------------------|---|
| Packing unit                         | 1 pc  |
| GTIN                                 | <br>4 017918 025533 |
| Weight per Piece (excluding packing) | 3.83 g  |
| Custom tariff number                 | 85369010  |
| Country of origin                    | Germany   |

### Technical data

#### Dimensions

|                          |              |
|--------------------------|--------------|
| Length                   | 7.3 mm       |
| Pitch                    | 3.81 mm      |
| Dimension a              | 22.86 mm     |
| Width                    | 26.66 mm     |
| Constructional height    | 8.5 mm       |
| Height                   | 12 mm        |
| Length of the solder pin | 3.5 mm       |
| Pin dimensions           | 0,5 x 0,9 mm |

# PCB terminal block - MKDS 1/ 7-3,81 - 1727065

## Technical data

### Dimensions

|               |        |
|---------------|--------|
| Hole diameter | 1.1 mm |
|---------------|--------|

### General

|  |                     |
|--|---------------------|
| Range of articles                      | MKDS 1              |
| Insulating material group              | I                   |
| Rated surge voltage (III/3)            | 2.5 kV              |
| Rated surge voltage (III/2)            | 2.5 kV              |
| Rated surge voltage (II/2)             | 2.5 kV              |
| Rated voltage (III/3)                  | 160 V               |
| Rated voltage (III/2)                  | 200 V               |
| Rated voltage (II/2)                   | 400 V               |
| Connection in acc. with standard       | EN-VDE              |
| Nominal current $I_N$                  | 13.5 A              |
| Nominal cross section                  | 1.5 mm <sup>2</sup> |
| Insulating material                    | PA                  |
| Solder pin surface                     | Sn                  |
| Flammability rating according to UL 94 | V0                  |
| Stripping length                       | 5 mm                |
| Number of positions                    | 7                   |
| Screw thread                           | M2                  |
| Tightening torque, min                 | 0.22 Nm             |
| Tightening torque max                  | 0.25 Nm             |

### Connection data

|  |                      |
|--|----------------------|
| Conductor cross section solid min.   | 0.14 mm <sup>2</sup> |
| Conductor cross section solid max.   | 1.5 mm <sup>2</sup>  |
| Conductor cross section flexible min.                                      | 0.14 mm <sup>2</sup> |
| Conductor cross section flexible max.                                      | 1.5 mm <sup>2</sup>  |
| Conductor cross section flexible, with ferrule without plastic sleeve min. | 0.25 mm <sup>2</sup> |
| Conductor cross section flexible, with ferrule without plastic sleeve max. | 0.5 mm <sup>2</sup>  |
| Conductor cross section flexible, with ferrule with plastic sleeve min.    | 0.25 mm <sup>2</sup> |
| Conductor cross section flexible, with ferrule with plastic sleeve max.    | 0.5 mm <sup>2</sup>  |
| Conductor cross section AWG min.   | 26                   |
| Conductor cross section AWG max.   | 16                   |
| 2 conductors with same cross section, solid min.                           | 0.14 mm <sup>2</sup> |
| 2 conductors with same cross section, solid max.                           | 0.5 mm <sup>2</sup>  |
| 2 conductors with same cross section, stranded min.                        | 0.14 mm <sup>2</sup> |
| 2 conductors with same cross section, stranded max.                        | 0.34 mm <sup>2</sup> |

# PCB terminal block - MKDS 1/ 7-3,81 - 1727065

## Technical data

### Standards and Regulations

|  |        |
|--|--------|
| Connection in acc. with standard       | EN-VDE |
|  | CSA    |
| Flammability rating according to UL 94 | V0     |

## Classifications

### eCl@ss

|            |          |
|------------|----------|
| eCl@ss 4.0 | 27141109 |
| eCl@ss 4.1 | 27141109 |
| eCl@ss 5.0 | 27141190 |
| eCl@ss 5.1 | 27141190 |
| eCl@ss 6.0 | 27261101 |
| eCl@ss 7.0 | 27440401 |
| eCl@ss 8.0 | 27440401 |
| eCl@ss 9.0 | 27440401 |

### ETIM

|          |          |
|----------|----------|
| ETIM 3.0 | EC001121 |
| ETIM 4.0 | EC002643 |
| ETIM 5.0 | EC002643 |

### UNSPSC

|               |          |
|---------------|----------|
| UNSPSC 6.01   | 30211801 |
| UNSPSC 7.0901 | 39121432 |
| UNSPSC 11     | 39121432 |
| UNSPSC 12.01  | 39121432 |
| UNSPSC 13.2   | 39121432 |

## Approvals

### Approvals

---

#### Approvals

CSA / SEV / CCA / IECCEB Scheme / EAC / EAC / cULus Recognized / cULus Recognized

---

#### Ex Approvals

---

# PCB terminal block - MKDS 1/ 7-3,81 - 1727065

## Approvals

Approvals submitted

### Approval details

|   |       |       |
|---|-------|-------|
| CSA  |       |       |
|   | B     | D     |
| mm <sup>2</sup> /AWG/kcmil  | 28-16 | 28-16 |
| Nominal current I <sub>N</sub>  | 10 A  | 10 A  |
| Nominal voltage U <sub>N</sub>  | 150 V | 300 V |

|                                |       |
|--------------------------------|-------|
| SEV                            |       |
|                                |       |
| mm <sup>2</sup> /AWG/kcmil     | 1.5   |
| Nominal current I <sub>N</sub> | 12 A  |
| Nominal voltage U <sub>N</sub> | 125 V |

|     |
|-----|
| CCA |
|-----|

|   |
|---|
| IECEE CB Scheme  |
|---|

|     |
|-----|
| EAC |
|-----|

|     |
|-----|
| EAC |
|-----|

|                                |       |       |
|--------------------------------|-------|-------|
| cULus Recognized               |       |       |
|                                | B     | D     |
| mm <sup>2</sup> /AWG/kcmil     | 30-16 | 30-16 |
| Nominal current I <sub>N</sub> | 10 A  | 10 A  |
| Nominal voltage U <sub>N</sub> | 300 V | 300 V |

|  |
|--|
| cULus Recognized  |
|--|

# PCB terminal block - MKDS 1/ 7-3,81 - 1727065

## Accessories

### Accessories

#### Labeled terminal marker

Marker card - SK 3,81/2,8:FORTL.ZAHLEN - 0804109



Marker card, Card, white, labeled, Horizontal: Consecutive numbers 1 - 10, 11 - 20, etc. up to 91 - (99)100, Mounting type: Adhesive, for terminal block width: 3.81 mm, Lettering field: 3.81 x 2.8 mm

#### Marker pen

Marker pen - B-STIFT - 1051993



Marker pen, for manual labeling of unprinted Zack strips, smear-proof and waterproof, line thickness 0.5 mm

#### Screwdriver tools

Screwdriver - SZS 0,4X2,5 VDE - 1205037



Screwdriver, slot-headed, VDE insulated, size: 0.4 x 2.5 x 80 mm, 2-component grip, with non-slip grip

## Drawings

Drilling diagram

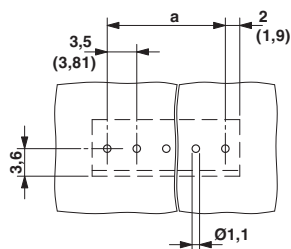

Dimensional drawing

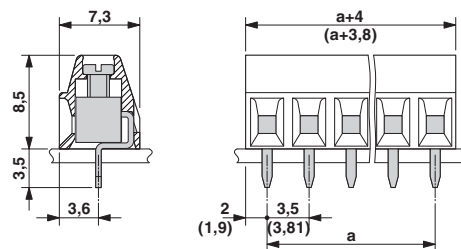



# Mouser Electronics

Authorized Distributor

Click to View Pricing, Inventory, Delivery & Lifecycle Information:

[Phoenix Contact:](#)

[1727065](#)