

Alle Rechte vorbehalten/ All rights reserved

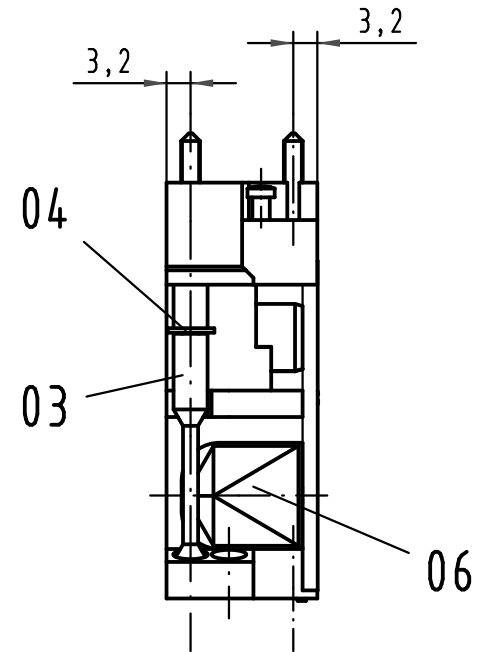

| Pos. pos. | Anzahl number | Benennung description |
|-----------|---------------|-----------------------------------------------|
| 01 | 1 | Grundschaale shell |
| 02 | 1 | Deckel cover |
| 03 | 2 | Verriegelungsschraube M2,5 locking screw M2,5 |
| 04 | 2 | Sicherungsscheibe locking washer |
| 05 | 2 | Schelle clamp |
| 06 | 2 | Blindstopfen blind plug |
| 07 | 10 | PT-Schraube PT-screw |

Teile nicht montiert
parts not assembled

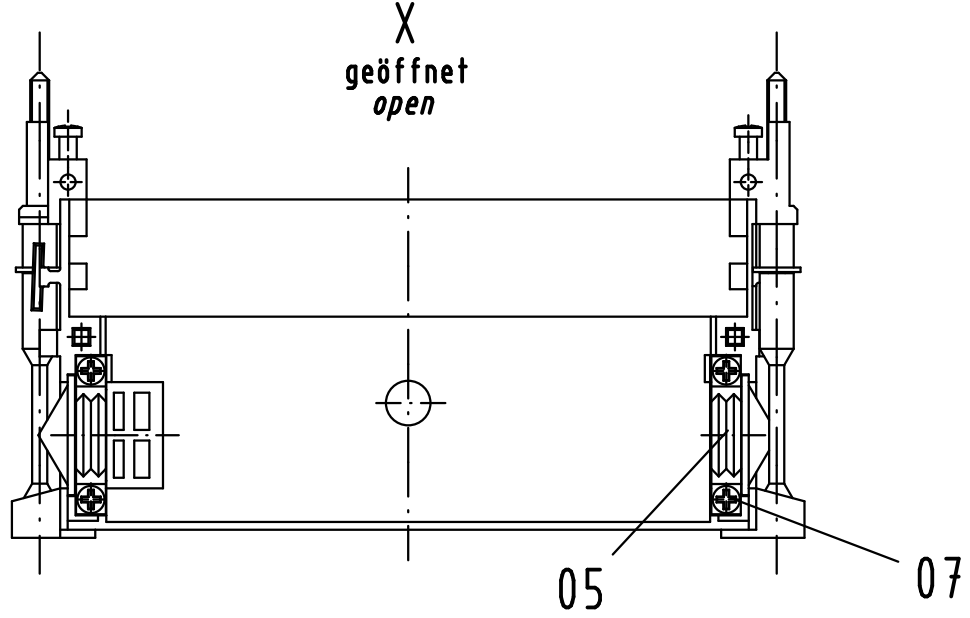
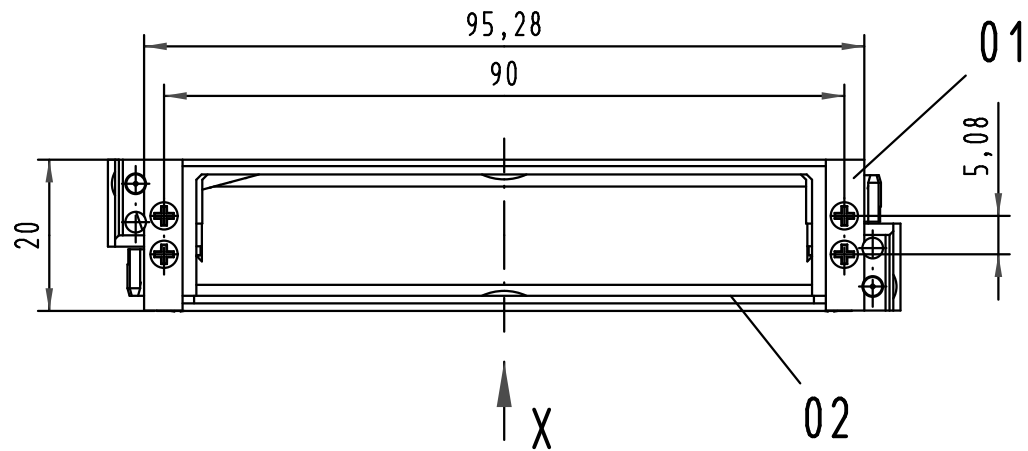
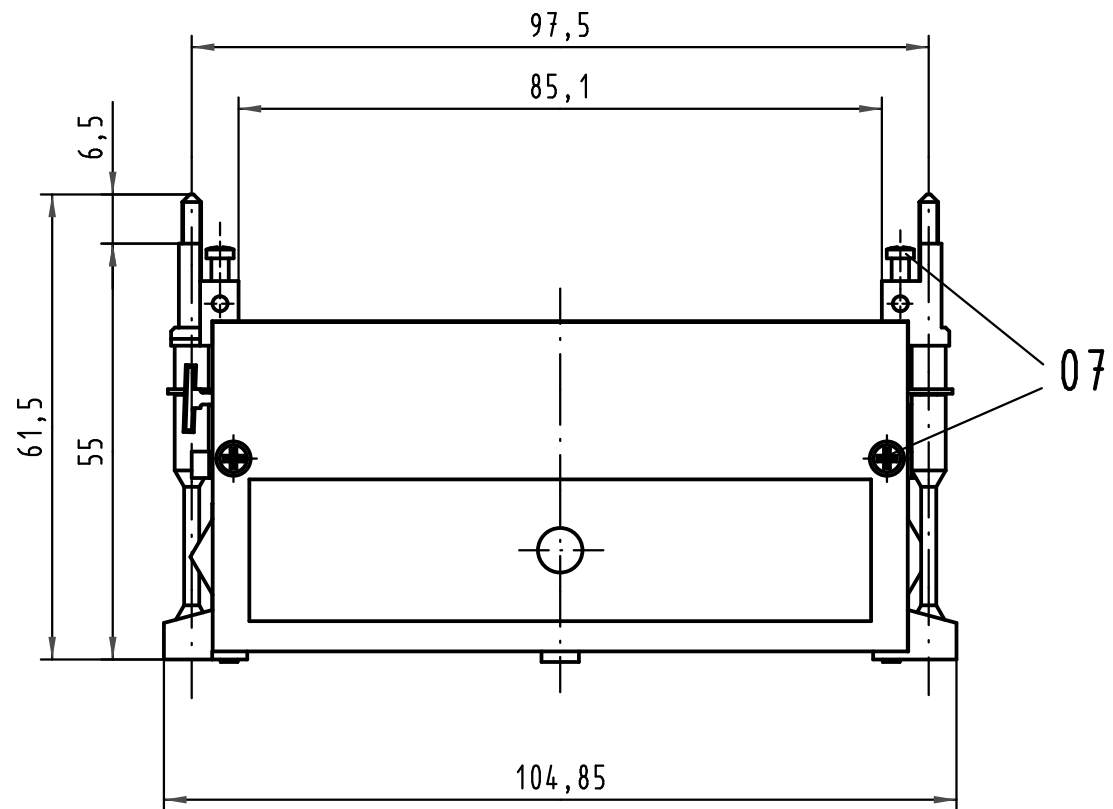
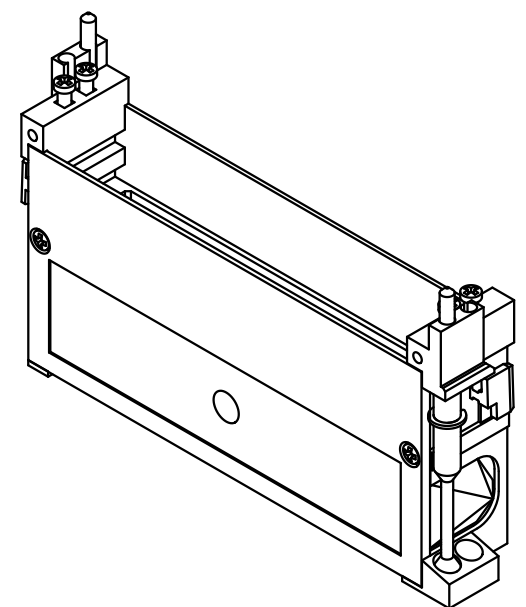

| | | | | | | |
|-----------------------------------------------|----------|-------------------|-----------------------------------|------|-------------------------------------------|-----------------------------------------|
| All Dimensions in mm Original Size DIN A 3 | | Techn. Character. | | | Nicht tolerierte Maß/Free size tolerances | |
| | | | Dat. | Name | Maßstab/Scale 1:1 | Schalengehäuse D20 shell housing D20 |
| | | | Insp. | Sch. | | |
| | | | Stand. | | | |
| 32028 | 23.08.07 | Hage. | HARTING Electronics GmbH & Co. KG | | | TB 09 06 048 0521 |
| 32446 | | | D-32339 ESPELKAMP | | | |
| Mod. | Dat. | Name | | | | Blatt/page |

Mouser Electronics

Authorized Distributor

Click to View Pricing, Inventory, Delivery & Lifecycle Information:

[HARTING:](#)

[09060480521](#)