

| REV.       | DESIGN Ausführung | MATERIAL Werkstoff | SURFACE Oberfläche | WIRE RANGE Drahtgrößenbereich (mm <sup>2</sup> ) | INSULATION Isolations Ø (mm) | STRIP FORM WIRE CRIMP Drahtcrimp Bandware | INSUL.-CRIMP Iso-Crimp Bandware             | A                             | B   | C   | D   | E    |     |
|------------|-------------------|--------------------|--------------------|--|------------------------------|---|---|-------------------------------|-----|-----|-----|------|-----|
| 965901-1   | A                 | 1                  | CuSn4              | PRET INNED vorverzinkt min. 0.8 µm               | 0.5-1.0 FLR                  | 1.4-2.3                                   | E = 2.6<br>G = 2.8<br>D <sub>Dr</sub> = 1.1 | H = 3.6<br>K = 3.9<br>D = 1.8 | 3   | 4   | 5.5 | 18.8 | 0.4 |
| 965899-1   | A                 | 1                  | CuSn4              | PRET INNED vorverzinkt min. 0.8 µm               | >1.0-2.5 FLR                 | 2.1-3.1                                   | E = 3.6<br>G = 3.8<br>D <sub>Dr</sub> = 1.8 | H = 4.7<br>K = 4.9<br>D = 2.6 | 3.3 | 4.3 | 5.8 | 18.8 | 0.4 |
| 928876-1   | A                 | 1                  | CuSn4              | PLAIN BLANK                                      | 0.5-1.0 FLK                  | 2.0-2.7                                   | E = 2.6<br>G = 2.8<br>D <sub>Dr</sub> = 1.1 | H = 3.9<br>K = 4.1<br>D = 2.4 | 3   | 4   | 5.5 | 18.8 | 0.4 |
| 927775-7   | M                 |                    | CuNi12ZN24         | PRET INNED vorverzinkt min. 0.8 µm               |                              |   |   |                               |     |     |     |      |     |
| 927775-6   | M                 |                    | CuSn4              |  |                              |   |   |                               |     |     |     |      |     |
| 927775-3   | M                 | 1                  | CuSn4              | PRET INNED vorverzinkt min. 0.8 µm               | 0.5-1.0 FLK                  | 2.0-2.7                                   | E = 2.6<br>G = 2.8<br>D <sub>Dr</sub> = 1.1 | H = 3.9<br>K = 4.1<br>D = 2.4 | 3   | 4   | 5.5 | 18.8 | 0.4 |
| 927775-1   | M                 |                    | CuFe2              | PRET INNED vorverzinkt min. 0.8 µm               |                              |   |   |                               |     |     |     |      |     |
| 928810-1   | A                 | 1                  | CuFe2              | PRET INNED vorverzinkt min. 1 µm                 | 0.5-1.0 FLR                  | 1.4-2.3                                   | E = 2.6<br>G = 2.8<br>D <sub>Dr</sub> = 1.1 | H = 3.6<br>K = 3.9<br>D = 1.8 | 3.0 | 4.0 | 5.5 | 18.8 | 0.4 |
| 963884-1   | A                 | 1                  | CuSn4              | PRET INNED vorverzinkt min. 1 µm                 | >1.0-2.5 FLR                 | 2.1-3.1                                   | E = 3.6<br>G = 3.8<br>D <sub>Dr</sub> = 1.8 | H = 4.7<br>K = 4.9<br>D = 2.6 | 3.3 | 4.3 | 5.8 | 18.8 | 0.4 |
| 927773-3   | N                 | 1                  | CuSn4              | PRET INNED vorverzinkt min. 1 µm                 | >1.0-2.5 FLK                 | 2.7-4.1                                   | E = 3.6<br>G = 3.8<br>D <sub>Dr</sub> = 1.8 | H = 5.5<br>K = 5.8<br>D = 3.6 | 3.3 | 4.3 | 5.8 | 18.8 | 0.4 |
| 927773-1   | N                 |                    | CuFe2              |  |                              |   |   |                               |     |     |     |      |     |
| 2-927768-1 | R                 |                    | CuSn4              |  |                              |   |   |                               |     |     |     |      |     |
| 1-927768-1 | R                 |                    | CuFe2              |  |                              |   |   |                               |     |     |     |      |     |
| 927768-9   | P                 |                    |                    |  |                              |   |   |                               |     |     |     |      |     |
| 927768-6   | P                 | 1                  | CuSn4              |  | >1.0-2.5 FLR                 | 2.1-3.1                                   | E = 3.6<br>G = 3.8<br>D <sub>Dr</sub> = 1.8 | H = 4.7<br>K = 4.9<br>D = 2.6 | 3.3 | 4.3 | 5.8 | 18.8 | 0.4 |
| 927768-3   | P                 |                    |                    |  |                              |   |   |                               |     |     |     |      |     |
| 927768-1   | P                 |                    | CuFe2              | PRET INNED vorverzinkt min. 1 µm                 |                              |   |   |                               |     |     |     |      |     |
| 1719810-1  | A                 | 1                  |                    |  |                              |   |   |                               |     |     |     |      |     |
| 2-927771-2 | N                 |                    | CuSn4              |  |                              |   |   |                               |     |     |     |      |     |
| 2-927771-1 | N                 |                    | CuFe2              |  |                              |   |   |                               |     |     |     |      |     |
| 1-927771-1 | N                 |                    |                    |  |                              |   |   |                               |     |     |     |      |     |
| 927771-9   | M                 | 1                  | CuSn4              |  | 0.5-1.0 FLR                  | 1.4-2.3                                   | E = 2.6<br>G = 2.8<br>D <sub>Dr</sub> = 1.1 | H = 3.6<br>K = 3.9<br>D = 1.8 | 3   | 4   | 5.5 | 18.8 | 0.4 |
| 927771-8   | N                 |                    |                    |  |                              |   |   |                               |     |     |     |      |     |
| 927771-6   | M                 |                    |                    |  |                              |   |   |                               |     |     |     |      |     |
| 927771-3   | M                 |                    | CuFe2              | PRET INNED vorverzinkt min. 1 µm                 |                              |   |   |                               |     |     |     |      |     |
| 927771-1   | M                 |                    |                    |  |                              |   |   |                               |     |     |     |      |     |
| 2-927774-1 | C                 |                    | CuSn4              |  |                              |   |   |                               |     |     |     |      |     |
| 1-927774-1 | C                 |                    | CuFe2              |  |                              |   |   |                               |     |     |     |      |     |
| 927774-6   | B                 | 2                  | CuSn4              |  | 0.2-0.5 FLR                  | 1.0-1.6                                   | E = 2.1<br>G = 2.1<br>D <sub>Dr</sub> = 0.8 | H = 2.7<br>K = 2.8<br>D = 1.4 | 2.5 | 3.5 | 5.6 | 18.8 | 0.4 |
| 927774-3   | B                 |                    |                    |  |                              |   |   |                               |     |     |     |      |     |
| 927774-1   | B                 |                    | CuFe2              | PRET INNED vorverzinkt min. 1 µm                 |                              |   |   |                               |     |     |     |      |     |
| 963708-1   | B                 | 2                  | CuFe2              | PRET INNED vorverzinkt min. 1 µm                 | 0.08-0.2 Sonderleitung       | 1.5-1.8                                   | E = 1.7<br>G = 1.7<br>D <sub>Dr</sub> = 0.6 | H = 3.1<br>K = 3.2<br>D = 1.6 | 2.5 | 3.7 | 5.9 | 18.8 | 0.4 |
| 969137-1   | A                 | 3                  | CuSn4              | PRET INNED vorverzinkt min. 0.8 µm               | 0.2-0.5 FLR                  | 1.2-2.3                                   | E = 2.1<br>G = 2.1<br>D <sub>Dr</sub> = 0.8 | H = 3.5<br>K = 3.6<br>D = 2.0 | 2.5 | 3.5 | 5   | 18.8 | 0.4 |
| 1-927778-1 | D                 |                    | CuFe2              |  |                              |   |   |                               |     |     |     |      |     |
| 927778-3   | C                 | 3                  | CuSn4              | PRET INNED vorverzinkt min. 0.8 µm               | 0.2-0.5 FLK                  | 1.2-2.3                                   | E = 2.1<br>G = 2.1<br>D <sub>Dr</sub> = 0.8 | H = 3.5<br>K = 3.6<br>D = 2.0 | 2.5 | 3.5 | 5   | 18.8 | 0.4 |
| 927778-1   | C                 |                    | CuFe2              |  |                              |   |   |                               |     |     |     |      |     |
| 2112132-1  | A                 | 4                  | CuSn4              | PLAIN BLANK                                      | 0.2-0.5 FLR                  | 1.15-1.6                                  | E = 2.4<br>G = 2.3<br>D <sub>Dr</sub> = 1   | H = 2.9<br>K = 2.9<br>D = 1.4 | 2.5 | 3.5 | 5.6 | 18.8 | 0.2 |
| 2-927766-1 | E                 |                    | CuSn4              |  |                              |   |   |                               |     |     |     |      |     |
| 1-927766-1 | E                 | 5                  | CuFe2              |  | >1.0-2.5 FLK                 | 2.7-3.0                                   | E = 3.6<br>G = 3.8<br>D <sub>Dr</sub> = 1.8 | H = 5.4<br>K = 4.6<br>D = 3.2 | 3.5 | 5.9 | 7.5 | 18.8 | 0.4 |
| 927766-3   | D                 |                    | CuSn4              | PRET INNED vorverzinkt min. 1 µm                 |                              |   |   |                               |     |     |     |      |     |
| 927766-1   | D                 |                    | CuFe2              |  |                              |   |   |                               |     |     |     |      |     |
| 2-929937-1 | E                 |                    | CuSn4              |  |                              |   |   |                               |     |     |     |      |     |
| 1-929937-1 | E                 |                    | CuFe2              |  |                              |   |   |                               |     |     |     |      |     |
| 929937-6   | E                 | 5                  | CuSn4              |  | >1.0-2.5 FLR                 | 2.7-3.0                                   | E = 3.6<br>G = 3.8<br>D <sub>Dr</sub> = 1.8 | H = 5.4<br>K = 4.6<br>D = 3.2 | 3.5 | 5.9 | 7.5 | 21   | 0.4 |
| 929937-3   | E                 |                    |                    |  |                              |   |   |                               |     |     |     |      |     |
| 929937-1   | E                 |                    | CuFe2              | PRET INNED vorverzinkt min. 1 µm                 |                              |   |   |                               |     |     |     |      |     |
| 2-929939-1 | E                 |                    | CuSn4              |  |                              |   |   |                               |     |     |     |      |     |
| 1-929939-1 | E                 |                    | CuFe2              |  |                              |   |   |                               |     |     |     |      |     |
| 929939-6   | E                 | 5                  | CuSn4              |  | 0.5-1.0 FLR                  | 1.4-2.1                                   | E = 2.6<br>G = 2.8<br>D <sub>Dr</sub> = 1.1 | H = 5.4<br>K = 4.6<br>D = 3.2 | 3   | 5.4 | 7   | 21   | 0.6 |
| 929939-3   | E                 |                    |                    |  |                              |   |   |                               |     |     |     |      |     |
| 929939-1   | E                 |                    | CuFe2              | PRET INNED vorverzinkt min. 1 µm                 |                              |   |   |                               |     |     |     |      |     |
| 2-927770-1 | G                 |                    | CuSn4              |  |                              |   |   |                               |     |     |     |      |     |
| 1-927770-1 | G                 |                    | CuFe2              |  |                              |   |   |                               |     |     |     |      |     |
| 927770-6   | F                 | 5                  | CuSn4              |  | 0.5-1.0 FLR                  | 1.4-2.1                                   | E = 2.6<br>G = 2.8<br>D <sub>Dr</sub> = 1.1 | H = 5.4<br>K = 4.6<br>D = 3.2 | 3   | 5.4 | 7   | 18.8 | 0.6 |
| 927770-3   | F                 |                    |                    |  |                              |   |   |                               |     |     |     |      |     |
| 927770-1   | F                 |                    | CuFe2              | PRET INNED vorverzinkt min. 1 µm                 |                              |   |   |                               |     |     |     |      |     |
| 2-929941-1 | E                 |                    | CuSn4              |  |                              |   |   |                               |     |     |     |      |     |
| 1-929941-1 | E                 |                    | CuFe2              |  |                              |   |   |                               |     |     |     |      |     |
| 929941-6   | D                 | 6                  | CuSn4              |  | 0.2-0.5 FLR                  | 1.15-1.6                                  | E = 2.1<br>G = 2.1<br>D <sub>Dr</sub> = 0.8 | H = 5.4<br>K = 4.6<br>D = 3.2 | 2.5 | 4.9 | 6.5 | 21   | 0.9 |
| 929941-3   | D                 |                    |                    |  |                              |   |   |                               |     |     |     |      |     |
| 929941-1   | D                 |                    | CuFe2              | PRET INNED vorverzinkt min. 1 µm                 |                              |   |   |                               |     |     |     |      |     |
| 1-927772-1 | D                 |                    | CuFe2              |  |                              |   |   |                               |     |     |     |      |     |
| 927772-3   | C                 | 6                  | CuSn4              | PRET INNED vorverzinkt min. 1 µm                 | 0.2-0.5 FLR                  | 1.15-1.6                                  | E = 2.1<br>G = 2.1<br>D <sub>Dr</sub> = 0.8 | H = 5.4<br>K = 4.6<br>D = 3.2 | 2.5 | 4.9 | 6.5 | 18.8 | 0.9 |
| 927772-1   | C                 |                    | CuFe2              |  |                              |   |   |                               |     |     |     |      |     |

SEE APPLICATION - SPECIFICATION  
 siehe Verarbeitungspezifikation  
 114-18050

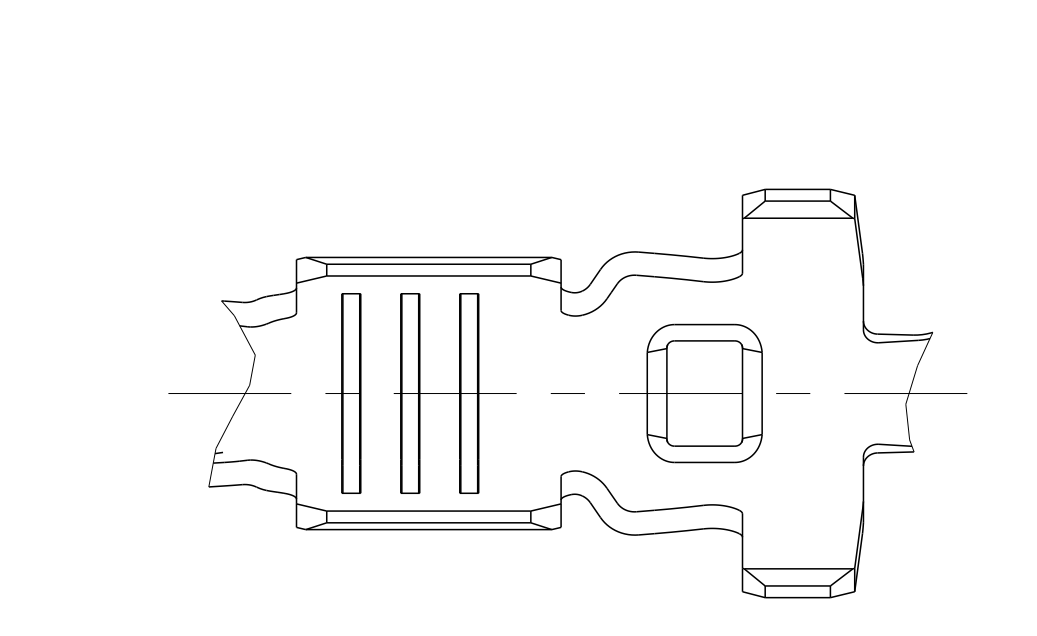
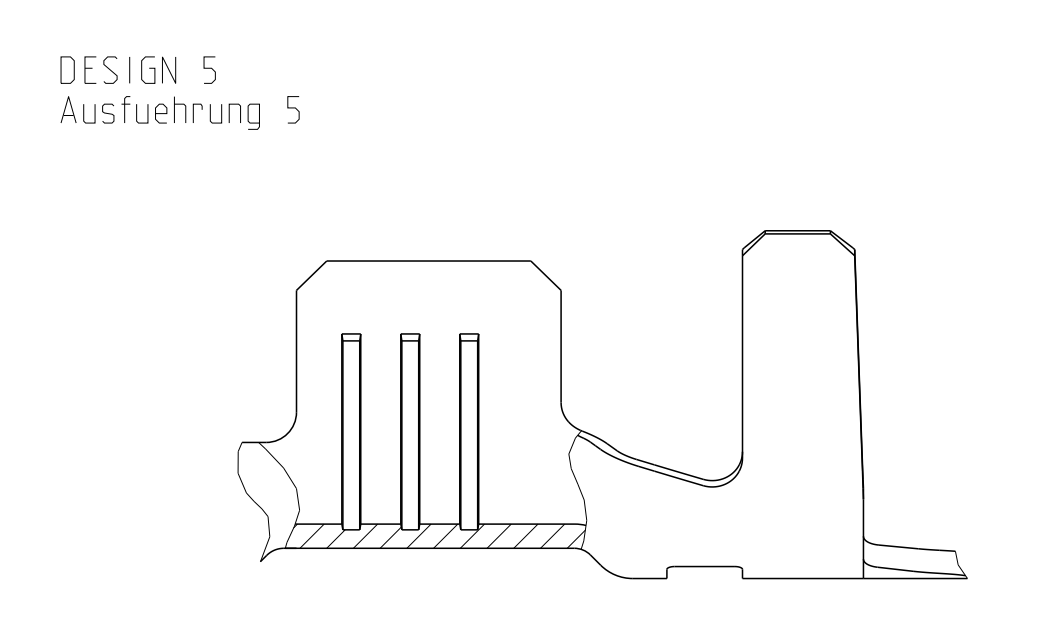
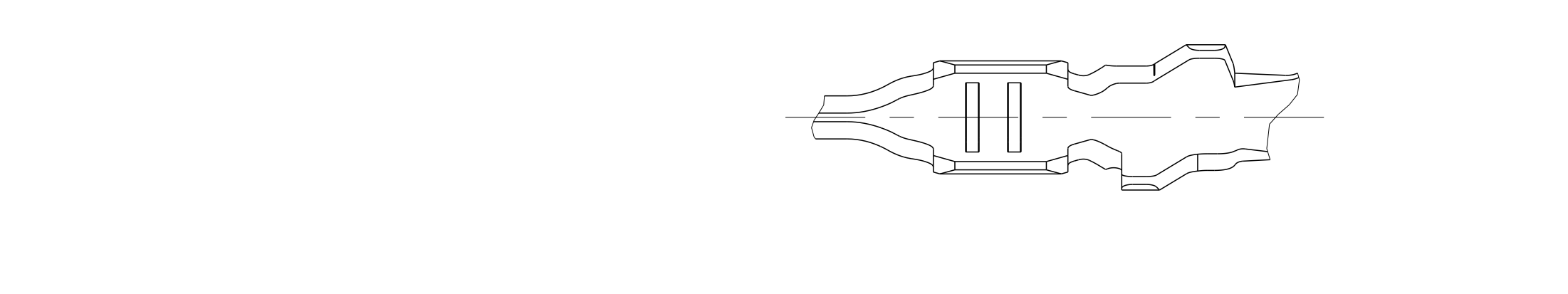
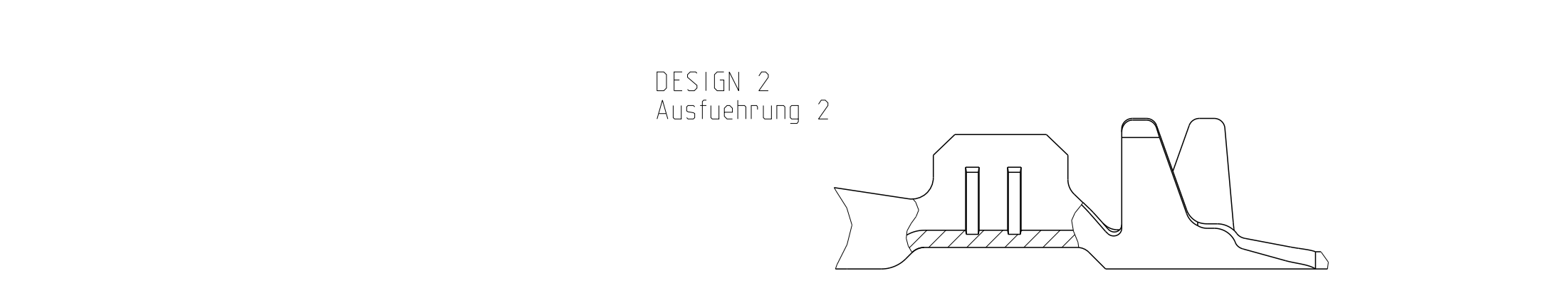
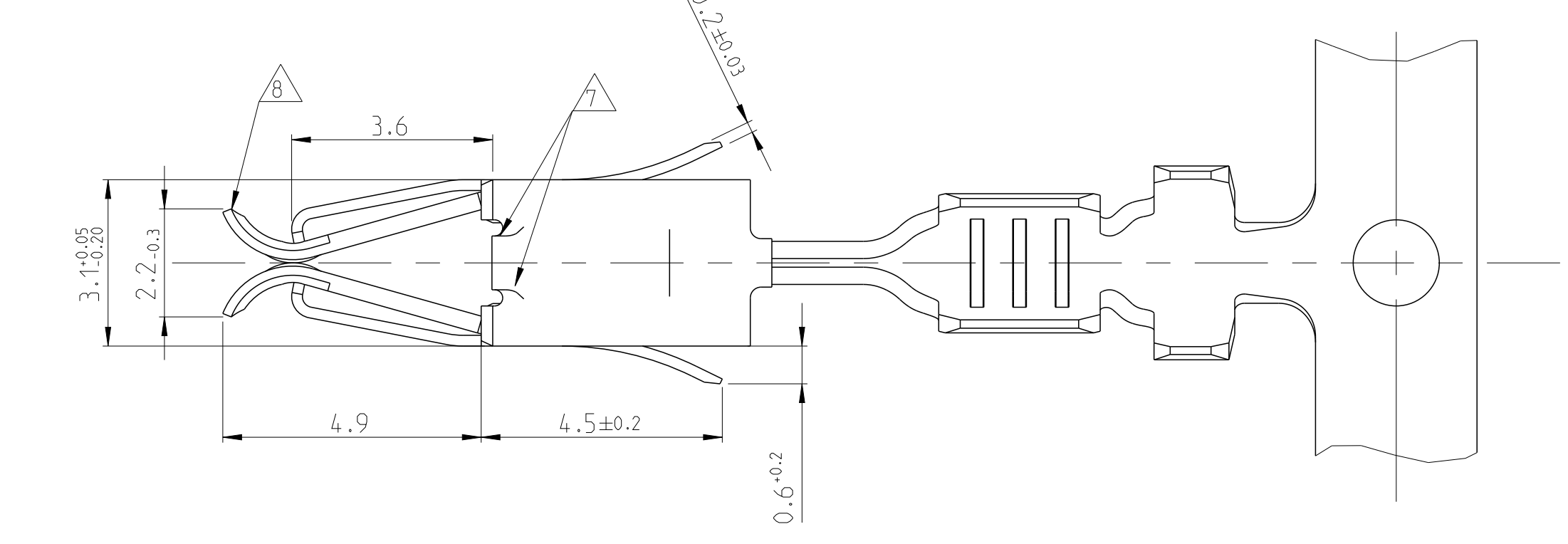
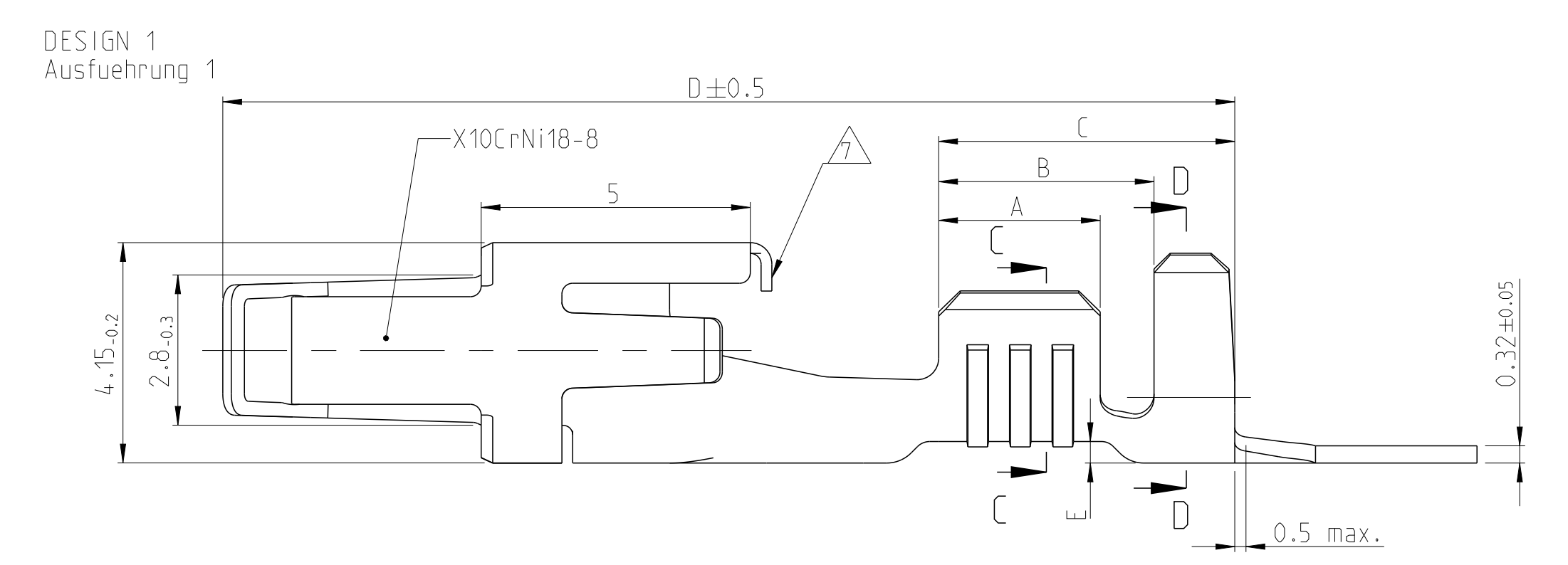

NOTES

- Bemerkungen
- 1 CONTACT BODY PRE-SILVER PLATED MIN. 0.8 µm  
 Kontaktkoerper vorversilbert min. 0.8 µm  
 CONTACT ZONE SELECTIVE PRE-SILVER PLATED MIN. 3 µm  
 Kontaktzone selektiv vorversilbert min. 3 µm
  - 2 CONTACT ZONE GOLD PLATED MIN. 0.8 µm OVER MIN. 1.3 µm NICKEL-LAYER  
 Kontaktzone vergoldet min. 0.8 µm ueber min. 1.3 µm Nickel-Zwischenschicht  
 CRIMP AREA MIN. 1 µm TIN PLATED OVER NICKEL-LAYER  
 Crimpbereich min. 1 µm verzinkt ueber Nickel-Zwischenschicht
  - 3 CANTILEVER SPRING INSIDE AND OUTSIDE 0.4-1.2 µm GOLD PLATED  
 Ueberfeder innen und aussen 0.4-1.2 µm vergoldet
  - 4 CONTACT BODY, CONTACT SPRING INSIDE AND CRIMP AREA MIN. 1 µm TIN PLATED OVER NICKEL-LAYER.  
 TOUCHING AREA TO CANTILEVER SPRING AND CONTACT SPRING OUTSIDE  
 SELECTIVE 0.8 µm GOLD OVER MIN. 1.3 µm NICKEL-LAYER  
 Kontaktkoerper, Kontaktfeder innen und Crimpbereich min. 1.3 µm verzinkt ueber Nickel-Zwischenschicht, Anlageflaeche zur Ueberfeder und Kontaktfeder aussen selektiv 0.8 µm vergoldet ueber min. 1 µm Nickel-Zwischenschicht
  - 5 CONTACT ZONE AND TOUCHING AREA TO CANTILEVER SPRING MIN. 0.8 µm SELECTIVE GOLD PLATED OVER 1.3 µm NICKEL PLATED. CRIMP AREA MIN. 1 µm TIN PLATED OVER NICKEL-LAYER  
 Kontaktzone und Anlageflaeche zur Ueberfeder min. 0.8 µm vergoldet ueber min. 1.3 µm Nickel-Zwischenschicht Crimpbereich min. 1 µm verzinkt ueber Nickel-Zwischenschicht
  - 6 CONTACT BODY AND CRIMP AREA MIN. 1 µm TIN PLATED OVER NICKEL-LAYER.  
 TOUCHING AREA TO CANTILEVER SPRING SELECTIVE 0.8 µm GOLD OVER MIN. 1.3 µm NICKEL-LAYER  
 Kontaktkoerper und Crimpbereich min. 1 µm verzinkt ueber Nickel-Zwischenschicht, Anlageflaeche zur Ueberfeder selektiv 0.8 µm vergoldet ueber min. 1.3 µm Nickel-Zwischenschicht
  - 7 CONTACT OFF OPTIONAL  
 Abschnitt/Freischchnitt optional
  - 8 SAWAG ONLY FOR PN 929937, 929939, 929941  
 Swage nur fuer PN 929937, 929939, 929941
  - 9 VARIANTS WITH GAP-SIZE 0.3mm (±0.1)  
 Varianten mit Gap-Size 0.3mm (±0.1)
  - 10 CONTACTS DIPPED IN OR SPRAYED WITH LUBRICANT BARRIERTA  
 Kontakte getaucht oder besprueht mit Lubricant Barrierta
  - 11 ACCORDING INSULATION DIA IS TO CHOOSE THE SINGLE WIRE SEAL  
 Entsprechend dem Isolationsdurchmesser ist die Einzel-Dichtung auszuwaehlen
  - 12 VARIANTS WITH GAP-SIZE 0.65mm (±0.1)  
 Varianten mit Gap-Size 0.65mm (±0.1)
  - 13 VARIANTS WITH GAP-SIZE 0.15mm (±0.05)  
 Varianten mit Gap-Size 0.15mm (±0.05)

| ORDER No. Bestell-Nr. | INSULATION Ø Isolations Ø | COLOUR Farbe |
|-----------------------|---------------------------|--------------|
| 828904-1              | 1.2-2.1                   | blue blau    |
| 828905-1              | 2.2-3.0                   | white weiss  |

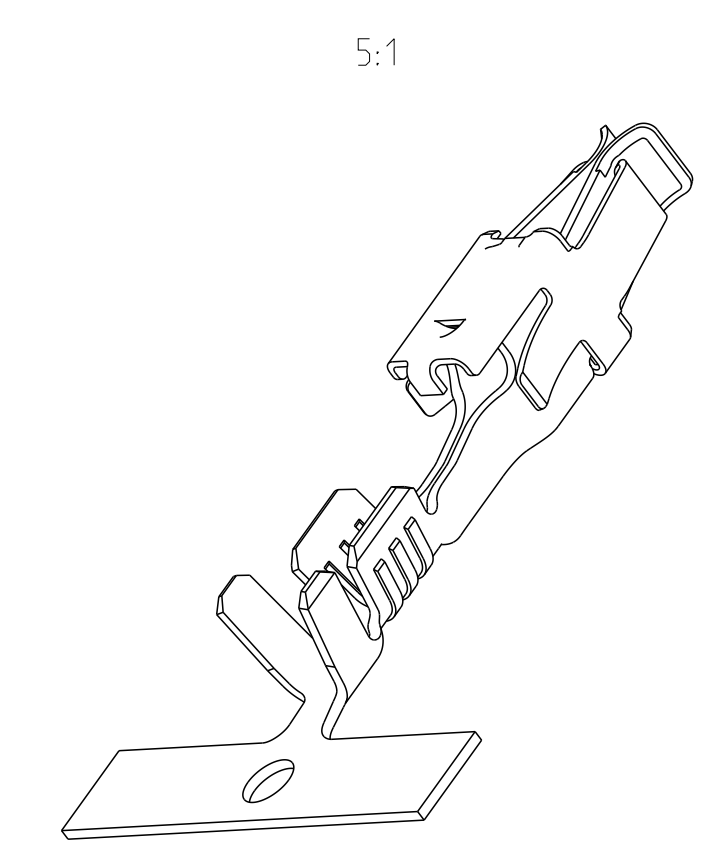
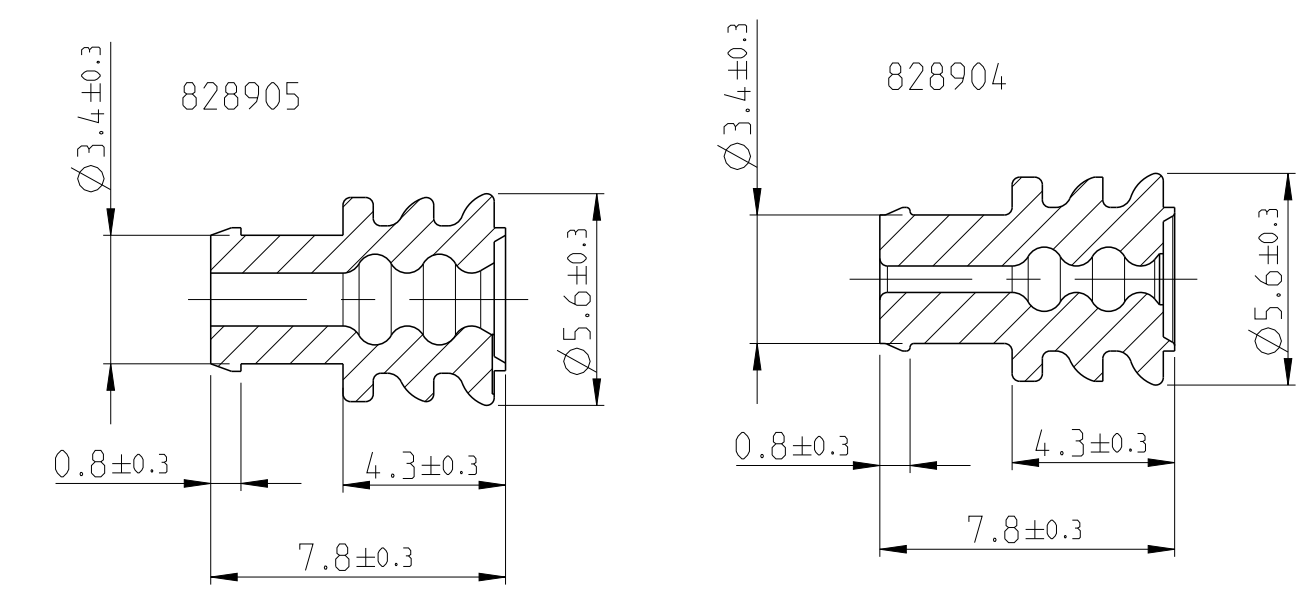

# Mouser Electronics

Authorized Distributor

Click to View Pricing, Inventory, Delivery & Lifecycle Information:

[TE Connectivity:](#)

[1-927774-1](#)