

REVISIONS				
LTR	DESCRIPTION	DATE	DWN	APVD
A1	ECO-09-022178	24SEP09	KK	AEG

NUMBER C-160625

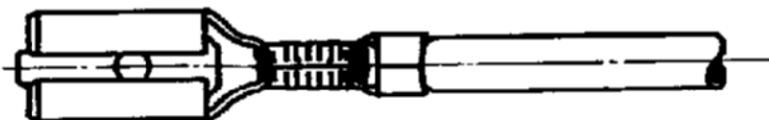

CHAMFER AROUND FRONT OF RECEPTACLE

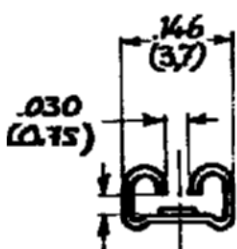
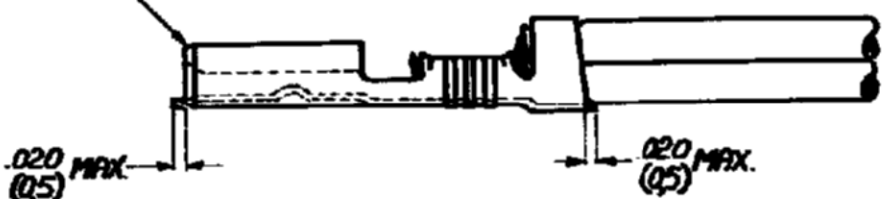

FOR .020 (0.5) TAB-THICKNESS

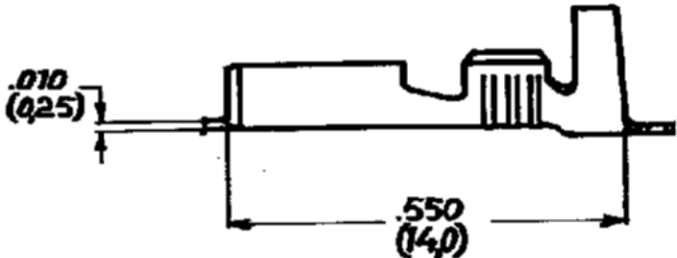
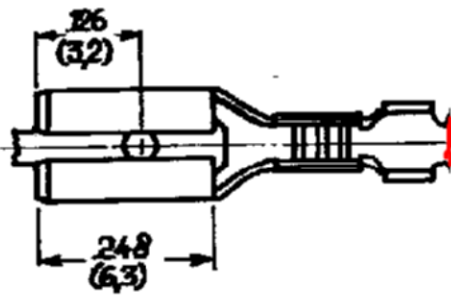

1-160625-0	PHOS. BRONZE	▲
160625-9	PHOSPHOR BRONZE	PRE-TIN
160625-5	PHOS. BRONZE	TIN
160625-4	PHOS. BRONZE	---
160625-3	BRASS	SILVER
160625-2	BRASS	TIN
160625-1/2	BRASS	---

▲ BRIGHT PRE-TIN PLATED

▲ OBSOLETE PARTS: OBSOLETE CIS STREAMLINING PER D.RENAUD/D.SINISI

CUSTOMER COPY FOR REFERENCE ONLY

©1979 BY AMP-HOLLAND N.V. ALL RIGHTS RESERVED A-MP PRODUCTS COVERED BY PATENTS AND/OR PATENTS PENDING.



AMP-HOLLAND N.V.
's-HERTOGENBOSCH
HOLLAND

WIRE RANGE 05-10 MAX	INSUL. RANGE 080-120 DIA R.B.-4.0	FIRST USED
----------------------------	-----------------------------------------	------------

ORDER NO.	MATERIAL	PLATING

SCALE 4 ≈ 1	LOC H	SIZE A	NO C-160625	REV A1
----------------	----------	-----------	----------------	-----------

DR S	DATE 7-79	DATE
CHK S	DATE 20/1/89	DATE 2-2-84

NAME 110 Ser. FASTON RECEPTACLE 1.P.

DIMENSIONS IN (M.M.) DO NOT SCALE PRINT

Mouser Electronics

Authorized Distributor

Click to View Pricing, Inventory, Delivery & Lifecycle Information:

[TE Connectivity:](#)

[160625-2](#)