

COUNT	DESCRIPTION OF REVISIONS	BY	CHKD	DATE	COUNT	DESCRIPTION OF REVISIONS	BY	CHKD	DATE
△					△				
△					△				
△					△				

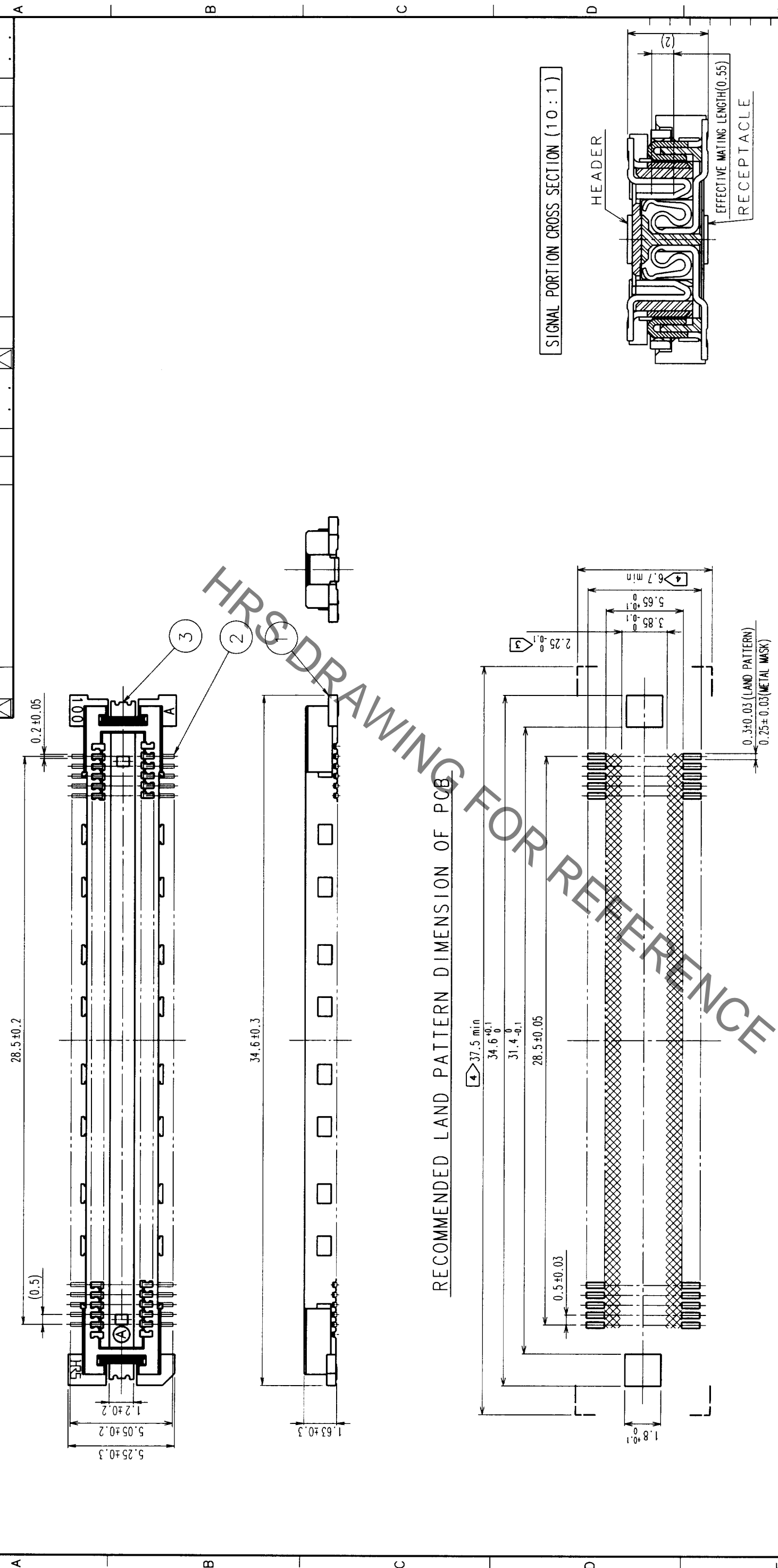

RECOMMENDED LAND PATTERN DIMENSION OF PCB

NO.	MATERIAL	FINISH, REMARKS	DRAWN	DESIGNED	CHECKED	APPROVED	RELEASED
2	COPPER ALLOY	CONTACT AREA: GOLD (0.1µm) OVER NICKEL					
1	LCP	LEAD: GOLD FLASH OVER NICKEL					
3	PHOSPHOR BRONZE	TIN PLATED					

NO.	MATERIAL	FINISH, REMARKS	DRAWN	DESIGNED	CHECKED	APPROVED	RELEASED
1	UL 94V-0						

CODE NO. (OLD): CL  
 DRAWING NO.: EDC3-152106-01  
 SCALE: 5:1  
 UNITS: mm

PART NO.: FX11LB-116P-SV (21)  
 CODE NO.: CL573-0054-0-21

- NOTES
- SMT LEAD-COPLANARITY: 0.1 MAX.
  - THIS PRODUCT HAS NO POLARITY TO PATTERN FOR MOUNTING.
  - MAKE SURE WIDTH OF PATTERN IS WITHIN THAT OF LAND, OR LEAD MAY TOUCH PATTERN. (THIS APPLIES TO HATCHED AREA.)
  - DO NOT MOUNT OTHER DEVICES ONTO [ ] AREA, OR MATING PAIR CANNOT BE MATED.
  - TO BE EMBOSSED CARRIER TAPED AS SPECIFIED IN SHEET 2.

TO	
PCK	

COUNT	DESCRIPTION OF REVISIONS	BY	CHKD	DATE	COUNT	DESCRIPTION OF REVISIONS	BY	CHKD	DATE
△					△				
△					△				
△					△				

REELED DIMENSION (Free)

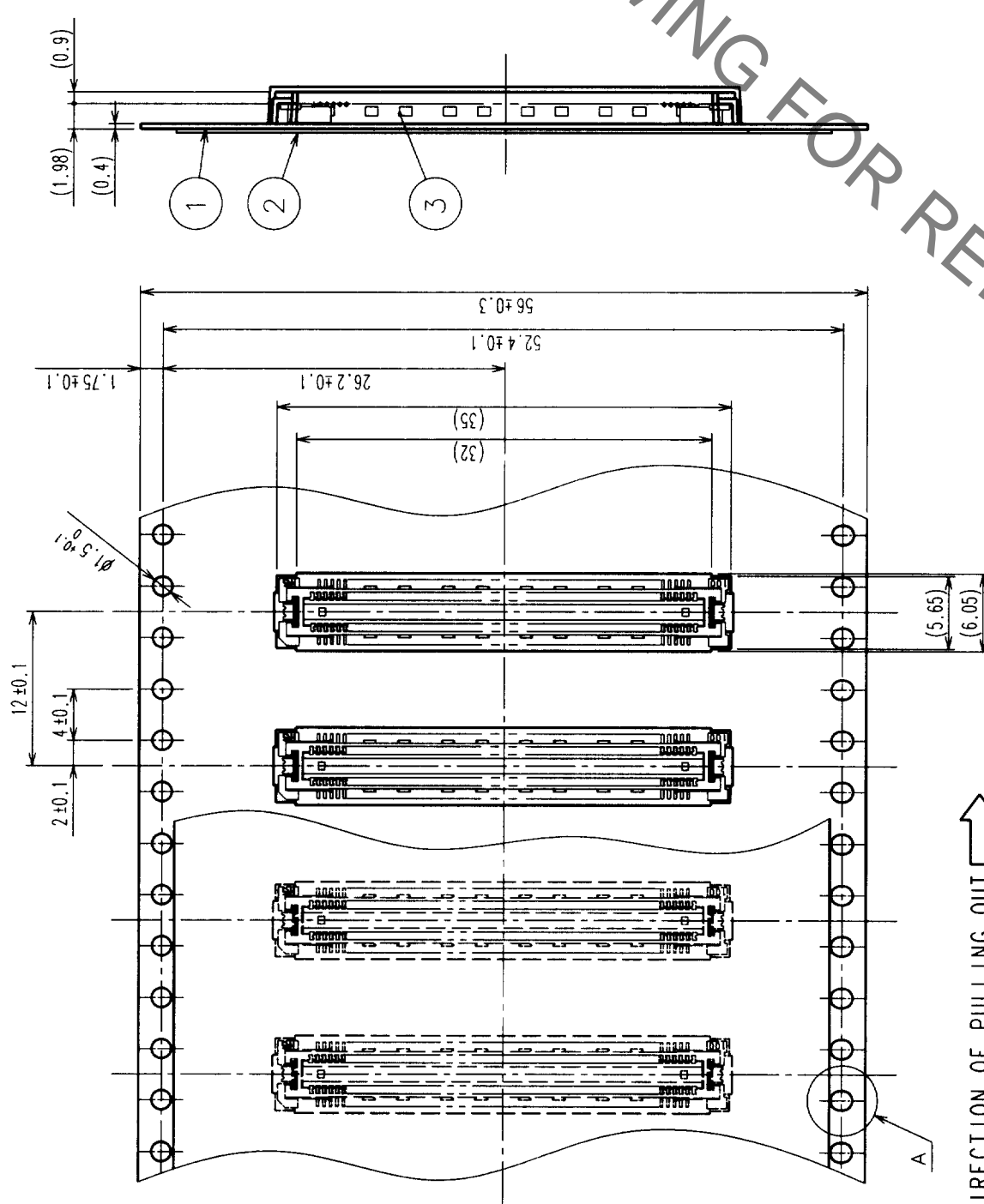
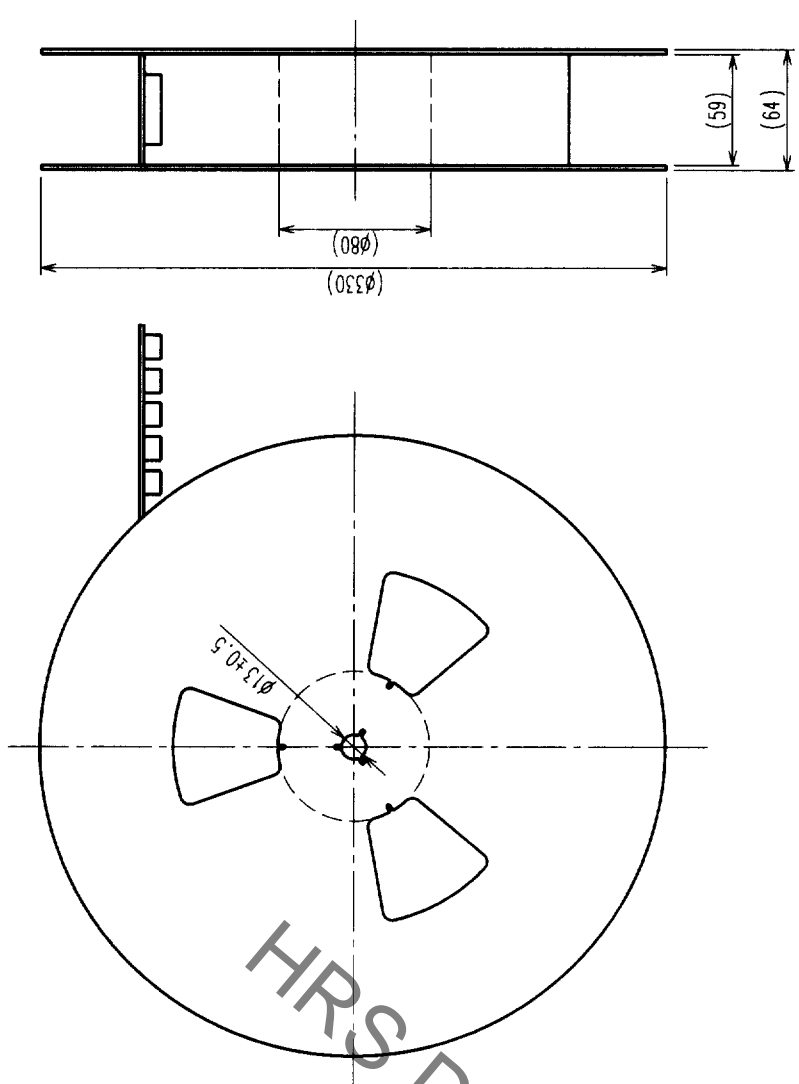

A (5:1)

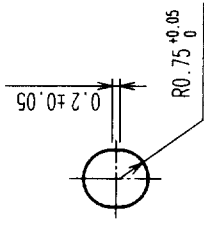

- NOTES
- 1 REEL: 1000 CONNECTORS.
  - 2 MINIMUM 10 COMPARTMENTS FROM BOTH REEL ENDS REMAIN EMPTY.
  - 3 THIS PRODUCT HAS NO POLARITY TO TAPE AND REEL PACKAGING.

2	PET	TOP COVER TAPE	3	(CONNECTOR)	FINISH, REMARKS	FINISH, REMARKS	APPROVED	RELEASED
1	PS	EMBOSSED CARRIER TAPE	3				<i>J. J. J.</i>	
NO.	MATERIAL	FINISH, REMARKS	NO.	MATERIAL	FINISH, REMARKS	DESIGNED	CHECKED	APPROVED
CODE NO. (OLD)	CL					DRAWN		
DRAWING FOR PACKING		DRAWING NO. EDC3-152106-01		PART NO. FX11LB-116P-SV(21)		DESIGNED <i>M. Sakai</i>		APPROVED <i>J. J. J.</i>
SCALE 2 : 1		UNITS mm		CODE NO. CL573-0054-0-21		DRAWN <i>M. Sakai</i>		RELEASED <i>J. J. J.</i>
		HIROSE ELECTRIC CO., LTD				99.10.25		99.10.26

TO	
PCK	