

used for:

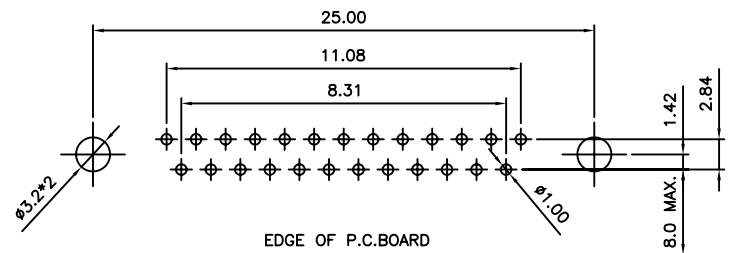
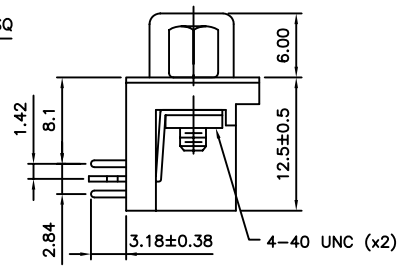
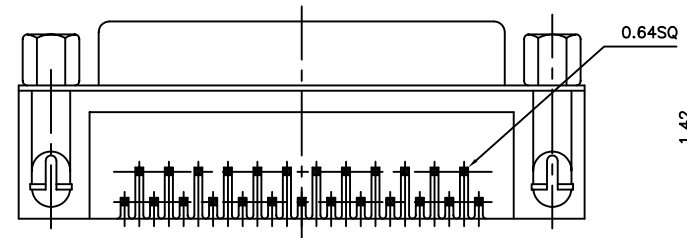
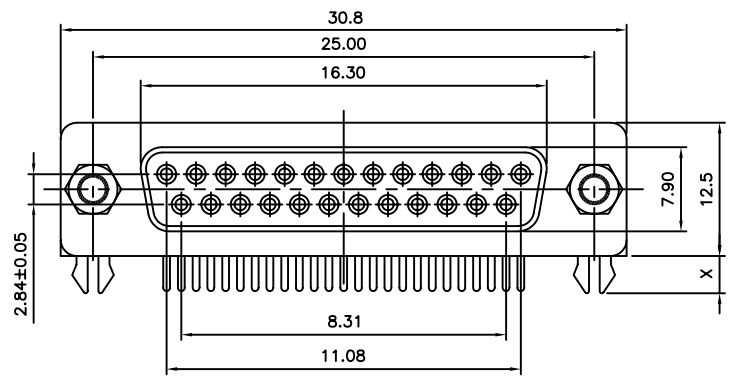

RECOMMENDED P.C.B LAYOUT (TOP VIEW)
TOLERANCES: ±0.05mm

SPECIFICATION

MATERIAL

Insulator: Thermal Plastic UL94V-0
Contacts: Copper Alloy
Shell: Steel
Rivet, Boardlock: Copper Alloy

CONTACT PLATING

Underplate: 50u" Nickel
Contact Area: Selective Gold
Solder Tails Area: 100u" Tin/Lead Free

ELECTRICAL

Operation Voltage: 250 VAC Max.
Current Rating: 3 Amps Max.
Contact Resistance: 15 mohms Max.
Insulation Resistance: 3000 Mohms Min @ 500 VDC
Dielectric Withstanding Voltage: 1000 VAC / Minute
Operating Temperature: -55°C To +105°C

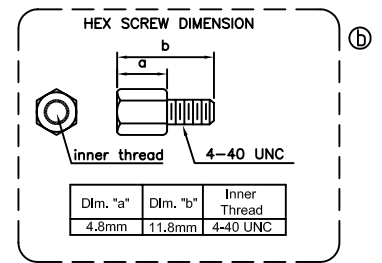

THIS DRAWING MAY NOT BE COPIED OR REPRODUCED IN ANY WAY, AND MAY NOT BE PASSED ON TO A THIRD PARTY WITHOUT WRITTEN PERMISSION. OWNERSHIP AND COPYRIGHT OF CONEC CORPORATION. DO NOT ALTER CAD DRAWING BY HAND.

tolerance		finish	
unless otherwise specified tolerance shall be as follow		2005 date	
Decimal: .x ±0.50	Angles: ±5°	draw. Oct. 03	Vincent Ke
.xx ±0.30		appd. Oct. 03	Kathy
.xxx ±0.20		norm	
		d-old	
b	Dec/14/07	Vincent Ke	
a	origin		
rev.	description	date	name

CONEC[®]

scale:	
material:	SEE NOTES
title:	D-Sub R/A 7.2mm 9pos. female
	RoHS compliant
drawing no.:	AutoCAD 2005
	C0510K01A
part no.:	DLS1XS5AK40X

DIN A3 sheet 1/1

Mouser Electronics

Authorized Distributor

Click to View Pricing, Inventory, Delivery & Lifecycle Information:

[CONEC:](#)

[DLS1XS5AK40X](#)