

SUGGESTED PCB LAYOUT

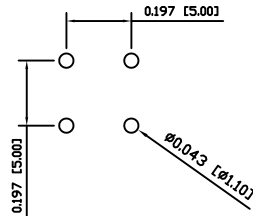

SCHMATIC

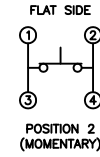
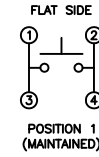

SPECIFICATIONS

FUNCTION:  
1P1T OFF-(ON)

RATINGS:  
10mA 35VDC

OPERATION FORCE:  
130±40gf

CONTACT RESISTANCE:  
Initial: 20mΩ Max.

INSULATION RESISTANCE:  
100MΩ Min. at 500VDC

DIELECTRIC STRENGTH:  
500VAC For 1 Minute

CAPACITANCE:  
1pF

ELECTRICAL LIFE:  
250,000 Cycles

MECHANICAL LIFE:  
500,000 Cycles Min.

TEMPERATURE:  
Operating: -20°C to 85°C

APPROVALS:  
**RoHS**  
COMPLIANT

MATERIALS

UPPER HOUSING:  
Acrylonitrile Butadiene Styrene (ABS)

LOWER HOUSING:  
Polybutylene Terephthalate (PBT)

CONTACTS:  
Silver Plated Copper

TERMINALS:  
Silver Plated Brass

COLORS

UPPER HOUSING COLOR:  
Black

LOWER HOUSING COLOR:  
White

|                |      |          |     |
|----------------|------|----------|-----|
| BODY           | A    | 09/06/06 | CAB |
| COLORS         | A    | 09/06/06 | CAB |
| MATERIALS      | A    | 09/06/06 | CAB |
| SPECIFICATIONS | A    | 09/06/06 | CAB |
| REFERENCE      | REV. | DATE     | BY  |

THE INFORMATION CONTAINED IN THIS DOCUMENT IS PROPRIETARY TO E-SWITCH AND IS NOT TO BE COPIED OR TRANSFERRED

|      |                 |          |          |          |
|------|-----------------|----------|----------|----------|
| A    | INITIAL RELEASE | PCRD0051 | 09/06/06 | CAB      |
| REV. | DESCRIPTION     | PCR      | DATE     | DRAWN BY |

|                    |                      |
|--------------------|----------------------|
| DIMENSIONS         | INCHES [MILLIMETERS] |
| GENERAL TOLERANCES | ±0.008 [±0.2] / ±1°  |
| SCALE              | DRAWING NOT TO SCALE |

|                |                |          |
|----------------|----------------|----------|
|                |                |          |
| KS-01Q-01      |                |          |
| DRAWING NUMBER | DATE           | REVISION |
| 29-KS01Q01     | AUGUST 6, 2009 | A        |

# Mouser Electronics

Authorized Distributor

Click to View Pricing, Inventory, Delivery & Lifecycle Information:

[E-Switch:](#)

[KS-01Q-01](#)