

LOC	DIST	REVISIONS					
		P	LTR	DESCRIPTION	DATE	DWN	APVD
CM	OO		T2	REVISED PER ECR-15-006702	28JUL2015	NK	PQ

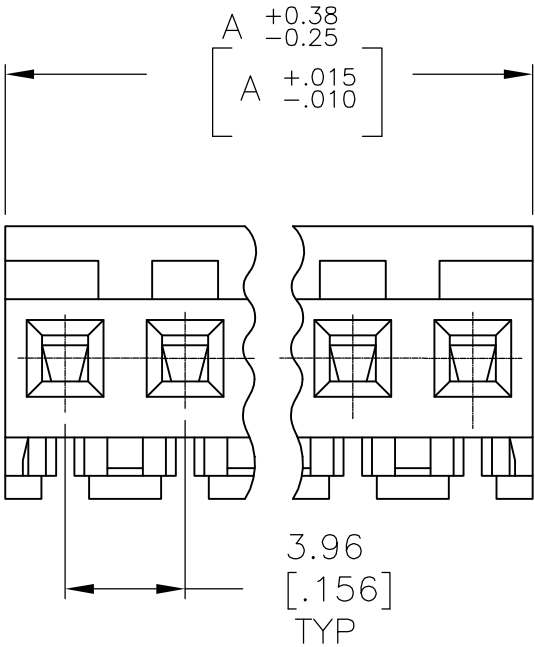
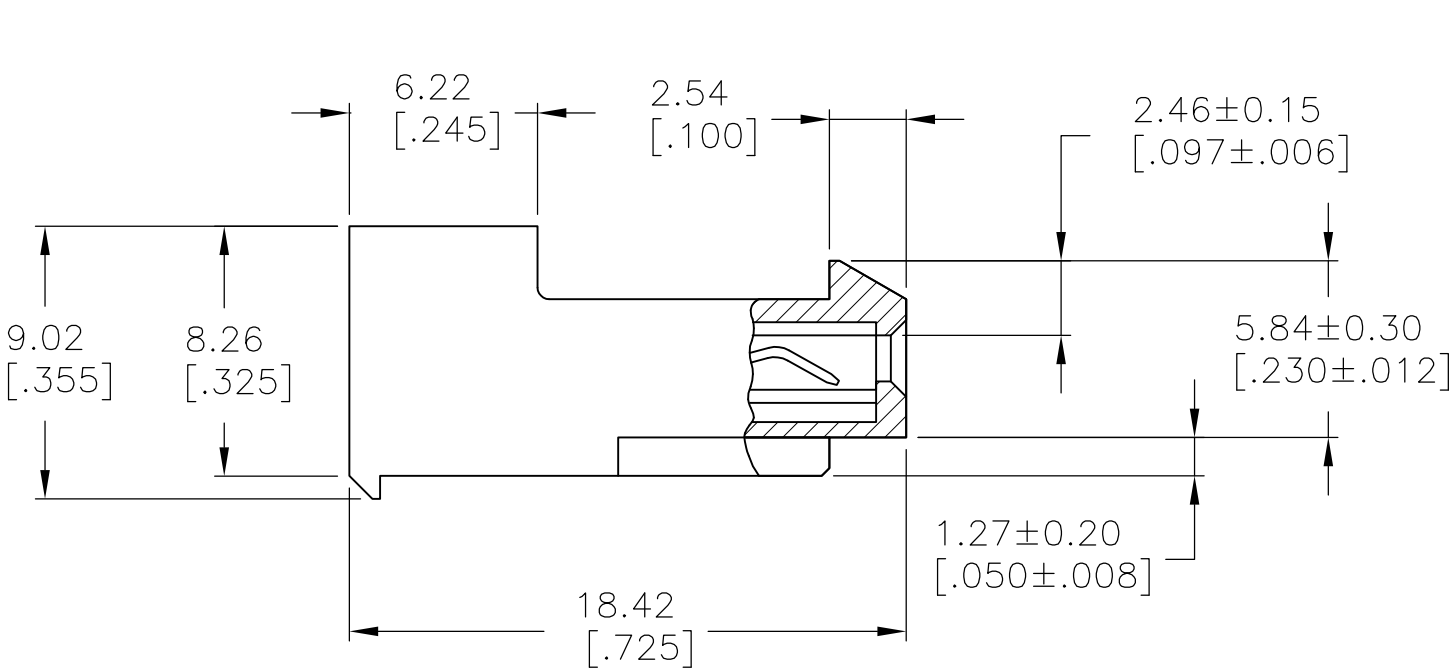
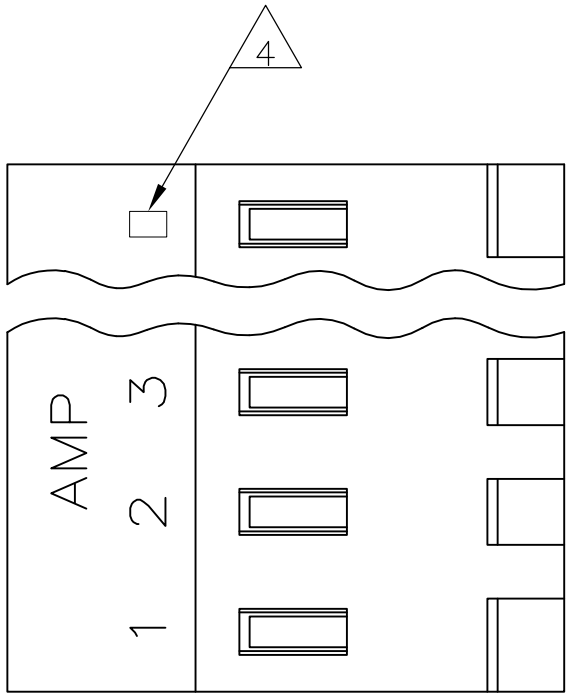

- 1

MATERIAL: CONNECTOR - NYLON UL94-V2 (YELLOW).  
CONTACTS - 0.30[.012] THICK COPPER ALLOY  
(BRIGHT TIN-LEAD 0.00203[.000080] MIN. THICK  
FOR CONTACTS 640427-2 THRU 2-640427-4).  
(MATTE WHISKER MITIGATED TIN 0.00203[.000080] MIN.  
THICKNESS OVER NICKEL UNDERPLATE FOR 3-640427-2  
THRU 5-640427-4).
- 2

CONTACTS ACCEPT 20 AWG WIRE WITH 2.41[.095] MAX  
INSULATION DIAMETER.
- 3

CONTACTS MUST ACCEPT 1.14±0.03[.045]  
POST AND REMAIN LOCKED IN POSITION.
- 4

IDENTIFICATION NUMBER FOR LAST CIRCUIT MAY  
NOT APPEAR ON ALL ASSEMBLIES.
- 5

DIMENSIONS IN BRACKETS ARE IN INCHES.
- 6

HOUSING FEATURES ARE: CLOSED END WITH LOCKING  
RAMP.
- 7

OBSOLETE PARTS: OBSOLETE CIS STREAMLINING PER D.RENAUD/D.SINISI

95.10[3.744]	24	5-640427-4
91.13[3.588]	23	5-640427-3
87.17[3.432]	22	5-640427-2
83.21[3.276]	21	5-640427-1
79.25[3.120]	20	5-640427-0
75.29[2.964]	19	4-640427-9
71.32[2.808]	18	4-640427-8
67.36[2.652]	17	4-640427-7
63.40[2.496]	16	4-640427-6
59.44[2.340]	15	4-640427-5
55.47[2.184]	14	4-640427-4
51.51[2.028]	13	4-640427-3
47.55[1.872]	12	4-640427-2
43.59[1.716]	11	4-640427-1
39.62[1.560]	10	4-640427-0
35.66[1.404]	9	3-640427-9
31.70[1.248]	8	3-640427-8
27.74[1.092]	7	3-640427-7
23.77[.936]	6	3-640427-6
19.81[.780]	5	3-640427-5
15.85[.624]	4	3-640427-4
11.89[.468]	3	3-640427-3
7.92[.312]	2	3-640427-2

<div>7</div>	SUPERCEDED	95.10[3.744]	24	<del>2-640427-4</del>
<div>7</div>	SUPERCEDED	91.13[3.588]	23	<del>2-640427-3</del>
<div>7</div>	SUPERCEDED	87.17[3.432]	22	<del>2-640427-2</del>
<div>7</div>	SUPERCEDED	83.21[3.276]	21	<del>2-640427-1</del>
<div>7</div>	SUPERCEDED	79.25[3.120]	20	<del>2-640427-0</del>
<div>7</div>	SUPERCEDED	75.29[2.964]	19	<del>1-640427-9</del>
		71.32[2.808]	18	1-640427-8
<div>7</div>	SUPERCEDED	67.36[2.652]	17	<del>1-640427-7</del>
		63.40[2.496]	16	1-640427-6
		59.44[2.340]	15	1-640427-5
		55.47[2.184]	14	1-640427-4
		51.51[2.028]	13	1-640427-3
		47.55[1.872]	12	1-640427-2
		43.59[1.716]	11	1-640427-1
	OBSOLETE	39.62[1.560]	10	<del>1-640427-0</del>
		35.66[1.404]	9	640427-9
		31.70[1.248]	8	640427-8
		27.74[1.092]	7	640427-7
		23.77[.936]	6	640427-6
		19.81[.780]	5	640427-5
		15.85[.624]	4	640427-4
		11.89[.468]	3	640427-3
		7.92[.312]	2	640427-2
		DIM A	NO. OF CIRCUITS	PART NO.

THIS DRAWING IS A CONTROLLED DOCUMENT.		DWN S. CARPENTER 07JUL03	<div><div>TE</div>TE Connectivity</div>		
DIMENSIONS: mm [INCHES]		CHK D. BOSSI 07JUL03			
		APVD D. BOSSI 07JUL03	NAME MTA 156 CONNECTOR ASSEMBLY, 20 AWG, STANDARD -		
		PRODUCT SPEC 108-1051			
TOLERANCES UNLESS OTHERWISE SPECIFIED:		APPLICATION SPEC 114-1020	SIZE A2	CAGE CODE 00779	DRAWING NO C=640427
MATERIAL 1		WEIGHT -	SCALE 4:1	SHEET 1 OF 1	REV T2
FINISH 1		CUSTOMER DRAWING	RESTRICTED TO -		

# Mouser Electronics

Authorized Distributor

Click to View Pricing, Inventory, Delivery & Lifecycle Information:

[TE Connectivity:](#)

[640427-7](#)