

WILL ACCEPT 26-20 AWG WIRE

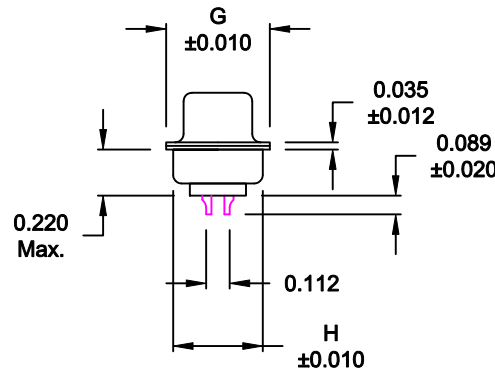
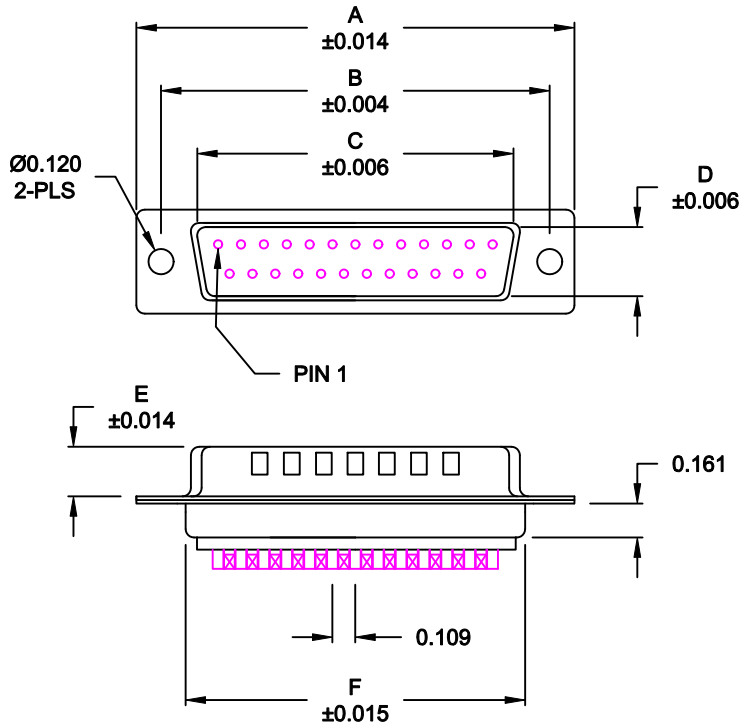

No. OF PINS	DIMENSIONS							
	A	B	C	D	E	F	G	H
9	1.213	0.984	0.666	0.329	0.236	0.756	0.496	0.427
	30.80	24.99	16.92	8.36	5.99	19.20	12.60	10.85
15	1.541	1.312	0.994	0.329	0.236	1.091	0.496	0.427
	39.15	33.32	25.25	8.36	5.99	27.70	12.60	10.85
25	2.087	1.852	1.534	0.329	0.236	1.618	0.496	0.427
	53.00	47.04	38.96	8.36	5.99	41.10	12.60	10.85
37	2.728	2.500	2.182	0.329	0.236	2.256	0.496	0.427
	69.30	63.50	55.42	8.36	5.99	57.30	12.60	10.85
50	2.638	2.406	2.079	0.436	0.240	2.169	0.602	0.527
	67.00	61.11	52.80	11.07	6.10	55.10	15.30	13.39

172-EYY-10YRYY1

- SERIES _____
- POSITIONS _____
- E09 _____
- E15 _____
- E25 _____
- E37 _____
- E50 _____
- GENDER _____
- 1 = MALE
- TERMINATION _____
- 0 = SOLDER CUP
- SHELL PLATING _____
- 2 = TIN (GROUND INDENTS)
- 3 = NICKEL (GROUND INDENTS)
- RoHS COMPLIANT _____
- HARDWARE OPTIONS _____
- 00 = NO HARDWARE
- 01 = .098" CLINCH NUT (BOARD SIDE)
- 02 = .236" CLINCH NUT (BOARD SIDE)
- 03 = .236" CLINCH NUT (MOUNTING SIDE)
- 05 = .237" 4-40 BOARD LOCK
- 91 = .237" 4-40 SPACER/ BOARD LOCK
- PLATING OPTIONS _____
- 1 = GOLD FLASH
- 2 = 30MICRO-INCH GOLD

MATERIAL:

- SHELL: STEEL, NICKEL OR TIN PLATED
- INSULATOR: UL 94V-0 RATED PBT-WHITE
- PROCESS TEMP.: 230° FOR CABLE APPLICATIONS, 260° FOR BOARD CONTACT: BRASS

ELECTRICAL:

- CURRENT RATING: 5 AMPS
- CONTACT RESISTANCE: 15 mOhms Max.
- INSULATION RESISTANCE: 1,000 MOhms min.
- VOLTAGE: 500VAC FOR 1 MINUTE
- TEMPERATURE: -50° C TO 100° C

DO NOT SCALE FROM DRAWING

RoHS COMPLIANT

	THESE DRAWINGS AND SPECIFICATIONS ARE THE PROPERTY OF NorComp AND SHALL NOT BE REPRODUCED, COPIED OR USED AS THE BASIS FOR THE MANUFACTURE OF SALE OF APPARATUS WITHOUT WRITTEN PERMISSION.		DRAWN: PAM JENKINS	DATE: 11-28-05
			CHECKED:	DATE:
NorComp		SCALE: 1:1	SHEET 1 OF 2	REV 10
		DWG NO. 172-EYY-10YRYY1		

ALL CLINCH-NUTS ARE 4-40 INTERNAL THREADS

01X 0.098" (BOARD SIDE) - CN1

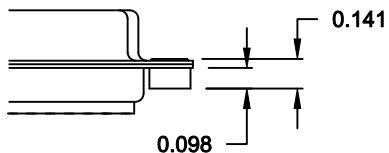

02X 0.236" (BOARD SIDE) - CN2

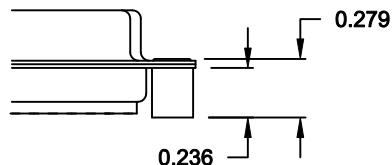

03X..... 0.236" (MATING SIDE) - CN8

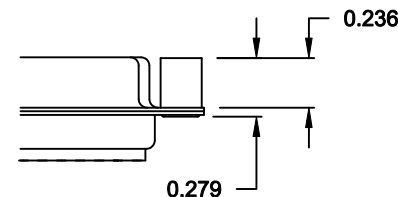

05X 0.237" (BOARD SIDE) - CN10

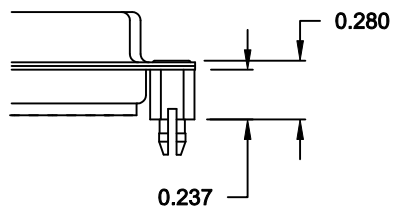

91X 0.237" BOARD SIDE
0.197" MATING SIDE
CN10/SFSO4404

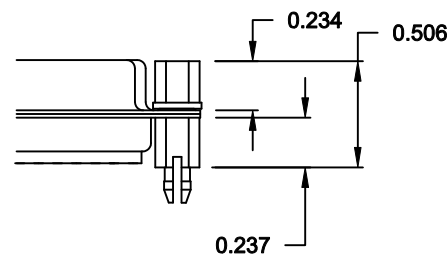

NOTE: 4-40 FEMALE SCREW LOCK IS REMOVABLE

DO NOT SCALE FROM DRAWING

	THESE DRAWINGS AND SPECIFICATIONS ARE THE PROPERTY OF NorComp AND SHALL NOT BE REPRODUCED, COPIED OR USED AS THE BASIS FOR THE MANUFACTURE OF SALE OF APPARATUS WITHOUT WRITTEN PERMISSION.		DRAWN: WAYNE ROBBINS	DATE: 11-28-05
			CHECKED:	DATE:
<h1>NorComp</h1>		SCALE:	SHEET 2 OF 2	REV 10
		DWG NO. 172-EYY-10YRYY1		

RoHS COMPLIANT

Mouser Electronics

Authorized Distributor

Click to View Pricing, Inventory, Delivery & Lifecycle Information:

NorComp:

<u>172-E50-103R021</u>	<u>172-E50-103R011</u>	<u>172-E50-103R031</u>	<u>172-E25-103R021</u>	<u>172-E25-103R011</u>	<u>172-E25-103R031</u>
<u>172-E15-103R031</u>	<u>172-E15-103R011</u>	<u>172-E15-103R021</u>	<u>172-E25-103R911</u>	<u>172-E37-103R911</u>	<u>172-E50-103R911</u>
<u>172-E09-103R011</u>	<u>172-E09-103R031</u>	<u>172-E09-103R021</u>	<u>172-E37-103R021</u>	<u>172-E37-103R011</u>	<u>172-E37-103R031</u>
<u>172-E50-203R001</u>	<u>172-E50-103R001</u>	<u>172-E25-203R001</u>	<u>172-E25-103R001</u>	<u>172-E15-103R001</u>	<u>172-E15-203R001</u>
<u>172-E09-103R001</u>	<u>172-E37-203R001</u>	<u>172-E37-103R001</u>	<u>172-E09-103R911</u>	<u>172-E09-102R001</u>	<u>172-E09-102R011</u>
<u>172-E09-102R021</u>	<u>172-E09-102R031</u>	<u>172-E09-202R001</u>	<u>172-E15-102R001</u>	<u>172-E15-102R011</u>	<u>172-E15-102R021</u>
<u>172-E15-102R031</u>	<u>172-E15-202R001</u>	<u>172-E25-102R001</u>	<u>172-E25-102R011</u>	<u>172-E25-102R021</u>	<u>172-E25-102R031</u>
<u>172-E25-202R001</u>	<u>172-E37-102R001</u>	<u>172-E37-102R011</u>	<u>172-E37-102R021</u>	<u>172-E37-102R031</u>	<u>172-E37-202R001</u>
<u>172-E50-102R001</u>	<u>172-E50-102R011</u>	<u>172-E50-102R021</u>	<u>172-E50-102R031</u>	<u>172-E50-202R001</u>	