

DESCRIPTION: TOP ENTRY - DIE CAST

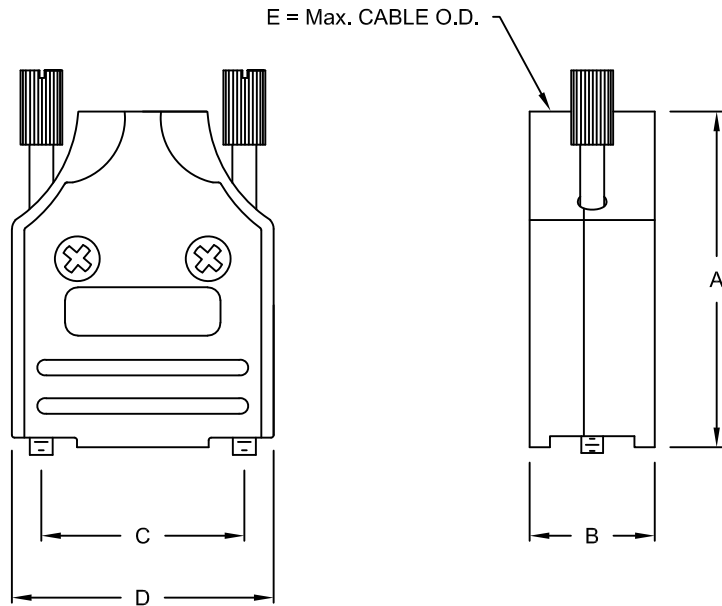

BACKSHELL KIT INCLUDES:

- (2) BACKSHELL HALVES
- (2) STRAIN RELIEF CLAMPS
- (2) STRAIN RELIEF SCREWS
- (2) MOUNTING SCREWS
- (2) THUMBSCREWS
- (3-SETS) METALIZED PLASTIC INSERTS

SPECIFICATIONS:

BACKSHELL: DIE CAST ZINC ALLOY
 PLATING: NICKEL
 GROMMET: THERMOPLASTIC ABS
 COLOR: NATURAL NICKEL PLATED
 SCREW: STEEL, ZINC PLATED
 CLAMP: STEEL, NICKEL PLATED
 OPERATING TEMP: -40° C TO +120° C

DIMENSIONS (IN.)					
No. OF PINS	A	B	C	D	E
09	1.626	0.606	0.984	1.268	0.512
15	1.705	0.606	1.312	1.598	0.512
25	1.949	0.606	1.852	2.146	0.512
37	2.138	0.606	2.500	2.783	0.512

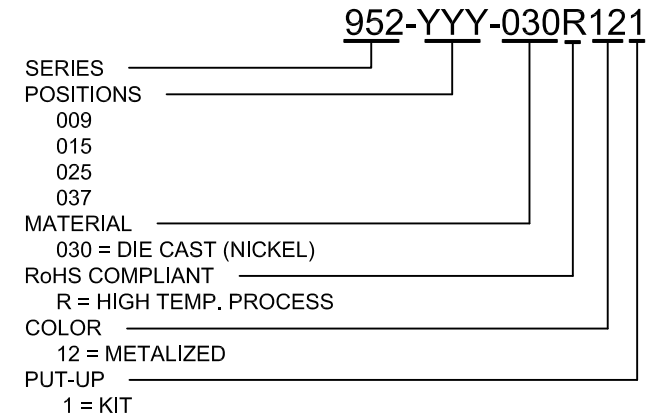

DO NOT SCALE FROM DRAWING

RoHS COMPLIANT

	THESE DRAWINGS AND SPECIFICATIONS ARE THE PROPERTY OF NorComp AND SHALL NOT BE REPRODUCED, COPIED OR USED AS THE BASIS FOR THE MANUFACTURE OF SALE OF APPARATUS WITHOUT WRITTEN PERMISSION.		DRAWN: C. SMITH	DATE: 03-29-07
	<h1>NorComp</h1>		SCALE: NTS	SHEET OF 1 1
DWG NO. 952-YYY-030R121			REV 1	

Mouser Electronics

Authorized Distributor

Click to View Pricing, Inventory, Delivery & Lifecycle Information:

[NorComp:](#)

[952-037-030R121](#) [952-009-030R121](#) [952-015-030R121](#) [952-025-030R121](#)