

THIS DRAWING IS UNPUBLISHED.

RELEASED FOR PUBLICATION

© COPYRIGHT By -

ALL RIGHTS RESERVED.

REVISIONS

P	LTR	DESCRIPTION	DATE	DWN	APVD
	B	REVISED PER ECO-17-008763	19DEC2017	RG	SH

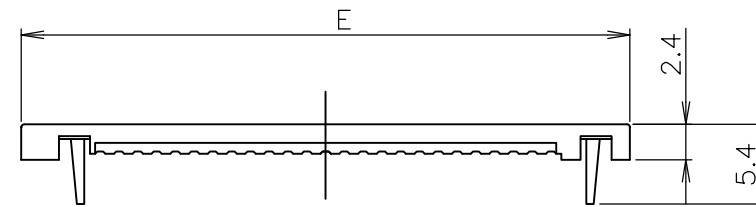
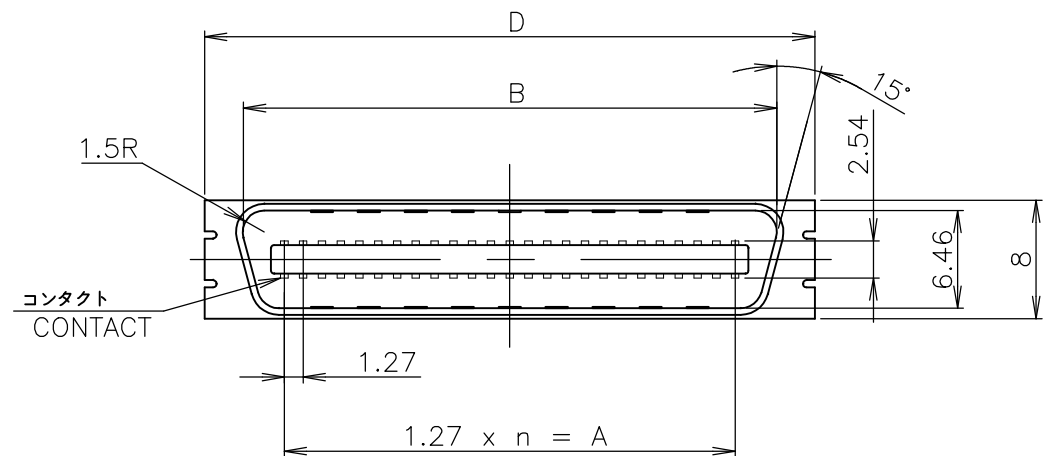

COVER HOUSING (2EA/KIT)

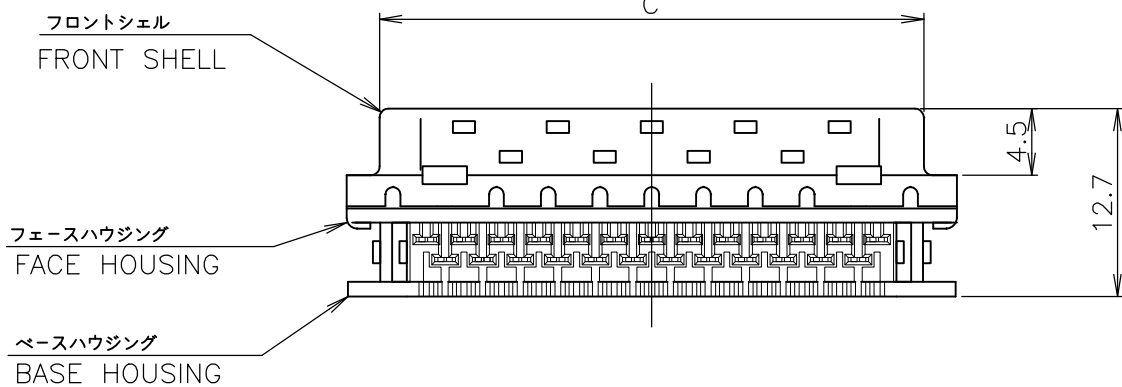
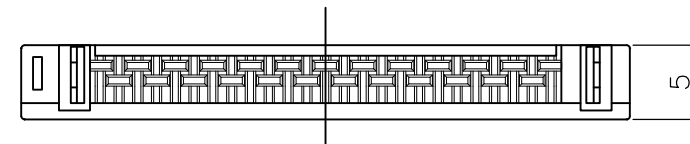

OBSOLETE	49.53	54.69	55.7	60.3	60.2	0.76u	39	80	3-5175677-0
	62.23	67.45	68.4	73.0	72.9	0.76u	49	100	2-5175677-9
	41.91	47.13	48.0	52.7	52.6	0.76u	33	68	2-5175677-8
	30.48	35.70	36.6	41.3	41.2	0.76u	24	50	2-5175677-7
	21.59	26.81	27.7	32.4	32.3	0.76u	17	36	2-5175677-5
	15.24	20.46	21.4	26.0	25.9	0.76u	12	26	2-5175677-4
OBSOLETE	11.43	16.65	17.6	22.2	22.1	0.76u	9	20	2-5175677-2
	7.62	12.84	13.7	18.4	18.3	0.76u	6	14	2-5175677-1
	49.53	54.69	55.7	60.3	60.2	0.3u	39	80	1-5175677-0
	62.23	67.45	68.4	73.0	72.9	0.3u	49	100	5175677-9
	41.91	47.13	48.0	52.7	52.6	0.3u	33	68	5175677-8
	30.48	35.70	36.6	41.3	41.2	0.3u	24	50	5175677-7
OBSOLETE	21.59	26.81	27.7	32.4	32.3	0.3u	17	36	5175677-5
	15.24	20.46	21.4	26.0	25.9	0.3u	12	26	5175677-4
	11.43	16.65	17.6	22.2	22.1	0.3u	9	20	5175677-2
	7.62	12.84	13.7	18.4	18.3	0.3u	6	14	5175677-1
	A	B	C	D	E	Au.PLATING	n	POS	PART No.

NOTE

- MATERIAL & FINISH
  - \*CONTACT; COPPER ALLOY Au PL.0.3 AND 0.76 MIN. AT CONTACT AREA AND TIN PL. AT I.D. AREA OVER Ni PL.
  - \*FRONT SHELL; STEEL, Ni PL.
  - \*HOUSING(BASE,FACE,COVER); THERMO-PLASTIC,GF,UL 94V-0. BLACK
- APPLICABLE WIRE; PLEASE CONFIRM TO TE CONNECTIVITY ENGINEERING.

TOLERANCES UNLESS OTHERWISE SPECIFIED  
一般公差

10 ≧	±0.2
30 ≧	>10 ±0.25
100 ≧	>30 ±0.3
ANGLES ±3°	

THIS DRAWING IS A CONTROLLED DOCUMENT.

DIMENSIONS: mm

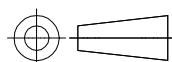

TOLERANCES UNLESS OTHERWISE SPECIFIED:

0 PLC	±
1 PLC	±
2 PLC	±
3 PLC	±
4 PLC	±
ANGLES	±

MATERIAL

SEE NOTES

FINISH

SEE NOTES

DWN COREL.WANG 19APR05

CHK STEVEN YAO 19APR05

APVD I.ENOMOTO 19APR05

PRODUCT SPEC

APPLICATION SPEC

WEIGHT 0.000000

CUSTOMER DRAWING

STE TE Connectivity Ltd.

CHAMP .050 PLUG CONN. KIT

SIZE	CAGE CODE	DRAWING NO	RESTRICTED TO
A3	00779	C-5175677	-

SCALE	SHEET	REV
2:1	1 OF 1	B

# Mouser Electronics

Authorized Distributor

Click to View Pricing, Inventory, Delivery & Lifecycle Information:

[TE Connectivity:](#)

[5175677-8](#)