

PART NUMBER	COPPER CONDUCTOR SIZE RANGE	STUD HOLE SIZE (IN.)	STUD HOLE SPACING (IN.)	HEX KEY SIZE (IN.)	FIGURE DIMENSIONS (IN.)					TIGHTENING TORQUE (IN.-LBS.)	STD. PKG. QTY.
					L	W	H	T	P		
H2L4-2N-X	#8 SOL- #4 STR	1/2	1.75	***	3.75	1.25	.76	.19	3.00	35	10
H2L8-2N-2	#4 SOL- #1 STR	1/2	1.75	7/16	3.94	1.38	.92	.22	3.00	100	2
H2L13-2N-2	#1 SOL- 2/0 STR	1/2	1.75	9/16	4.00	1.63	1.06	.22	3.00	250	2
H2L21-2N-2	2/0 STR- 4/0 STR	1/2	1.75	9/16	4.19	1.88	1.34	.31	3.00	250	2
H2L30-2N-1	4/0 STR- 300 kcmil	1/2	1.75	5/8	4.38	2.00	1.45	.31	3.00	350	1

NOTES:

1. ALLOWS FOR TERMINATION OF TWO COPPER CONDUCTORS.
2. CAST FROM HIGH STRENGTH CORROSION RESISTANT COPPER ALLOY TO PROVIDE PREMIUM ELECTRICAL AND MECHANICAL PERFORMANCE.
3. WIRE RANGE-TAKING CAPABILITY MINIMIZES INVENTORY REQUIREMENTS.
4. INTERNAL PRESSURE PLATE PROVIDES UNIFORM CLAMPING FORCE ON CONDCUTOR FOR PREMIUM ELECTRICAL PERFORMANCE.
5. INTERNAL BARREL SERRATIONS PROVIDE PREMIUM WIRE PULL-OUT STRENGTH.
6. INSPECTION WINDOW TO VISUALLY ASSURE FULL CONDUCTOR INSERTION.
7. FLAT BOTTOM ALLOWS FOR COMPLETE CONTACT WITH MOUNTING SURFACE.
8. UL LISTED FOR USE UP TO 600V AND TEMPERATURE RATED 90° C.

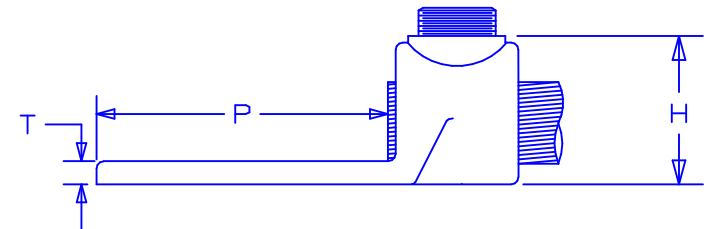
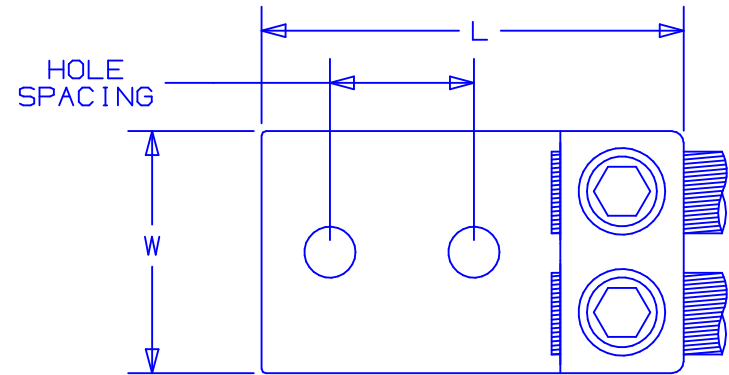

C41436_00

00	9/04	KF		RELEASED			
REV	DATE	BY	CHK	DESCRIPTION	ECN #	PM	CUST



TINLEY PARK, ILLINOIS

TWO-HOLE, STRAIGHT TONGUE,
TWO BARREL LUG
H2L-2N FAMILY

DRAWN BY KLFU	CHK'D	SCALE NONE	DRAWING NO. C41436
------------------	-------	---------------	-----------------------

Mouser Electronics

Authorized Distributor

Click to View Pricing, Inventory, Delivery & Lifecycle Information:

[Panduit:](#)

[H2L4-2N-X](#) [H2L13-2N-2](#) [H2L30-2N-1](#) [H2L21-2N-2](#) [H2L8-2N-2](#)