

PRODUCT NUMBER
10082201-YXX-XXLF

PLATING

1 = 0.76µm GOLD OR
0.76µm GXT (PdNi WITH
GOLD FLASH)
ON CONTACT AREA
2µm MATTE TIN ON TAIL

4 = 2µm MATTE TIN
ON CONTACT AREA
AND TAIL

8 = 0.38µm GOLD
ON CONTACT AREA
2µm MATTE TIN
ON TAIL

RoHs COMPATIBLE, NOTE 7.

TOTAL NB OF POSITIONS
02 TO 36

PACKAGING, NOTE 3.

PIN STYLE	MATING SIDE	DIM "B"
01	5.84	2.50
02	6.75	2.50
03	5.84	3.00
04	6.75	3.00
05	11.60	3.00
06	9.50	4.30
07	8.07	3.00

NOTES:

- HOUSING MAT'L : HIGH TEMPERATURE THERMOPLASTIC. UL94V-0 COLOR: BLACK
- PIN MATERIAL : PHOSPHOR BRONZE
- PACKAGING.
 - = POLY BAGS
 - A = TAPE & REEL WITH CAP, AS AVAILABLE
 - K = TAPE & REEL WITHOUT PICK UP CAP, AS AVAILABLE
- 9N MIN RETENTION IN EITHER DIRECTION
- TO DETERMINE DIMENSIONS :
N = NUMBER OF POSITIONS PER ROW
EXAMPLE : 8 POS N x 2.54 = 20.32mm
- UNDERPLATING : 1.27µm Ni MIN
- RoHS COMPATIBLE PRODUCT SPECIFICATIONS

a - PLATING:

- "LF" MEANS THE PRODUCT IS LEAD-FREE,
2µm MINIMUM MATTE TIN OVER 1.27µm
MINIMUM NICKEL UNDERPLATE.

b - MANUFACTURING PROCESS COMPATIBILITY

- THE HOUSING WILL WITHSTAND EXPOSURE TO
260°C PEAK TEMPERATURE FOR 30 SECONDES
IN A CONVECTION, INFRA-RED OR VAPOR
PHASE REFLOW OVEN.

c - LABELING:

- MEETS PACKAGING SPECS AS PER GS-14-920

d - LEGAL STATEMENT: SEE GS-47-0004

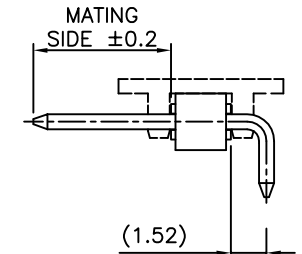
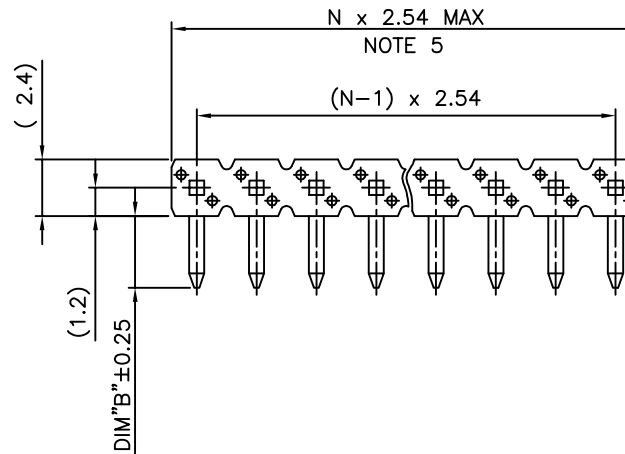
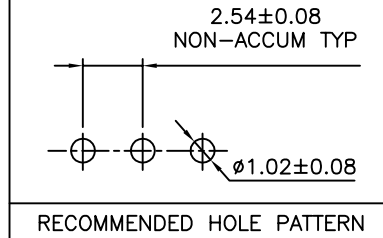
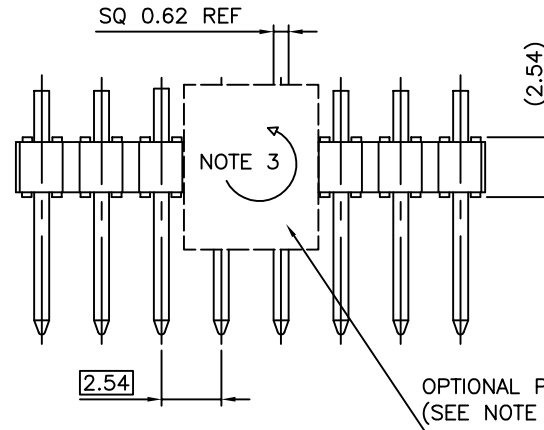

mat'l. code SEE NOTES		surface ISO 1302	tolerance ISO 406 ISO 1101	projection	product family BERGSTIK
ltr	ecn no	dr	date	tolerances unless otherwise specified	title
A	F08-0104	LMU	08.01.15	angles	UNSHR.HEADER RA SR PIN IN PASTE
B	F09-0072	JCO	09.07.23	linear	
C	F12-0032	LMU	12.05.04	.X ±0.3 .XX ±0.15 .XXX ±0.05	scale 5:1
D	B-18990	LMU	14.10.06	dr	L.MULIN 08.01.15
E	B-20031	AMA	15.01.20	engr	J.COMPAGNON 08.01.15
F	F-23188	AMA	16.02.01	chr	
				appd	J.M.C 08.01.15
sheet index	revision sheet				type CUSTOMER Drawing

Mouser Electronics

Authorized Distributor

Click to View Pricing, Inventory, Delivery & Lifecycle Information:

FCI / Amphenol:

[10082201-101-20LF](#) [10082201-101-07LF](#) [10082201-105-06LF](#) [10082201-404-10LF](#) [10082201-101-06LF](#)
[10082201-401-02LF](#) [10082201-101-18LF](#) [10082201-104-20LF](#) [10082201-101-30LF](#) [10082201-101-10LF](#) [10082201-](#)
[404-06LF](#) [10082201-404-04LF](#) [10082201-101-04LF](#) [10082201-405A06LF](#) [10082201-406K06LF](#) [10082201-101-08LF](#)
[10082201-405-04LF](#) [10082201-405-03LF](#) [10082201-407-04LF](#) [10082201-104A14LF](#) [10082201-104A04LF](#)
[10082201-104A12LF](#) [10082201-104A10LF](#) [10082201-102-36LF](#) [10082201-104A05LF](#) [10082201-104A06LF](#)