

DESCRIPTION: FEMALE - DIP SOLDER / MACHINED - ECONOMY

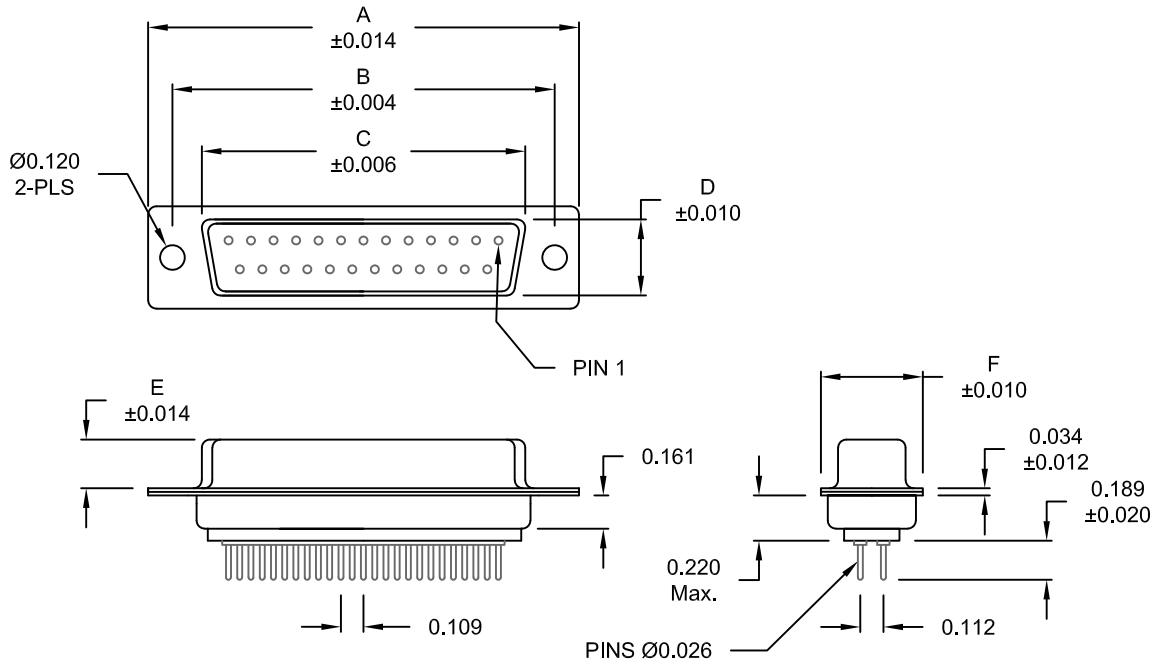

**MATERIAL:**

SHELL: STEEL, NICKEL OR TIN PLATED  
 INSULATOR: UL 94V-O RATED, WHITE, PA6T  
 PROCESS TEMP.: 260° PROCESS TEMPERATURE  
 CONTACT: BRASS

**ELECTRICAL:**

CURRENT RATING: 5 AMPS  
 CONTACT RESISTANCE: 15 mOhms Max.  
 INSULATION RESISTANCE: 1,000 MOhms min.  
 VOLTAGE: 500VAC FOR 1 MINUTE  
 TEMPERATURE: -55° C TO 125° C

No. OF PINS	DIMENSIONS					
	A	B	C	D	E	F
9	1.213	0.984	0.642	0.311	0.236	0.496
	30.80	24.99	16.30	7.90	5.99	12.60
15	1.541	1.312	0.970	0.311	0.236	0.496
	39.15	33.32	24.65	7.90	5.99	12.60
25	2.087	1.852	1.512	0.311	0.236	0.496
	53.00	47.04	38.40	7.90	5.99	12.60
37	2.728	2.500	2.157	0.311	0.236	0.496
	69.30	63.50	54.80	7.90	5.99	12.60
50	2.638	2.406	2.055	0.429	0.240	0.602
	67.00	61.10	52.20	10.90	6.10	15.30

**172-EYY-21YRY1**

SERIES \_\_\_\_\_  
 POSITIONS \_\_\_\_\_  
 E09 \_\_\_\_\_  
 E15 \_\_\_\_\_  
 E25 \_\_\_\_\_  
 E37 \_\_\_\_\_  
 E50 \_\_\_\_\_  
 GENDER \_\_\_\_\_  
 2 = FEMALE  
 TERMINATION \_\_\_\_\_  
 1 = DIP SOLDER  
 SHELL PLATING \_\_\_\_\_  
 2 = TIN  
 3 = NICKEL  
 RoHS COMPLIANT \_\_\_\_\_  
 HARDWARE OPTIONS \_\_\_\_\_  
 00 = NO HARDWARE  
 01 = .098" CLINCH NUT (BOARD SIDE)  
 02 = .236" CLINCH NUT (BOARD SIDE)  
 03 = .236" CLINCH NUT (MOUNTING SIDE)  
 05 = .237" 4-40 BOARD LOCK  
 08 = .228" 4-40 BOARD LOCK  
 90 = .237" 4-40 BOARD LOCK  
 FOR 0.093" BOARD MAX.  
 91 = .237" 4-40 SPACER/ BOARD LOCK  
 92 = .237" 4-40 SPACER/ BOARD LOCK  
 FOR 0.093" BOARD MAX.  
 PLATING OPTIONS \_\_\_\_\_  
 1 = GOLD FLASH  
 2 = 30MICRO-INCH GOLD  
 5 = 15 MICRO-INCH GOLD

UNITS = inch [mm]

**DO NOT SCALE FROM DRAWING**

**RoHS COMPLIANT**

	THESE DRAWINGS AND SPECIFICATIONS ARE THE PROPERTY OF NorComp AND SHALL NOT BE REPRODUCED, COPIED OR USED AS THE BASIS FOR THE MANUFACTURE OF SALE OF APPARATUS WITHOUT WRITTEN PERMISSION.		DRAWN: <b>PAM JENKINS</b>	DATE: <b>11-28-05</b>
	<h1>NorComp</h1>		SCALE: NTS	SHEET 1 OF 3
			DWG NO. <b>172-EYY-21YRY1</b>	

DESCRIPTION: PCB LAYOUT - STANDARD "D" - MALE & FEMALE

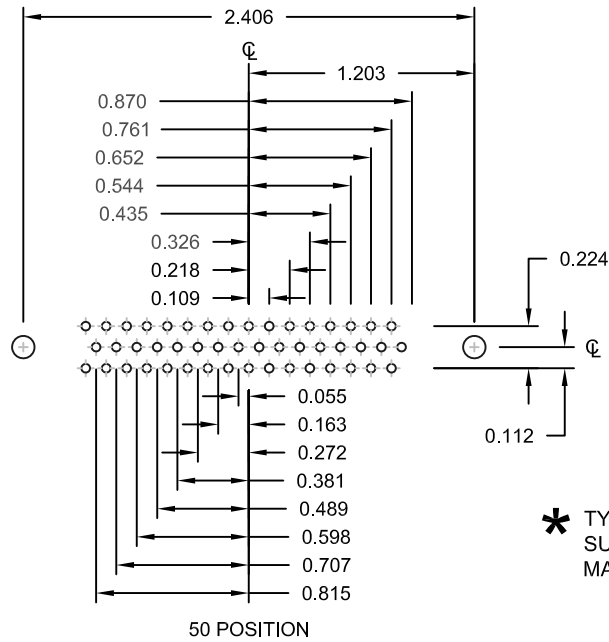
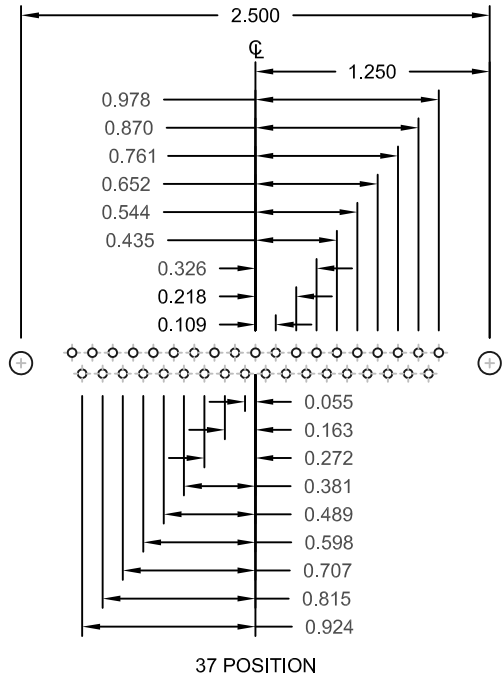
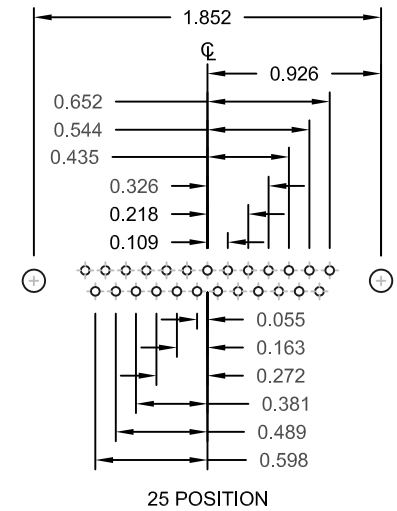
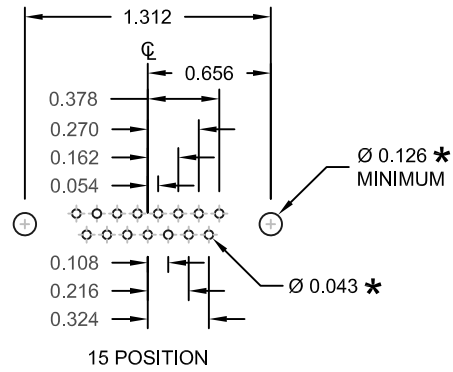
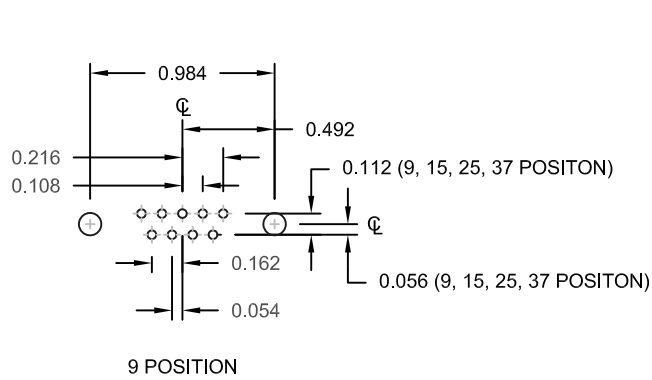

\* TYP. SUGGESTED SIZE MAY NOT BE SUITABLE FOR ALL APPLICATIONS

UNITS = inch

DO NOT SCALE FROM DRAWING



THESE DRAWINGS AND SPECIFICATIONS ARE THE PROPERTY OF NorComp AND SHALL NOT BE REPRODUCED, COPIED OR USED AS THE BASIS FOR THE MANUFACTURE OF SALE OF APPARATUS WITHOUT WRITTEN PERMISSION.

DRAWN: PAM JENKINS		DATE: 11-28-05	
SCALE: NTS	SHEET 2	OF 3	REV 16
DWG NO. 172-EYY-21YRY1			

NorComp

DESCRIPTION: CLINCH NUT HARDWARE

ALL CLINCH-NUTS ARE 4-40 INTERNAL THREADS

TOLERANCE:

ALL DIMENSIONS ARE ±0.010

01X ..... 0.098" (BOARD SIDE)

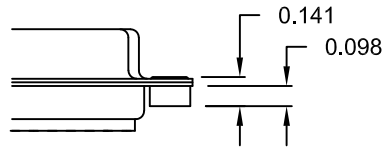

02X ..... 0.236" (BOARD SIDE)

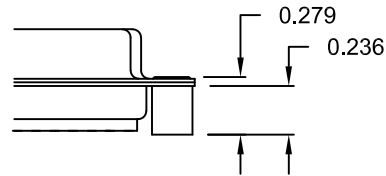

03X..... 0.236" (MATING SIDE)

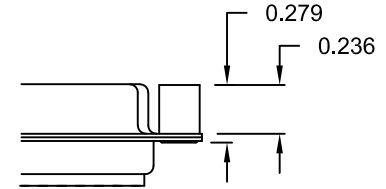

05X ..... 0.237" (BOARD SIDE)

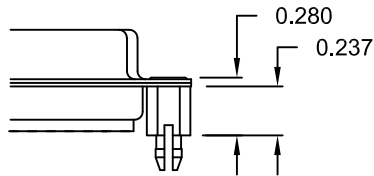

08X ..... 0.228" (BOARD SIDE)

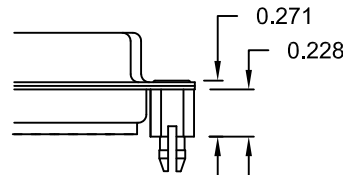

91X ..... 0.237" BOARD SIDE  
0.197 MATING SIDE

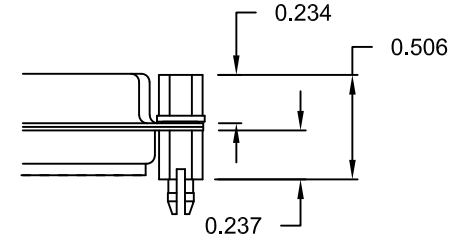

NOTE: 4-40 FEMALE SCREW LOCK IS REMOVABLE

90X ..... 0.237" (BOARD SIDE)

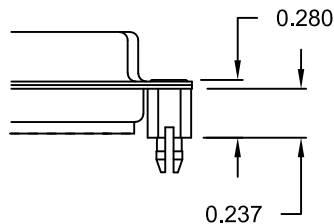

92X ..... 0.237" BOARD SIDE  
0.197 MATING SIDE

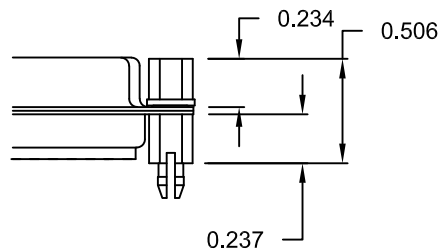

NOTE: 4-40 FEMALE SCREW LOCK IS REMOVABLE

UNITS = inch [mm]

DO NOT SCALE FROM DRAWING

NOTE: 90 & 92 OPTION FOR 0.093" MAX. BOARD THICKNESS



THESE DRAWINGS AND SPECIFICATIONS ARE THE PROPERTY OF NorComp AND SHALL NOT BE REPRODUCED, COPIED OR USED AS THE BASIS FOR THE MANUFACTURE OF SALE OF APPARATUS WITHOUT WRITTEN PERMISSION.

DRAWN: PAM JENKINS		DATE: 11-28-05	
SCALE: NTS	SHEET 3	OF 3	REV 16
DWG NO. 172-EYY-21YRY1			

RoHS COMPLIANT

NorComp

# Mouser Electronics

Authorized Distributor

Click to View Pricing, Inventory, Delivery & Lifecycle Information:

## NorComp:

[172-E37-213R021](#) [172-E37-213R011](#) [172-E37-213R031](#) [172-E09-213R021](#) [172-E09-213R011](#) [172-E09-213R031](#)  
[172-E25-213R031](#) [172-E25-213R011](#) [172-E25-213R021](#) [172-E50-213R021](#) [172-E50-213R011](#) [172-E50-213R031](#)  
[172-E15-213R021](#) [172-E15-213R031](#) [172-E15-213R011](#) [172-E09-211R031](#) [172-E09-213R911](#) [172-E15-213R911](#)  
[172-E25-213R911](#) [172-E37-213R911](#) [172-E50-213R911](#) [172-E50-213R051](#) [172-E15-213R051](#) [172-E09-213R051](#)  
[172-E25-213E051](#) [172-E37-213R051](#)