

REVISIONS					
P	LTR	DESCRIPTION	DATE	DWN	APVD
A2	REVISED PER	ECO-17-011927	22AUG2017	RS	KR

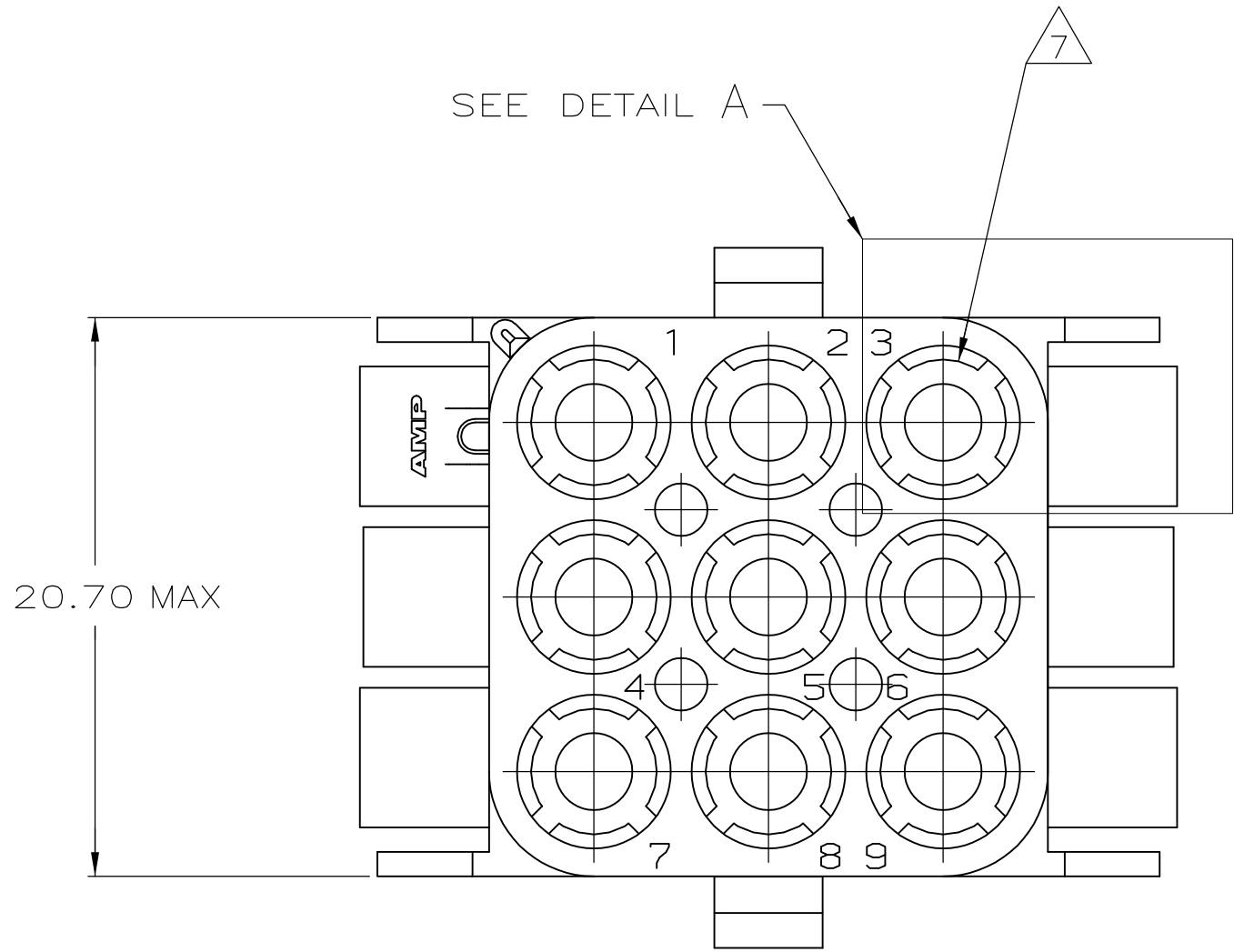

- MATES WITH APPROPRIATE UNIVERSAL MATE-N-LOK™ PLUG.
- RECOMMENDED PANEL THICKNESS 0.76 - 2.29.
- PANEL MUST BE PUNCHED SO THAT THE HOUSING ENTERS THE PANEL IN THE SAME DIRECTION AS THE PUNCH.
- OPTIONAL FOR KEYING HOUSING IN PANEL.
- CIRCUIT NUMBER 1 LOCATION.
- UNDERWRITER RECOGNIZED COMPONENT LOGO AND CSA CERTIFICATION LOGO TO BE LOCATED ONCE EACH SIDE ON SIDE OF HOUSING.
- FOUR RIBS EQUALLY SPACED, NO SPECIFIC ORIENTATION. NO RIBS OR SIX RIBS EQUALLY SPACED, NO SPECIFIC ORIENTATION, OPTIONAL.
- 150° C TEMPERATURE RATING FOR THIS HOUSING IS FOR SHORT TERM DURATION. MAX OPERATING TEMPERATURE REMAINS 125° C.
- PHOSPHOR BRONZE CONTACTS SHOULD ALWAYS BE USED WITH THIS HOUSING.
- DIMENSIONS SHOWN REPRESENT PRODUCT IN DRY, AS MOLDED CONDITION. ADDITIONAL 2% GROWTH DUE TO SUBSEQUENT MOISTURE ABSORPTION MAY OCCUR AND SHOULD BE ACCOUNTED FOR.

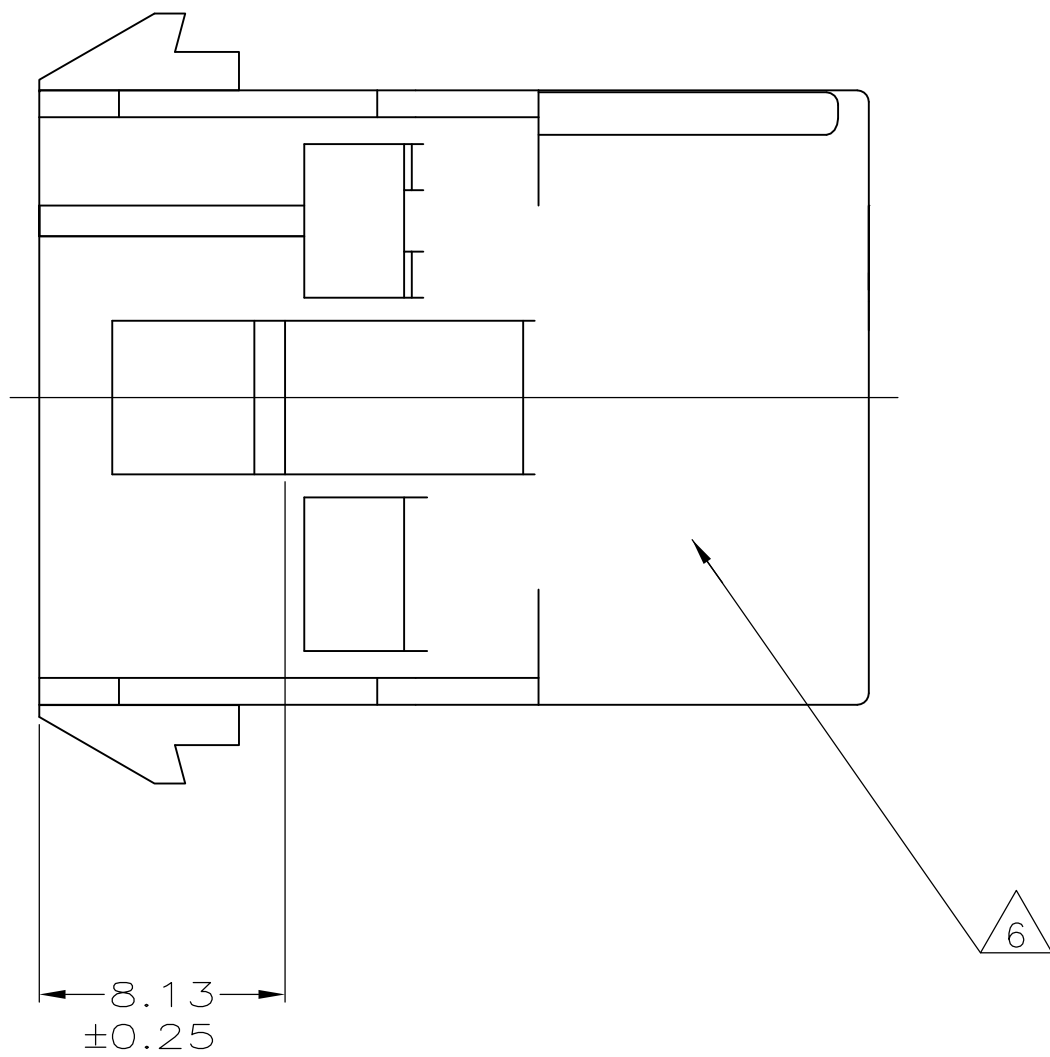
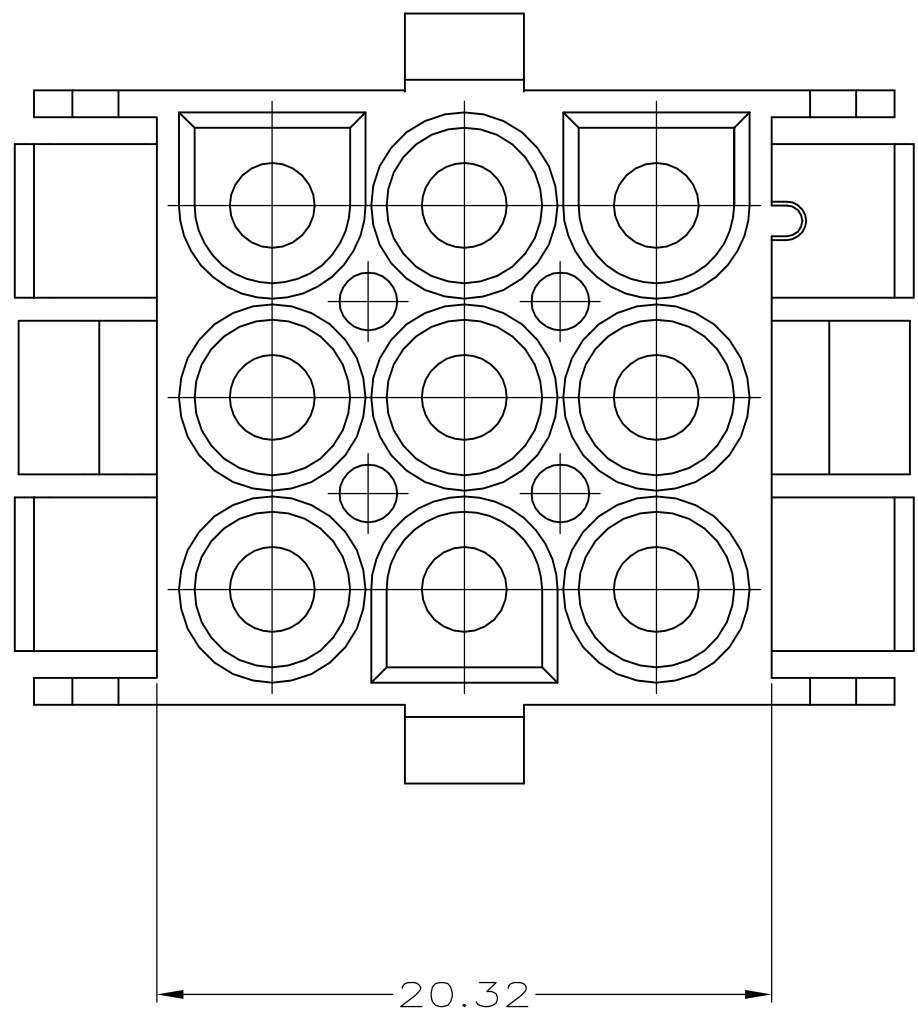
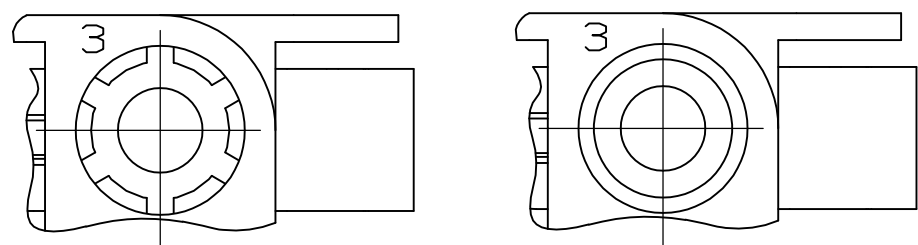

DETAIL A
OPTIONAL CONSTRUCTIONS

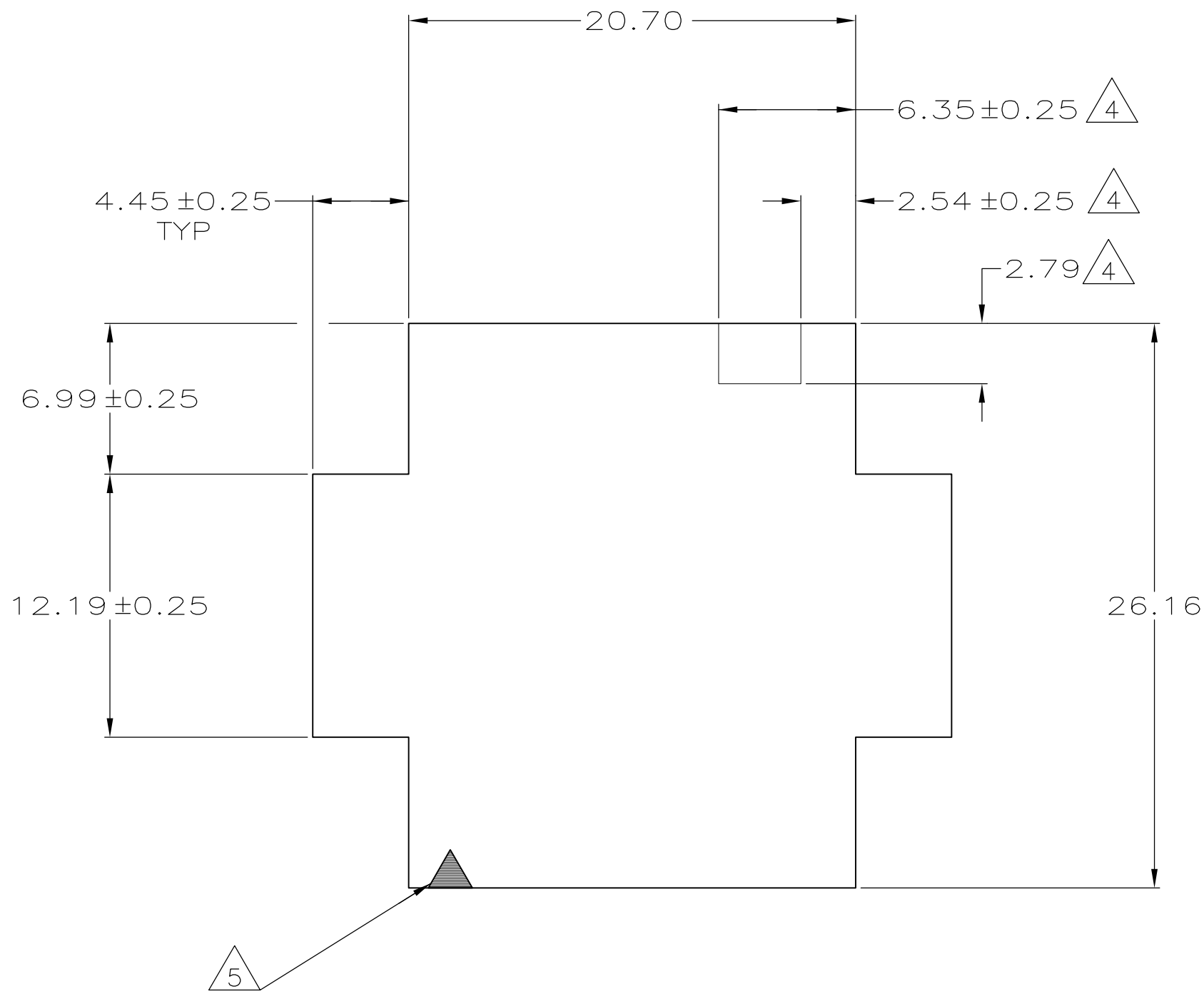
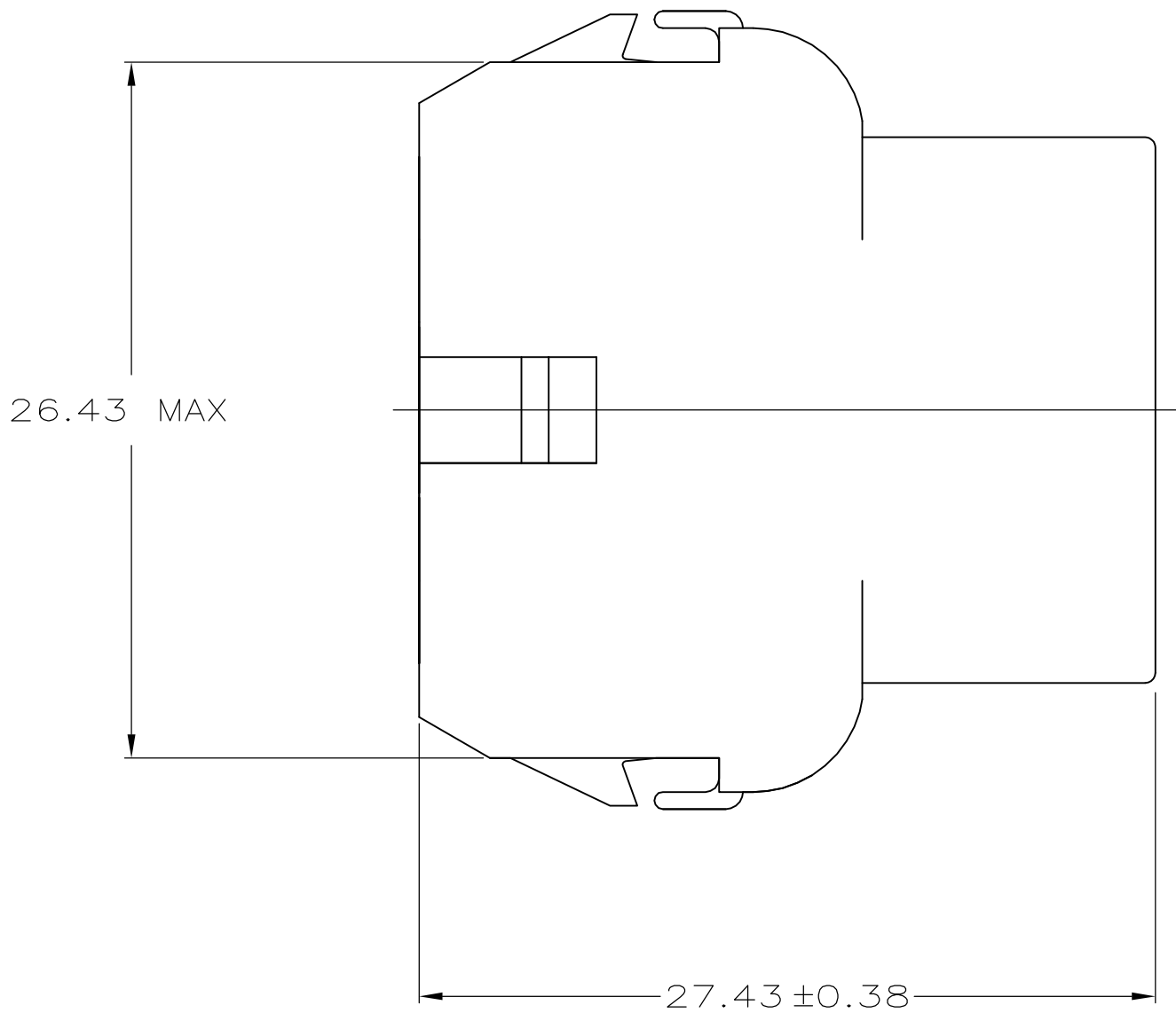

RECOMMENDED PANEL CUT OUT

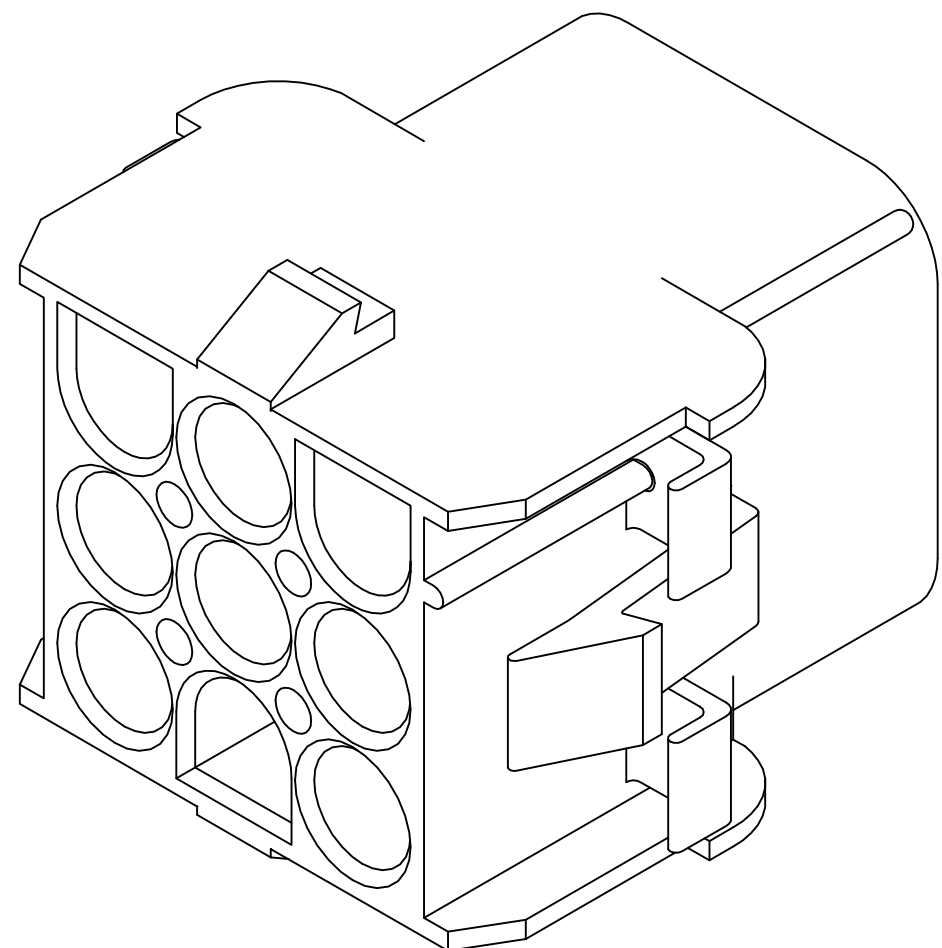

3-DIMENSIONAL MODEL
NTS

6.35	.250	-	-
4.45	.175	27.43	1.080
2.79	.110	26.43	1.041
2.54	.100	26.16	1.030
2.29	.090	20.70	.815
0.76	.030	20.32	.800
0.38	.015	12.19	.480
0.25	.010	8.13	.320
0.13	.005	6.99	.275
MM	IN	MM	IN
CONVERSION TABLE			

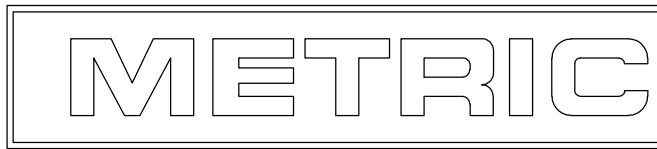

794538-1
PART NUMBER

THIS DRAWING IS A CONTROLLED DOCUMENT.		DWN K. WHITAKER 18-NOV-1998	TE Connectivity	CAP, 9 CIRCUIT, UNIVERSAL MATE-N-LOK™	
DIMENSIONS: mm		CHK R. SWING 18-NOV-1998			
TOLERANCES UNLESS OTHERWISE SPECIFIED:		APVD D. SELF 18-NOV-1998	NAME		RESTRICTED TO
0. PLC ± - 1. PLC ± - 2. PLC ± 0.13 3. PLC ± - 4. PLC ± - ± 0° 30'		PRODUCT SPEC	APPLICATION SPEC		SIZE
MATERIAL NYLON, UL 94V-2, BLACK		FINISH -	WEIGHT 0.000000		A1 00779
CUSTOMER DRAWING		SCALE 4:1		SHEET 1 OF 1	
				REV A2	

Mouser Electronics

Authorized Distributor

Click to View Pricing, Inventory, Delivery & Lifecycle Information:

[TE Connectivity:](#)

[794538-1](#)