

LOC	DIST	REVISIONS				
DF	D0	P	LTR	DESCRIPTION	DATE	DWN APVD
		F		UPDATE PER 0H2Y-0164-04	05-12-04	JDM MKS

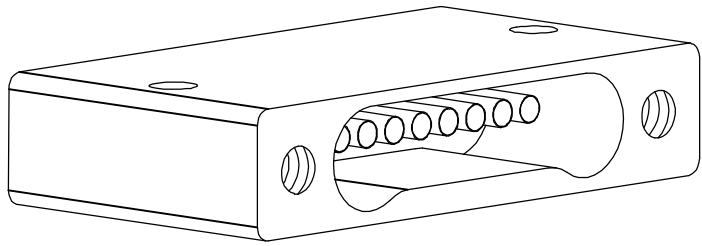
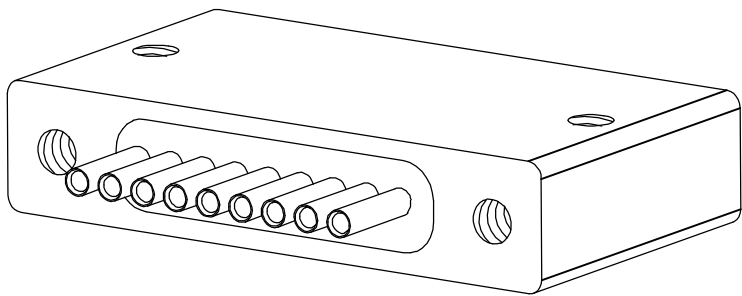
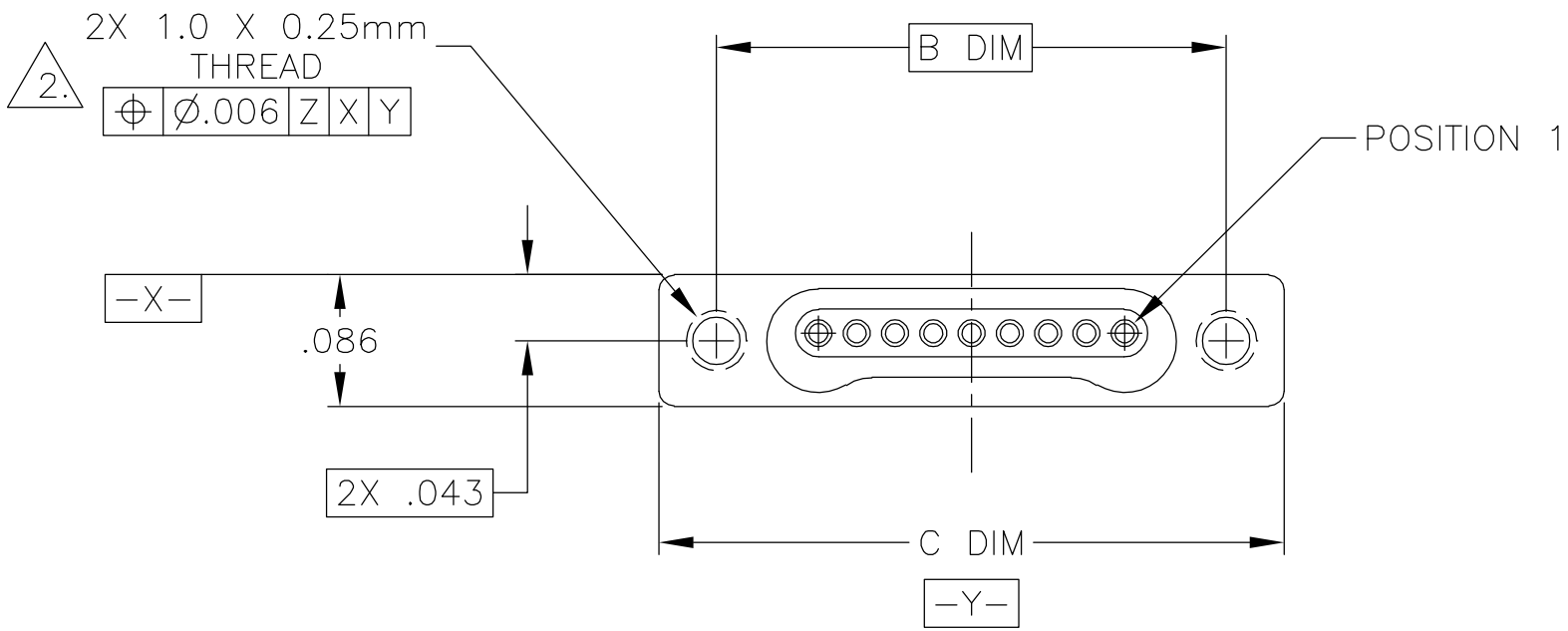
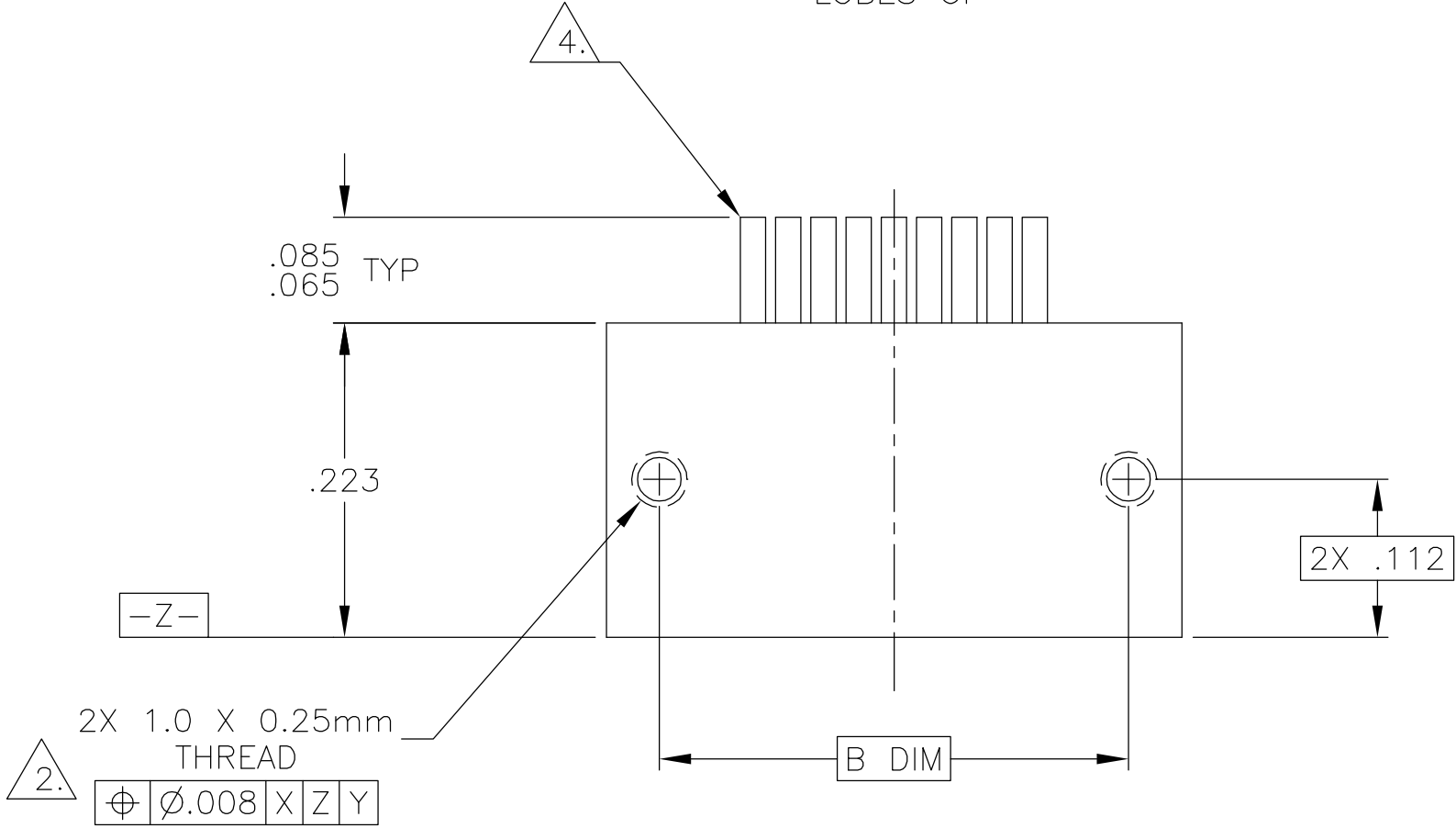
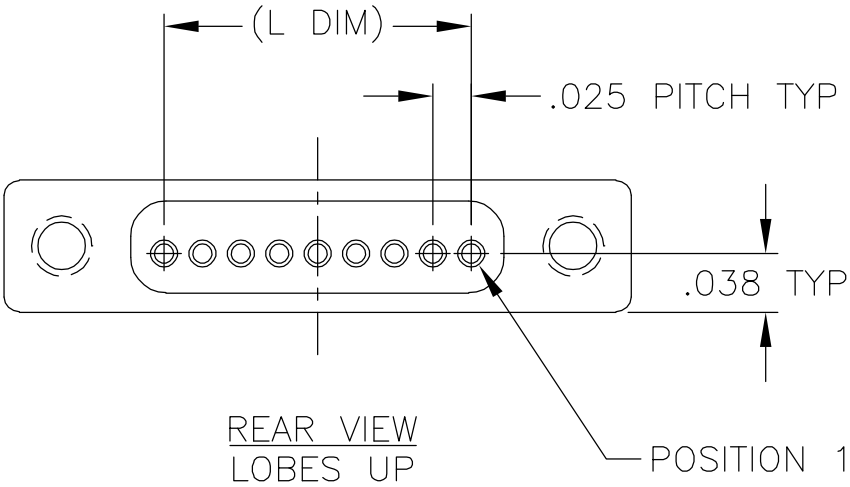

SIZE	B DIM	C DIM ±.0050	(L DIM)
05	.233	.3085	(.100)
09	.333	.4085	(.200)
15	.483	.5585	(.350)
25	.733	.8085	(.600)
37	1.033	1.1085	(.900)
51	1.383	1.4585	(1.250)

1. SHELL OPTIONS (TO BE SPECIFIED IN NANONICS PART NUMBER):
METAL: 6061-T6 ALUMINUM, ELECTROLESS NICKEL PLATED PER MIL-C-26074 (STANDARD) OR GOLD PLATED PER MIL-G-45204
303 STAINLESS STEEL, PASSIVATED PER SAE-AMS-QQ-P-35
INSULATOR MATERIAL FOR ALL METAL SHELLS IS LIQUID CRYSTAL POLYMER (LCP) PER MIL-M-24519 OR PER ASTM D5138
2. STANDARD 1.0 X 0.25mm JACKSCREW AND MOUNTING THREADS ARE SHOWN FOR REFERENCE ONLY AND MUST BE SPECIFIED IN THE NANONICS PART NUMBER WHEN REQUIRED. 1.2 X 0.25mm THREADS ALSO AVAILABLE.
3. MOUNTING HARDWARE IS AVAILABLE WITH THIS CONFIGURATION (NOT SHOWN). HARDWARE MUST BE SPECIFIED IN THE NANONICS PART NUMBER. CONSULT TYCO ELECTRONICS FOR DETAILS.
4. THIS CONFIGURATION TO HAVE SOLDER CUPS WHICH ARE TO BE TERMINATED BY THE CUSTOMER WITH 30 AWG STRANDED OR SMALLER WIRE. SOLDER CUPS ARE GOLD PLATED PER MIL-G-45204.
5. NANONICS TERMINATION CODE: 11500
6. THIS DRAWING PREVIOUSLY IDENTIFIED AS NANONICS 303-0018-XX

THIS DRAWING IS A CONTROLLED DOCUMENT.		DWN D. RYAN 02-12-99		tyco Electronics Tyco Electronics Corporation Harrisburg, PA 17105				
DIMENSIONS: INCHES		CHK M. STORRY 02-16-99		NAME RECEPTACLE ASSEMBLY, SINGLE ROW DUALLOBE, SOLDER CUP TERMINATION, PLASTIC OR METAL				
	TOLERANCES UNLESS OTHERWISE SPECIFIED:		APVD S. KAIN 07-10-00					
	PRODUCT SPEC							
	APPLICATION SPEC							
MATERIAL SEE NOTES	0 PLC ± - 1 PLC ± - 2 PLC ± .010 3 PLC ± .005 4 PLC ± - ANGLES ± 1'		—		SIZE	CAGE CODE	DRAWING NO	RESTRICTED TO
	FINISH		WEIGHT —		A2	00779	C=1589052	—
	SEE NOTES		CUSTOMER DRAWING		SCALE 8:1		SHEET 1 OF 1	REV F

Mouser Electronics

Authorized Distributor

Click to View Pricing, Inventory, Delivery & Lifecycle Information:

[TE Connectivity:](#)

[SSL01511500SCN](#)