

- 1 BERYLLIUM COPPER
- 2 PTFE
- 3 ZINC ALLOY
- 4 GOLD PLATED
- 5 NICKEL PLATED
- 6 BRASS
- 7 PACKAGING: 1 PC/BAG, 200 PCS/BOX, 1200 PCS/CARTON
- 8 TRAY PACKAGED

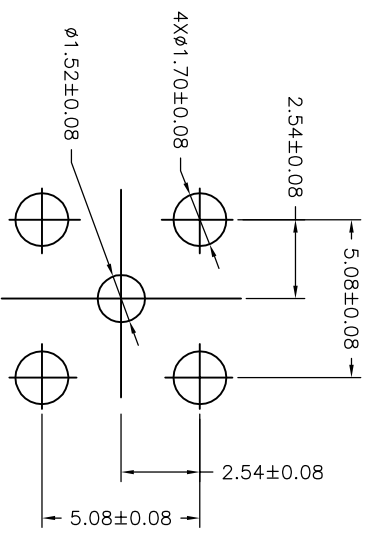

RECOMMENDED PCB LAYOUT

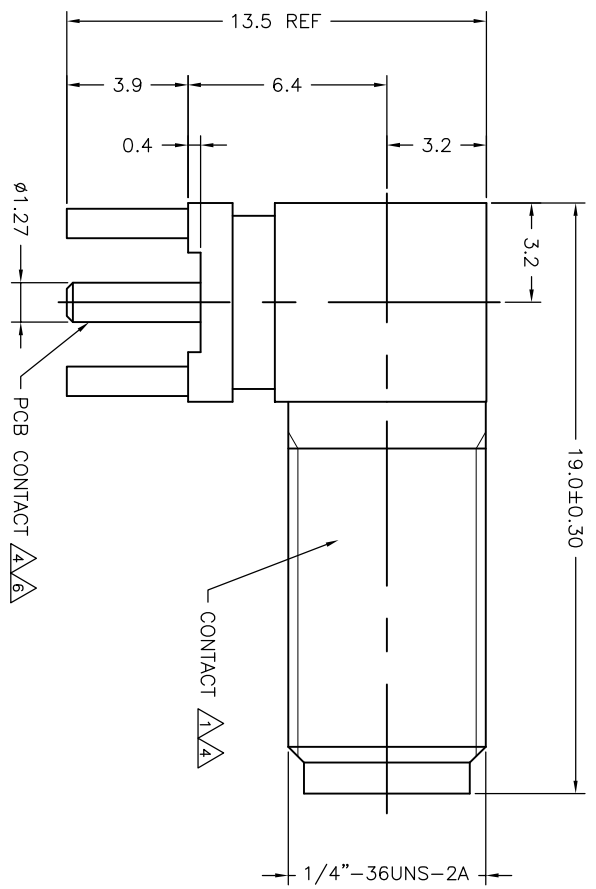
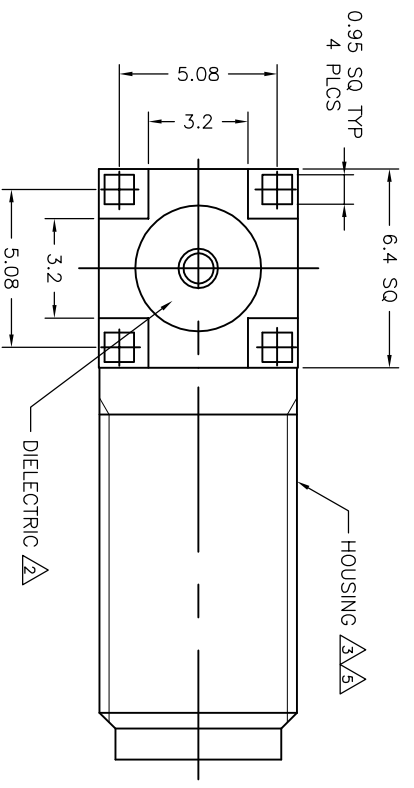

619540-2	8
619540-1	7
PART NUMBER	

ELECTRICAL	MECHANICAL	ENVIRONMENTAL
Frequency Range (GHz) DC to 12GHz	Recommended Mating force or Torque 8 In-lbs nominal	Temperature Rating -65°C TO +85°C
Voltage Rating (Peak) @ Sea Level 335 VAC RMS	Mating cycles 500	
Insulation Resistance (MIN.) 5000 M ohms	Note: Use of active flux may be needed to improve solder wetting.	
Contact Resistance (Milliohms MAX) Center Contact 3.0 Outer Contact 2.0		

THIS DRAWING IS A CONTROLLED DOCUMENT.		APVD		NAME	
DMN	RTA ZUO	11 JULY 2012	STE TE Connectivity		
CHK	BING LIU	11 JULY 2012	SMA JACK R/A PCB END		
APVD	MARTIN YE	11 JULY 2012	SIZE		
PRODUCT SPEC	108-32039		A300779		
APPLICATION SPEC			PAGE CODE		
WEIGHT	0.000000		DRAWING NO		
CUSTOMER DRAWING		SCALE		SHEET	
		6:1		1 of 1	
				REV	
				A1	