

RATINGS:

CURRENT: 10 AMPS
BREAKDOWN VOLTAGE: 5700 V RMS
CONTACT RESISTANCE: 0.004 OHMS MAX.
CONTACT-TO-PANEL C: 2 pF NOMINAL

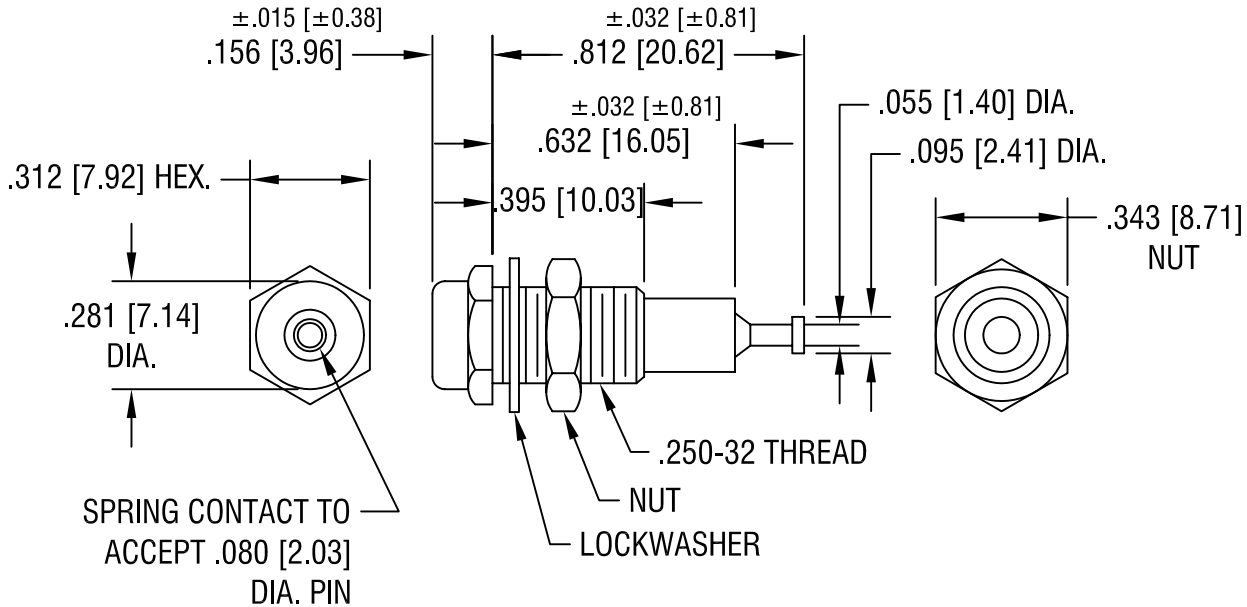

NOTES:

1. CONTACT:

MAT'L - BRASS BODY WITH WRAP
AROUND BERYLLIUM COPPER
GOLD PLATE

BODY:

MAT'L - NYLON 6/6 PER ASTM D4066

2. SHELL, NUT/WASHER:

BRASS, NICKEL PLATE.
HARDWARE SUPPLIED
UNASSEMBLED.

PART NO.	COLOR
6012	WHITE
6013	RED
6014	BLACK
6015	GREEN
6016	YELLOW
6017	BLUE

2.5.03 CHANGE AS PER ECN 03-011 A

DATE DESCRIPTION REV.

KEYSTONE ELECTRONICS CORP.			
ASTORIA, N.Y. 11105-2017			
PART NAME			
INSULATED METAL-CLAD TIP JACK			
MATERIAL			
AS NOTED			
FINISH		DRN BY	DATE
AS NOTED		BOONE	12.7.82
		APPD	SCALE
		LN	2X
TOLERANCES	INCH	MM	CODE
DECIMAL	± .005	[± 0.15]	C/M
ANGULAR	± 1°		
UNLESS OTHERWISE SPECIFIED			DWG NO.
			6012-6017

Mouser Electronics

Authorized Distributor

Click to View Pricing, Inventory, Delivery & Lifecycle Information:

[Keystone Electronics:](#)

[6014](#)