

Customer Information Sheet

DRAWING No.: M50-311XX42 SHEET 2 OF 2 IF IN DOUBT - ASK © NOT TO SCALE THIRD ANGLE PROJECTION ALL DIMENSIONS IN mm

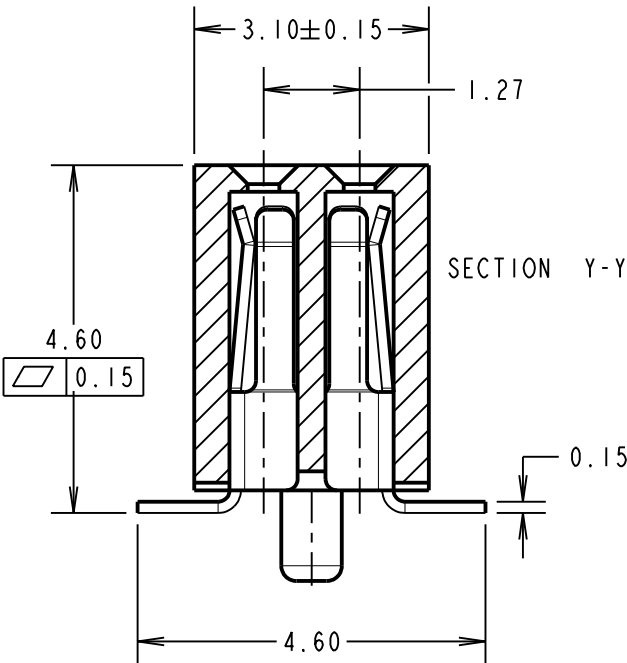
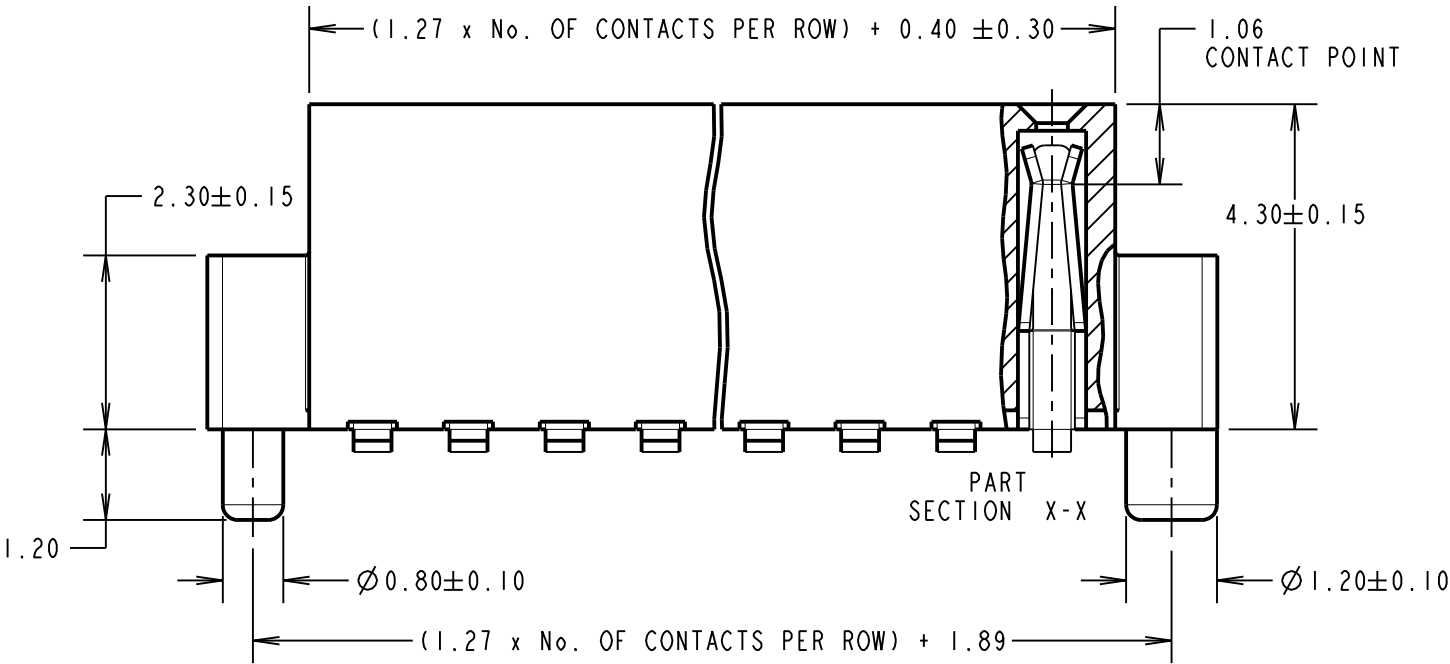
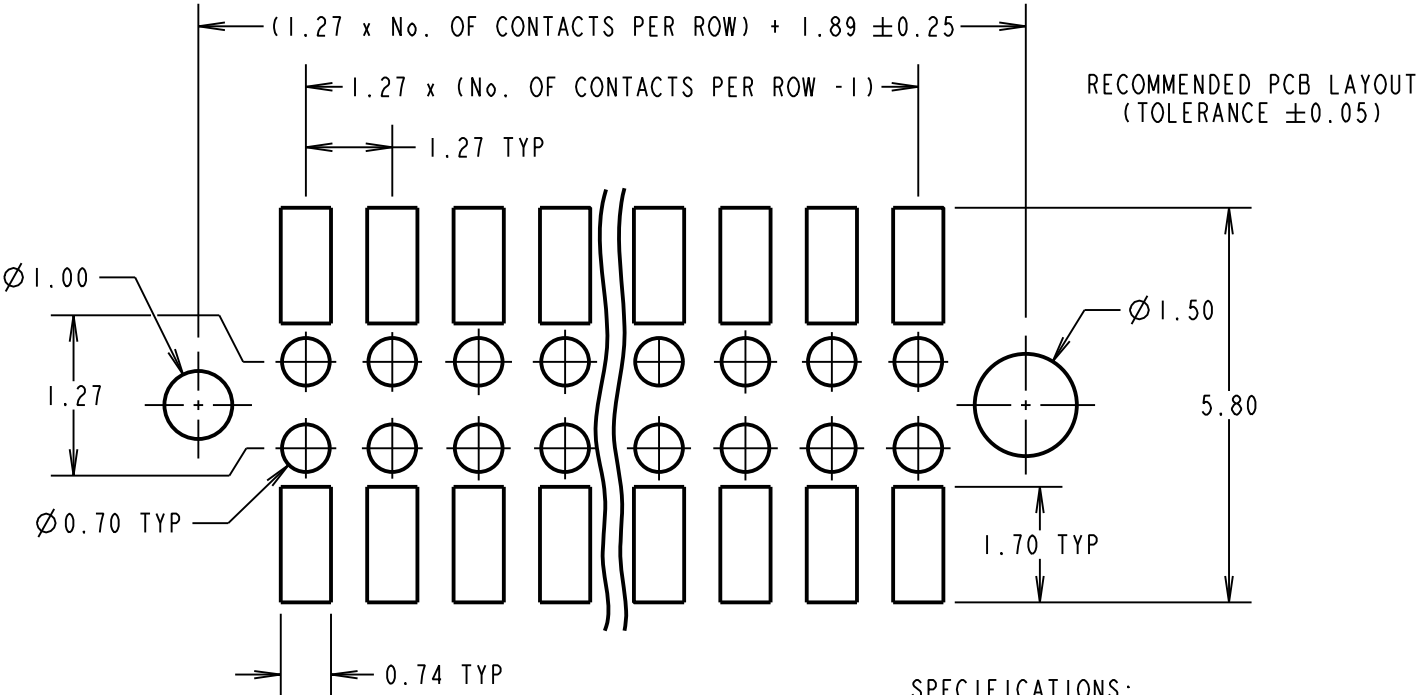
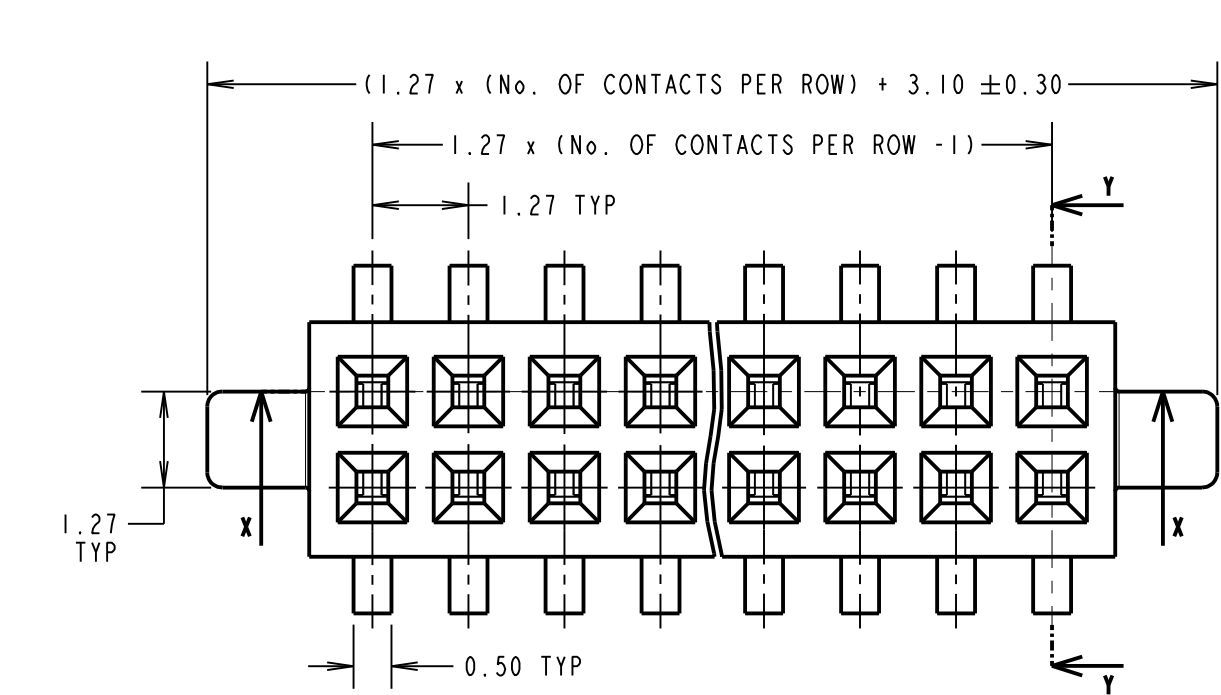

SPECIFICATIONS:
MATERIAL:
MOULDING = PA9T, UL94V-0, BLACK
CONTACT = PHOSPHOR BRONZE
FINISH:
CONTACT = NICKEL ALL OVER,
GOLD FLASH ON CONTACT AREA,
100% TIN ON TAILS
ELECTRICAL:
CURRENT RATING = 1A
VOLTAGE PROOF = 500V AC FOR ONE MINUTE
CONTACT RESISTANCE = $20\text{m}\Omega$ MAX INITIAL,
 $30\text{m}\Omega$ MAX AFTER CONDITIONING
INSULATION RESISTANCE = $1,000\text{M}\Omega$ MIN
VOLTAGE PROOF = 500V AC/DC
MECHANICAL:
DURABILITY = 300 CYCLES MIN
INSERTION FORCE = 0.98N MAX PER CONTACT
WITHDRAWAL FORCE = 0.12N MIN PER CONTACT
ENVIRONMENTAL:
OPERATING TEMPERATURE = -40°C TO $+105^{\circ}\text{C}$
PACKING:
TUBE
FOR COMPLETE SPECIFICATION, SEE COMPONENT
SPECIFICATION C029XX (LATEST ISSUE)

Active products:
M50-3110542
M50-3111042
M50-3112542
M50-3113042

ORDER CODE:
M50-311XX42
No. OF CONTACTS PER ROW:
03 TO 50
FINISH:
GOLD FLASH ON CONTACTS,
100 %TIN ON TAIL

OBSOLETE
All other size/finish
combinations not listed

HARWIN
www.harwin.com
technical@harwin.com

THIS DRAWING AND ANY
INFORMATION OR DESCRIPTIVE
MATTER SET OUT HEREON ARE
CONFIDENTIAL AND COPYRIGHT
PROPERTY OF THE HARWIN
GROUP AND MUST NOT BE
DISCLOSED, LOANED, COPIED
OR USED FOR MANUFACTURING,
TENDERING OR FOR ANY
OTHER PURPOSE WITHOUT
THEIR WRITTEN PERMISSION.

TOLERANCES
X = $\pm 1\text{mm}$
X.X = $\pm 0.50\text{mm}$
X.XX = $\pm 0.10\text{mm}$
X.XXX = $\pm 0.01\text{mm}$
ANGLES = $\pm 5^{\circ}$
UNLESS STATED

MATERIAL:
SEE ABOVE
FINISH: SEE ABOVE
S/AREA: mm²

TITLE:
1.27mm PITCH DIL VERTICAL
SMT SOCKET ASSY WITH POSTS
DRAWING NUMBER:
M50-311XX42
SHT 2 OF 2

NOTES:
1. ALL TOLERANCES ARE ± 0.25
UNLESS OTHERWISE STATED.

SB	9	31.05.16	13323
NAME	ISS.	DATE	C/NOT
APPROVED:		S.BENNETT	
CHECKED:		M.PERREN	
DRAWN:		S.BENNETT	
CUSTOMER REF.:			
ASSEMBLY DRG:			

Mouser Electronics

Authorized Distributor

Click to View Pricing, Inventory, Delivery & Lifecycle Information:

Harwin:

[M50-3113042](#) [M50-3111042](#) [M50-3110542](#) [M50-3110642](#) [M50-3110742](#) [M50-3110842](#) [M50-3110942](#) [M50-3111142](#) [M50-3111242](#) [M50-3111542](#) [M50-3112042](#) [M50-3112542](#) [M50-3113542](#) [M50-3114042](#) [M50-3114542](#) [M50-3115042](#)