

THIS DRAWING IS UNPUBLISHED. RELEASED FOR PUBLICATION, 19 .
 © COPYRIGHT 19 BY AMP INCORPORATED. ALL INTERNATIONAL RIGHTS RESERVED.

LOC CH DIST 11 P F

REVISIONS				
ZONE	LTR	DESCRIPTION	DATE	APPD
	0	RELEASED FOR PRODUCTION	07/JAN/97	RNP
	A	EC OB20-1083-98	20/AUG/98	RNP
	B	EC OB20-0530-99	29/APR/99	RNP

- 1 MATERIAL- BODY, COPPER ALLOY
BAND, BeCu
- 2 FINISH-BODY AND BAND, .0002 IN. SILVER
OVER .00004 IN. NICKEL.
- 3. WIRE BARREL WILL ACCEPT 12-14 AWG WIRE.
- 4. MATES WITH AMP PART NUMBER 194212-1.
- 5. ALL DIMENSIONS ARE REFERENCE ONLY.

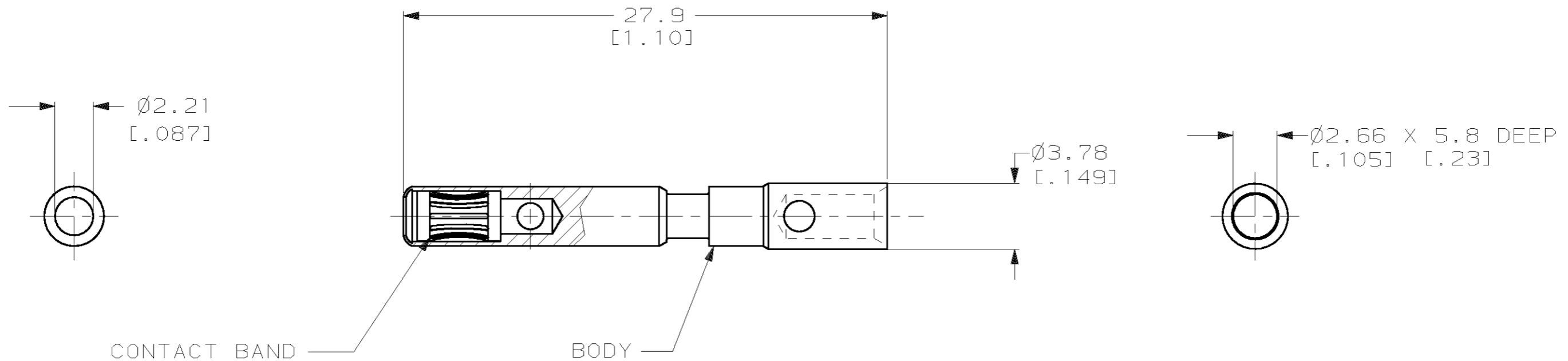

194213-1

FINISH PART NO

DO NOT SCALE PRINT. UNLESS SPECIFIED DIMENSIONS IN mm [INCHES] TOLERANCES ON: 2 PLC DEC ± 0.5 [.02] 3 PLC DEC ± 0.25 [.010] ANGLES ± -	DR 07/JAN/97 R N POLK
MATERIAL 1	CHK -
FINISH 2	APPD -
	APPD -
	PRODUCT SPEC -
	APPLICATION SPEC -
	WEIGHT -

AMP AMP Incorporated
Harrisburg, PA 17105-3608

NAME
SOCKET ASSY, 2mm, 12-14 AWG
LUBRICATED, MATE-N-LOK II

SIZE B	CAGE CODE 00779	DRAWING NO C-194213
SCALE	SHEET 1 OF 1	

THIS DRAWING IS A CONTROLLED DOCUMENT FOR AMP INCORPORATED. IT IS SUBJECT TO CHANGE AND THE CONTROLLING ENGINEERING ORGANIZATION SHOULD BE CONTACTED FOR THE LATEST REVISION.

Mouser Electronics

Authorized Distributor

Click to View Pricing, Inventory, Delivery & Lifecycle Information:

[TE Connectivity:](#)

[194213-1](#)