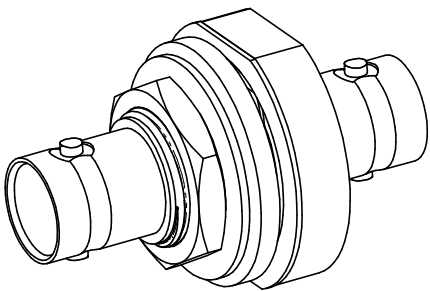
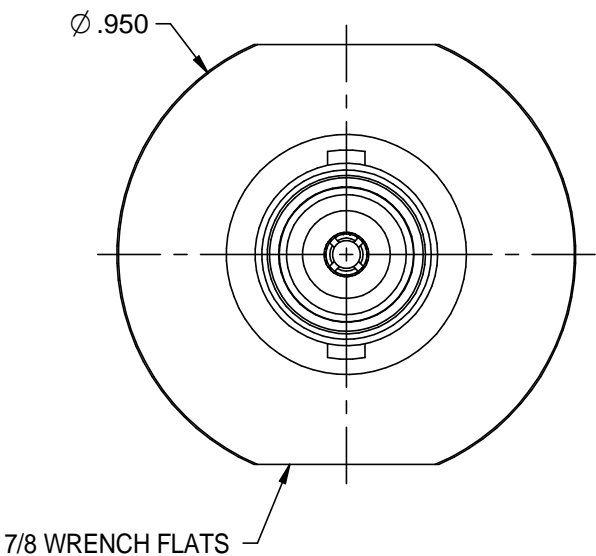
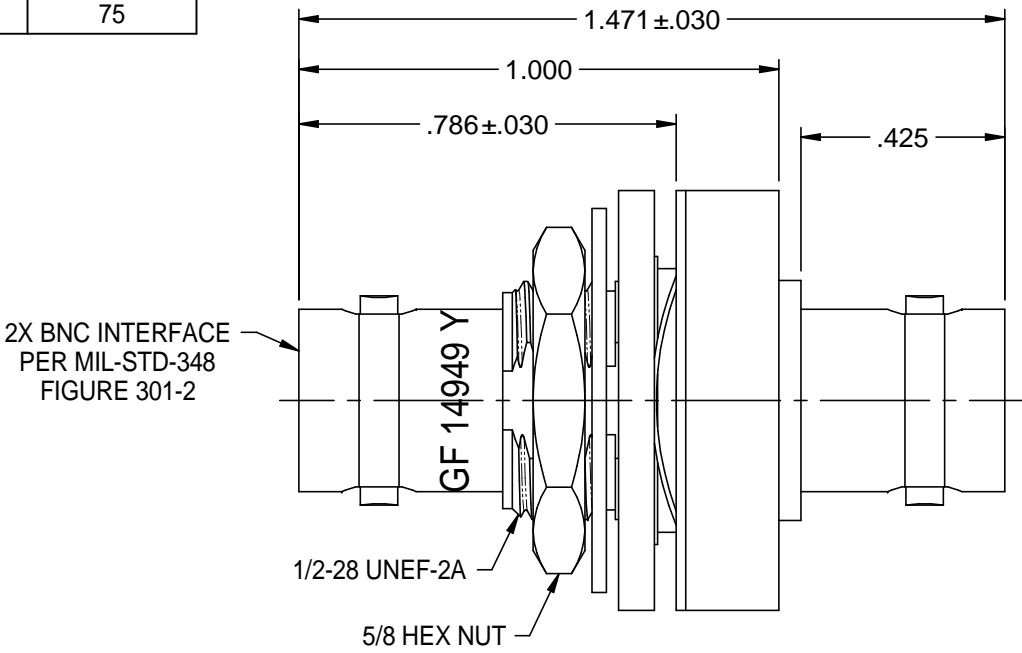

TABLE 1	
TROMPETER NUMBER	IMPEDANCE (OHMS)
BJ28GF	50
UBJ28GF	75



NOTES: UNLESS OTHERWISE SPECIFIED.

1. MATERIAL & FINISH:
 - 1.1 BODY: NICKEL PLATED BRASS
 - 1.2 DIELECTRIC: PTFE (TEFLON)
 - 1.3 CENTER CONACT: GOLD PLATED BERYLLIUM COPPER
 - 1.4 INSULATORS: NYLON
 - 1.5 MOUNTING HARDWARE: NICKEL PLATED COPPER ALLOY
2. ELECTRICAL: FILTER FUNCTION BETWEEN SHIELD AND CHASSIS.
 - 2.1 VOLTAGE RATING: 200 VDC AT SEA LEVEL AND 25°C
 - 2.2 CAPACITANCE: 4nFD MIN, 10nFD MAX AT 1 KHz AND 25°C
 - 2.3 DISSIPATION FACTOR: 5% MAX AT 1 KHz AND 25°C
 - 2.4 DILECTRIC WITHSTANDING VOLTAGE: 500 VDC AT SEA LEVEL AND 25°C FOR 1 MINUTE
 - 2.5 INSULATION RESISTANCE: 1 G- OHM MIN AT 200 VDC AND 25°C
 - 2.6 RF INSERTION LOSS (FILITER PERFORMANCE): WHEN MEASURED PER MIL-STD-220 ON A SWEEP FREQUENCY RESPONSE BASIS (WITH 1/2 AMP DRIVEN CURRENT IN 50 & 75 OHM) INSERTION LOSS SHALL BE AS FOLLOWS: SEE TABLE 2
3. PANEL THICKNESS (MAX): .094
4. PANEL NUT TORQUE (MAX): 25 IN LBS

TABLE 2	
FREQUENCY (MHz)	ATTENUATION (MIN dB @ 25°C)
1	1
3	2
10	8
30	16
100	30
300	30
1000	30

<p>This PROPRIETARY Document is property of Cinch Connectivity Solutions. It is confidential in nature, non-transferable, and issued with the clear understanding that it is not traced or copied without permission and is returnable upon demand.</p> <p>INTERPRET DRAWING IN ACCORDANCE WITH ASME Y14.5-2009.</p>	<p>3RD ANGLE PROJECTION</p> <p>RoHS2 <input checked="" type="checkbox"/> 2011/65/EU</p> <p>UNLESS OTHERWISE SPECIFIED UNITS: INCH</p> <p>.XX ±.02 .XXX ±.005 ANGLES ±2°</p>	<p>TROMPETER</p> <p>Title: BNC COAXIAL BLK'D MT FEED THRU JACK WITH GROUND FILTERING CAPACITOR</p>		
		<p>Model No. U/BJ28GF</p>		
		Size A	DO NOT SCALE DRAWING	Date: 10/6/2014
		Sheet 1 of 1		

Mouser Electronics

Authorized Distributor

Click to View Pricing, Inventory, Delivery & Lifecycle Information:

[Cinch Connectivity Solutions:](#)

[UBJ28GF](#)