

ALR-1920-120

Multi Purpose LCD Controller Board

Key Features :

- > Supports 120Hz panels up to 1920x1200 resolution
- > HDMI and DisplayPort input signals
- > Advanced image processing
- > Designed for commercial display systems

The ALR-1920-120 is a compact and easy to work with controller solution for 120Hz panels up to 1920x1200 resolution. A comprehensive range of features and control options make this ideal for a wide range of commercial display systems.

Panel Connectivity

TFT: 1920x1200 (120Hz or 60Hz)
1920x1080 (120Hz or 60Hz)
1280x1024 (60Hz)

Input

HDMI 1.3: 60Hz at WUXGA, UXGA, SXGA, WXGA, XGA, SVGA, VGA, 1080p, 1080i, 720p, 576p, 480p

DisplayPort 1.1a: 60Hz at WUXGA, UXGA, SXGA, WXGA, XGA, SVGA, VGA 1080p, 1080i, 720p, 576p, 480p

Reliability

Calculated Mean Time Between Failure (MTBF): In excess of 200,000 hours.
Warranty: 3 years.

Custom Engineering Services

Custom input timing, panel timing, splash screen, OSD Menu, conformal coatings, layouts etc

Features

Colors:	Up to 8 bit per color, ie 16.7 million colors.
Functions:	On Screen Display (OSD) menu
Function Controls:	External buttons, IR Remote, RS-232, DDC/CI.
Image Scaling:	Up / Down* scaling to fit input to panel resolution.
Image Control:	Brightness, Contrast, Sharpness, Color temperature, Gamma.
Other Features:	Auto source seek, OSD timeout, OSD position, OSD menu rotation, OSD transparency, select input source.
Dimensions:	127mm x 91.44mm x 17.3mm
Form Factor:	DV standard & mounting holes.
Power Requirements:	+12V/+24VDC ±5%, 4W (controller only)
Panel Power:	Supports 3.3V, 5V, 12V & 18V panels.
Panel Signal:	LVDS (VESA & JEIDA compliant).
Inverter Support:	DPMS, PWM
Plug & Play:	DDC 1,2/b compatible
Controller Status Indicator:	Dual color LED support

* To 50% of the input signal resolution compared to the panel resolution

ALR-1920-120

Multi Purpose LCD Controller Board

Mechanical Drawing

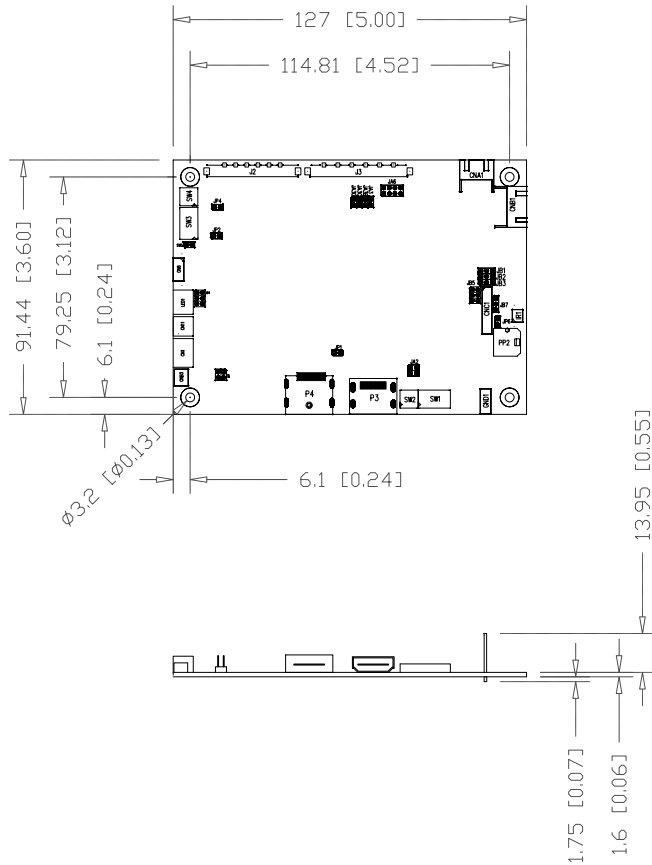

Connector Definitions

- CN1** Audio output (Stereo) with amplification from HDMI / Display port
- CN8** RS-232 serial control
- CN11** SPDIF Audio output
- CNA1** Auxiliary power output
- CNB1** Backlight inverter
- CNB3** Panel backlight control
- CNC1** OSD controls
- IR1** Infra-Red sensor connector
- LED1** Controller status LED (Optional)
- J2** LVDS panel signal output 1
- J3** LVDS panel signal output 2
- P3** HDMI input
- P4** Display port input
- PP2** Power input

Ordering Options

ALR-1920-120 Controller Board	P/N 41731003X-3
Digital OSD button	Kit 67110-3
Horizontal membrane	Kit 67134-3
Vertical membrane	Kit 67135-3
Inverter Interface board	P/N 416040010-3
OSD switch mount cable, 150mm	P/N 426122200-3
IR Remote Control	P/N 559000106-3

3D Drawings (SLDPRT)

Save time and effort for your system volumetric analysis design. Includes jpg file previews.

Available Resources

- > Instruction Manual
 - > Revision Control Documentation**
 - > Firmware Upgrade Manual**
 - > Mechanical Drawing
- ** Available on Request

Controller Solution Generator
<http://www.digitalview.com/csg>

EUROPE

The Lake House, Knebworth Park, Herts, SG3 6PY, UK
 t : +44 (0) 20-7631-2150

ASIA

16th Floor Millennium City 3, 370 Kwun Tong Road, Kwun Tong, Hong Kong
 t : (852) 2861-3615

USA

18440 Technology Drive, Morgan Hill, CA 95037, USA
 t : +1 (408) 782-7773

Mouser Electronics

Authorized Distributor

Click to View Pricing, Inventory, Delivery & Lifecycle Information:

[Digital View:](#)

[426122200-3](#)