

■ Features :

- Protections:Short circuit/Over load /Over voltage/Polarity
- Cooling by free air convection
- 100% full load burn-in test
- Low cost
- High reliability

SPECIFICATION



MODEL		PSD-15A-05	PSD-15B-05	PSD-15C-05	PSD-15A-12	PSD-15B-12	PSD-15C-12	PSD-15A-24	PSD-15B-24	PSD-15C-24
OUTPUT	DC VOLTAGE	5V			12V			24V		
	RATED CURRENT	3A			1.25A			0.6A		
	CURRENT RANGE	0 ~ 3A			0 ~ 1.25A			0 ~ 0.6A		
	RATED POWER	15W			15W			14.4W		
	RIPPLE & NOISE (max.) <small>Note.2</small>	50mVp-p			100mVp-p			100mVp-p		
	VOLTAGE TOLERANCE <small>Note.3</small>	±2.0%			±2.0%			±2.0%		
	LINE REGULATION	±1.0%			±1.0%			±0.5%		
	LOAD REGULATION	±1.0%			±1.0%			±0.5%		
SETUP, RISE, HOLD UP TIME		2.5s, 25ms, ----/12VDC/24VDC/48VDC at full load								
INPUT	VOLTAGE RANGE	A: 9.2 ~18VDC (12VDC) B:18 ~ 36VDC (24VDC) C:36~72VDC(48VDC)								
	EFFICIENCY(Typ.)	74%	78%	78%	67%	78%	78%	72%	78%	79%
	DC CURRENT(Typ.)	1.9A/12VDC 0.9A/24VDC 0.45A/48VDC								
PROTECTION	OVER LOAD	105% -150% rated output power Protection type : Hiccup mode ,recovery automatically after fault condition is removed								
	OVER VOLTAGE	5.75 ~ 6.75V			13.8~ 16.2V			27.6 ~ 32.4V		
	ENVIRONMENT	WORKING TEMP.	-10 ~ +60℃ (Refer to output load derating curve)							
WORKING HUMIDITY		20 ~ 95% RH non-condensing								
STORAGE TEMP., HUMIDITY		-20 ~ +85℃, 10 ~ 95% RH								
TEMP. COEFFICIENT		±0.05%/℃ (0 ~ 50℃)								
VIBRATION		10 ~ 500Hz, 2G 10min./1cycle, Period for 60min.each along X, Y, Z axes								
SAFETY & EMC	WITHSTAND VOLTAGE	I/P-O/P:2KVAC								
	ISOLATION RESISTANCE	I/P-O/P:100M Ohms/500VDC								
	EMI CONDUCTION&RADIATION	Compliance to EN55022(CISPR22) CLASS B								
	EMS IMMUNITY	Compliance to EN61000-4-2, 3, 4, 6, 8 EN55024, EN61000-6-1 Light industry level, criteria A								
OTHERS	DIMENSION	94*49*25mm (L*W*H)								
	PACKING	81mg;120pcs/10.72Kg								
NOTE	1.All parameters NOT specially mentioned are measured at normal input,rated load and 25℃ of ambient temperature. 2.Ripple & noise are measured at 20 MHz of bandwidth by using a 12inch twisted pair-wire terminated with a 0.1uf & 47uf capacitor. 3.Tolerance:includes set up tolerance,line regulation and load regulation.									

Mechanical Specification

Unit:mm

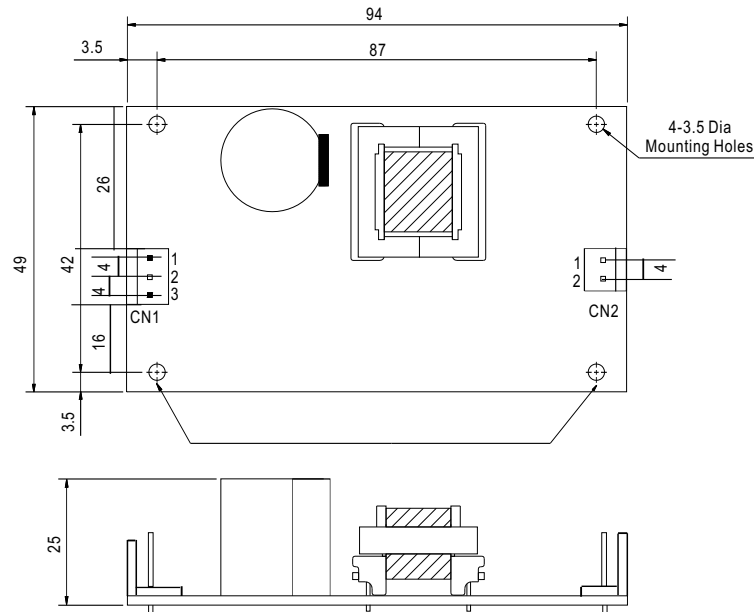

DC Input Connector (CN1) : JST B3P-VH or equivalent

Pin No.	Assignment	Mating Housing	Terminal
1	-V	JST VHR or equivalent	JST SVH-21T-P1.1 or equivalent
2	NC		
3	+V		

DC Output Connector (CN2) : JST B2P-VH or equivalent

Pin No.	Assignment	Mating Housing	Terminal
1	-V	JST VHR or equivalent	JST SVH-21T-P1.1 or equivalent
2	+V		

Block Diagram

fosc : 100KHz

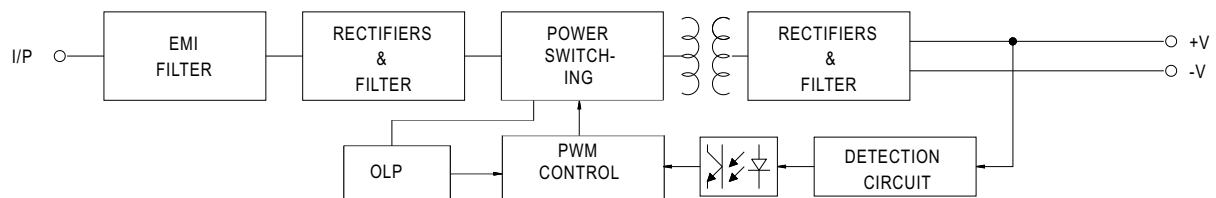

Output Derating

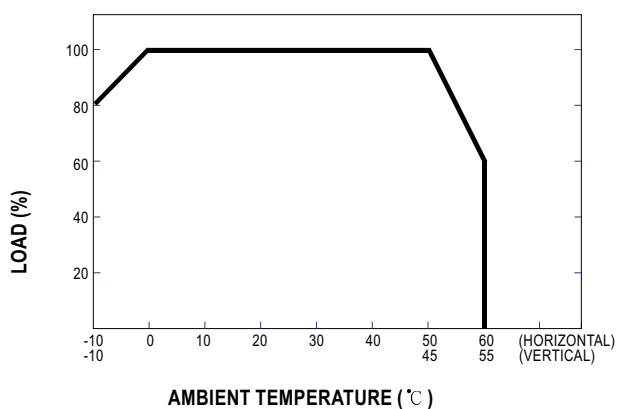

Mouser Electronics

Authorized Distributor

Click to View Pricing, Inventory, Delivery & Lifecycle Information:

MEAN WELL:

[PSD-15A-05](#) [PSD-15B-12](#) [PSD-15A-24](#) [PSD-15B-24](#) [PSD-15A-12](#) [PSD-15B-05](#)