

THIS DOCUMENT IS THE PROPERTY OF
KEYSTONE ELECTRONICS CORP. AND
SHALL NOT BE REPRODUCED, DISTRIBUTED
OR USED AS A BASIS FOR MANUFACTURE
WITHOUT PRIOR WRITTEN PERMISSION
FROM KEYSTONE ELECTRONICS CORP.

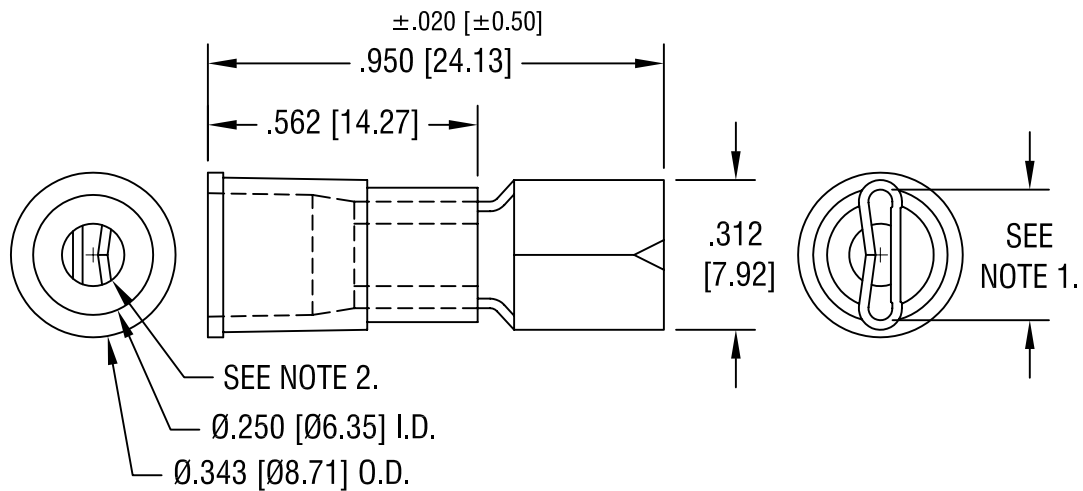

NOTES:

1. ACCEPTS MALE TAB,
.250 [6.35] W. x .032 [0.81] TH'K
2. ACCEPTS WIRE RANGE 12-10 AWG
MAXIMUM INSULATION DIA. .250 [6.35]
3. BODY: MAT'L: BRASS, TIN PLATE
INSULATION: MAT'L: VINYL, CODED YELLOW

KEYSTONE ELECTRONICS CORP.

ASTORIA, N.Y. 11105-2017

PART NAME

SOLDERLESS TERMINAL, FEMALE

MATERIAL

AS NOTED

FINISH

AS NOTED

DRN BY

BOONE

DATE

7.10.03

APP'D

LN

SCALE

2.5X

TOLERANCES

INCH [MM]

DECIMAL ±.010 [±0.25]

ANGULAR ± 1°

UNLESS OTHERWISE SPECIFIED

CODE

C/M

DWG NO.

8280

DATE

DESCRIPTION

REV.

Mouser Electronics

Authorized Distributor

Click to View Pricing, Inventory, Delivery & Lifecycle Information:

[Keystone Electronics:](#)

[8280](#)