

LOC	DIST	REVISIONS					
AF	50	P	LTR	DESCRIPTION	DATE	DWN	APVD
			M10	REVISED PER ECR-09-027342	18DEC2009	HMR	PD
			M11	REVISED PER ECO-14-015023	08OCT2014	MD	DL

1. FOR USE WITH TYCO ELECTRONICS 250 SERIES LOW INSERTION RECEPTACLES
2. ALL SUGGESTED P.C. BOARD CUTOUTS ARE SHOWN FROM THE COMPONENT SIDE.
- 4 V-0 LETTERS THIS LOCATION FOR -7 THRU -12 PARTS ONLY.
- 5 BLUE COLOR MAY APPEAR GRAY
6. 521498-7: BLUE PARTS MAY APPEAR MEDIUM BLUE TO LIGHT BLUE TO LIGHT GRAY IN COLOR AND MAY ALSO EXHIBIT A MARBLING EFFECT.
7. 521498-8: YELLOW PARTS MAY APPEAR LIGHT YELLOW TO LIGHT BEIGE IN COLOR AND MAY ALSO EXHIBIT A MARBLING EFFECT.
8. 1-521498-0: GREEN PARTS MAY APPEAR MEDIUM GREEN TO VERY LIGHT GREEN (MINT) IN COLOR AND MAY ALSO EXHIBIT A MARBLING EFFECT.
9. 1-521498-2: RED PARTS MAY APPEAR DARK PINK, MEDIUM PINK, OR LIGHT PINK IN COLOR AND MAY ALSO EXHIBIT A MARBLING EFFECT.

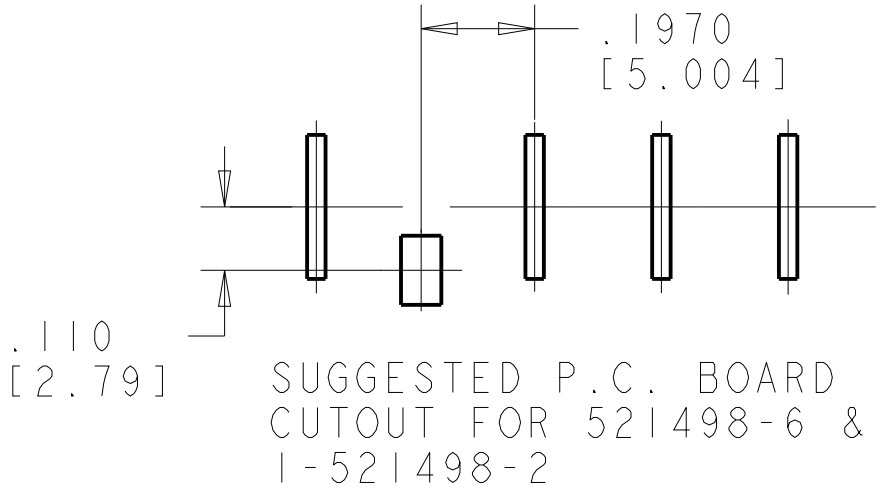
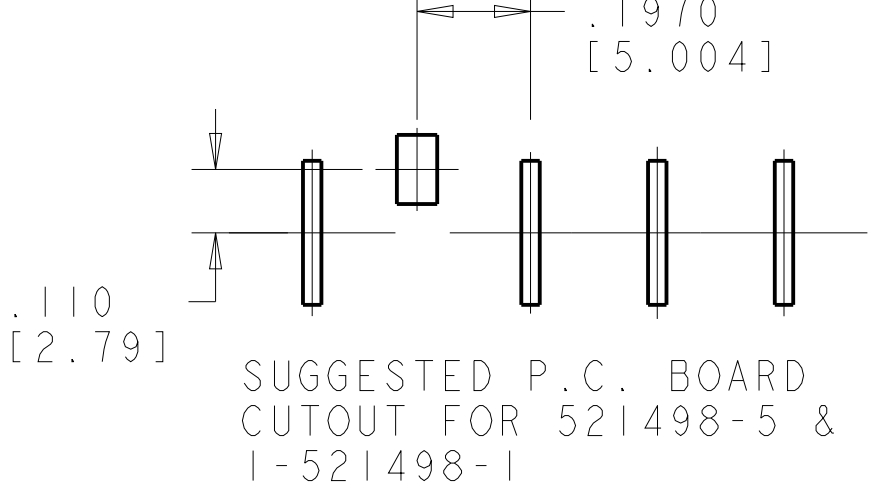
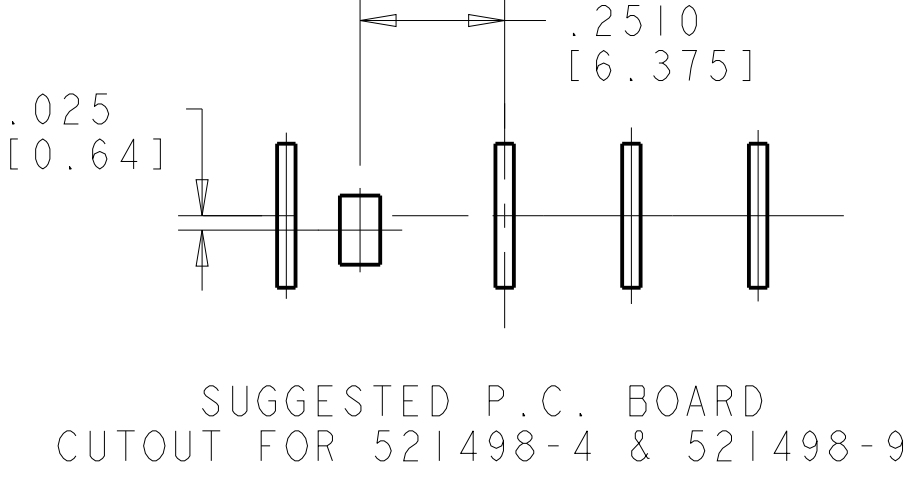
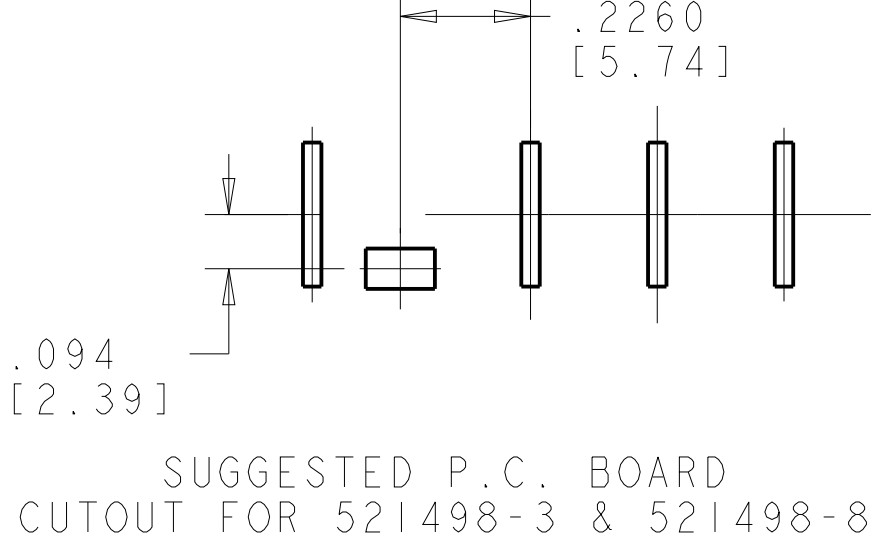
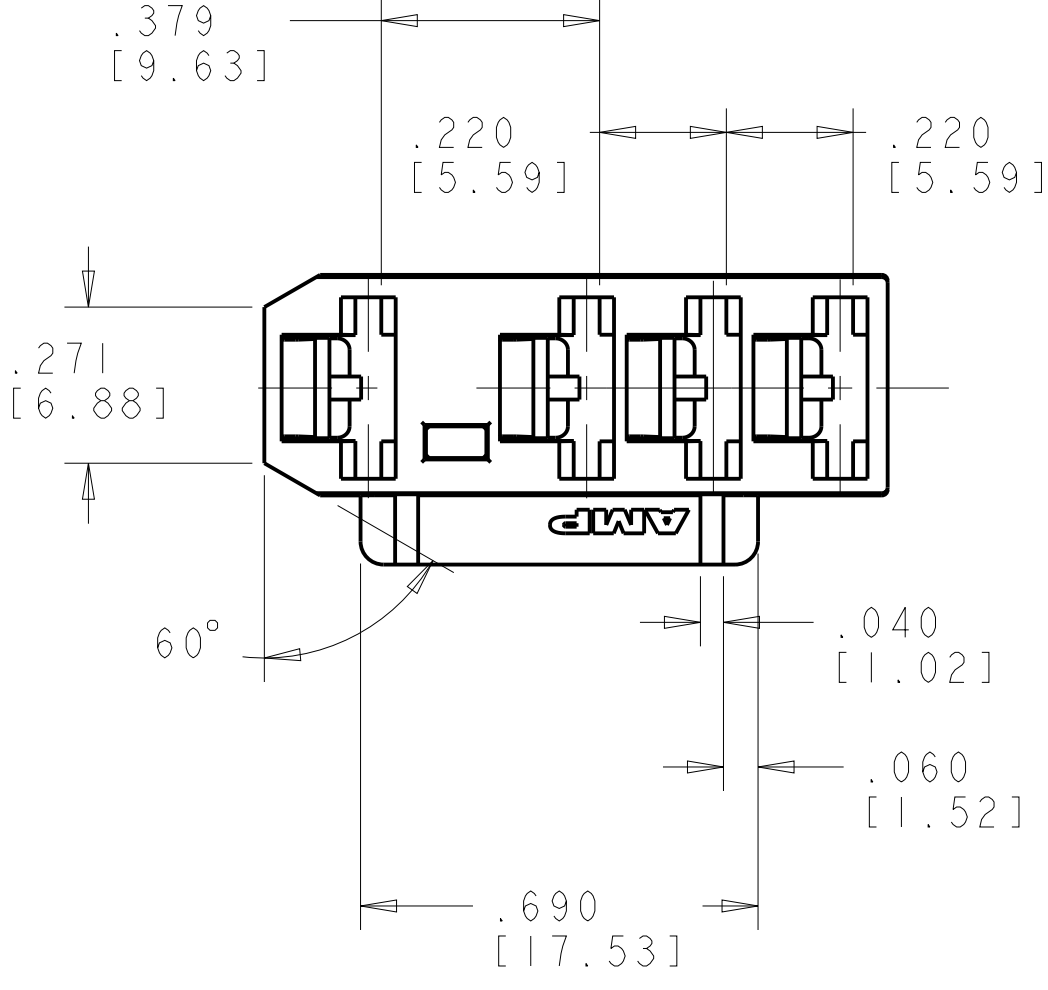
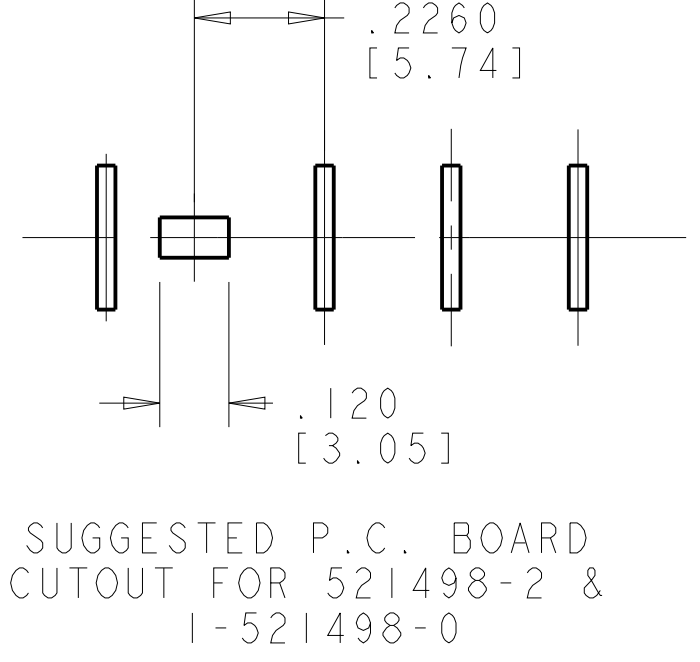
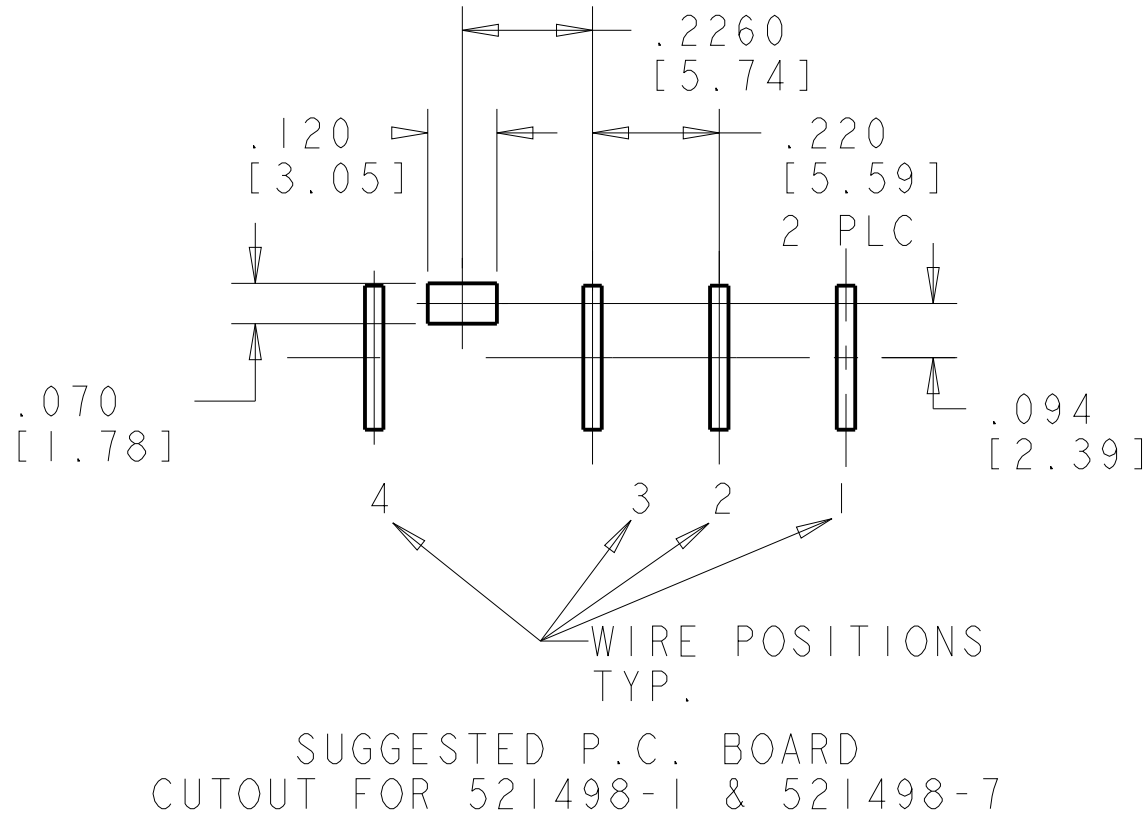
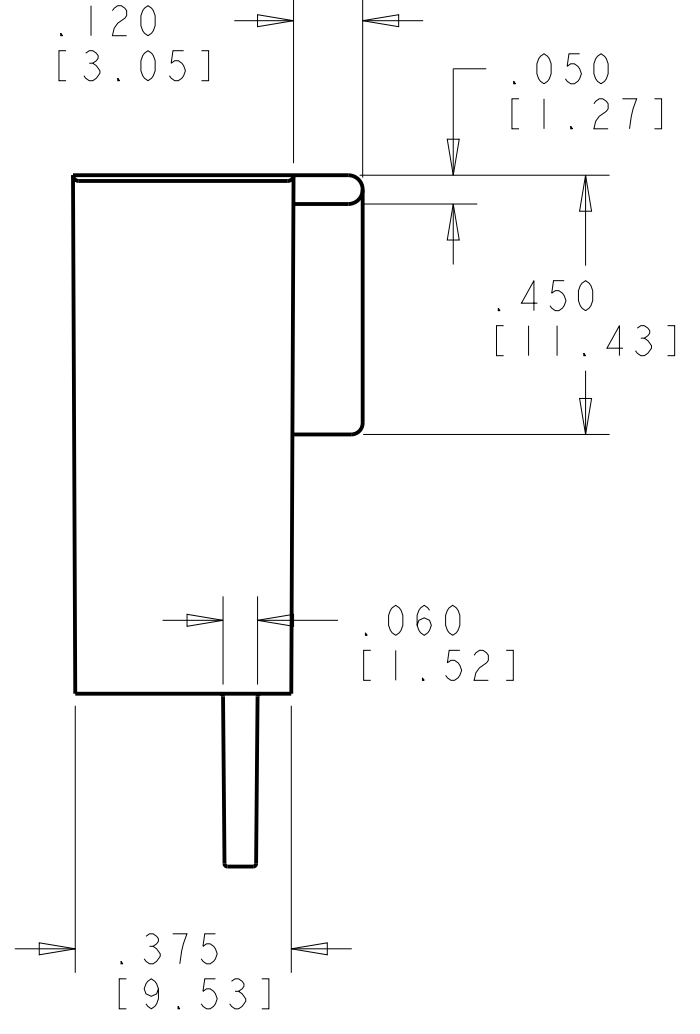
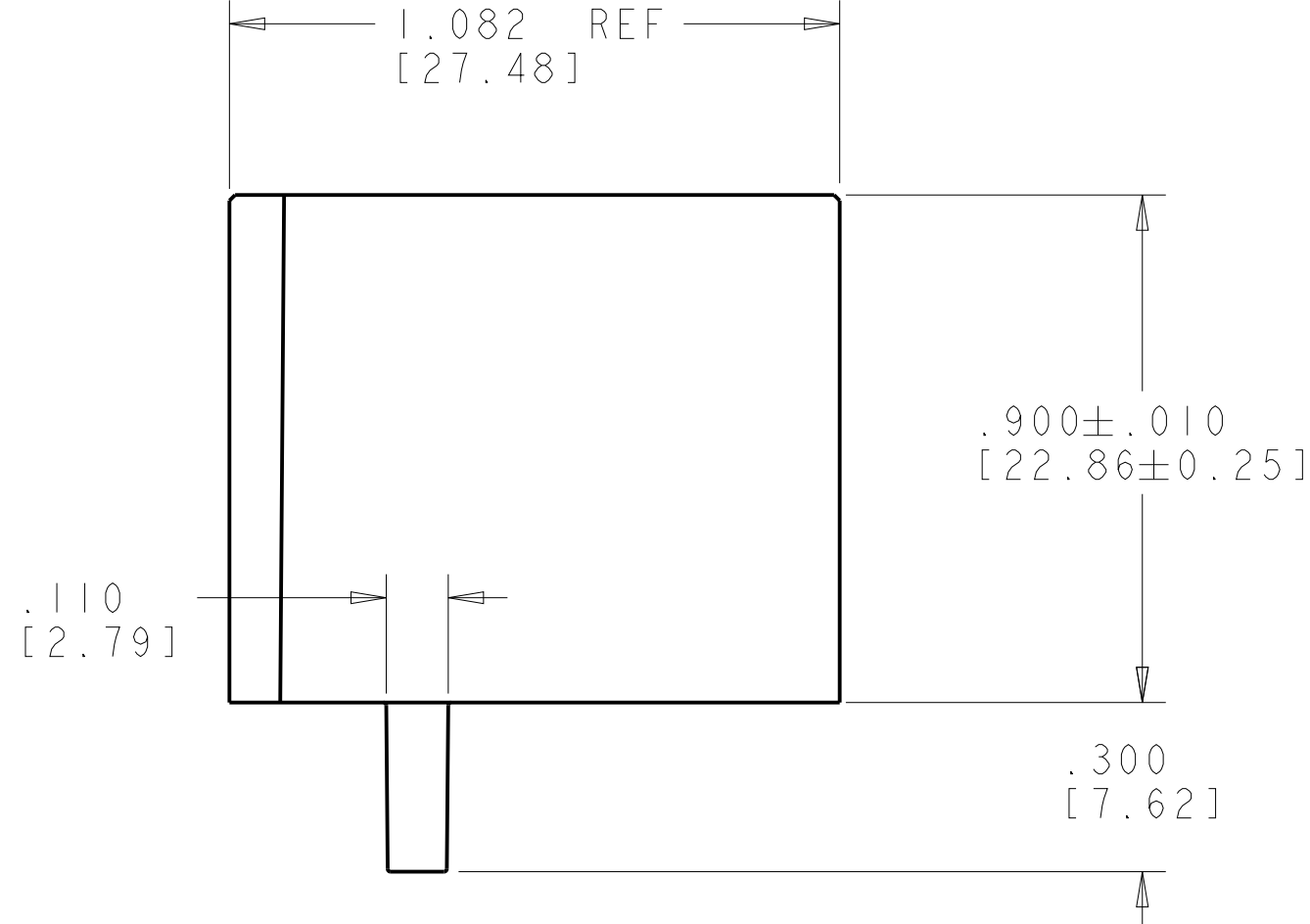
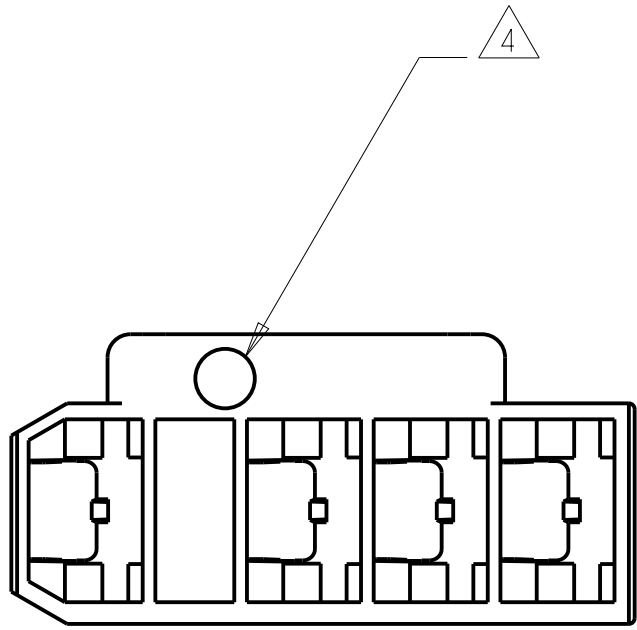

RED	NYLON, V-0	4	1-521498-2
WHITE	NYLON, V-0	4	1-521498-1
GREEN	NYLON, V-0	4	1-521498-0
BLACK	NYLON, V-0	4	521498-9
YELLOW	NYLON, V-0	4	521498-8
BLUE	NYLON, V-0	4	521498-7
RED	NYLON, V-2		521498-6
WHITE	NYLON, V-2		521498-5
BLACK	NYLON, V-2		521498-4
YELLOW	NYLON, V-2		521498-3
GREEN	NYLON, V-2		521498-2
BLUE	NYLON, V-2		521498-1
COLOR	MATERIAL	PART NUMBER	

1. THIS DRAWING IS UNPUBLISHED. IT IS SUBJECT TO CHANGE WITHOUT NOTICE. ANY CHANGES TO THIS DRAWING SHOULD BE CONTACTED FOR THE LATEST EDITION.		DWN R. FLAIG 01OCT2002		Tyco Electronics Harrisburg, PA 17105-3608	
DIMENSIONS: INCHES[mm]		CHK P. DESANTIS 01OCT2002		NAME	
TOLERANCES UNLESS OTHERWISE SPECIFIED: 0 PLC ±.005[0.13] 1 PLC ±. 2 PLC ±. 3 PLC ±. 4 PLC ±. ANGLES ±1°		APVD P. DESANTIS 01OCT2002		PRODUCT SPEC	
MATERIAL		APPLICATION SPEC		SIZE	
FINISH		WEIGHT		CAGE CODE	
CUSTOMER DRAWING		SCALE		SHEET	
		3:1		OF 1	
		REV		M11	

Mouser Electronics

Authorized Distributor

Click to View Pricing, Inventory, Delivery & Lifecycle Information:

[TE Connectivity:](#)

[521498-4](#)