

This document is the property of Amphenol Corporation and is delivered on the express condition that it is not to be disclosed, reproduced or used, in whole or in part, for manufacture or sale by anyone other than Amphenol Corporation without its prior consent, & that no right is granted to disclose or to use any information in this document.

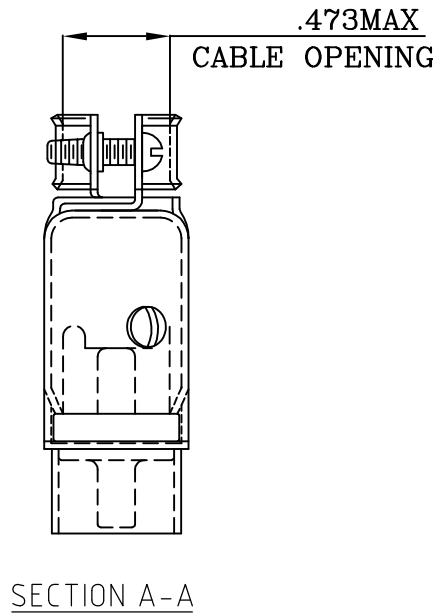
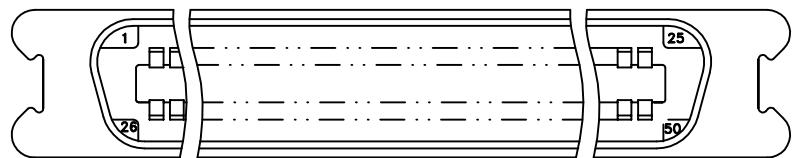
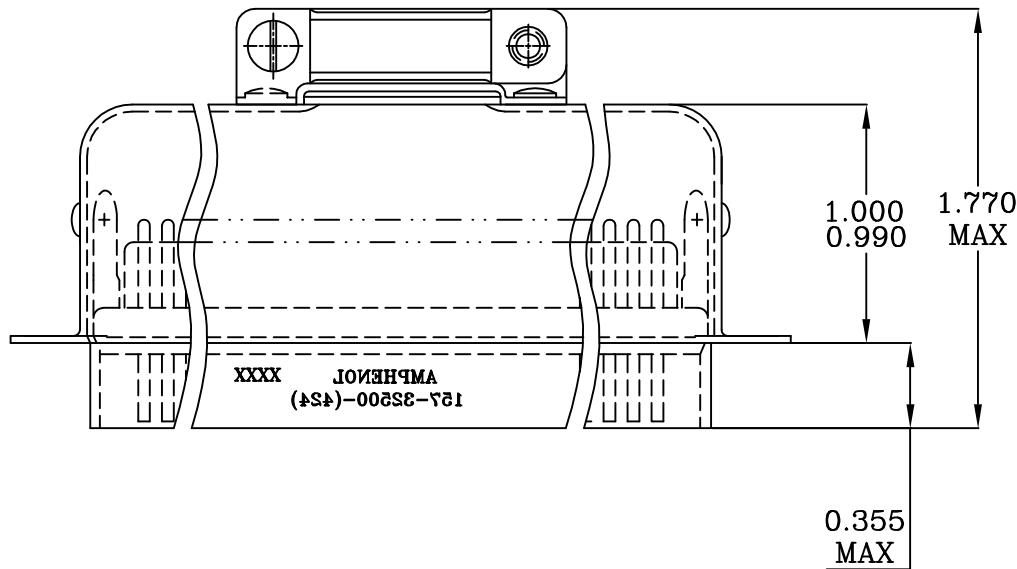
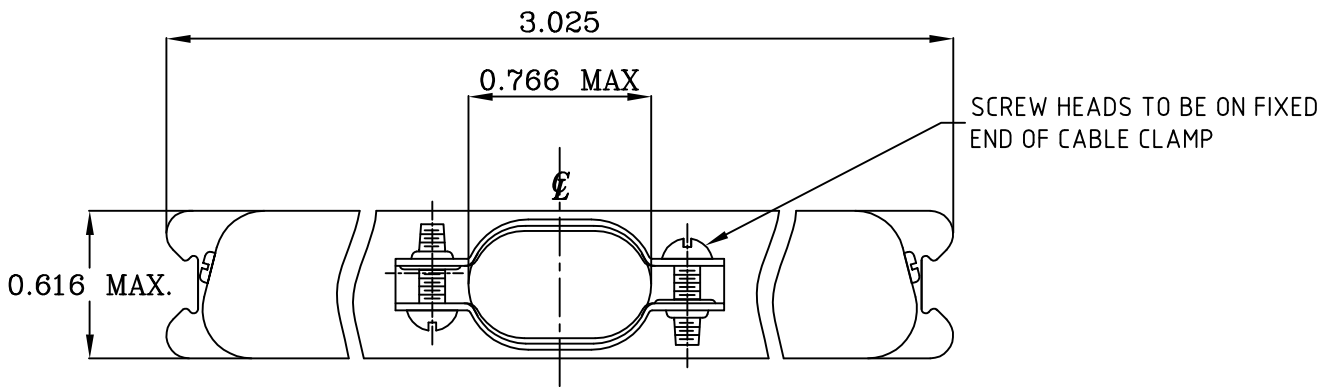

TABLE 1

CONNECTOR SIZES	AVERAGE MATING FORCE (POUNDS)
14	5
24	8
36	12
50	15
64	19

- 9) DIELECTRIC WITHSTANDING VOLTAGE: 1200 VAC (RMS) AT SEA LEVEL  
10) CONNECTOR MATING FORCE: REFER TO TABLE 1.  
11) CONTACT RETENTION FORCE: 2 LBS MAX.  
12) DURABILITY: 250 CYCLES MIN.  
13) VIBRATION: NO INTERRUPTIONS < 1u SEC.  
14) OPERATING TEMPERATURE: -55°C TO +105°C (-67°F TO +221°F)

SPECIFICATIONS:

- 1) INSULATION DISPLACEMENT CONTACTS: TO ACCOMMODATE 24-26 AWG SOLID AND 26-28 STRANDED CONNECTOR WIRES.  
2) DIELECTRIC: PBT GLASS FIBER RE-INFORCED, UL-94V0  
3) CONTACT MATERIAL: COPPER ALLOY  
4) CONTACT: 30 MICRO-INCHES MIN. GOLD MATING AREA: 1 MICRO-INCHES GOLD PLATED MIN. ALL OVER: 50 MICRO-INCHES MIN. NICKEL UNDERPLATING ALL OVER.  
5) SHELL MATERIAL: ZINC PLATED STEEL.  
6) CURRENT CAPACITY: 5 AMPS/CONTACT  
7) VOLTAGE RATING: 700 VOLTS D.C. AT SEA LEVEL  
200 VOLTS D.C. AT 70,000 FEET  
8) INSULATION RESISTANCE: >5000 M OHM

CUSTOMER INFORMATION DRAWING

ITEM NO	PART OR IDENTIFICATION NO	NOMENCLATURE OR DESCRIPTION	QTY REQ'D
PARTS LIST			
UNLESS OTHERWISE SPECIFIED TOLERANCES U.S. METRIC .X +/- 0.020 .XX +/- 0.010 .XXX +/- 0.005 FRACTIONS +/- ANGLES +/- 1°		APPROVAL DRAWN XS.GUO CHECKED DATE 03/10/06	Amphenol
FOR MATERIALS AND FINISHES SEE NOTES REMOVE SHARP EDGES		DRAWING FILE : \\DRAWING\\157\\C15732500424.DWG	TITLE 50 CONTACT SIZE MICROPIERCE CABLE MOUNT PLUG ASSEMBLY
DIMENSIONS U.S. INCHES (METRIC) (MM)		ANGLE OF PROJECTION 	SIZE A3 DRAWING NO. C157-32500(424) REV. B
		SCALE NONE	SHEET 1 OF 1

# Mouser Electronics

Authorized Distributor

Click to View Pricing, Inventory, Delivery & Lifecycle Information:

[Amphenol:](#)

[15732500424](#)