



RCA PHONO JACKS: KLPX Series

RCA Phono Jack PCB Mount

Product Features

Audio Applications for Computers and Multimedia
Two Contact Cost Efficient Design
Right Angle and Vertical Mount Available

Performance Specifications

Materials and Finish

Housing

PBT Thermoplastic, UL94V-0 Rated

Terminals

Brass, Tin Plated

Electrical Characteristics

Contact Resistance

30 milliohms Max.

Insulation Resistance

100 Megohms Min. at 500V DC

Dielectric Withstanding Voltage

500V AC RMS for 1 Minute

Mechanical Characteristics

Insertion Force

0.3kg - 3.0kg

Extraction Force

0.3kg - 3.0kg

Durability

5000 Mating Cycles Min.

Operating Temperature

-25°C to +80°C

| | | | |
|-----------------------|---------------------|----------------------|------------------|
| 2D Drawing | IGES | STEP | 3D PDF |
| Solder Profile | CofC RoHS Compliant | CofC REACH Compliant | UL Plastic File |
| Certificate of Origin | Check Stock | Request a Sample | Send Us An Email |

Generated Part Number

Part Number Builder

| | | | | |
|----------------------|---|----------------------|----------------------|----------------------|
| <input type="text"/> | - | <input type="text"/> | <input type="text"/> | <input type="text"/> |
| Series | | Type | Color Option | Plating Option |

Series

KLPX - RCA Phono Jack

Type

0848-2 - Vertical Mount

0848A-2 - Right Angle Mount

Color Option

B - Black

R - Red

W - White

Y - Yellow

Barrel Plating Option

Blank - Nickel Plating

Contact Kycon for other options

KLPX

Dimensions in mm

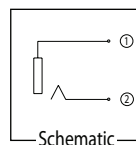
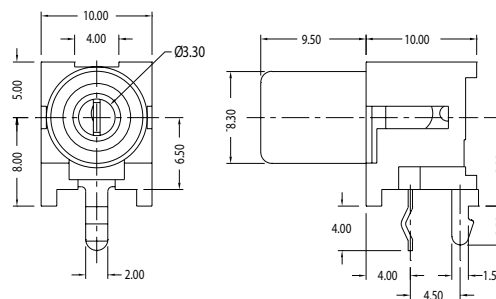

Mouser Electronics

Authorized Distributor

Click to View Pricing, Inventory, Delivery & Lifecycle Information:

[Kycon:](#)

[KLPX-0848-2-B](#) [KLPX-0848-2-R](#) [KLPX-0848-2-W](#) [KLPX-0848-2-Y](#) [KLPX-0848-2-B-G](#) [KLPX-0848-2-R-G](#) [KLPX-0848-2-Y-G](#) [KLPX-0848-2-W-G](#) [KLPX-0848A-2-R](#) [KLPX-0848A-2-B](#) [KLPX-0848A-2-Y](#) [KLPX-0848A-2-O](#) [KLPX-0848A-2-W](#) [KLPX-0848A-2-Y-G](#) [KLPX-0848A-2-W-G](#) [KLPX-0848A-2-B-G](#) [KLPX-0848A-2-R-G](#) [KLPX-0848A-2-BL](#) [KLPX-0848A-2-GR](#) [KLPX-0848A-2-O-G](#) [KLPX-0848-2-GR](#) [KLPX-0848-2-BL](#) [KLPX-0848-2-O](#) [KLPX-028-W](#) [KLPX-028-B](#) [KLPX-028-R](#)