

MODULAR JACKS AND PLUGS: GWX /GWX-SMT Series Right Angle Modular Jack, Tab Up

Product Features:

- Low Profile Design Suitable for PC Add-on
- Tab up Design for Easy Insertion/Removal of Mating Plug
- Available Fully Shielded for EMI/RFI Protection
- Available with Through Hole or Surface Mount
- Contact Options
- CSA/NTRL Certified File No. LR78160

Performance Specifications

Materials and Finish

Housing

High Temperature Thermoplastic, UL 94V-0 Rated,
Black Color

Contact Material

Phosphor Bronze

Contact Plating

Standard: Nickel Underplating, Selectively Plated
Gold Flash

50 Option: Nickel Underplating, Selectively Plated
50µ" Gold

Contact Area, Gold Flash on Solderails

Shield Material

Copper Alloy, Nickel Plated

Electrical Characteristic

Insulation Resistance

500 Megohms Min.

Rated Voltage

125V DC

Contact Resistance

20 milliohms Max.

Rated Current

1.5A

| | | | |
|-----------------------|---------------------|----------------------|------------------|
| 2D Drawing | IGES | STEP | 3D PDF |
| Solder Profile | CofC RoHS Compliant | CofC REACH Compliant | UL Plastic File |
| Certificate of Origin | Check Stock | Request a Sample | Send Us An Email |

Generated Part Number



Part Number Builder

| | | | | | |
|----------------------|---|----------------------|-----------------------------|----------------------|----------------------|
| <input type="text"/> | - | <input type="text"/> | <input type="text"/> | <input type="text"/> | <input type="text"/> |
| Series | | Shield Option | No. of Positions & Contacts | Plating Options | Packaging Option |

Series

- GWX - Through Hole, Right Angle
- GWX-SMT - Surface Mount, Right Angle

Shield Option

- N - Non-Shielded
- S - Fully Shielded
- S3 - Fully Shielded with Tabs on Top (Available only with Through Hole)
- S9 - Fully Shielded with Tabs on Top and Sides

Number of Positions/Contacts

88 - 8 Positions / 8 Contacts

Plating Option

- Blank - Gold Flash
- 50 - 50µ" Gold Plating

Packaging Option

- Blank - Tray
- TR - Tape & Reel (Available only with SMT Option)

Contact Kycon for Other Options

GWX-S-88

Dimensions in mm

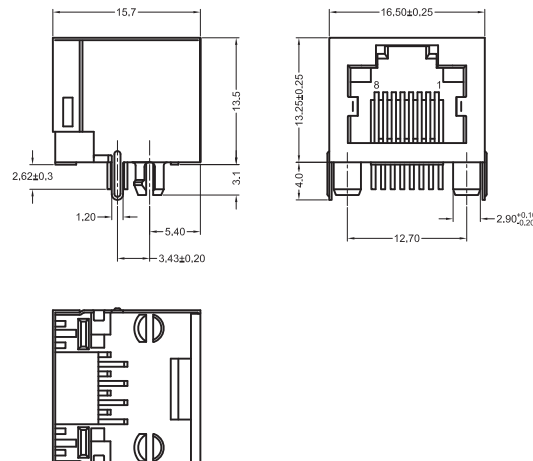

Mouser Electronics

Authorized Distributor

Click to View Pricing, Inventory, Delivery & Lifecycle Information:

[Kycon:](#)

[GWX-S3-88-50](#) [GWX-S9-88](#) [GWX-S9-88-50](#) [GWX-SMT-S9-88-50](#) [GWX-S-88-50](#) [GWX-S-88](#) [GWX-SMT-S9-88](#)
[GWX-N-88](#) [GWX-N-88-50](#) [GWX-S3-88](#) [GWX-SMT-N-88](#) [GWX-SMT-N-88-50](#) [GWX-SMT-N-88-50-TR](#) [GWX-SMT-N-](#)
[88-TR](#) [GWX-SMT-S-88](#) [GWX-SMT-S-88-50](#) [GWX-SMT-S-88-50-TR](#) [GWX-SMT-S-88-TR](#) [GWX-SMT-S9-88-50-TR](#)
[GWX-SMT-S9-88-TR](#)