

THIS DRAWING IS UNPUBLISHED. RELEASED FOR PUBLICATION
 © COPYRIGHT 20 BY - ALL RIGHTS RESERVED.

REVISIONS				
P	LTR	DESCRIPTION	DATE	APVD
E		REVISED PER ECO-13-019095	05DEC2013	DR RB

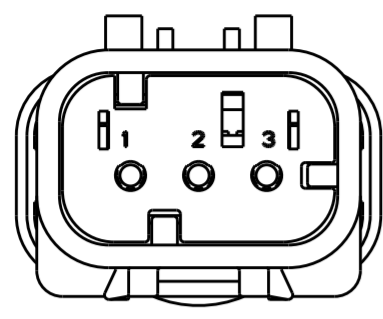

776430-2
SCALE 2:1
KEY B

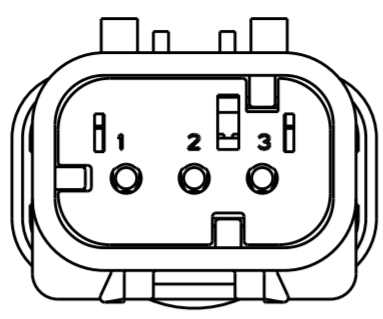

776430-3
SCALE 2:1
KEY C

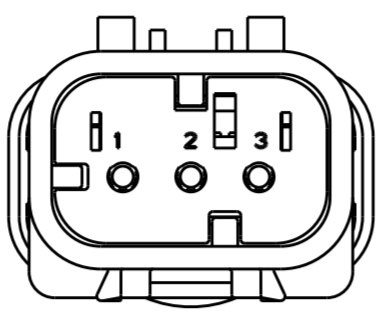

776430-4
SCALE 2:1
KEY D

1 MATERIAL: 15% GLASS FILLED THERMOPLASTIC
COLOR: BLACK

2 MATERIAL: 15% GLASS FILLED THERMOPLASTIC
COLOR: (SEE TABLE)

3 MATERIAL: SILICONE
COLOR: GREEN

4. RECOMMENDED WIRE DIAMETER RANGE IS 2.18 TO 3.67mm.

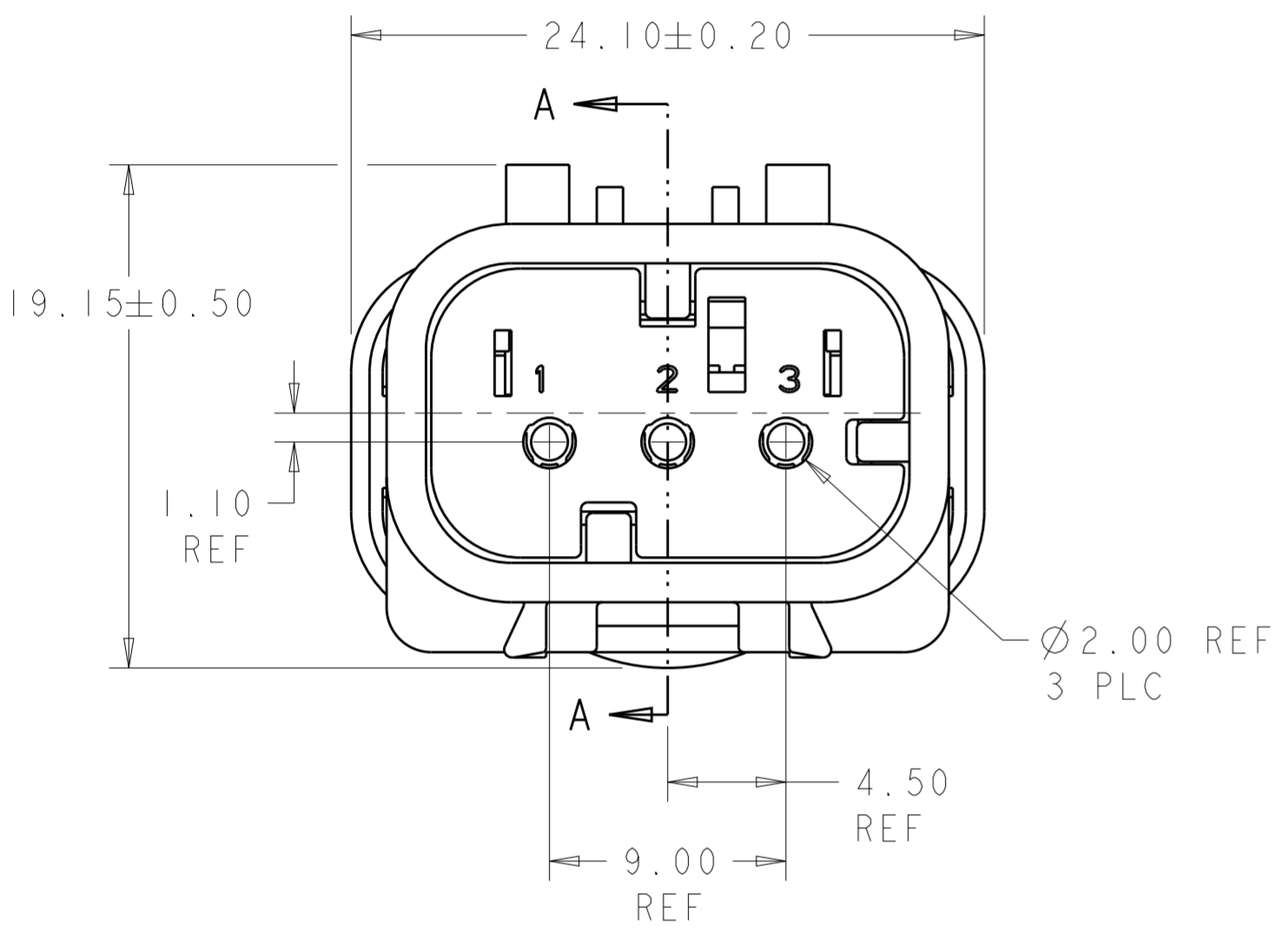

776430-1 SHOWN
KEY A

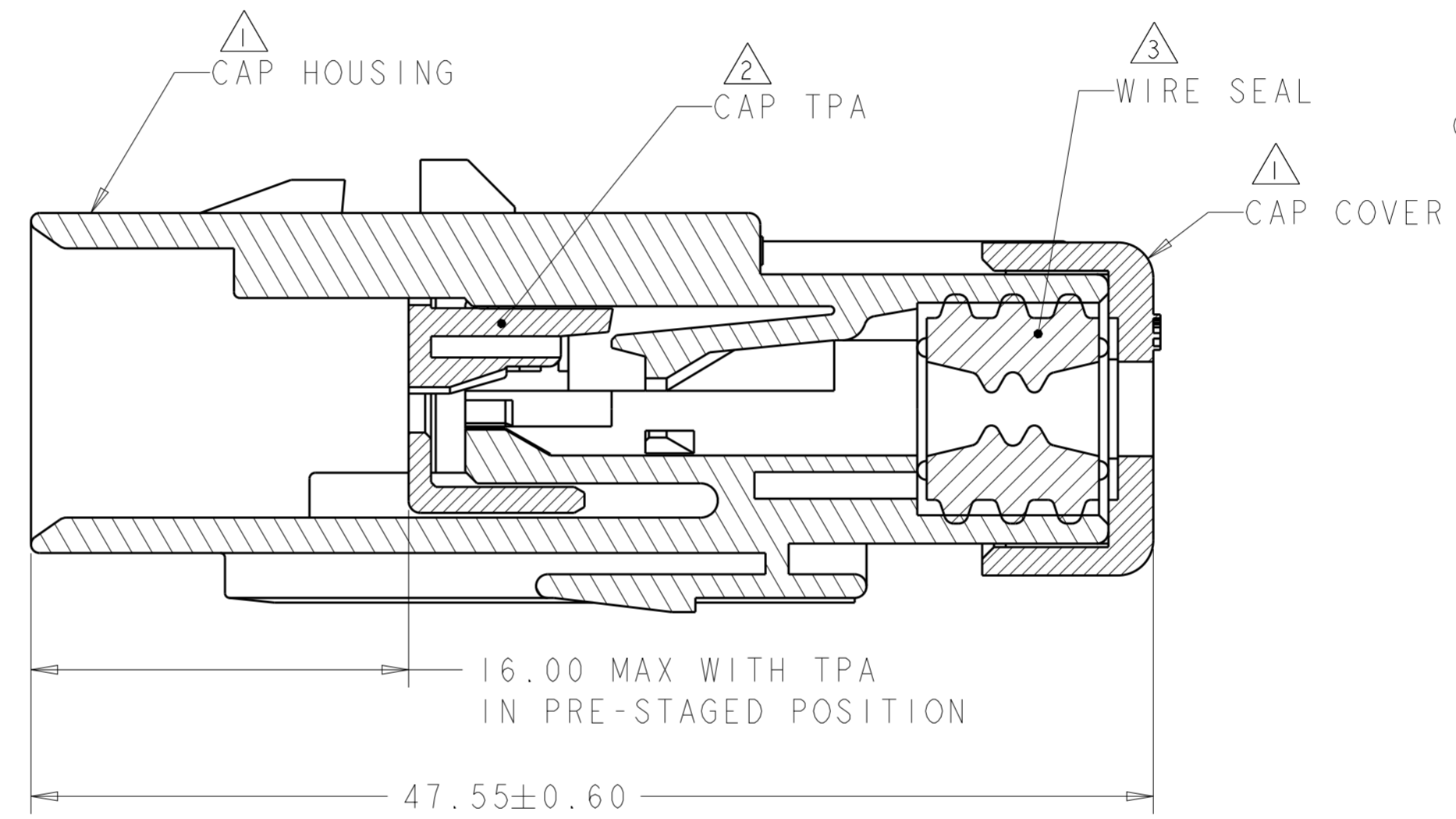

SECTION A-A

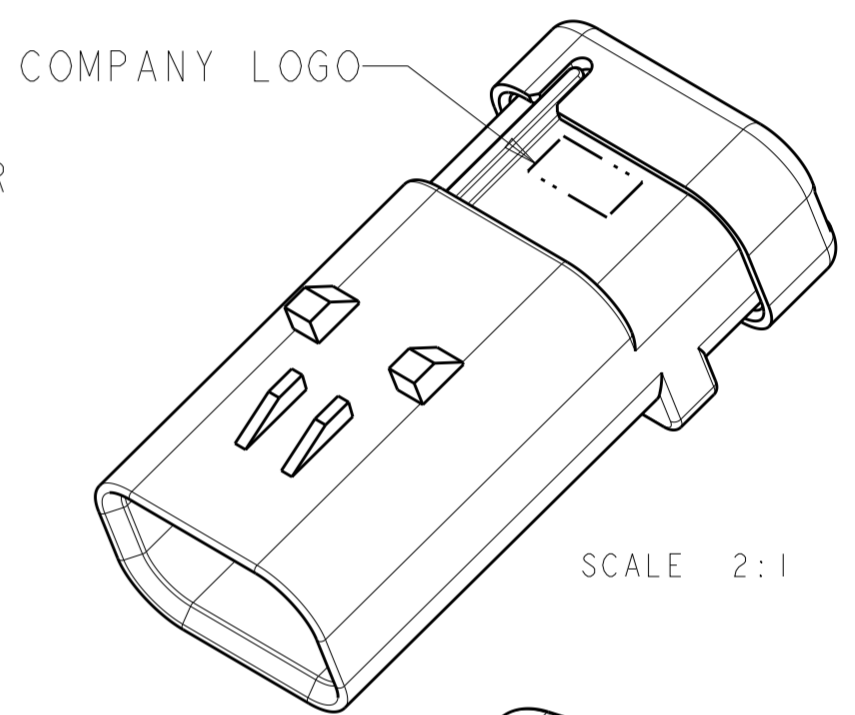

SCALE 2:1

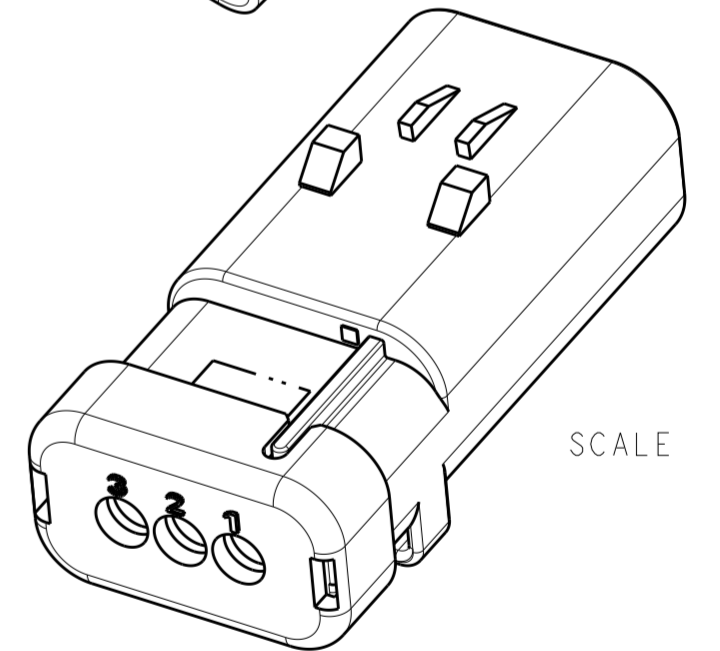

SCALE 2:1

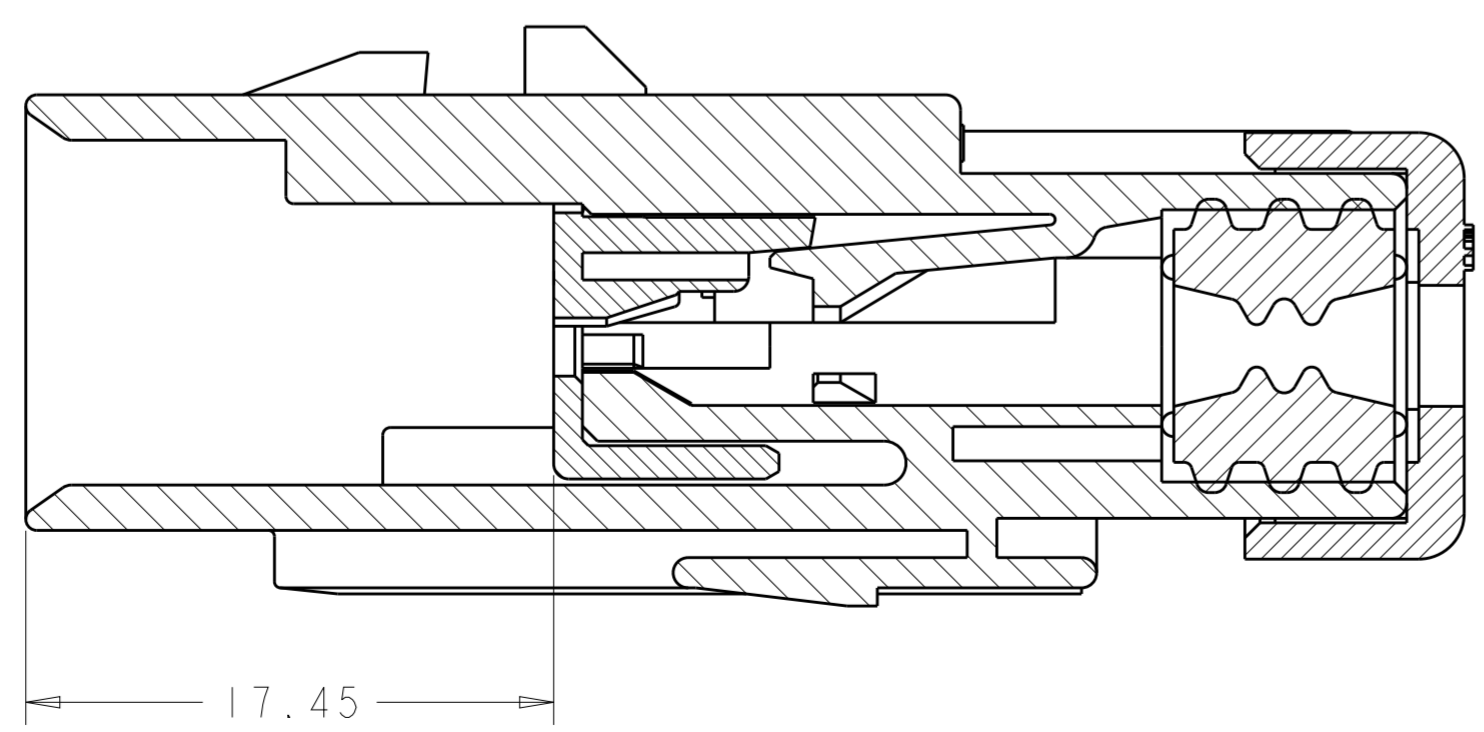

SECTION A-A
WITH TPA IN CLOSED POSITION

D	GREEN	776430-4
C	YELLOW	776430-3
B	GRAY	776430-2
A	RED	776430-1
KEY	TPA COLOR	PART NUMBER

THIS DRAWING IS A CONTROLLED DOCUMENT.		DWN Y. PETERSON	22FEB00	TE Connectivity CAP ASSEMBLY, 3 POSITION, SINGLE ROW, AMPSEAL 16			
DIMENSIONS:		CHK R. GREINER	11DEC01				
TOLERANCES UNLESS OTHERWISE SPECIFIED:		APVD M. TRULLI	11DEC01				
mm		PRODUCT SPEC	108-2184				
		APPLICATION SPEC	114-13065	SIZE	CAGE CODE	DRAWING NO	RESTRICTED TO
MATERIAL		FINISH	WEIGHT	A200779	C-776430		
Customer Drawing				SCALE	4:1	SHEET	OF
				REV	E		

Mouser Electronics

Authorized Distributor

Click to View Pricing, Inventory, Delivery & Lifecycle Information:

[TE Connectivity:](#)

[776430-4](#)