

3 Apr. 1. 2020 Copyright 2020 HIROSE ELECTRIC CO., LTD. All Rights Reserved.
 In case of consideration for using Automotive equipment / device which demand high reliability, kindly contact our sales workflow correspondents.

2

7

8

COUNT	DESCRIPTION OF REVISIONS	BY	CHKD	DATE	COUNT	DESCRIPTION OF REVISIONS	BY	CHKD	DATE
△					△				
△					△				
△					△				

A

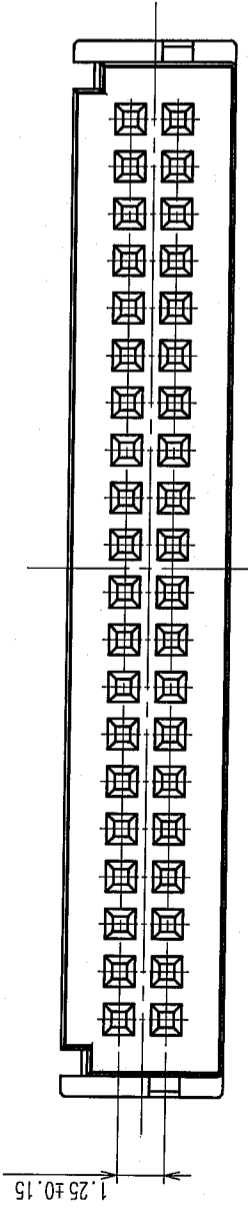

27.85 ± 0.3

B

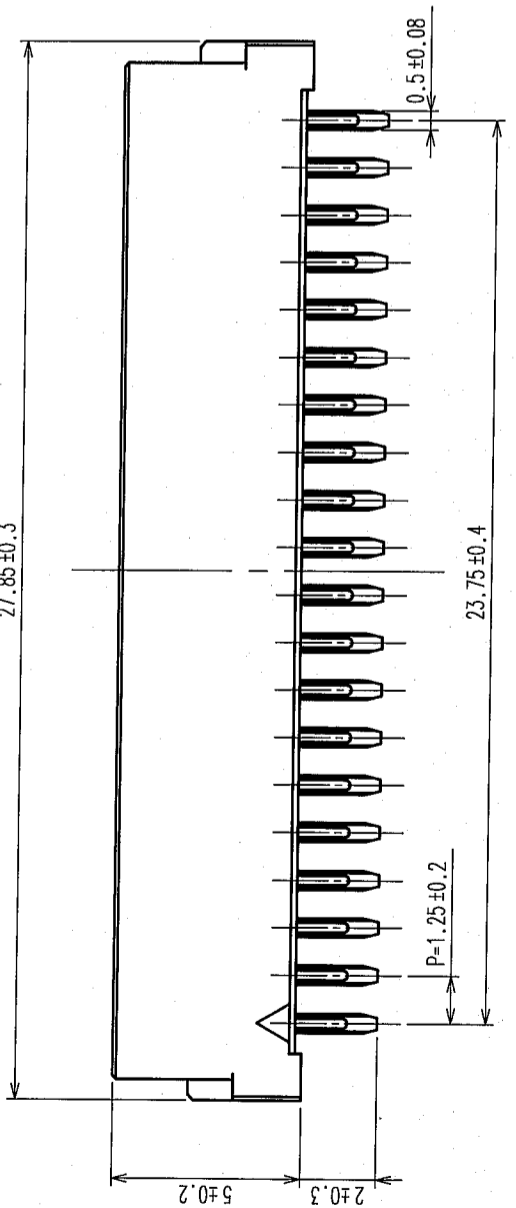

P=1.25 ± 0.2

23.75 ± 0.4

C

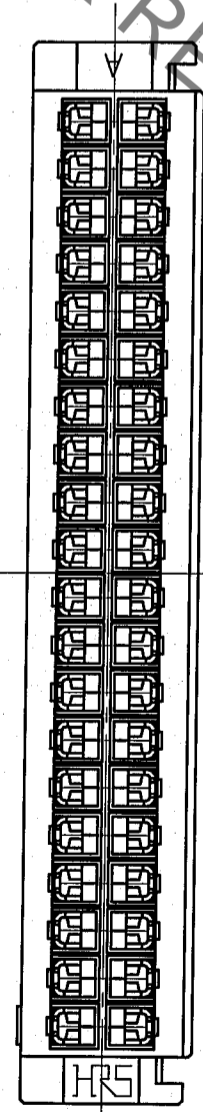

D

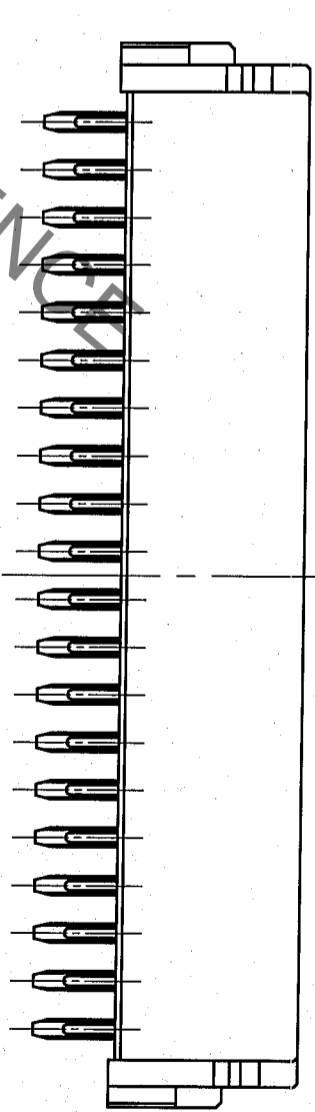

E

MATED CONNECTORS

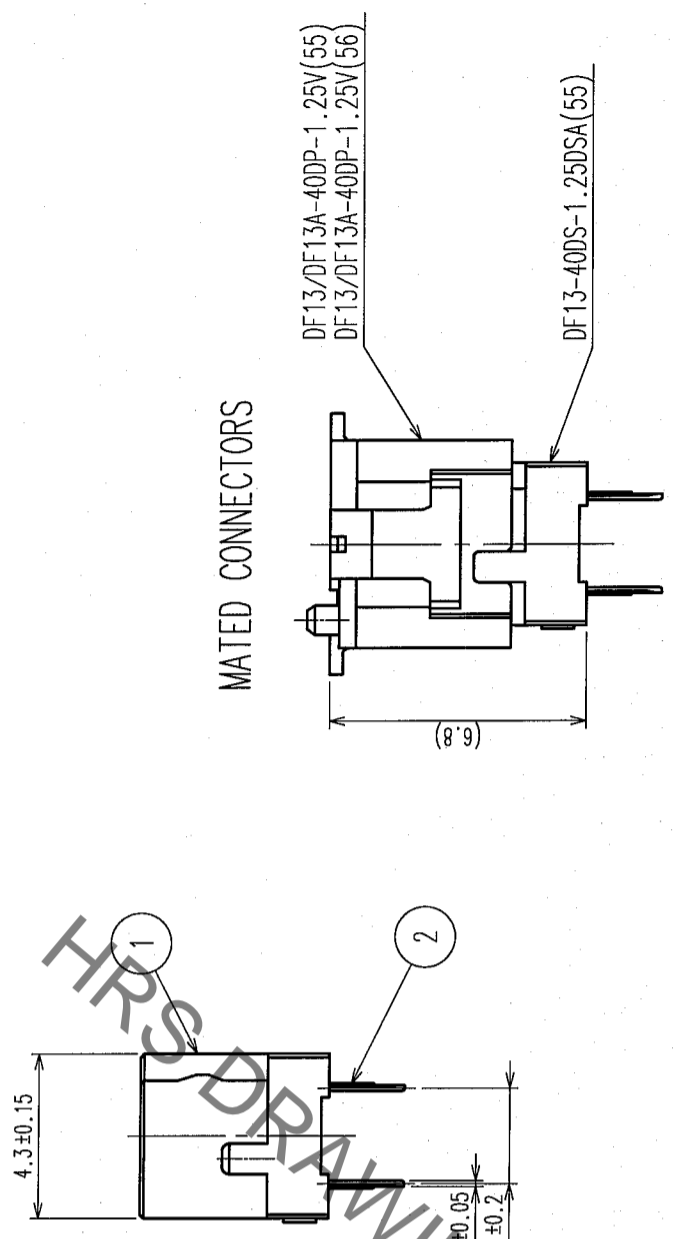

DF13/DF13A-40DP-1.25V(55)
 DF13/DF13A-40DP-1.25V(56)

DF13-40DS-1.25DSA(55)

(6.8)

NOTES1 THROUGH HOLE DIA. ON BOARD: $\phi 0.6^{+0.05}_0$

2	PHOSPHOR BRONZE	CONTACT AREA: GOLD PLATING 0.2 μ m min LEAD AREA: TIN PLATING 2 μ m min UNDER PLATING: NICKEL PLATING 1 μ m min
1	POLYAMIDE	UL94V-0 (BEIGE)
NO.	MATERIAL	FINISH, REMARKS
4	SBR	STOPPER (GREEN)
3	PS POLYSTYRENE	ELECTROSTATIC PROTECTION (PURPLE)
NO.	MATERIAL	FINISH, REMARKS

REMARKS

DRAWN	DESIGNED	CHECKED	APPROVED	RELEASED
A. Miura	T. Nishiyama	H. Yamashita	S. Ota	
'06.01.31	'06.01.31	'06.02.02	'06.02.02	
PART NO.	DF13-40DS-1.25DSA(55)			
CODE NO. (COLD)	EDC3-160787-03	DRAWING NO.		
SCALE	5 : 1			
UNITS	mm			

HIROSE ELECTRIC CO., LTD.

CL536-0635-3-55

FORM NO. 233

TO

2 In case of consideration for using Automotive equipment / device which demand high reliability, kindly contact our sales window correspondents.

COUNT	DESCRIPTION OF REVISIONS	BY	CHKD	DATE	COUNT	DESCRIPTION OF REVISIONS	BY	CHKD	DATE
△					△				
△					△				
△					△				

510-2

A

DF13-DS-1.25DSA/V MADE IN JAPAN

HRS ヒロセ電機

空チユ-フ回収に御協力下さい

1 2 3 4 5 6 7 8

3

4

A(10:1)

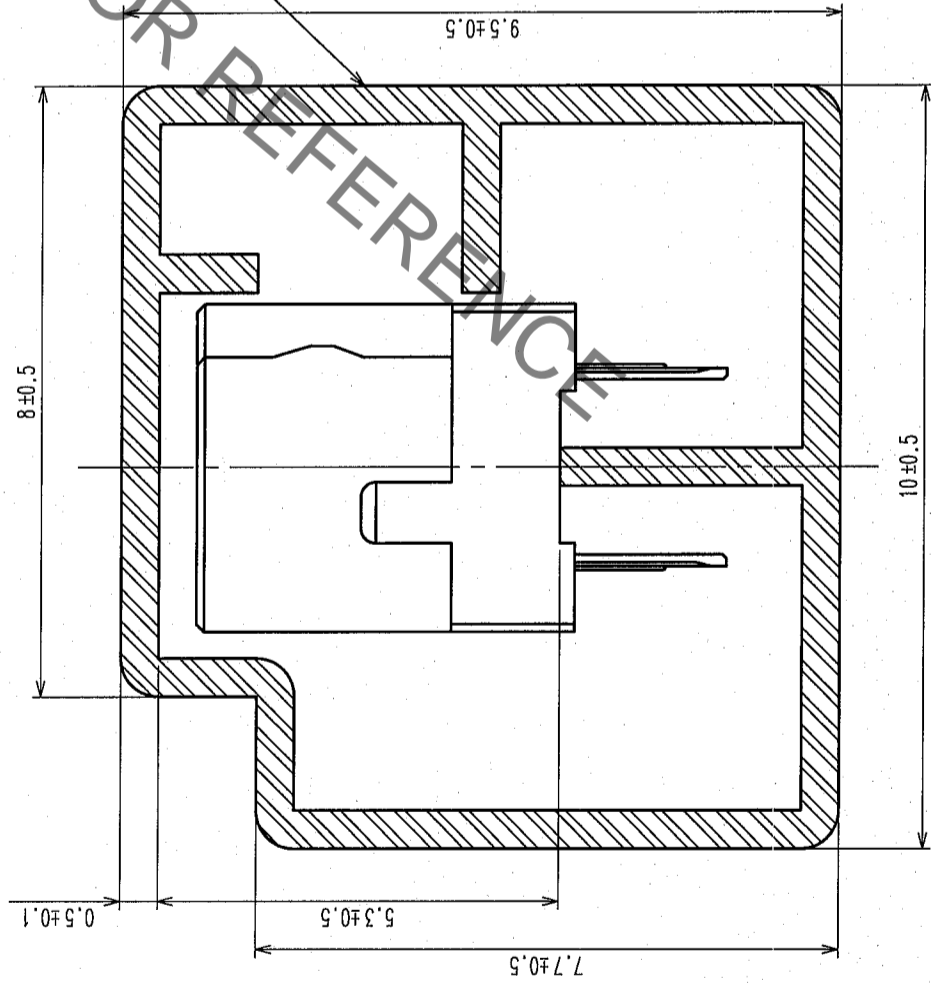

NOTES
 2 NUMBER OF CONNECTORS PER A MAGAZINE CASE SHALL BE 17.
 3 THESE CONNECTORS SHALL BE ON SALED IN ACCORDANCE WITH THE MULTIPLE QUANTITY OF 17.

CODE NO. (OLD) CL	DRAWING NO. EDC3-160787-03	DRAWING NO. DF13-40DS-1.25DSA(55)	DESIGNED T. Kurogami	CHECKED H. Tanaka	APPROVED J. Ota	RELEASED
SCALE FREE	DRAWN A. Miura	PART NO.	06.01.31	06.02.02	06.02.02	
UNITS mm	HRS HIROSE ELECTRIC CO., LTD.	CODE NO. CL536-0635-3-55	2	2	2	2

TO